

**2008 TRAFFIC VOLUMES**  
**MUNICIPALITY OF**  
**MONTICELLO**  
 PREPARED BY THE  
**MINNESOTA DEPARTMENT OF TRANSPORTATION**  
 OFFICE OF TRANSPORTATION DATA & ANALYSIS  
 IN COOPERATION WITH  
**U.S. DEPARTMENT OF TRANSPORTATION**  
 FEDERAL HIGHWAY ADMINISTRATION

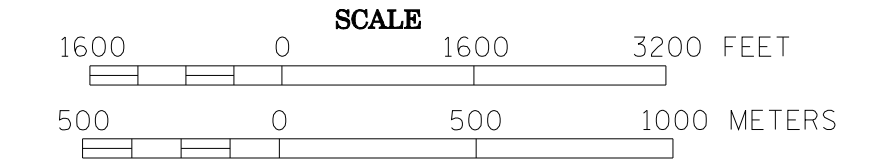

**2008**  
 BASIC DATA - 1991

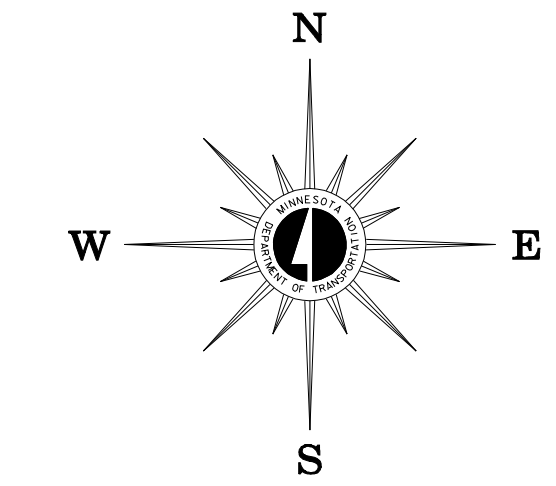

**LEGEND**

- INTERSTATE TRUNK HIGHWAY..... (I-95)
- U.S. TRUNK HIGHWAY..... (10)
- STATE TRUNK HIGHWAY..... (55)
- COUNTY STATE AID HIGHWAY..... (21)
- COUNTY ROAD..... (14)
- CORPORATE LIMITS.....
- PUBLIC ROAD.....
- PRIVATE ROAD.....

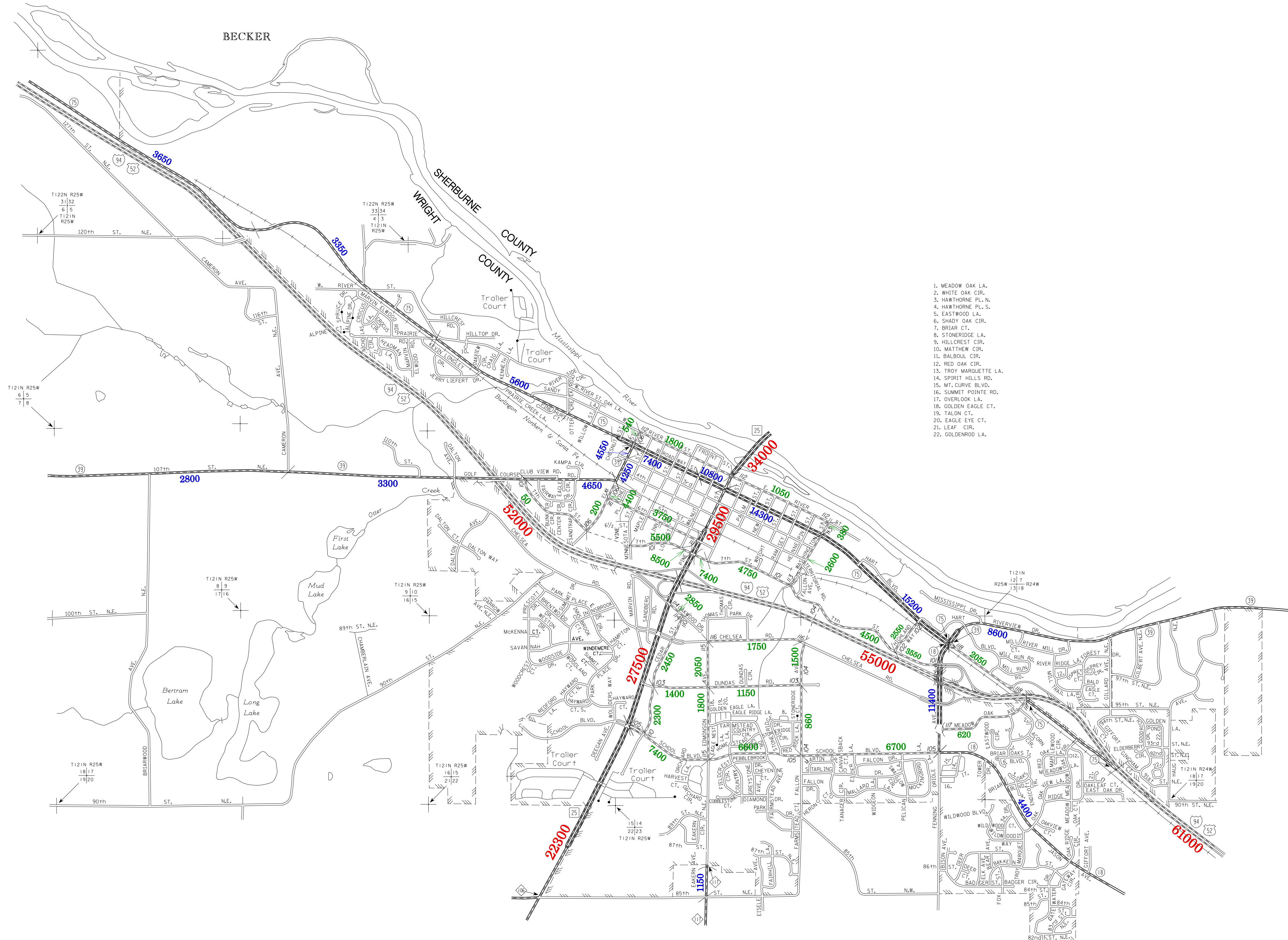

1. MEADOW OAK LA.
2. WHITE OAK CIR.
3. HAWTHORNE PL. N.
4. HAWTHORNE PL. S.
5. EASTWOOD LA.
6. SHADY OAK CIR.
7. BRIAR CT.
8. STONERIDGE LA.
9. HILLCREST CIR.
10. MATTHEW CIR.
11. BALBOUL CIR.
12. RED OAK CIR.
13. TROY MARQUETTE LA.
14. SPIRIT HILLS RD.
15. MT. CURVE BLVD.
16. SUMMIT POINTE RD.
17. OVERLOOK LA.
18. GOLDEN EAGLE CT.
19. FALCON CT.
20. EAGLE EYE CT.
21. LEAF CIR.
22. GOLDENWOOD LA.

**MUNICIPAL STATE AID STREET SYSTEM**

**LEGEND**

- MUNICIPAL COUNTY STATE AID STREET.....
- MUNICIPAL STATE AID STREET.....
- COUNTY STATE AID HIGHWAY.....
- COUNTY ROAD.....
- TRUNK HIGHWAY.....

VOLUMES PREPARED BY  
 THE OFFICE OF  
 TRANSPORTATION DATA & ANALYSIS

NUMERALS INDICATE AVERAGE DAILY  
 TRAFFIC VOLUMES ON DESIGNATED ROADS.

**TRUNK HIGHWAY ROUTES ARE 2008 A.A.D.T. VOLUMES**  
**COUNTY SYSTEM ROADS ARE 2008 A.A.D.T. VOLUMES**  
**MUNICIPAL STREET ROUTES ARE 2008 A.A.D.T. VOLUMES**

FOR DESIGNATED ROADS :  
 / = SEGMENT ENDPOINT FOR ALL  
 ROADS INTERSECTED BY HATCH  
 ( = SEGMENT ENDPOINT ONLY FOR  
 ROAD SEPARATED FROM INTERSECTING  
 ROAD BY ARC

TRAFFIC VOLUMES ARE SUBJECT TO VARIABILITY AND CONSTRUCTION EFFECTS

FOR MORE INFO VISIT: <http://www.dot.state.mn.us/traffic/data/html/aadt.html>