

2008 TRAFFIC VOLUMES

MUNICIPALITY OF CAMBRIDGE

PREPARED BY THE
MINNESOTA DEPARTMENT OF TRANSPORTATION
OFFICE OF TRANSPORTATION DATA & ANALYSIS
IN COOPERATION WITH
U.S. DEPARTMENT OF TRANSPORTATION
FEDERAL HIGHWAY ADMINISTRATION

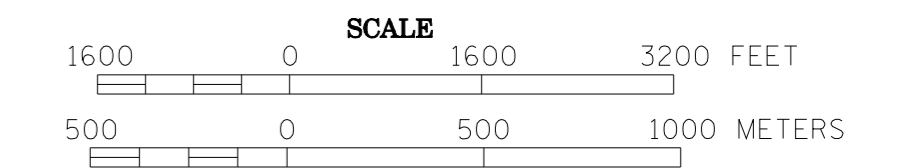

2008
BASIC DATA - 1991

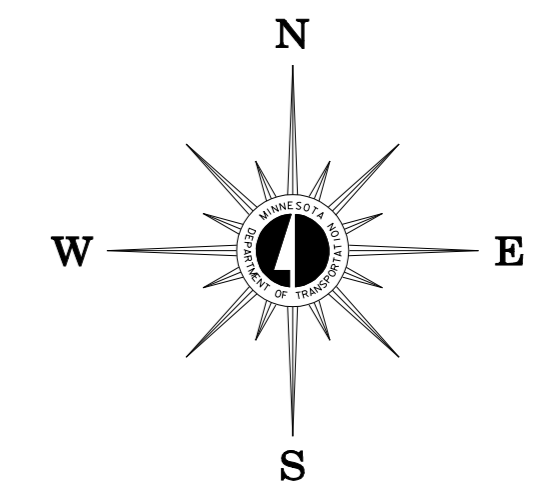

LEGEND

- INTERSTATE TRUNK HIGHWAY..... (15)
- U.S. TRUNK HIGHWAY..... (10)
- STATE TRUNK HIGHWAY..... (55)
- COUNTY STATE AID HIGHWAY..... (23)
- COUNTY ROAD..... (15)
- CORPORATE LIMITS.....
- PUBLIC ROAD.....
- PRIVATE ROAD.....

MUNICIPAL STATE AID STREET SYSTEM

LEGEND

- MUNICIPAL COUNTY STATE AID STREET.....
- MUNICIPAL STATE AID STREET.....
- COUNTY STATE AID HIGHWAY.....
- COUNTY ROAD.....
- TRUNK HIGHWAY.....

VOLUMES PREPARED BY
THE OFFICE OF
TRANSPORTATION DATA & ANALYSIS

NUMERALS INDICATE AVERAGE DAILY
TRAFFIC VOLUMES ON DESIGNATED ROADS.

TRUNK HIGHWAY ROUTES ARE 2008 A.A.D.T. VOLUMES
COUNTY SYSTEM ROADS ARE 2008 A.A.D.T. VOLUMES
MUNICIPAL STREET ROUTES ARE 2008 A.A.D.T. VOLUMES

FOR DESIGNATED ROADS :
/ = SEGMENT ENDPOINT FOR ALL
ROADS INTERSECTED BY HATCH
(= SEGMENT ENDPOINT ONLY FOR
ROAD SEPARATED FROM INTERSECTING
ROAD BY ARC

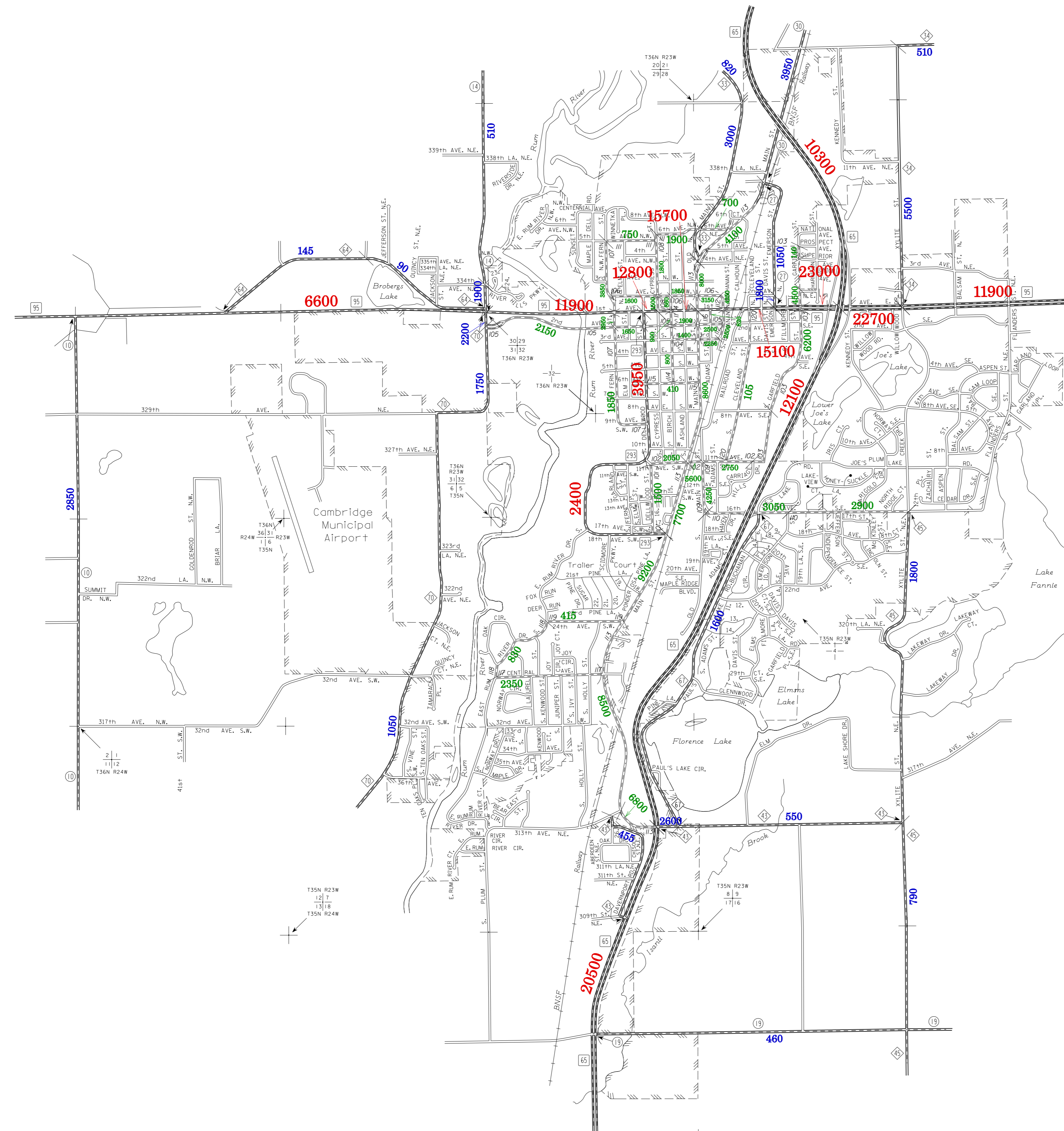

1. S. GARFIELD ST.
2. 20 1/2 LA. S.E.
3. 20TH LA. S.E.
4. S. CLEVELAND LA.
5. 19 1/2 LA. S.E.
6. S. BUCHANAN LA.
7. S. DAVIS LA.
8. 19TH LA. S.E.
9. 18 1/2 LA. S.E.
10. 20TH AVE. S.E.
11. BUCHANAN ST.
12. NELSON DR. S.E.
13. 24TH AVE. S.E.
14. CENTRAL AVE.
15. ASHLAND PL.
16. CYPRESS PL.
17. HORSESHOE DR.
18. PINE VILLAGE DR.
19. SCOTCH PINE DR.
20. JACK PINE DR.
21. RED PINE DR.
22. RIVER HILLS CT.
23. REVER HILLS PL.
24. WHITE PINE DR.
25. HONEYSUCKLE S.
26. BALTIMORE ST. N.E.

TRAFFIC VOLUMES ARE SUBJECT TO VARIABILITY AND CONSTRUCTION EFFECTS

FOR MORE INFO VISIT: <http://www.dot.state.mn.us/traffic/data/html/aadt.html>