

# 2007 TRAFFIC VOLUMES

(SEE NOTE)

## MUNICIPALITY OF WOODBURY

PREPARED BY THE  
MINNESOTA DEPARTMENT OF TRANSPORTATION  
OFFICE OF TRANSPORTATION DATA & ANALYSIS  
IN COOPERATION WITH  
U.S. DEPARTMENT OF TRANSPORTATION  
FEDERAL HIGHWAY ADMINISTRATION

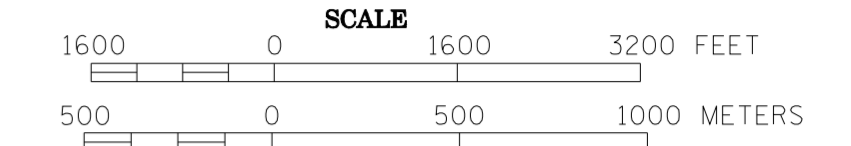

2007

BASIC DATA - 1993

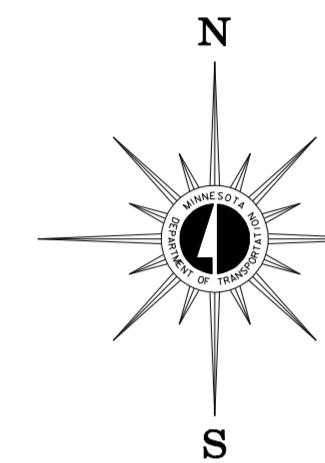

### LEGEND

- INTERSTATE TRUNK HIGHWAY..... (I-95)
- U.S. TRUNK HIGHWAY..... (US-169)
- STATE TRUNK HIGHWAY..... (ST-95)
- COUNTY STATE AID HIGHWAY..... (CSA-23)
- COUNTY ROAD..... (CR-15)
- CORPORATE LIMITS.....
- PUBLIC ROAD.....
- PRIVATE ROAD.....

## MUNICIPAL STATE AID STREET SYSTEM

### LEGEND

- MUNICIPAL COUNTY STATE AID STREET.....
- MUNICIPAL STATE AID STREET.....
- COUNTY STATE AID HIGHWAY.....
- COUNTY ROAD.....
- TRUNK HIGHWAY.....

VOLUMES PREPARED BY  
THE OFFICE OF  
TRANSPORTATION DATA & ANALYSIS

NUMERALS INDICATE AVERAGE DAILY  
TRAFFIC VOLUMES ON DESIGNATED ROADS.

TRUNK HIGHWAY ROUTES ARE 2006 A.A.D.T. VOLUMES  
COUNTY SYSTEM ROADS ARE 2007 A.A.D.T. VOLUMES  
MUNICIPAL STREET ROUTES ARE 2007 A.A.D.T. VOLUMES

FOR DESIGNATED ROADS :  
/ = SEGMENT ENDPOINT FOR ALL  
ROADS INTERSECTED BY HATCH  
( = SEGMENT ENDPOINT ONLY FOR  
ROAD SEPARATED FROM INTERSECTING  
ROAD BY ARC

TRAFFIC VOLUMES ARE SUBJECT TO  
VARIABILITY AND CONSTRUCTION EFFECTS  
FOR MORE INFO VISIT:

<http://www.dot.state.mn.us/traffic/data/html/aadt.html>

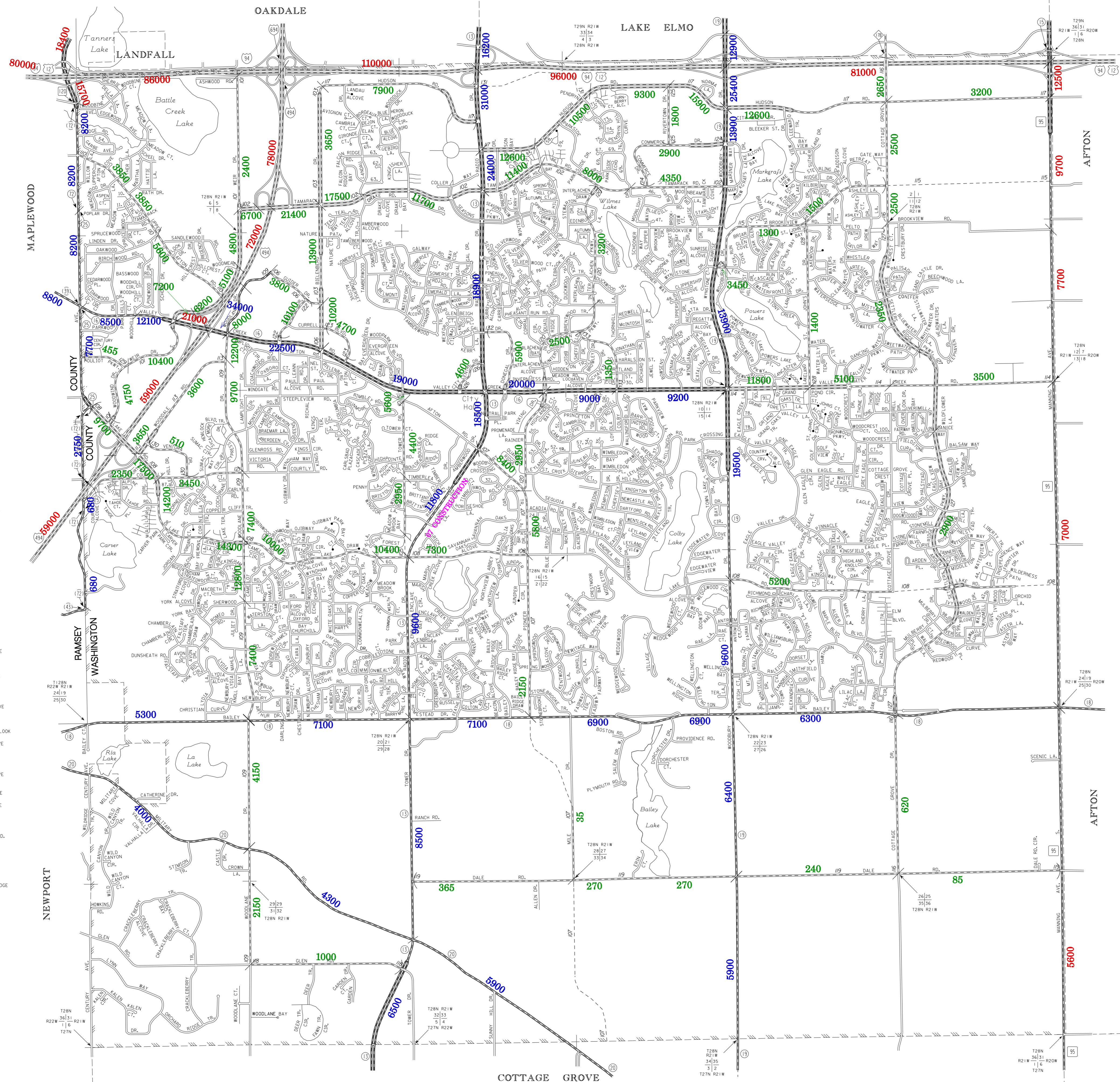

1. HAYENWOOD CIR.
2. CARILLON PLAZA W.
3. SPRINGBROOK PLAZA
4. SPRINGBROOK LA.
5. CARILLON PLAZA E.
6. CAPE TOWN PLAZA
7. CAYENE PLAZA W.
8. CAULFIELD PLAZA
9. CASCADE PLAZA N.
10. ALDERWOOD BAY
11. ALDERWOOD CIR.
12. ALDERWOOD PLAZA
13. ALDERWOOD DRAW
14. MOCBETH CIR.
15. WINDWARD LA.
16. ALDERWOOD DR.
17. PINEHURST CIR.
18. DONEGAL KNOLL
19. SHANNON CT.
20. COLBY LAKE CT.
21. BRIDAL PATH CT.
22. EDENBURGH LA.
23. INTERLACHEN ECHO
24. ACADIA BAY
25. PRINCETON BAY
26. EDINBOROUGH DR.
27. CORNELL CT.
28. PRINCETON ALCOVE
29. HIGHLAND ALCOVE
30. DORTLAND CT.
31. THORNHILL LA.
32. PRAIRIE OAK TR.
33. HORSESHOE RD.
34. LEVLAND CIR.
35. LETLAND COVE
36. JONAS ALCOVE
37. WHITEFIELD DR.
38. PINEHURST BAY
39. HIGHLAND KNOLL CT.
40. EAGLES NEST LA.
41. ASHROVE LA.
42. JYWOOD BAY
43. PROSPECT CURVE
44. LEGACY LA.
45. OAK KNOLL DR.
46. MOONLIGHT PL.
47. MOONLIGHT BAY
48. CLIPPERSHIP BAY
49. CLIPPERSHIP CT.
50. HIGHLAND BLVD.
51. HIGHLAND CIR.
52. LEVLAND BAY
53. RAINIER CT.
54. RAINIER BAY
55. RAINIER ALCOVE
56. LEVLAND ALCOVE
57. LEVLAND CT.
58. THOMAS DR.
59. THOMAS LA.
60. MEADOW BROOK CT.
61. ASPENWOOD PLAZA
62. EAGLE RIDGE ALCOVE
63. EAGLE RIDGE RD.
64. WINTERBERRY DRAW
65. FONTAINE CT.
66. MONTICELLO ALCOVE
67. PRESERVE ALCOVE
68. PRESERVE DRAW
69. PRESERVE TR.
70. ALYSSA RD.
71. PENDRYN HILL ALCOVE
72. PENDRYN HILL BAY
73. PENDRYN HILL CIR.
74. PENDRYN HILL CT.
75. PENDRYN HILL OVERLOOK
76. DONCASTER WAY
77. COPPER OAKS ALCOVE
78. EAGLE TRACE LA.
79. CORTLAND ALCOVE
80. SUMMER WIND RD.
81. SUMMER WIND BAY
82. SUMMER WIND ALCOVE
83. SUMMER WIND CIR.
84. SPRING VIEW WAY
85. SPRING VIEW ALCOVE
86. SPRING LA.
87. COBBLE HILL ALCOVE
88. CORNELIA TR.
89. COBBLE HILL CT.
90. GRAND BROOK CT.
91. GRAND ISLE PL.
92. GRAND RESERVE BLVD.
93. FEATHER RIDGE CIR.
94. HOMESTEAD LA.
95. QUINCY WAY
96. ADDISON WAY
97. STERLING ALCOVE
98. MULBERRY ALCOVE
99. TRAVERSE CIR.
100. COTTAGE GROVE RIDGE