

2007 TRAFFIC VOLUMES  
(SEE NOTE)

MUNICIPALITY OF  
**SAINT FRANCIS**

PREPARED BY THE  
MINNESOTA DEPARTMENT OF TRANSPORTATION  
ENGINEERING SERVICES DIVISION  
IN COOPERATION WITH  
U.S. DEPARTMENT OF TRANSPORTATION  
FEDERAL HIGHWAY ADMINISTRATION

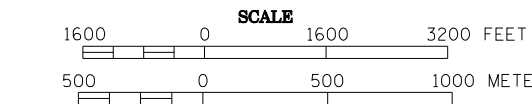

2007  
BASIC DATA - 1990

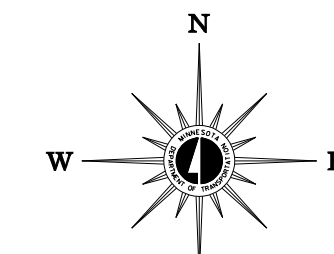

**LEGEND**

- INTERSTATE TRUNK HIGHWAY.....(5)
- U.S. TRUNK HIGHWAY.....(55)
- STATE TRUNK HIGHWAY.....(51)
- COUNTY STATE AID HIGHWAY.....(2)
- COUNTY ROAD.....(4)
- CORPORATE LIMITS.....
- PUBLIC ROAD.....
- PRIVATE ROAD.....

**MUNICIPAL STATE AID STREET SYSTEM**

**LEGEND**

- MUNICIPAL COUNTY STATE AID STREET.....
- MUNICIPAL STATE AID STREET.....
- COUNTY STATE AID HIGHWAY.....
- COUNTY ROAD.....
- TRUNK HIGHWAY.....

VOLUMES PREPARED BY  
THE OFFICE OF  
TRANSPORTATION DATA & ANALYSIS

NUMERALS INDICATE AVERAGE DAILY  
TRAFFIC VOLUMES ON DESIGNATED ROADS.

TRUNK HIGHWAY ROUTES ARE 2006 A.A.D.T. VOLUMES  
COUNTY SYSTEM ROADS ARE 2007 A.A.D.T. VOLUMES  
MUNICIPAL STREET ROUTES ARE 2007 A.A.D.T. VOLUMES

FOR DESIGNATED ROADS:  
/ = SEGMENT ENDPOINT FOR ALL  
ROADS INTERSECTED BY HATCH  
( = SEGMENT ENDPOINT ONLY FOR  
ROAD SEPARATED FROM INTERSECTING  
ROAD BY ARC

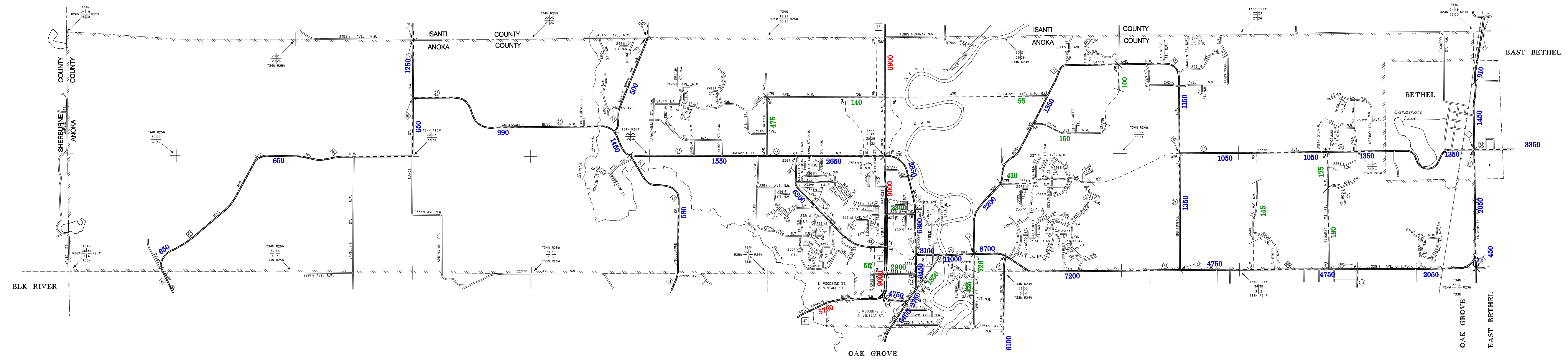

TRAFFIC VOLUMES ARE SUBJECT TO VARIABILITY AND CONSTRUCTION EFFECTS

FOR MORE INFO VISIT: <http://www.dot.state.mn.us/traffic/data/html/aadt.html>