

2005 TRAFFIC VOLUMES

MUNICIPALITIES OF SWIFT CO.

PREPARED BY THE MINNESOTA DEPARTMENT OF TRANSPORTATION OFFICE OF TRANSPORTATION DATA & ANALYSIS IN COOPERATION WITH U.S. DEPARTMENT OF TRANSPORTATION FEDERAL HIGHWAY ADMINISTRATION

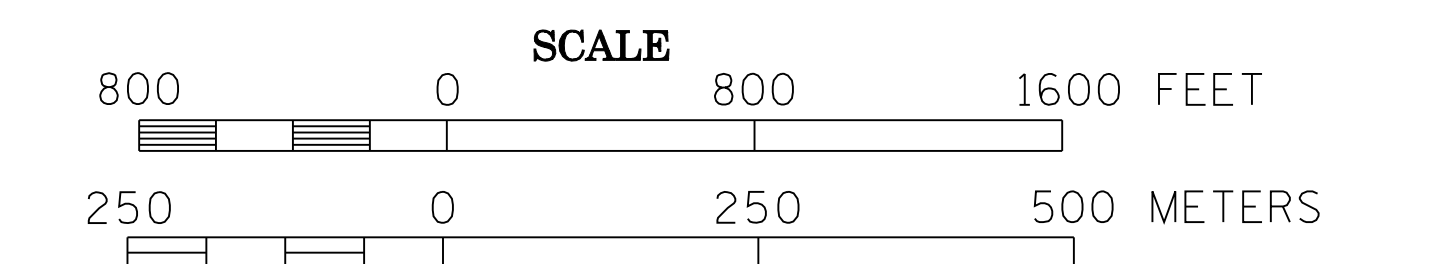

2005 BASIC DATA - 1977

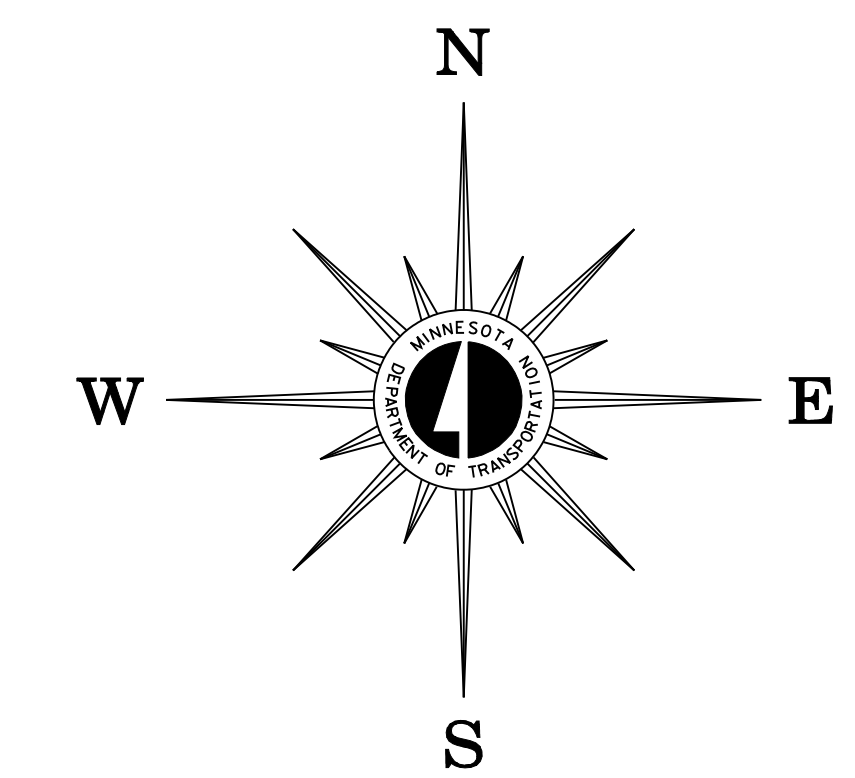

LEGEND

- INTERSTATE TRUNK HIGHWAY..... (35)
- U.S. TRUNK HIGHWAY..... (10)
- STATE TRUNK HIGHWAY..... (55)
- COUNTY STATE AID HIGHWAY..... (2)
- COUNTY ROAD..... (1)
- PUBLIC ROAD.....
- PRIVATE ROAD.....
- CORPORATE LIMITS.....

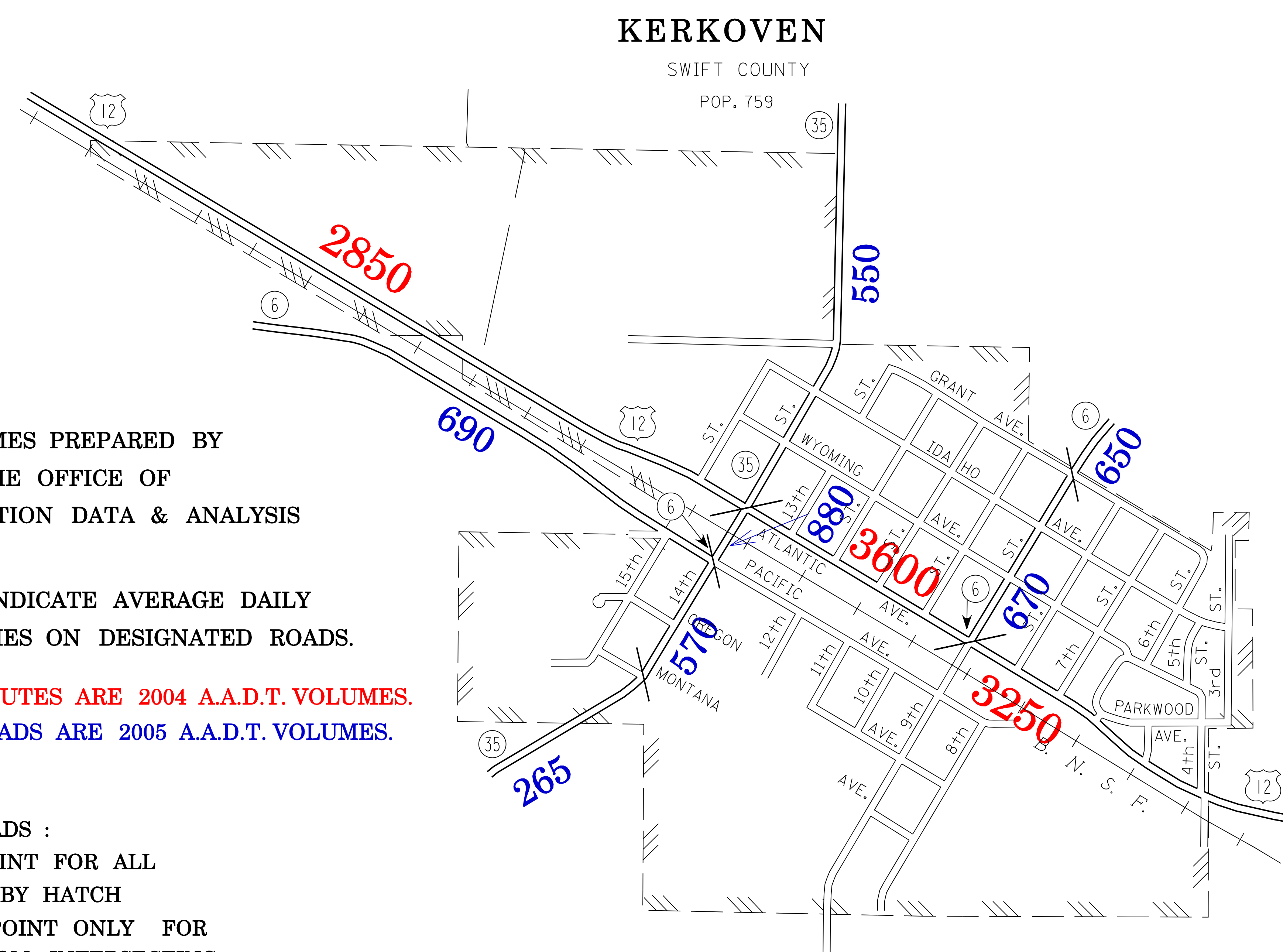
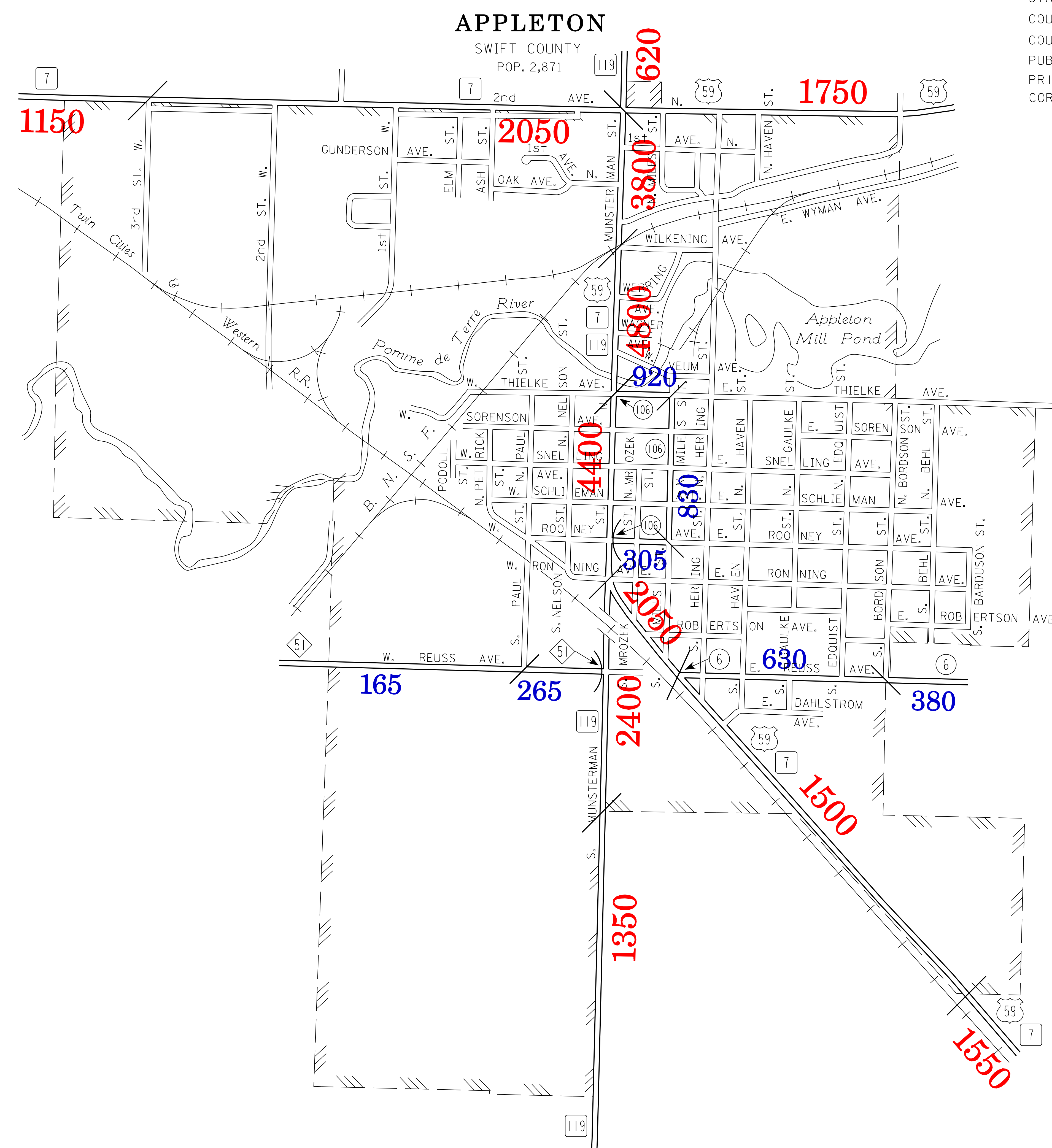
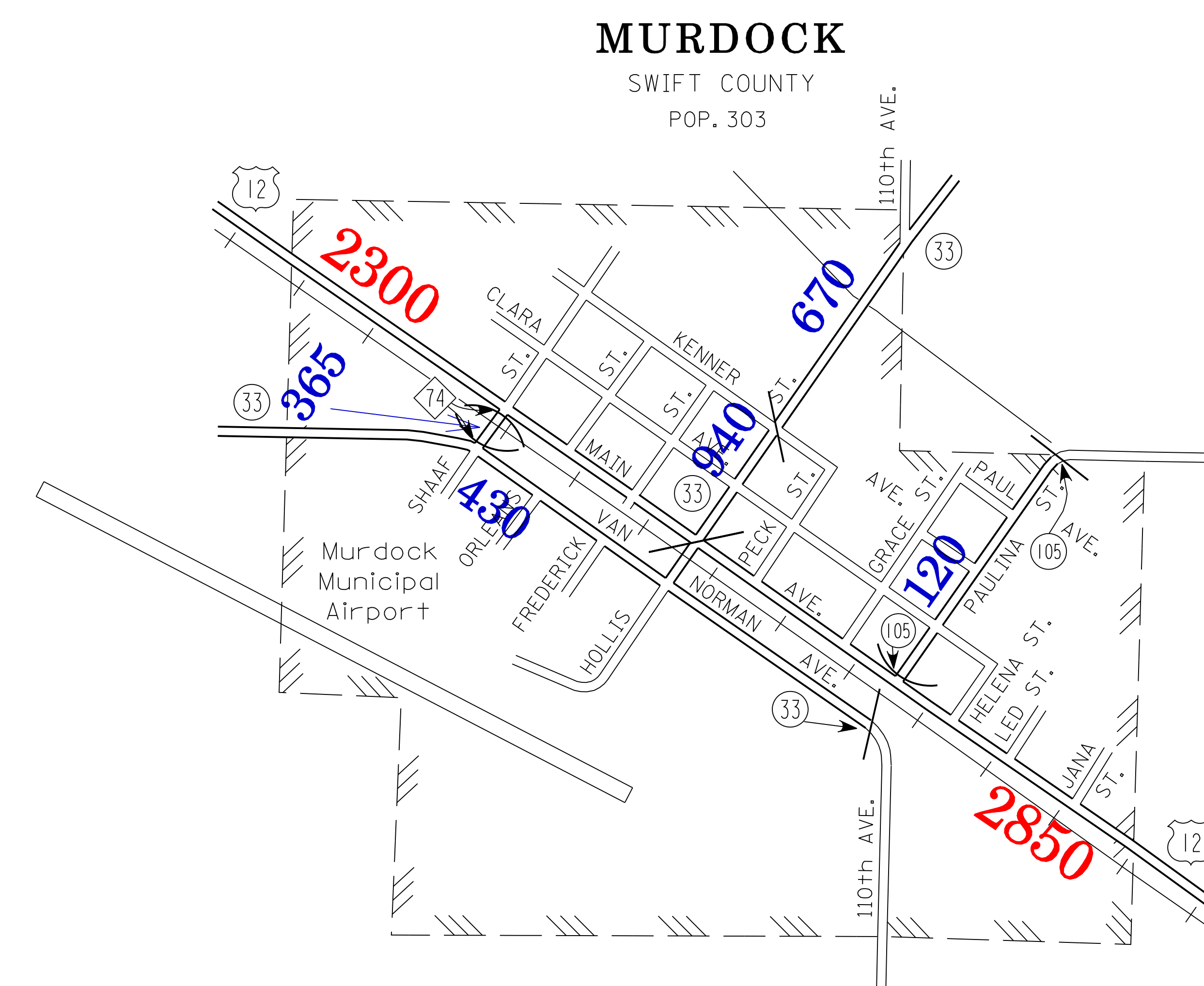
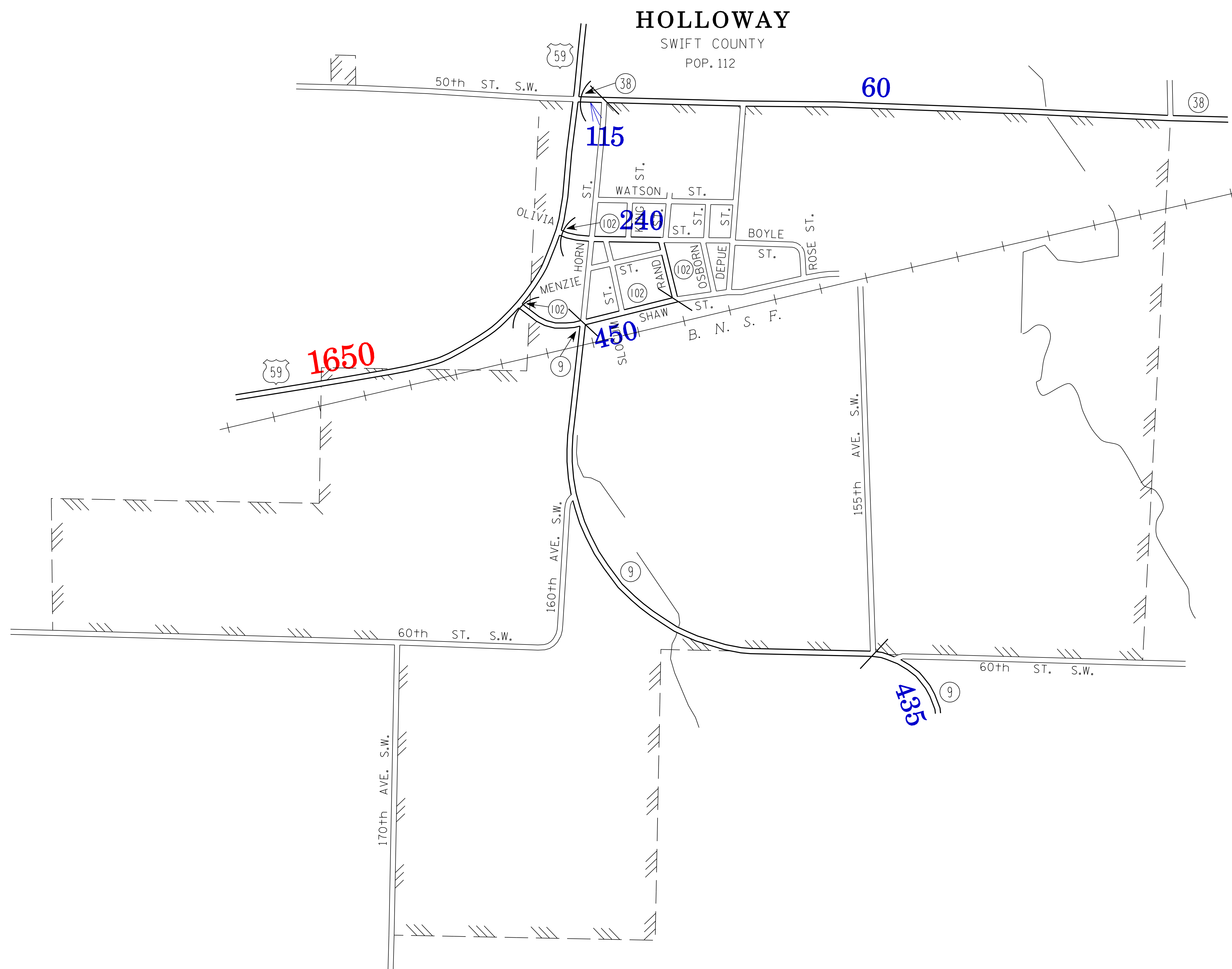

VOLUMES PREPARED BY THE OFFICE OF TRANSPORTATION DATA & ANALYSIS

NUMERALS INDICATE AVERAGE DAILY TRAFFIC VOLUMES ON DESIGNATED ROADS.

TRUNK HIGHWAY ROUTES ARE 2004 A.A.D.T. VOLUMES. COUNTY SYSTEM ROADS ARE 2005 A.A.D.T. VOLUMES.

FOR DESIGNATED ROADS :
 / = SEGMENT ENDPOINT FOR ALL ROADS INTERSECTED BY HATCH
 (= SEGMENT ENDPOINT ONLY FOR ROAD SEPARATED FROM INTERSECTING ROAD BY ARC

MUNICIPALITIES SHOWN ON THIS SHEET
 APPLETON
 HOLLOWAY
 KERKOVEN
 MURDOCK

NOTE: 2000 U.S. CENSUS FIGURES SHOWN FOR ALL MUNICIPALITIES UNLESS OTHERWISE STATED.