

2005 TRAFFIC VOLUMES
 MUNICIPALITIES OF
MORRISON CO.
 PREPARED BY THE
 MINNESOTA DEPARTMENT OF TRANSPORTATION
 OFFICE OF TRANSPORTATION DATA & ANALYSIS
 IN COOPERATION WITH
 U.S. DEPARTMENT OF TRANSPORTATION
 FEDERAL HIGHWAY ADMINISTRATION

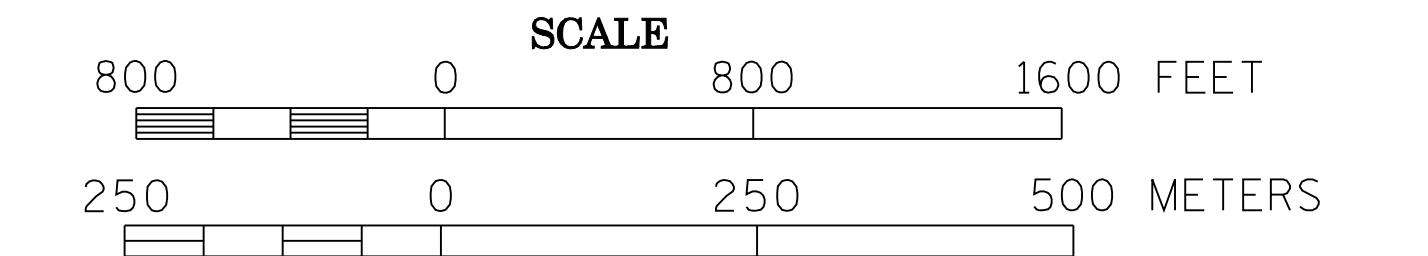

2005
 BASIC DATA - 1977

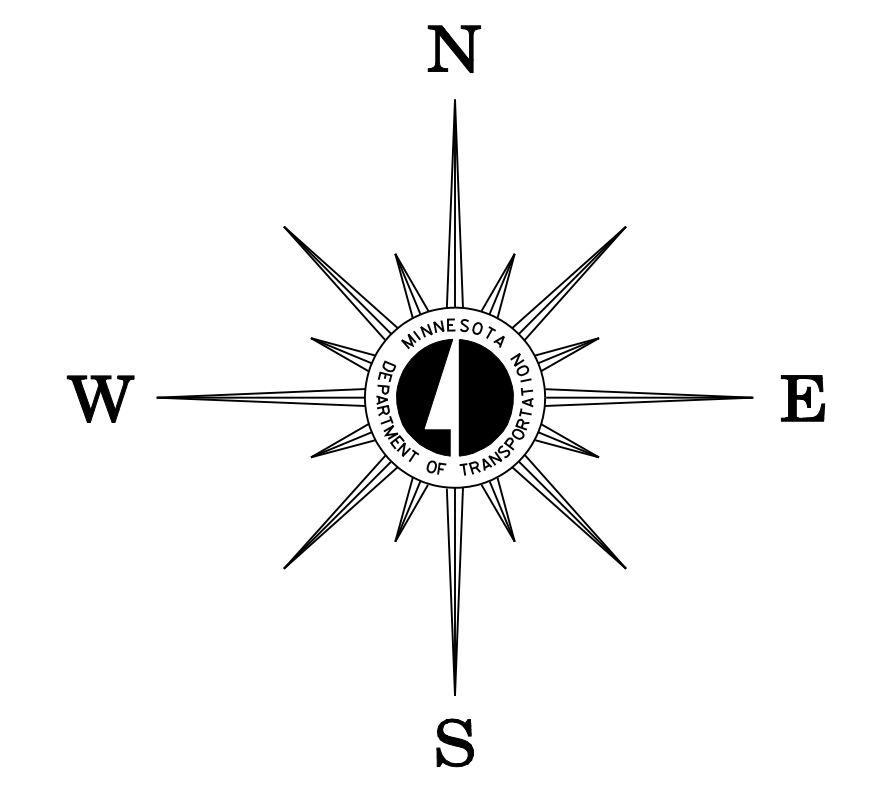

LEGEND

- INTERSTATE TRUNK HIGHWAY..... (I)
- U. S. TRUNK HIGHWAY..... (U)
- STATE TRUNK HIGHWAY..... (S)
- COUNTY STATE AID HIGHWAY..... (C)
- COUNTY ROAD..... (R)
- PUBLIC ROAD..... (P)
- PRIVATE ROAD..... (PR)
- CORPORATE LIMITS..... (H)

VOLUMES PREPARED BY
 THE OFFICE OF
 TRANSPORTATION DATA & ANALYSIS

NUMERALS INDICATE AVERAGE DAILY
 TRAFFIC VOLUMES ON DESIGNATED ROADS.

TRUNK HIGHWAY ROUTES ARE 2004 A.A.D.T. VOLUMES.
 COUNTY SYSTEM ROADS ARE 2005 A.A.D.T. VOLUMES.

FOR DESIGNATED ROADS :
 / = SEGMENT ENDPOINT FOR ALL
 ROADS INTERSECTED BY HATCH
 (= SEGMENT ENDPOINT ONLY FOR
 ROAD SEPARATED FROM INTERSECTING
 ROAD BY ARC

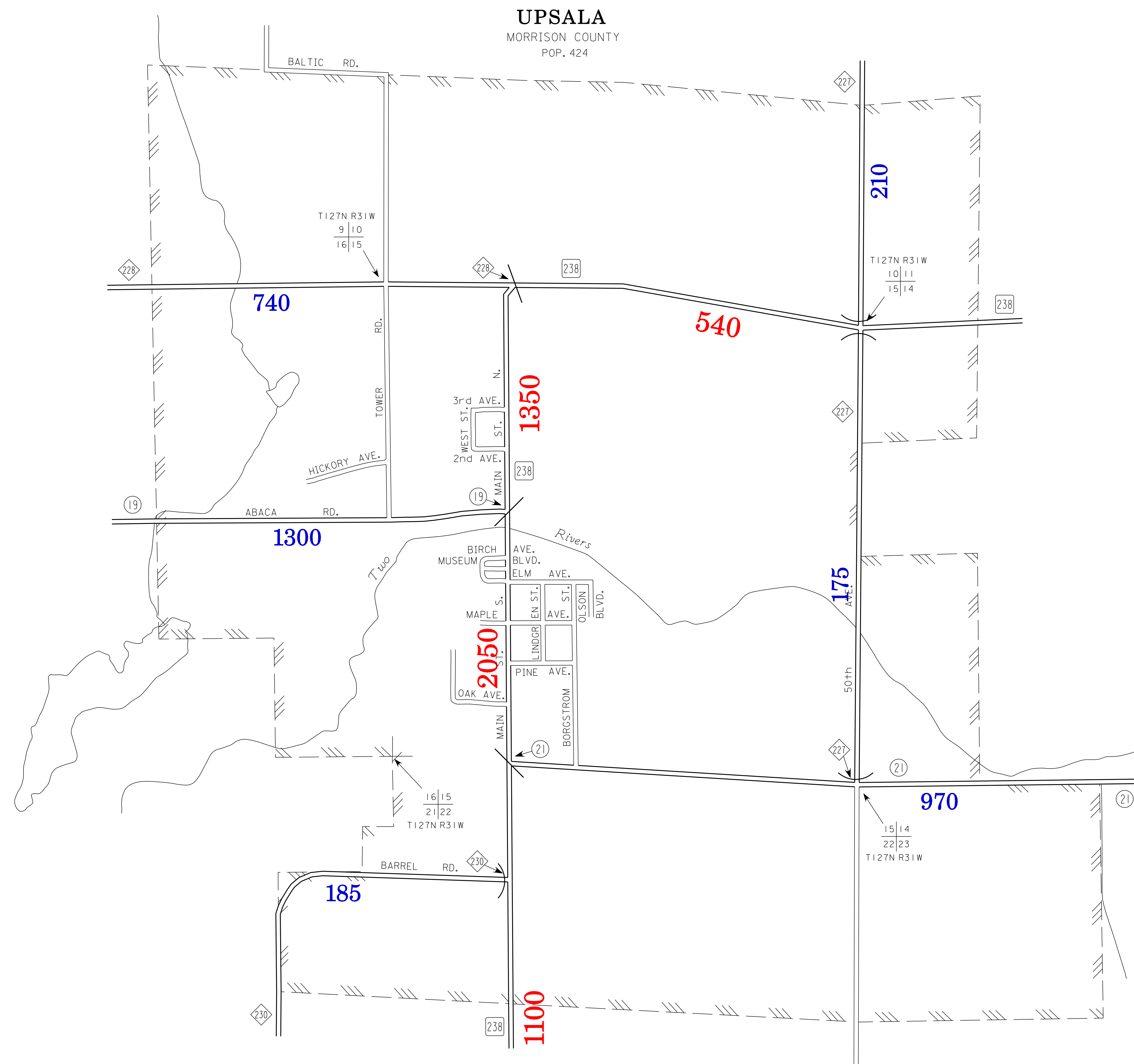

MUNICIPALITIES SHOWN
 ON THIS SHEET
 UPSALA

NOTE: 2000 U.S. CENSUS FIGURES SHOWN FOR ALL MUNICIPALITIES UNLESS OTHERWISE STATED.