

CHICKAMAW BEACH
 CASS COUNTY
 POP. 148

2005 TRAFFIC VOLUMES

MUNICIPALITIES OF CASS CO.

PREPARED BY THE
MINNESOTA DEPARTMENT OF TRANSPORTATION
 OFFICE OF TRANSPORTATION DATA & ANALYSIS
 IN COOPERATION WITH
U.S. DEPARTMENT OF TRANSPORTATION
 FEDERAL HIGHWAY ADMINISTRATION

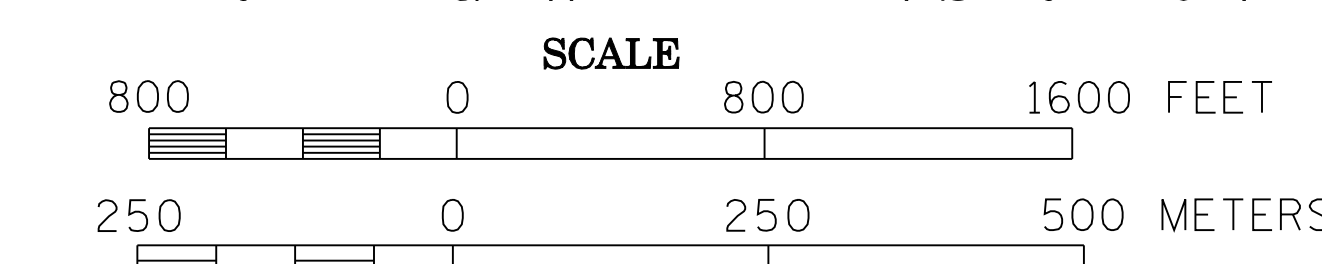

2005
 BASIC DATA - 1977

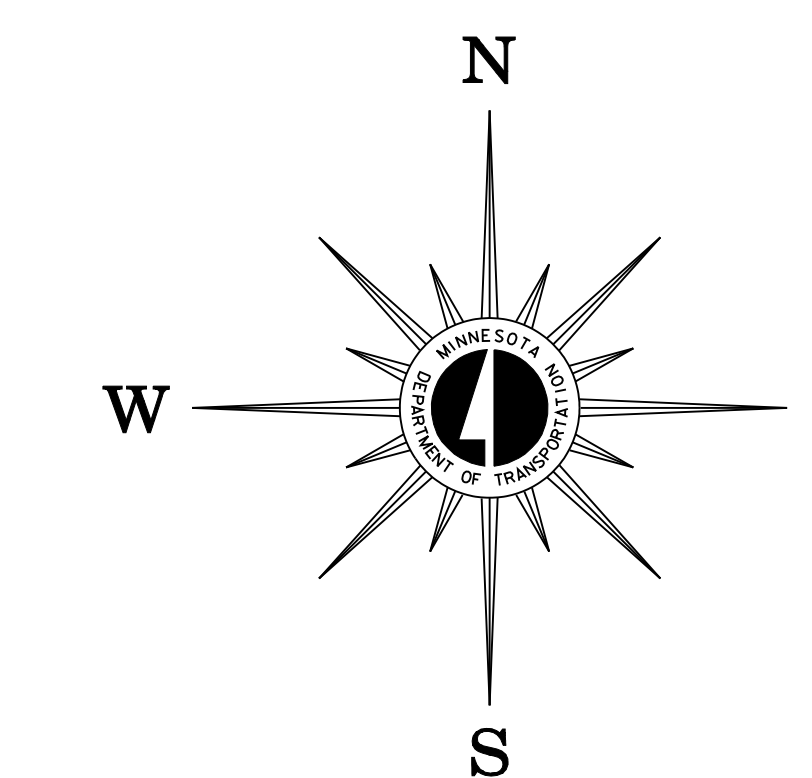

LEGEND

- INTERSTATE TRUNK HIGHWAY..... (35)
- U.S. TRUNK HIGHWAY..... (10)
- STATE TRUNK HIGHWAY..... (55)
- COUNTY STATE AID HIGHWAY..... (2)
- COUNTY ROAD..... (15)
- PUBLIC ROAD.....
- PRIVATE ROAD.....
- CORPORATE LIMITS.....

VOLUMES PREPARED BY
 THE OFFICE OF
 TRANSPORTATION DATA & ANALYSIS

NUMERALS INDICATE AVERAGE DAILY
 TRAFFIC VOLUMES ON DESIGNATED ROADS.

TRUNK HIGHWAY ROUTES ARE 2004 A.A.D.T. VOLUMES.
COUNTY SYSTEM ROADS ARE 2005 A.A.D.T. VOLUMES.

FOR DESIGNATED ROADS :
 / = SEGMENT ENDPOINT FOR ALL
 ROADS INTERSECTED BY HATCH
 (= SEGMENT ENDPOINT ONLY FOR
 ROAD SEPARATED FROM INTERSECTING
 ROAD BY ARC

MUNICIPALITIES SHOWN
 ON THIS SHEET
 CHICKAMAW BEACH
 PINE RIVER

MOTLEY:
 See Morrison Co.
 Sheet 3 of 5

NOTE: 2000 U.S. CENSUS FIGURES SHOWN FOR ALL MUNICIPALITIES UNLESS OTHERWISE STATED.

Municipalities under 5000 pop. in CASS COUNTY
 SHEET 5 OF 5

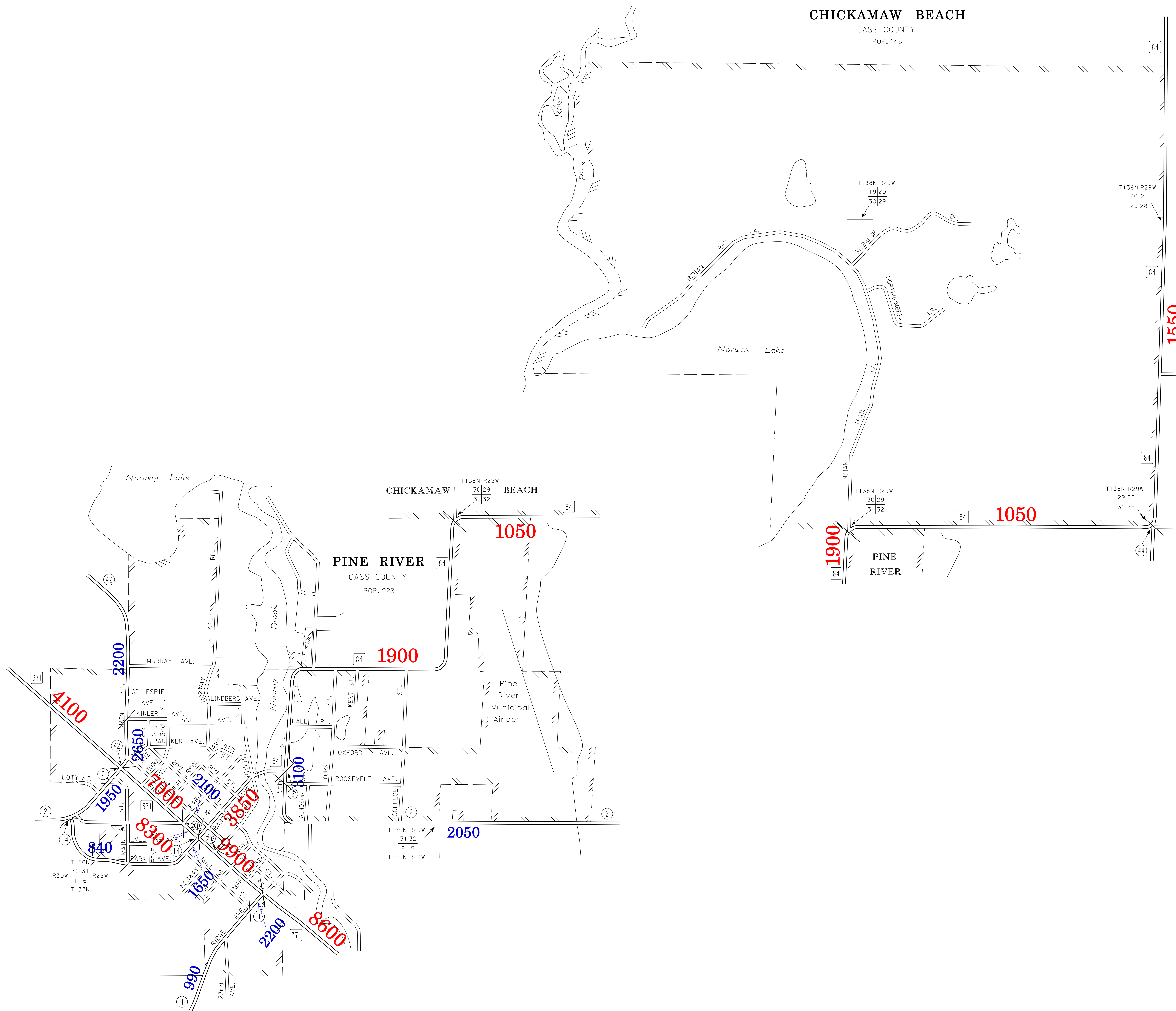

1550

1050

1900

1900

1050

PINE RIVER
 CASS COUNTY
 POP. 928

4100

2200

2650

7000

2100

3850

3100

2050

840

1950

8300

1650

9900

2200

8600

990