

2005 TRAFFIC VOLUMES

MUNICIPALITIES OF BLUE EARTH CO.

PREPARED BY THE
MINNESOTA DEPARTMENT OF TRANSPORTATION
 OFFICE OF TRANSPORTATION DATA & ANALYSIS
 IN COOPERATION WITH
U.S. DEPARTMENT OF TRANSPORTATION
 FEDERAL HIGHWAY ADMINISTRATION

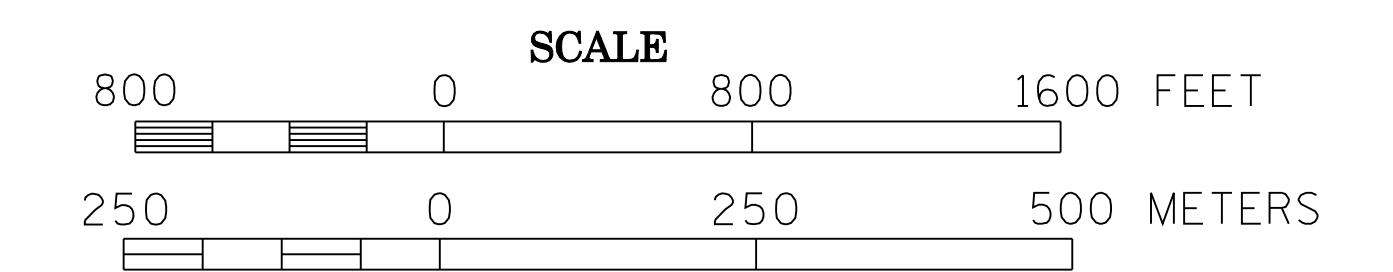

2005
 BASIC DATA - 1990

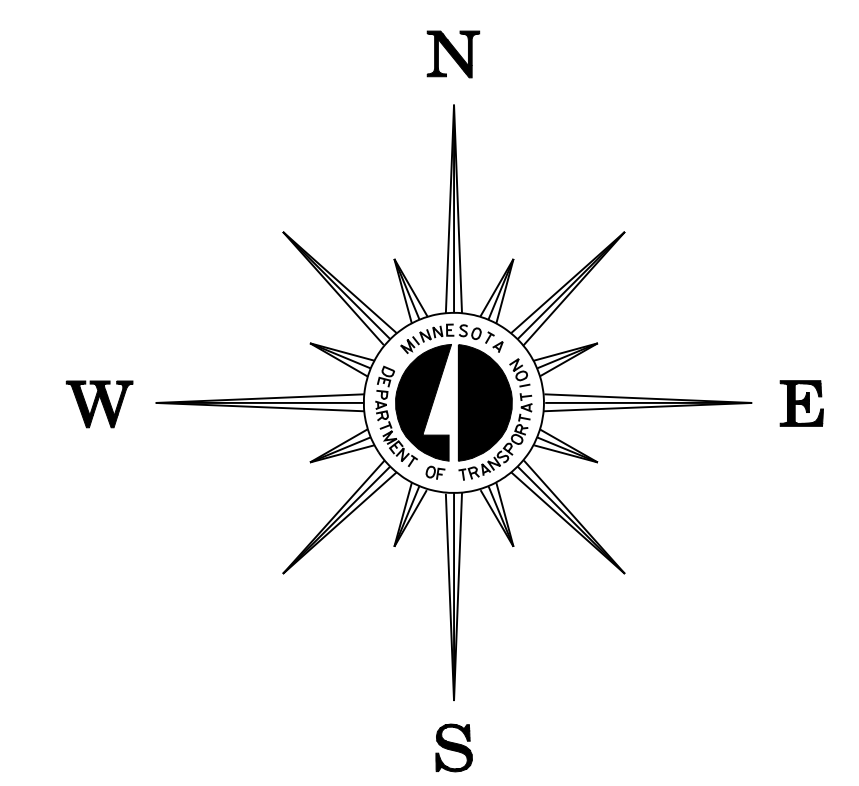

LEGEND

- INTERSTATE TRUNK HIGHWAY..... (I-95)
- U.S. TRUNK HIGHWAY..... (US-10)
- STATE TRUNK HIGHWAY..... (ST-15)
- COUNTY STATE AID HIGHWAY..... (CSA-2)
- COUNTY ROAD..... (CR-12)
- PUBLIC ROAD..... (PR-1)
- PRIVATE ROAD..... (PR-1)
- CORPORATE LIMITS.....

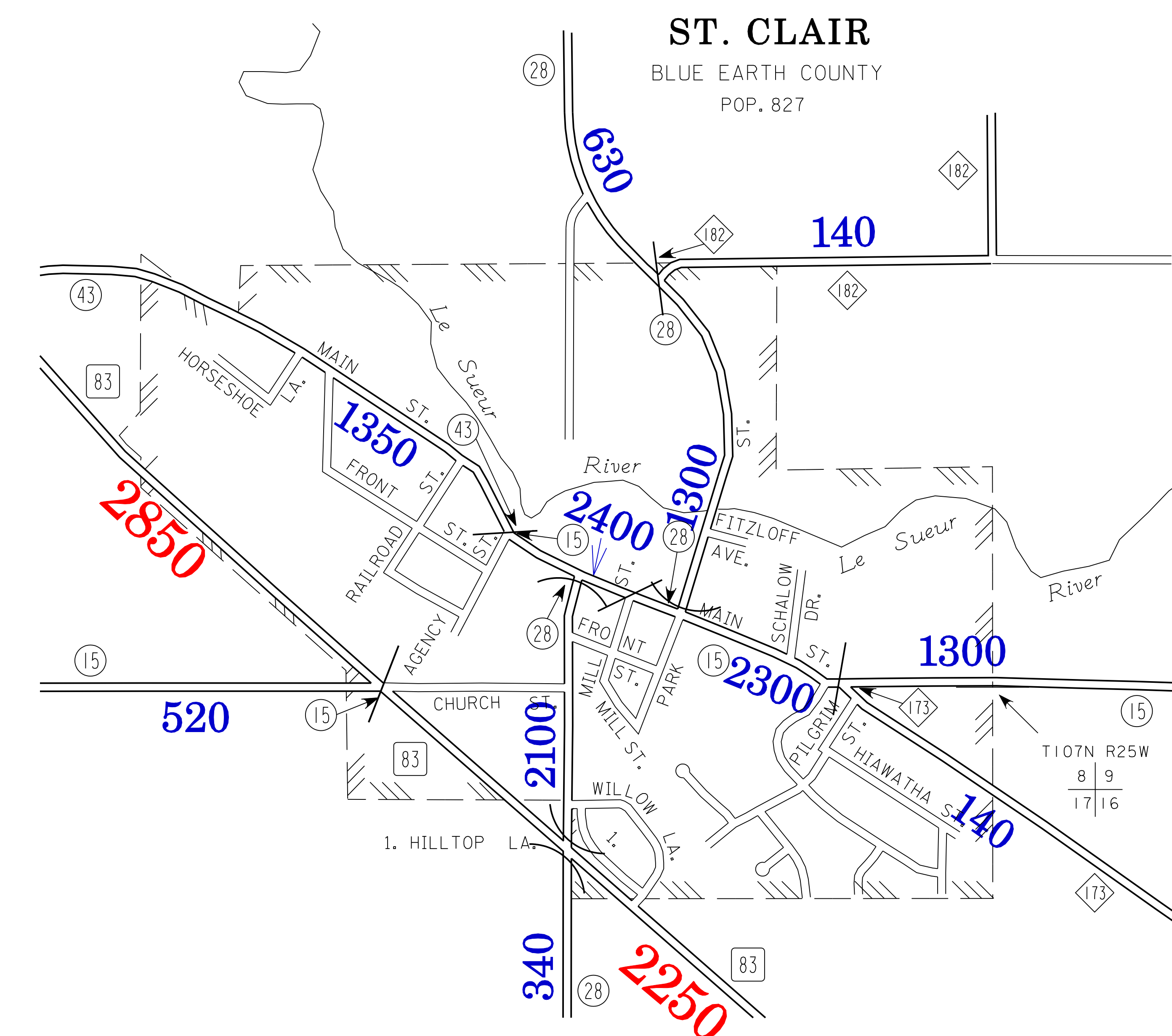
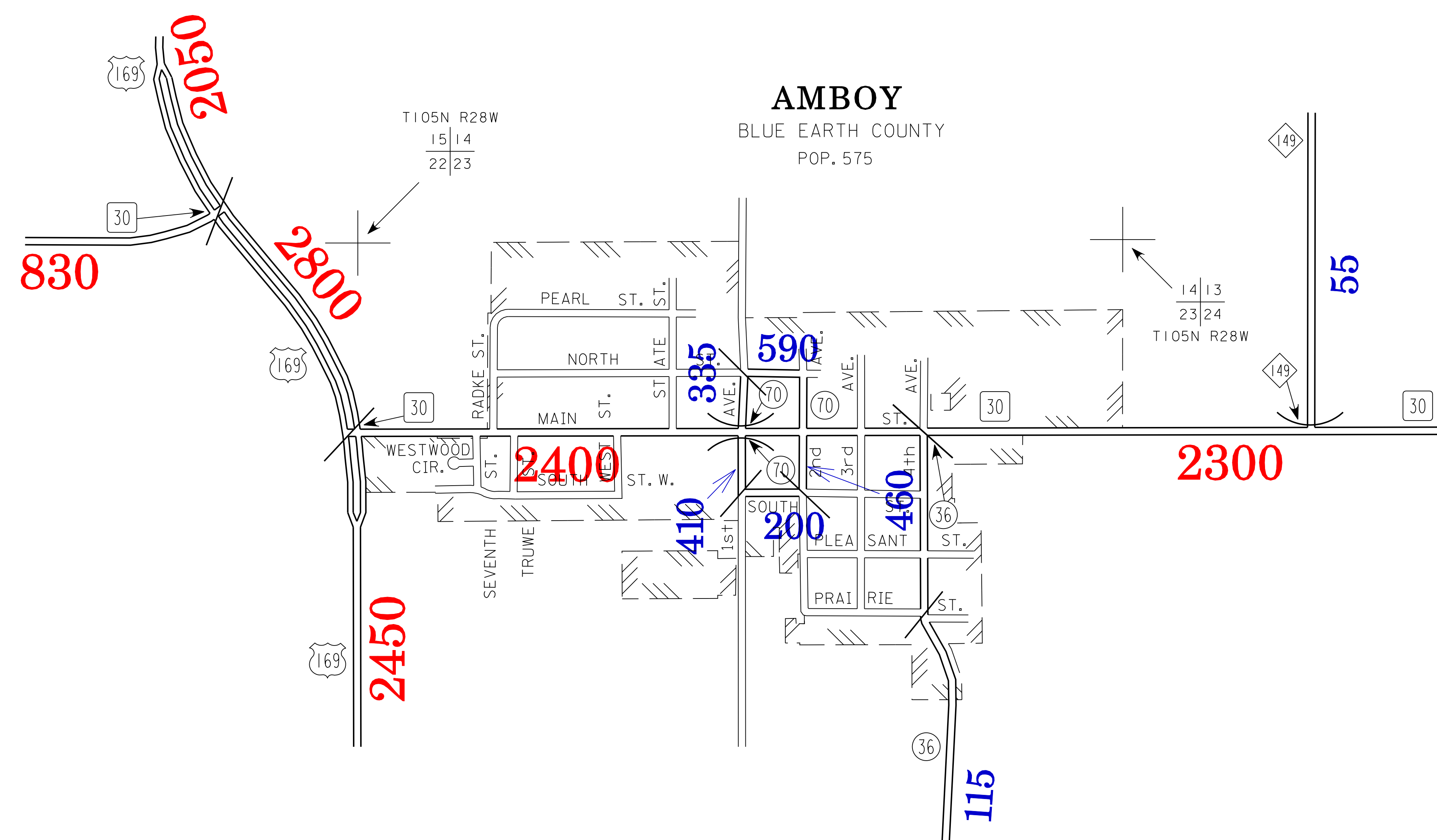
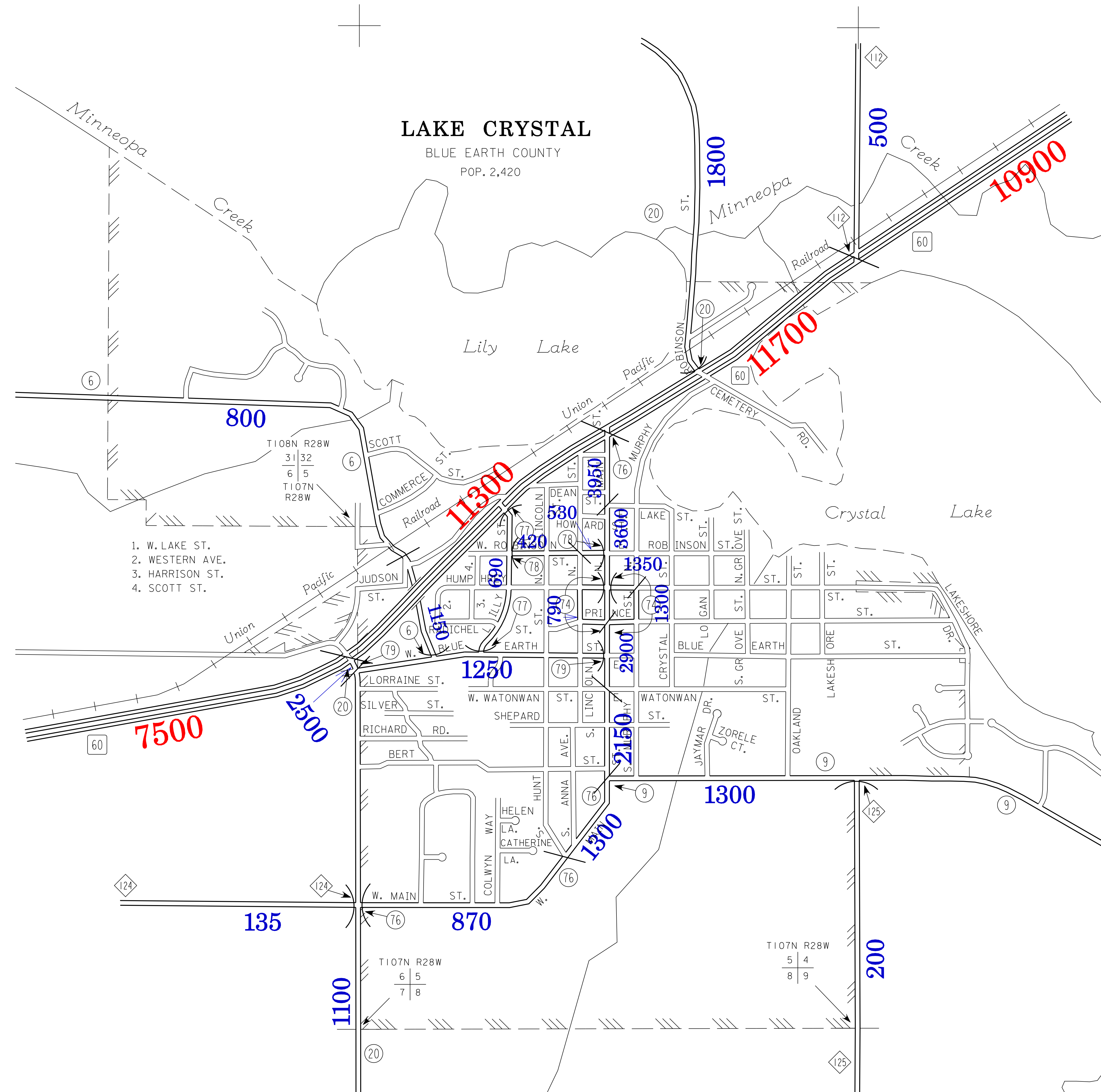

VOLUMES PREPARED BY
 THE OFFICE OF
 TRANSPORTATION DATA & ANALYSIS

NUMERALS INDICATE AVERAGE DAILY
 TRAFFIC VOLUMES ON DESIGNATED ROADS.

TRUNK HIGHWAY ROUTES ARE 2004 A.A.D.T. VOLUMES.
 COUNTY SYSTEM ROADS ARE 2005 A.A.D.T. VOLUMES.

FOR DESIGNATED ROADS :
 / = SEGMENT ENDPOINT FOR ALL
 ROADS INTERSECTED BY HATCH
 (= SEGMENT ENDPOINT ONLY FOR
 ROAD SEPARATED FROM INTERSECTING
 ROAD BY ARC

MUNICIPALITIES SHOWN
 ON THIS SHEET
 AMBOY
 LAKE CRYSTAL
 ST. CLAIR

NOTE: 2000 U.S. CENSUS FIGURES SHOWN FOR ALL MUNICIPALITIES UNLESS OTHERWISE STATED.