

2003 TRAFFIC VOLUMES

MUNICIPALITIES OF  
**NICOLLET CO.**

PREPARED BY THE  
MINNESOTA DEPARTMENT OF TRANSPORTATION  
PROGRAM SUPPORT GROUP  
IN COOPERATION WITH  
U.S. DEPARTMENT OF TRANSPORTATION  
FEDERAL HIGHWAY ADMINISTRATION

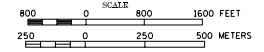

2003  
BASIC DATA - 1977

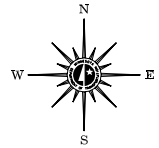

LEGEND

- INTERSTATE TRUNK HIGHWAY.....(I)
- U.S. TRUNK HIGHWAY.....(U.S.)
- STATE TRUNK HIGHWAY.....(S.T.H.)
- COUNTY STATE AID HIGHWAY.....(C.S.A.H.)
- COUNTY ROAD.....(C.R.)
- PUBLIC ROAD.....(P.R.)
- PRIVATE ROAD.....(P.R.)
- CORPORATE LIMITS.....(---)

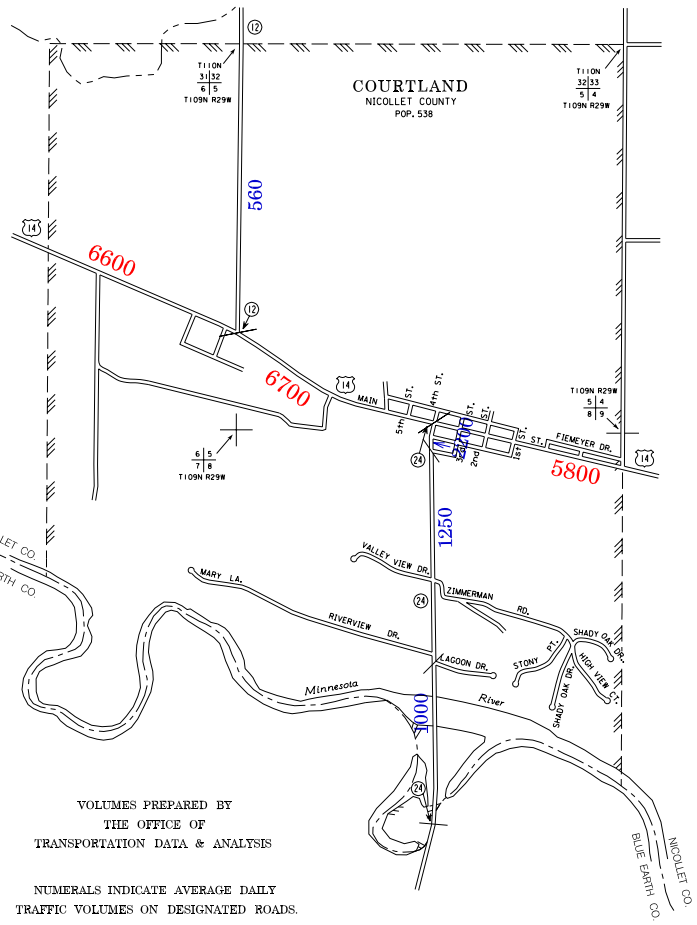

VOLUMES PREPARED BY  
THE OFFICE OF  
TRANSPORTATION DATA & ANALYSIS

NUMERALS INDICATE AVERAGE DAILY  
TRAFFIC VOLUMES ON DESIGNATED ROADS.

TRUNK HIGHWAY ROUTES ARE 2002 A.A.D.T. VOLUMES.  
COUNTY SYSTEM ROADS ARE 2003 A.A.D.T. VOLUMES.

FOR DESIGNATED ROADS:  
/ = SEGMENT ENDPOINT FOR ALL  
ROADS INTERSECTED BY HATCH  
- = SEGMENT ENDPOINT ONLY FOR  
ROAD SEPARATED FROM INTERSECTING  
ROAD BY ARC

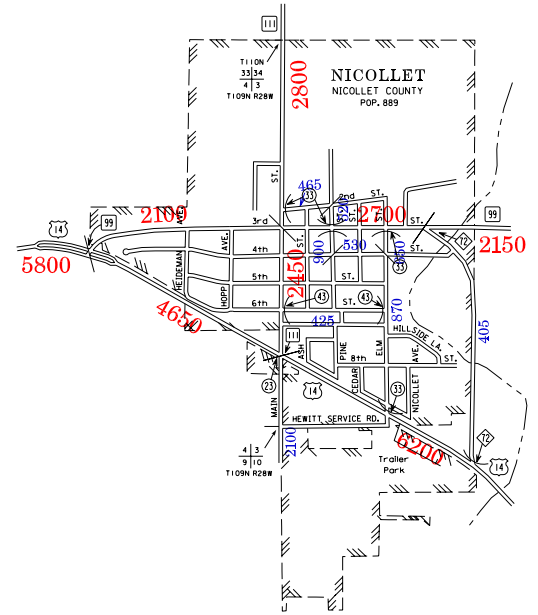
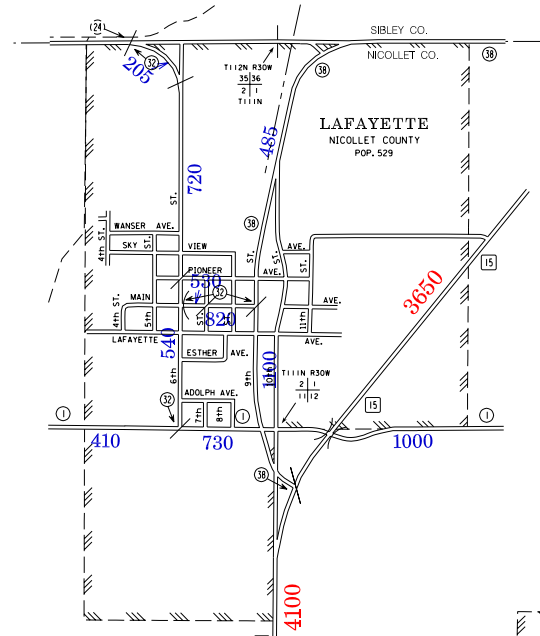

MUNICIPALITIES SHOWN  
ON THIS SHEET  
COURTLAND  
LAFAYETTE  
NICOLLET

NOTE: 2000 U.S. CENSUS FIGURES SHOWN FOR ALL MUNICIPALITIES UNLESS OTHERWISE STATED.