

2003 TRAFFIC VOLUMES

MUNICIPALITIES OF
GOODHUE CO.

PREPARED BY THE
MINNESOTA DEPARTMENT OF TRANSPORTATION
PROGRAM SUPPORT GROUP

U.S. DEPARTMENT OF TRANSPORTATION
IN COOPERATION WITH
FEDERAL HIGHWAY ADMINISTRATION

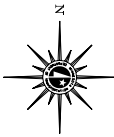

- LEGEND**
- ① INTERSTATE TRUNK HIGHWAY
 - ② U.S. TRUNK HIGHWAY
 - ③ STATE TRUNK HIGHWAY
 - ④ COUNTY ROAD
 - ⑤ PRIVATE ROAD
 - ⑥ CORPORATE LIMITS

CANNON FALLS
GOODHUE COUNTY
POP. 3,795

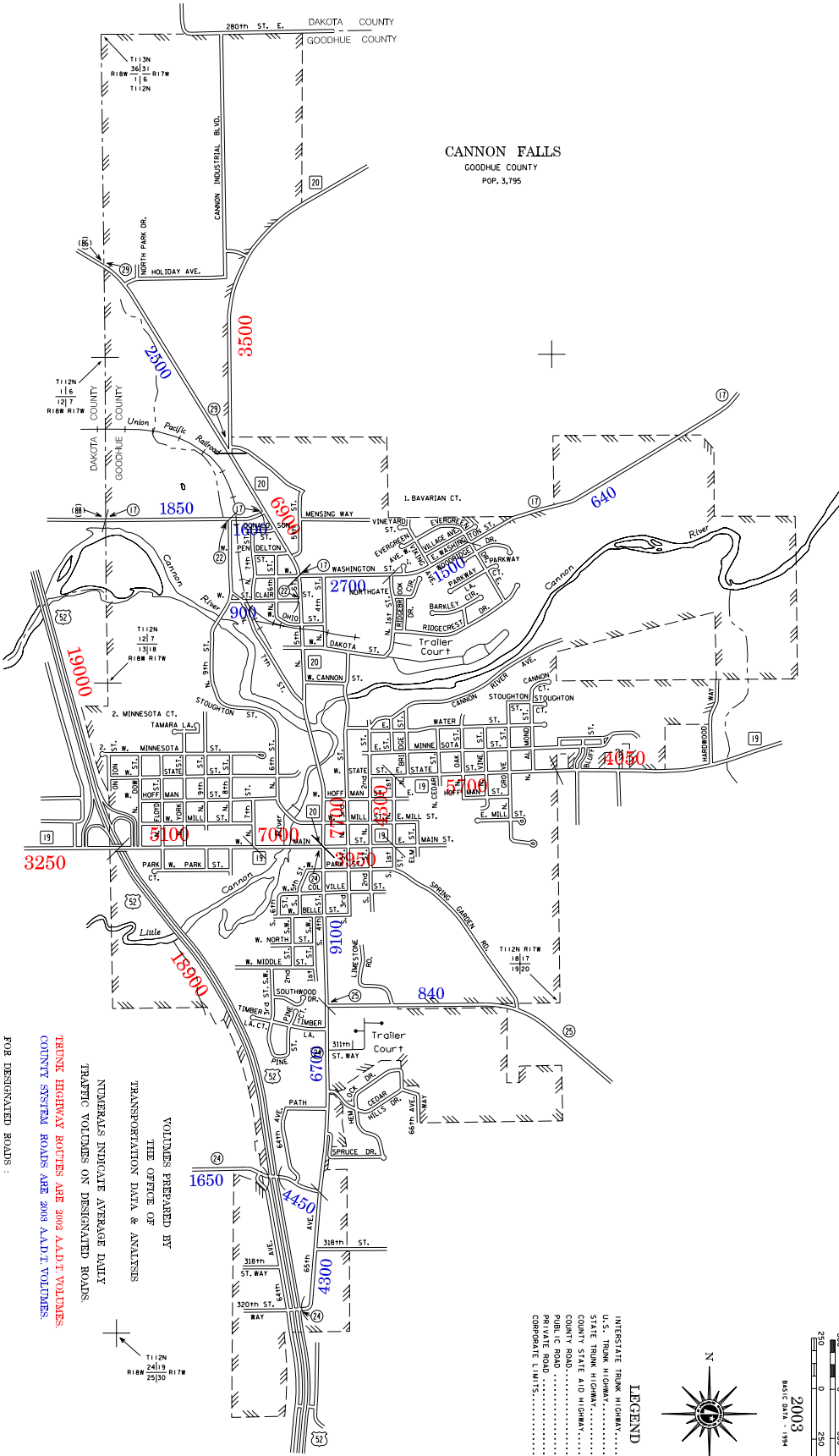

VOLUMES PREPARED BY
THE OFFICE OF
TRANSPORTATION DATA & ANALYSIS

NOTES: INDICATE AVERAGE DAILY
TRAFFIC VOLUMES ON DESIGNATED ROADS.
TRAFFIC VOLUMES ON DESIGNATED ROADS
COUNTY SYSTEM ROADS ARE 2003 AADT VOLUMES.
TRUNK HIGHWAY ROUTES ARE 2002 AADT VOLUMES.

FOR DESIGNATED ROADS:
/ = SEGMENT ENDPOINT FOR ALL
ROADS INTERSECTED BY HIGHWAY
(= SEGMENT ENDPOINT ONLY FOR
ROAD SEPARATED FROM INTERSECTING
ROAD BY ARC