

# 2003 M.S.A.S. TRAFFIC VOLUMES

(SEE NOTE)

MUNICIPALITY OF

## LAKE ELMO

PREPARED BY THE  
MINNESOTA DEPARTMENT OF TRANSPORTATION  
PROGRAM SUPPORT GROUP

IN COOPERATION WITH  
U.S. DEPARTMENT OF TRANSPORTATION  
FEDERAL HIGHWAY ADMINISTRATION

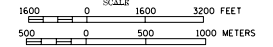

2003  
BASIC DATA - 1990

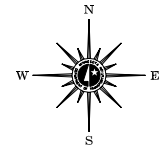

### LEGEND

- INTERSTATE TRUNK HIGHWAY.....
- U.S. TRUNK HIGHWAY.....
- STATE TRUNK HIGHWAY.....
- COUNTY STATE AID HIGHWAY.....
- COUNTY ROAD.....
- CORPORATE LIMITS.....
- PUBLIC ROAD.....
- PRIVATE ROAD.....

### MUNICIPAL STATE AID STREET SYSTEM

#### LEGEND

- MUNICIPAL COUNTY STATE AID STREET.....
- MUNICIPAL STATE AID STREET.....
- COUNTY STATE AID HIGHWAY.....
- COUNTY ROAD.....
- TRUNK HIGHWAY.....

#### NOTE:

A.A.D.T. .... 2500

(AVERAGE ANNUAL DAILY TRAFFIC)

VOLUMES PREPARED BY THE OFFICE OF  
TRANSPORTATION DATA & ANALYSIS

NOTE: TRUNK HIGHWAY ROUTES ARE 2003 TRAFFIC VOLUMES.  
COUNTY SYSTEM ROADS ARE 2003 TRAFFIC VOLUMES.  
MUNICIPAL STREET ROUTES ARE 2003 TRAFFIC VOLUMES.

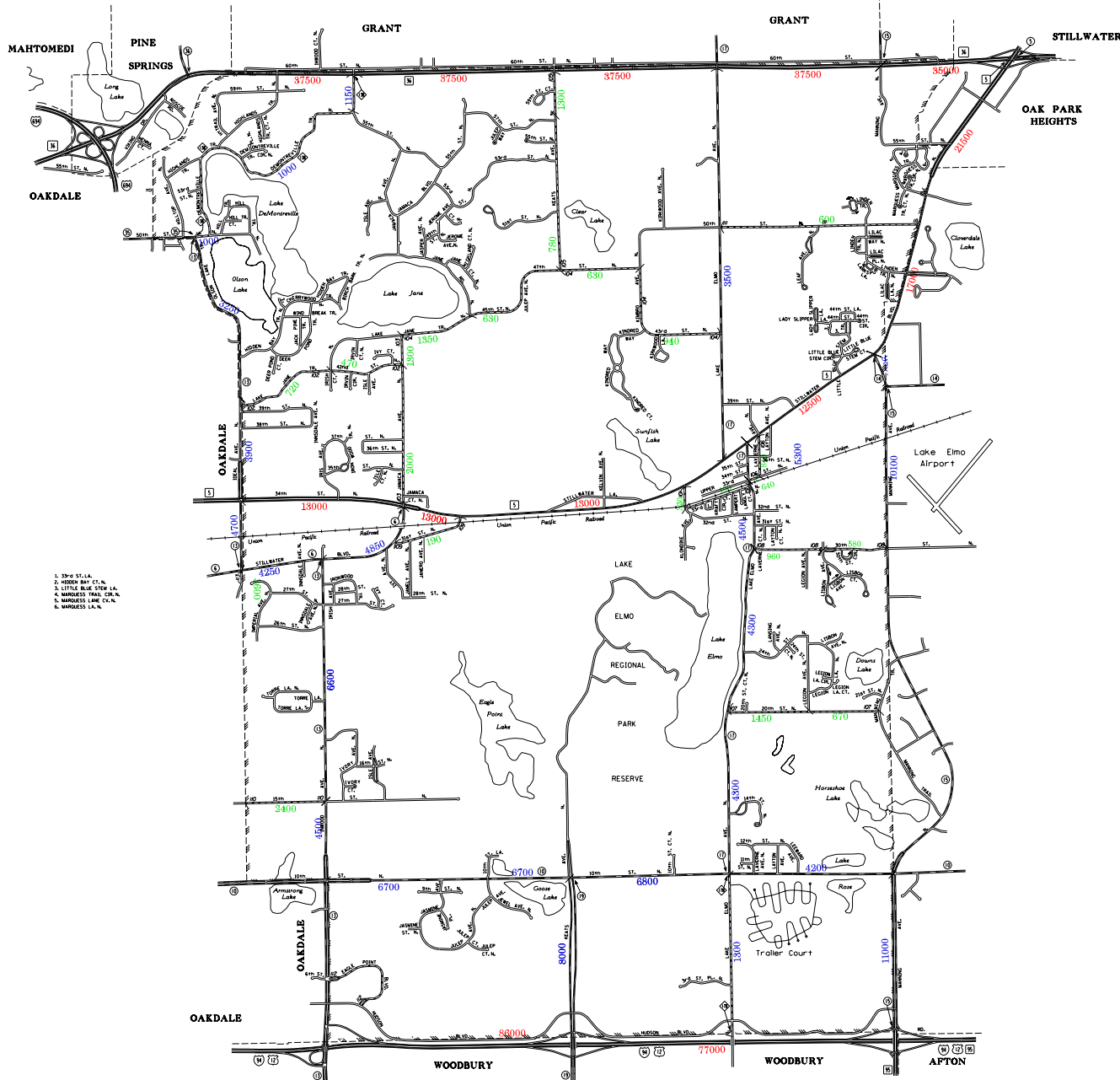

1. 33rd ST. L.A.
2. HOOVER BAY CT. N.
3. LITTLE BLUE ST. W. L.A.
4. MARSHALL TRAIL CR. N.
5. MARSHALL LANE CT. N.
6. MARSHALL L.A. N.