

# 2003 M.S.A.S. TRAFFIC VOLUMES

(SEE NOTE)

## MUNICIPALITY OF BLAINE

PREPARED BY THE  
MINNESOTA DEPARTMENT OF TRANSPORTATION  
PROGRAM SUPPORT GROUP  
IN COOPERATION WITH

U.S. DEPARTMENT OF TRANSPORTATION  
FEDERAL HIGHWAY ADMINISTRATION

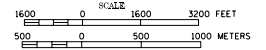

2003  
BASIC DATA - 1990

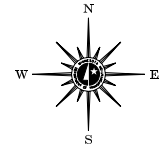

### LEGEND

- INTERSTATE TRUNK HIGHWAY.....
- U.S. TRUNK HIGHWAY.....
- STATE TRUNK HIGHWAY.....
- STATE STATE AID HIGHWAY.....
- COUNTY ROAD.....
- CORPORATE LIMITS.....
- PUBLIC ROAD.....
- PRIVATE ROAD.....

## MUNICIPAL STATE AID STREET SYSTEM

### LEGEND

- MUNICIPAL COUNTY STATE AID STREET.....
- MUNICIPAL STATE AID STREET.....
- COUNTY STATE AID HIGHWAY.....
- COUNTY ROAD.....
- TRUNK HIGHWAY.....

### NOTE:

A.A.D.T. .... 2500

(AVERAGE ANNUAL DAILY TRAFFIC)

VOLUMES PREPARED BY THE OFFICE OF  
TRANSPORTATION DATA & ANALYSIS

NOTE: TRUNK HIGHWAY ROUTES ARE 2002 TRAFFIC VOLUMES.  
COUNTY SYSTEM ROADS ARE 2003 TRAFFIC VOLUMES.  
MUNICIPAL STREET ROUTES ARE 2003 TRAFFIC VOLUMES.

ANDOVER

HAM LAKE

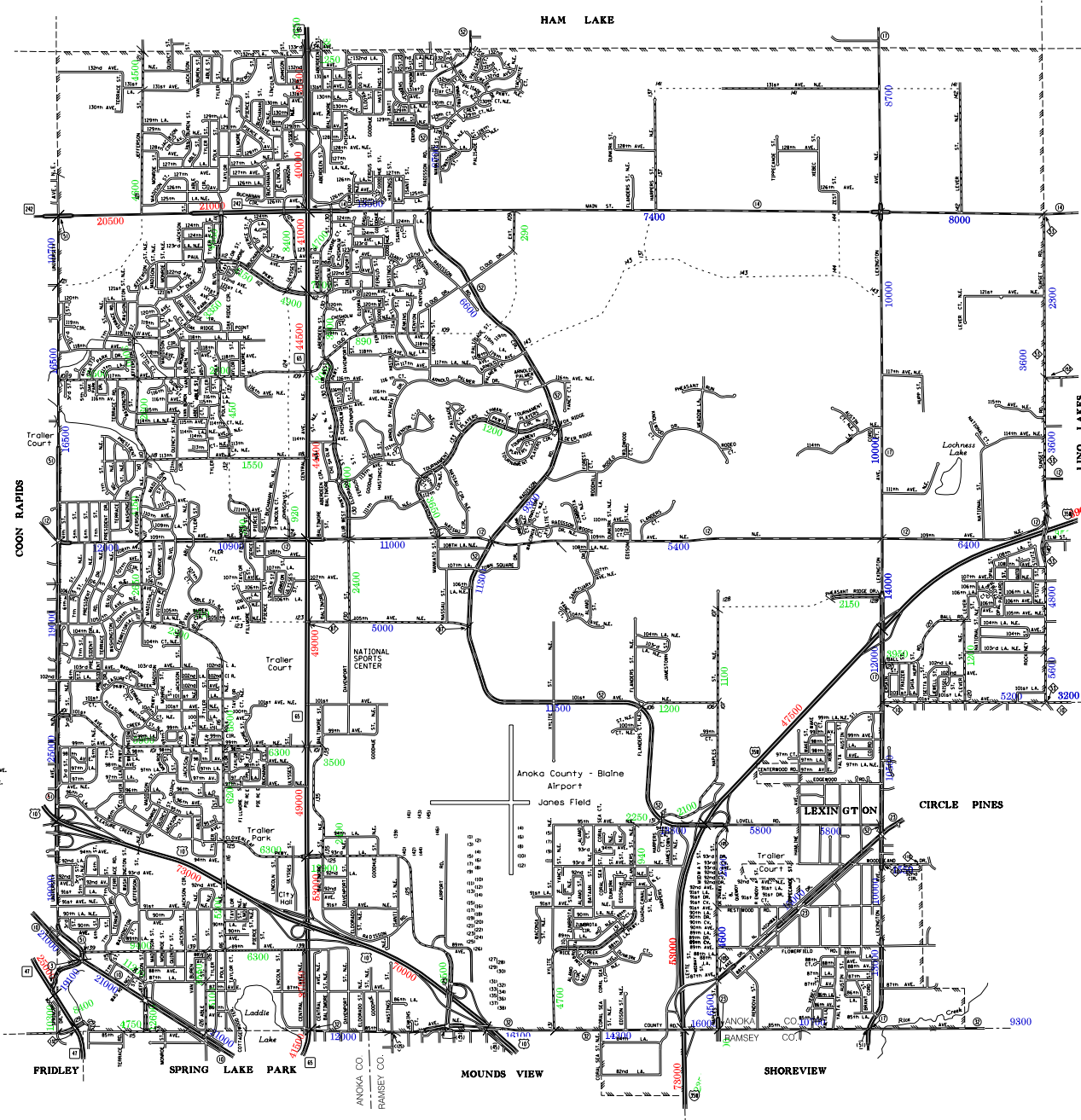

- 1. WYOMING ST.
- 2. MADISON ST.
- 3. DARTMOUTH CT.
- 4. LAYTON CT.
- 5. PIERCE CT. N.E.
- 6. ELWOOD CT. N.E.
- 7. HENNING ST.
- 8. PETERSON ST.
- 9. BAYVIEW CT.
- 10. YANK ST. N.E.

#### Airport Streets

- 121 PENNSYLVANIA AVE.
- 122 OREGON AVE.
- 123 OAKMAN AVE.
- 124 WILSON AVE.
- 125 NORTH DAKOTA AVE.
- 126 NORTH CAROLINA AVE.
- 127 NEW YORK AVE.
- 128 NEW JERSEY AVE.
- 129 NEW MEXICO AVE.
- 130 NEW HAMPSHIRE AVE.
- 131 NEVADA AVE.
- 132 NEWBRUNSWICK AVE.
- 133 MISSOURI AVE.
- 134 MISSOURI AVE.
- 135 MINNESOTA AVE.
- 136 WISCONSIN AVE.
- 137 MASSACHUSETTS AVE.
- 138 MARYLAND AVE.
- 139 MAINE AVE.
- 140 LOUISIANA AVE.
- 141 KENTUCKY AVE.
- 142 IOWA AVE.
- 143 OHIO AVE.
- 144 INDIANA AVE.
- 145 MISSISSIPPI AVE.
- 146 ALABAMA AVE.
- 147 ARIZONA AVE.
- 148 CALIFORNIA AVE.
- 149 COLORADO AVE.
- 150 CONNECTICUT AVE.
- 151 DELAWARE AVE.
- 152 FLORIDA AVE.
- 153 GEORGIA AVE.
- 154 ILLINOIS AVE.
- 155 MICHIGAN AVE.
- 156 NEBRASKA AVE.
- 157 NEW JERSEY AVE.
- 158 NEW YORK AVE.
- 159 NORTH CAROLINA AVE.
- 160 NORTH DAKOTA AVE.
- 161 PENNSYLVANIA AVE.
- 162 VIRGINIA AVE.
- 163 WISCONSIN AVE.
- 164 WYOMING AVE.