

2003 M.S.A.S. TRAFFIC VOLUMES

(SEE NOTE)

MUNICIPALITY OF
ANDOVER

PREPARED BY THE
MINNESOTA DEPARTMENT OF TRANSPORTATION
PROGRAM SUPPORT GROUP
IN COOPERATION WITH
U.S. DEPARTMENT OF TRANSPORTATION
FEDERAL HIGHWAY ADMINISTRATION

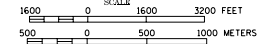

2003
BASIC DATA - 1990

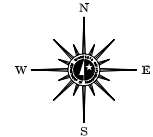

LEGEND

- INTERSTATE TRUNK HIGHWAY..... (I)
- U.S. TRUNK HIGHWAY..... (U)
- STATE TRUNK HIGHWAY..... (S)
- COUNTY STATE AID HIGHWAY..... (C)
- COUNTY ROAD..... (R)
- CORPORATE LIMITS..... (---)
- PUBLIC ROAD..... (—)
- PRIVATE ROAD..... (---)

MUNICIPAL STATE AID
STREET SYSTEM

LEGEND

- MUNICIPAL COUNTY STATE AID STREET..... (—)
- MUNICIPAL STATE AID STREET..... (—)
- COUNTY STATE AID HIGHWAY..... (—)
- COUNTY ROAD..... (—)
- TRUNK HIGHWAY..... (—)

NOTE:

A.A.D.T.....6500

(AVERAGE ANNUAL DAILY TRAFFIC)

VOLUMES PREPARED BY THE OFFICE OF
TRANSPORTATION DATA & ANALYSIS

NOTE: TRUNK HIGHWAY ROUTES ARE 2002 TRAFFIC VOLUMES.
COUNTY SYSTEM ROADS ARE 2003 TRAFFIC VOLUMES.
MUNICIPAL STREET ROUTES ARE 2003 TRAFFIC VOLUMES.

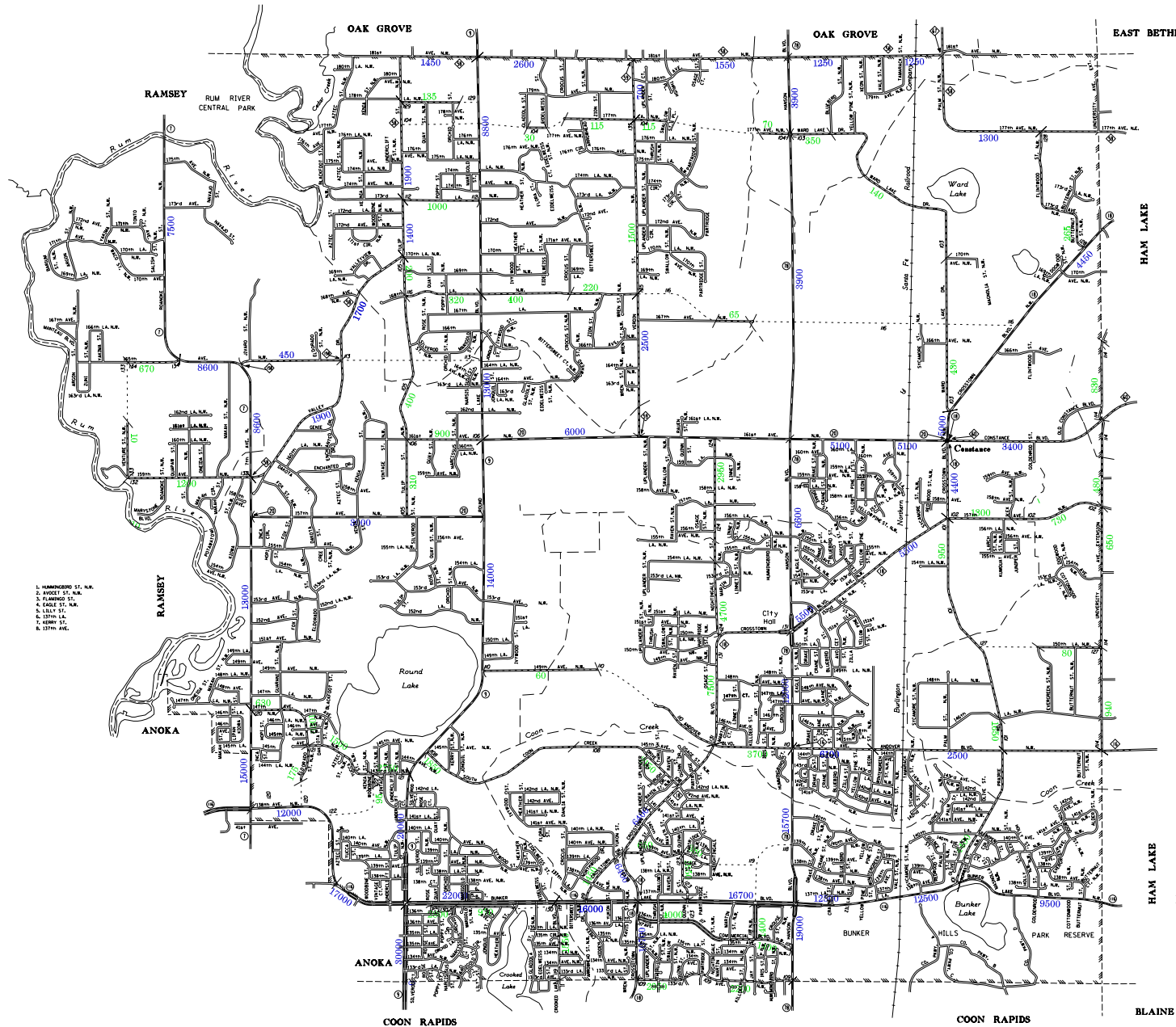

1. HAMMINGSD ST. N.W.
2. WISSET ST. N.W.
3. PLUMBING ST.
4. COCKE ST. N.W.
5. LILLY ST.
6. 37TH ST. N.W.
7. KERRY ST.
8. 37TH AVE.