

PRINCETON
MILLE LACS AND SHERBURNE COUNTIES
TOTAL POP. 3,933

2002 TRAFFIC VOLUMES
MUNICIPALITIES OF
MILLE LACS CO.

PREPARED BY THE
MINNESOTA DEPARTMENT OF TRANSPORTATION
PROGRAM SUPPORT GROUP
IN COOPERATION WITH
U.S. DEPARTMENT OF TRANSPORTATION
FEDERAL HIGHWAY ADMINISTRATION

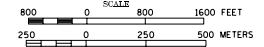

2002
BASIC DATA - 1977

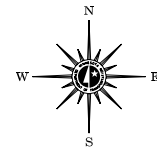

LEGEND

- INTERSTATE TRUNK HIGHWAY..... (I)
- U.S. TRUNK HIGHWAY..... (SH)
- STATE TRUNK HIGHWAY..... (SH)
- COUNTY STATE AID HIGHWAY..... (CS)
- COUNTY ROAD..... (CR)
- PUBLIC ROAD..... (PR)
- PRIVATE ROAD..... (PR)
- CORPORATE LIMITS..... (CL)

VOLUMES PREPARED BY
THE OFFICE OF
TRANSPORTATION DATA & ANALYSIS

NUMERALS INDICATE AVERAGE DAILY
TRAFFIC VOLUMES ON DESIGNATED ROADS
NOTE: TH ROUTES ARE 2002 A.A.D.T. VOLUMES

FOR DESIGNATED ROADS :
/ = SEGMENT ENDPOINT FOR ALL
ROADS INTERSECTED BY HATCH
(= SEGMENT ENDPOINT ONLY FOR
ROAD SEPARATED FROM INTERSECTING
ROAD BY ARC

DUE TO SIGNIFICANT ROAD CONSTRUCTION
COUNTS WERE NOT TAKEN AT SITES WHERE
VOLUMES ARE DISPLAYED WITH AN ASTERISK.
THESE ASTERISKED SITES REFLECT 1998 A.A.D.T.

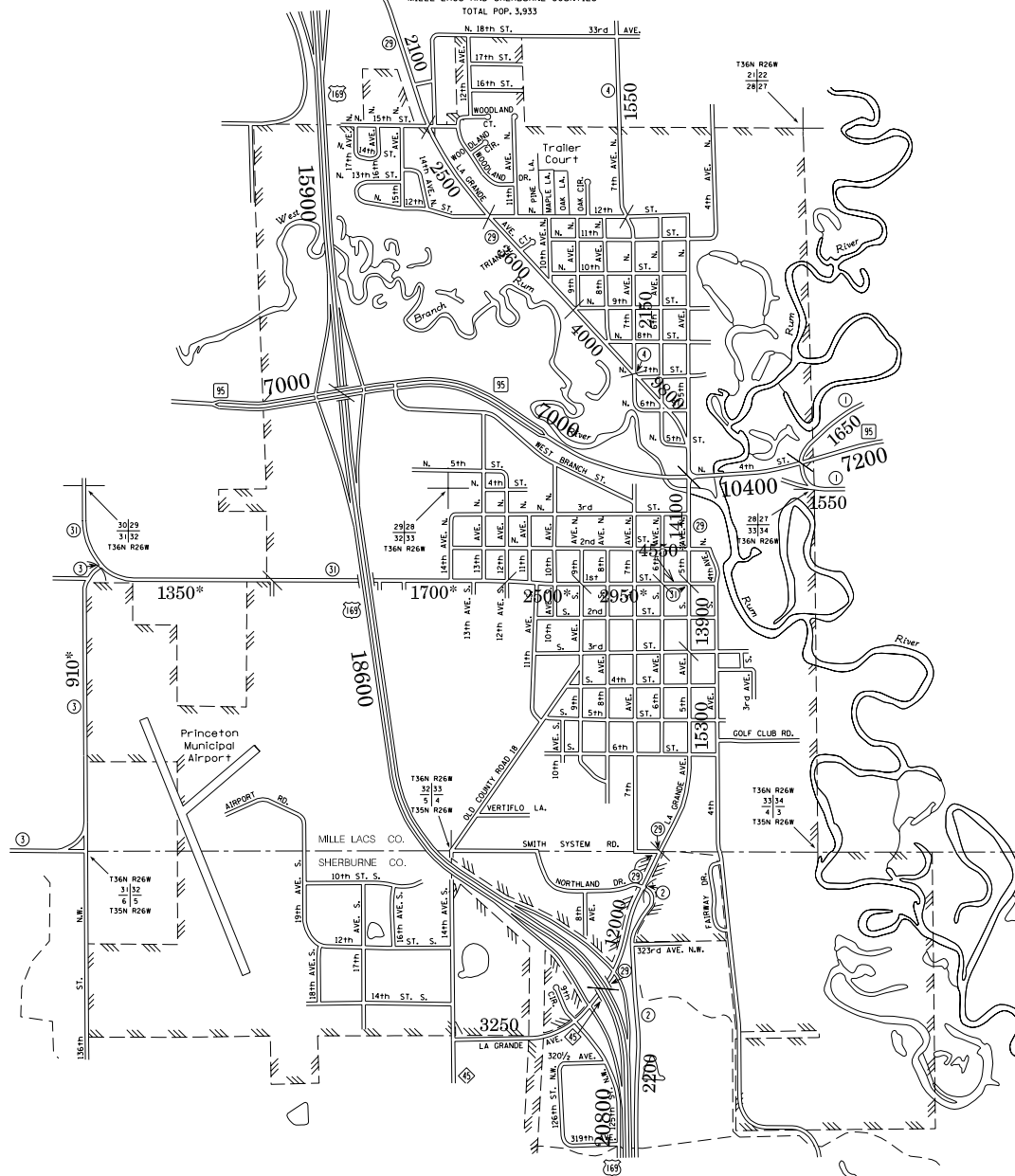

MUNICIPALITIES SHOWN
ON THIS SHEET
PRINCETON

NOTE: 2000 U.S. CENSUS FIGURES SHOWN FOR ALL MUNICIPALITIES UNLESS OTHERWISE STATED.