

2002 TRAFFIC VOLUMES

MUNICIPALITY OF WORTHINGTON

PREPARED BY THE
MINNESOTA DEPARTMENT OF TRANSPORTATION
PROGRAM SUPPORT GROUP
IN COOPERATION WITH
U.S. DEPARTMENT OF TRANSPORTATION
FEDERAL HIGHWAY ADMINISTRATION

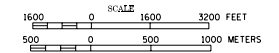

2002
BASIC DATA - 1977

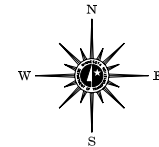

LEGEND

- INTERSTATE TRUNK HIGHWAY..... (H)
- U.S. TRUNK HIGHWAY..... (SH)
- STATE TRUNK HIGHWAY..... (ST)
- COUNTY STATE AID HIGHWAY..... (CSA)
- COUNTY ROAD..... (CR)
- CORPORATE LIMITS..... (Dashed line)
- PUBLIC ROAD..... (Solid line)
- PRIVATE ROAD..... (Thin solid line)

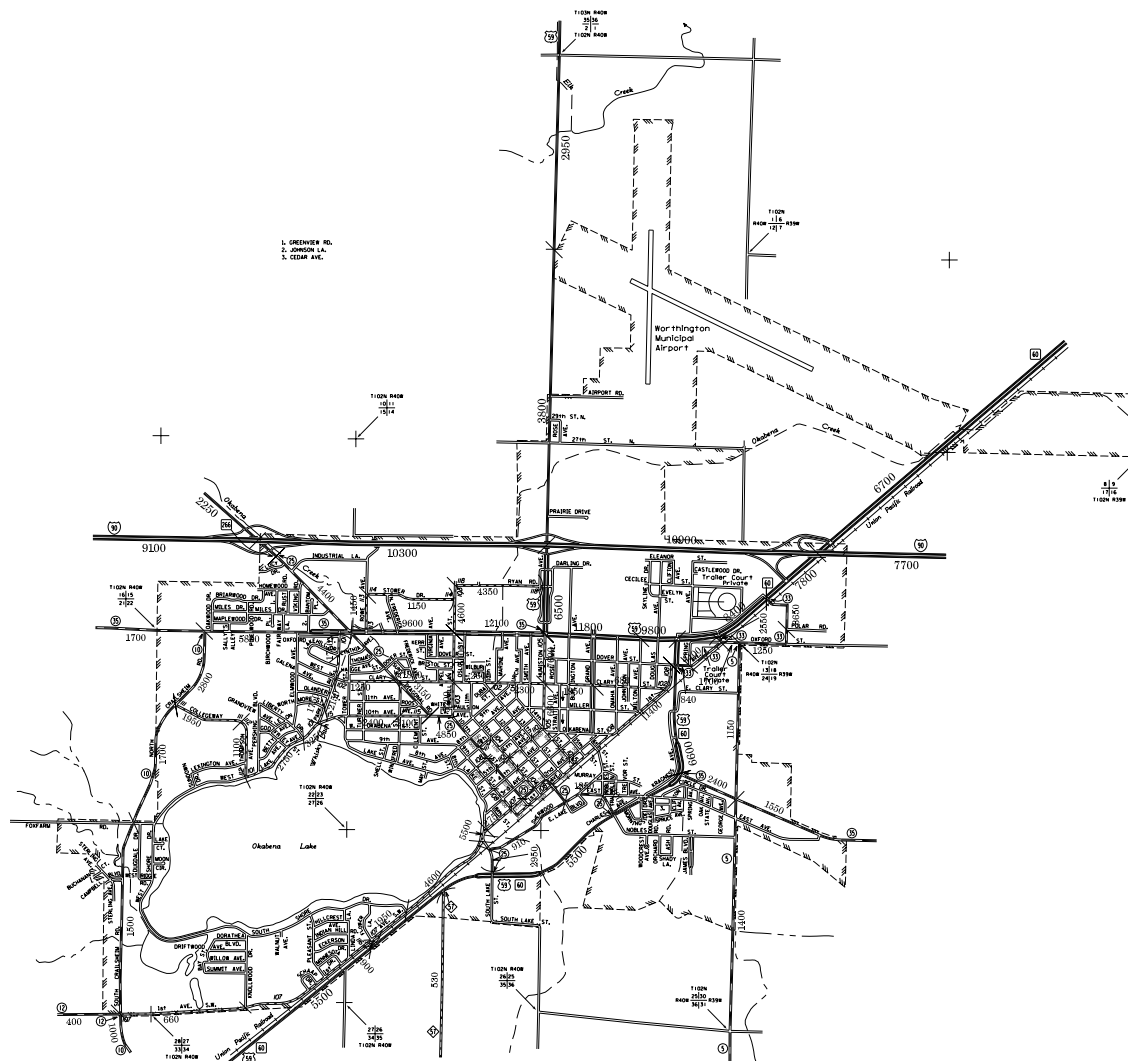

1. GREENVIEW RD.
2. JOHNSON LA.
3. CEDAR AVE.

MUNICIPAL STATE AID STREET SYSTEM

LEGEND

- MUNICIPAL COUNTY STATE AID STREET..... (Thin solid line)
- MUNICIPAL STATE AID STREET..... (Medium solid line)
- COUNTY STATE AID HIGHWAY..... (Thick solid line)
- COUNTY ROAD..... (Thin solid line)
- TRUNK HIGHWAY..... (Thick solid line)

VOLUMES PREPARED BY
THE OFFICE OF
TRANSPORTATION DATA & ANALYSIS

NUMERALS INDICATE AVERAGE DAILY
TRAFFIC VOLUMES ON DESIGNATED ROADS
NOTE: T.H. ROUTES ARE 2002 A.A.D.T. VOLUMES

FOR DESIGNATED ROADS :
/ - SEGMENT ENDPOINT FOR ALL
ROADS INTERSECTED BY HATCH
(= SEGMENT ENDPOINT ONLY FOR
ROAD SEPARATED FROM INTERSECTING
ROAD BY ARC