

2001 TRAFFIC VOLUMES
GENERAL HIGHWAY MAP
STEVENS COUNTY
MINNESOTA

PREPARED BY THE
MINNESOTA DEPARTMENT OF TRANSPORTATION
PROGRAM SUPPORT GROUP
OF COURTESY WITH
U.S. DEPARTMENT OF TRANSPORTATION
FEDERAL HIGHWAY ADMINISTRATION



2002
BASIC DATA - 1977

PROJECTION: Minnesota State Plane System
UNIT: U.S. FEET
LAYER: CONTIGUOUS LINE



LEGEND

ROAD AND HIGHWAY FEATURES	SYMBOLS
Interstate	Thick solid line with red and blue shields
State Highway	Thin solid line with blue and red shields
County Road	Thin solid line with blue and red shields
Local Road	Thin solid line
Unimproved Road	Dashed line
Right-of-Way	Thin solid line
Interchange	Circle with four arrows
Overpass	Circle with two arrows
Underpass	Circle with two arrows
Grade Separation	Circle with two arrows
Roundabout	Circle with four arrows
Signalized Intersection	Circle with four arrows
Unsignalized Intersection	Circle with four arrows
Stop Sign	Circle with four arrows
Yield Sign	Circle with four arrows
Priority Sign	Circle with four arrows
Other Signs	Circle with four arrows
Water	Blue area
Wetlands	Blue wavy lines
Topography	Brown contour lines
Setbacks	Thin solid line
City Limits	Thin solid line
County Boundary	Thin solid line
Regulatory Map Features	Thin solid line
Other Features	Thin solid line

VOLUMES PREPARED BY
THE OFFICE OF
TRANSPORTATION DATA & ANALYSIS

NUMERALS INDICATE AVERAGE DAILY
TRAFFIC VOLUMES ON DESIGNATED ROADS
NOTE: TR ROUTES ARE 2000 AADT VOLUMES

FOR DESIGNATED ROADS:
/ - SEGMENT ENDPOINT FOR ALL
ROADS INTERSECTED BY HAICH
+ = SEGMENT ENDPOINT ONLY FOR
ROAD SEPARATED FROM INTERSECTING
ROAD BY ARC

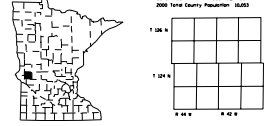
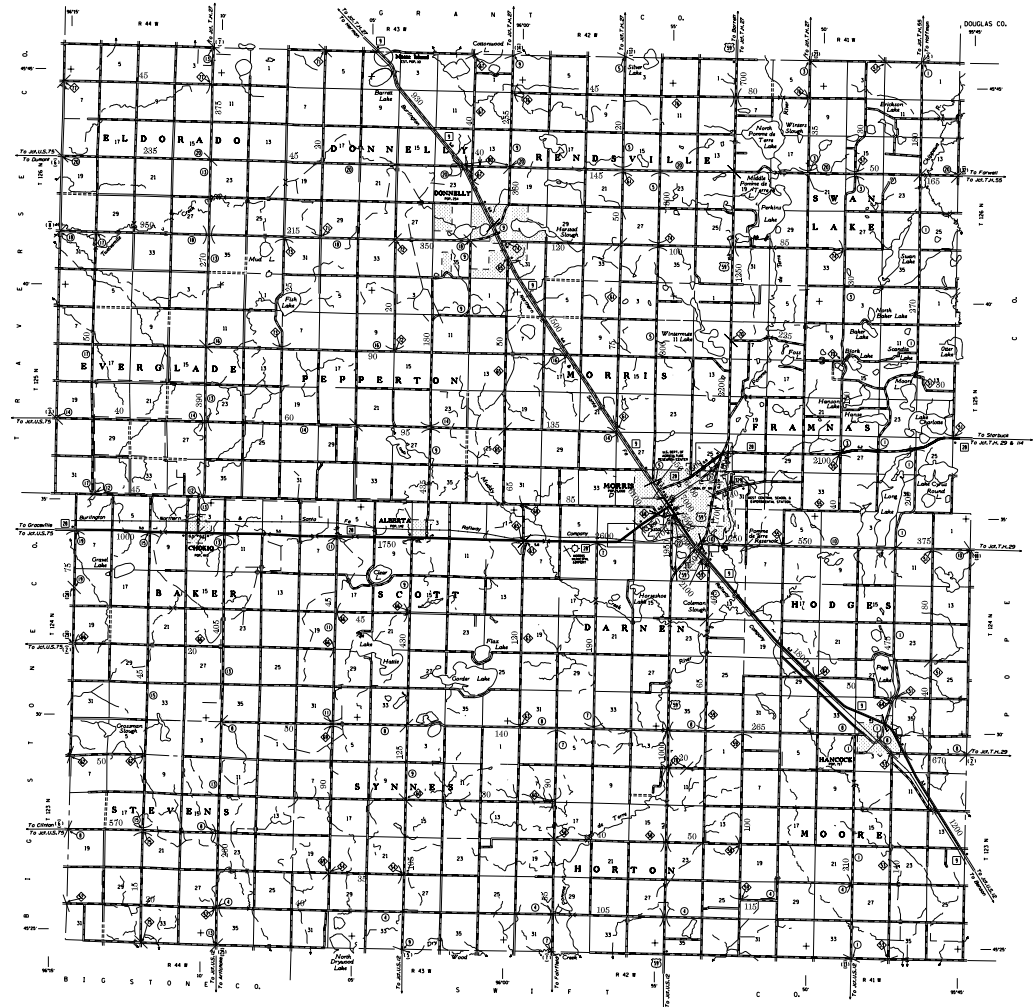

*NOT ALL FEATURES EXCEPT TOWNSHIP BOUNDARIES AND
COUNTY LINES CURRENT AS OF JANUARY 1, 2000.
NOTE: FOR DETAILS OF COUNTY STATE AID ROADS AND COUNTY
ROADS IN INCORPORATED PLACES SEE MAPS OF MUNICIPALITIES.