

2001 TRAFFIC VOLUMES

MUNICIPALITIES OF
TODD

PREPARED BY THE
MINNESOTA DEPARTMENT OF TRANSPORTATION
PROGRAM SUPPORT GROUP
IN COOPERATION WITH
U.S. DEPARTMENT OF TRANSPORTATION
FEDERAL HIGHWAY ADMINISTRATION

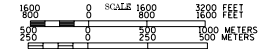

19XX
BASIC DATA - 19XX

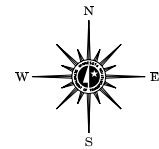

LEGEND

- INTERSTATE TRUNK HIGHWAY.....(5)
- U.S. TRUNK HIGHWAY.....(10)
- STATE TRUNK HIGHWAY.....(35)
- COUNTY STATE AID HIGHWAY.....(2)
- COUNTY ROAD.....(4)
- PUBLIC ROAD.....(1)
- PRIVATE ROAD.....(1)
- CORPORATE LIMITS.....(---)

VOLUMES PREPARED BY
THE OFFICE OF
TRANSPORTATION DATA & ANALYSIS

NUMERALS INDICATE AVERAGE DAILY
TRAFFIC VOLUMES ON DESIGNATED ROADS
NOTE: T.H. ROUTES ARE 2000 A.D.T. VOLUMES

FOR DESIGNATED ROADS :
/ = SEGMENT ENDPOINT FOR ALL
ROADS INTERSECTED BY HATCH
(= SEGMENT ENDPOINT ONLY FOR
ROAD SEPARATED FROM INTERSECTING
ROAD BY ARC

MUNICIPALITIES SHOWN
ON THIS SHEET
STAPLES

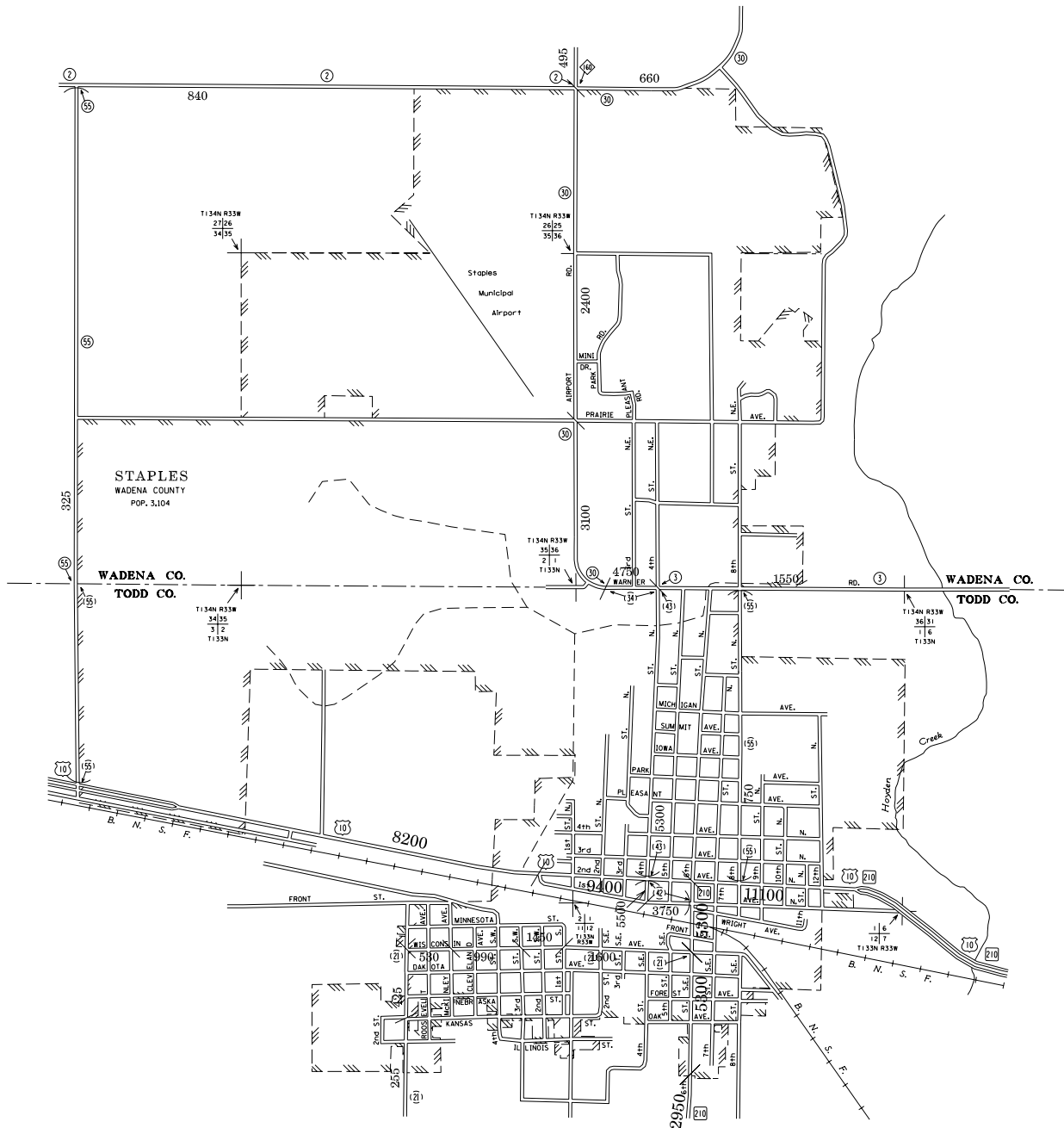

NOTE: 1990 U.S. CENSUS FIGURES SHOWN FOR ALL MUNICIPALITIES UNLESS OTHERWISE STATED.