

2001 TRAFFIC VOLUMES
 MUNICIPALITIES OF
MORRISON CO.
 PREPARED BY THE
 MINNESOTA DEPARTMENT OF TRANSPORTATION
 PROGRAM SUPPORT GROUP
 IN COOPERATION WITH
 U.S. DEPARTMENT OF TRANSPORTATION
 FEDERAL HIGHWAY ADMINISTRATION

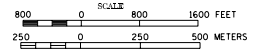

2002
 BASIC DATA - 1977

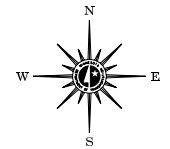

- LEGEND**
- INTERSTATE TRUNK HIGHWAY.....(1)
 - U.S. TRUNK HIGHWAY.....(2)
 - STATE TRUNK HIGHWAY.....(3)
 - COUNTY STATE AID HIGHWAY.....(4)
 - COUNTY ROAD.....(5)
 - PUBLIC ROAD.....(6)
 - PRIVATE ROAD.....(7)
 - CORPORATE LIMITS.....(8)

VOLUMES PREPARED BY
 THE OFFICE OF
 TRANSPORTATION DATA & ANALYSIS

NUMERALS INDICATE AVERAGE DAILY
 TRAFFIC VOLUMES ON DESIGNATED ROADS
 NOTE: T.H. ROUTES ARE 2000 A.A.D.T. VOLUMES

FOR DESIGNATED ROADS:
 // = SEGMENT ENDPOINT FOR ALL
 ROADS INTERSECTED BY HATCH
 (= SEGMENT ENDPOINT ONLY FOR
 ROAD SEPARATED FROM INTERSECTING
 ROAD BY ARC

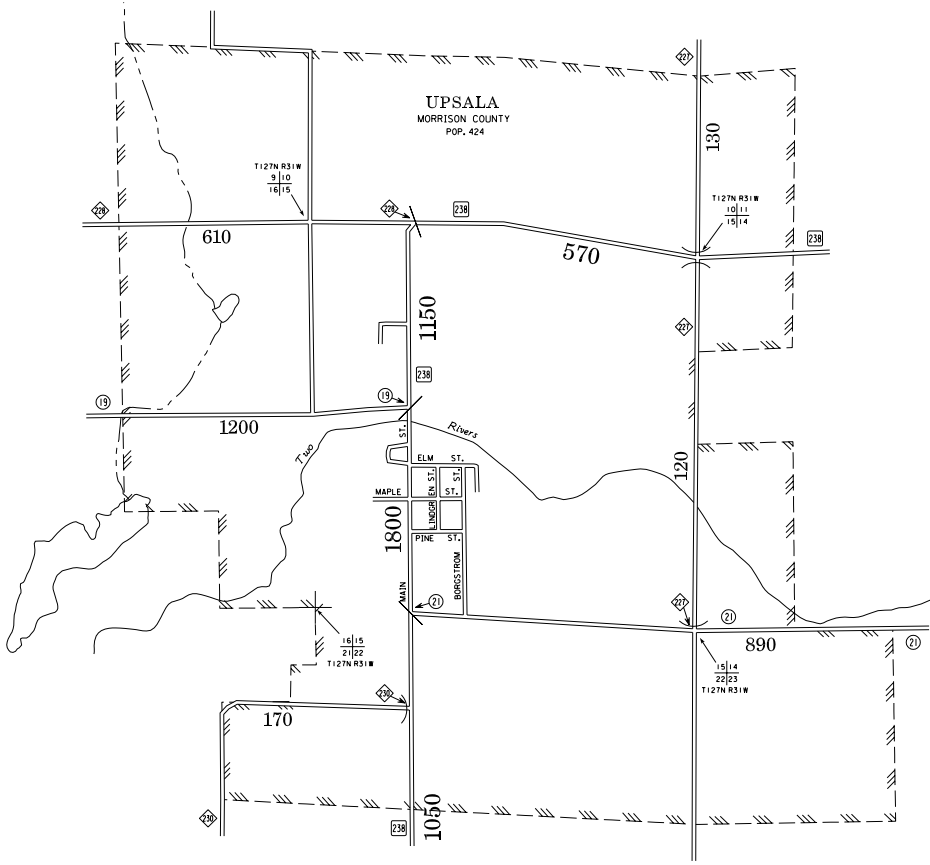

MUNICIPALITIES SHOWN
 ON THIS SHEET
 UPSALA