

2001 M.S.A.S. TRAFFIC VOLUMES

(SEE NOTE)

MUNICIPALITY OF LAKE ELMO

PREPARED BY THE
MINNESOTA DEPARTMENT OF TRANSPORTATION
PROGRAM SUPPORT GROUP
IN COOPERATION WITH
U.S. DEPARTMENT OF TRANSPORTATION
FEDERAL HIGHWAY ADMINISTRATION

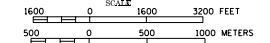

2001
BASIC DATA - 1990

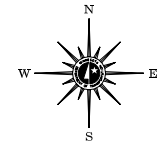

LEGEND

- INTERSTATE TRUNK HIGHWAY.....(I)
- U.S. TRUNK HIGHWAY.....(U.S.)
- STATE TRUNK HIGHWAY.....(S.T.H.)
- COUNTY STATE AID HIGHWAY.....(C.S.A.H.)
- COUNTY ROAD.....(C.R.)
- CORPORATE LIMITS.....(---)
- PUBLIC ROAD.....(---)
- PRIVATE ROAD.....(---)

MUNICIPAL STATE AID STREET SYSTEM

LEGEND

- MUNICIPAL COUNTY STATE AID STREET.....(---)
- MUNICIPAL STATE AID STREET.....(---)
- COUNTY STATE AID HIGHWAY.....(---)
- COUNTY ROAD.....(---)
- TRUNK HIGHWAY.....(---)

NOTE:

- A.A.D.T.....(---) 2500
(AVERAGE ANNUAL DAILY TRAFFIC)
- VOLUMES PREPARED BY THE OFFICE OF
TRANSPORTATION DATA & ANALYSIS
- NOTE: INTERSTATES, STATE TRUNK HIGHWAYS, AND COUNTY
ROAD SYSTEMS REFLECT 2000 TRAFFIC VOLUMES.

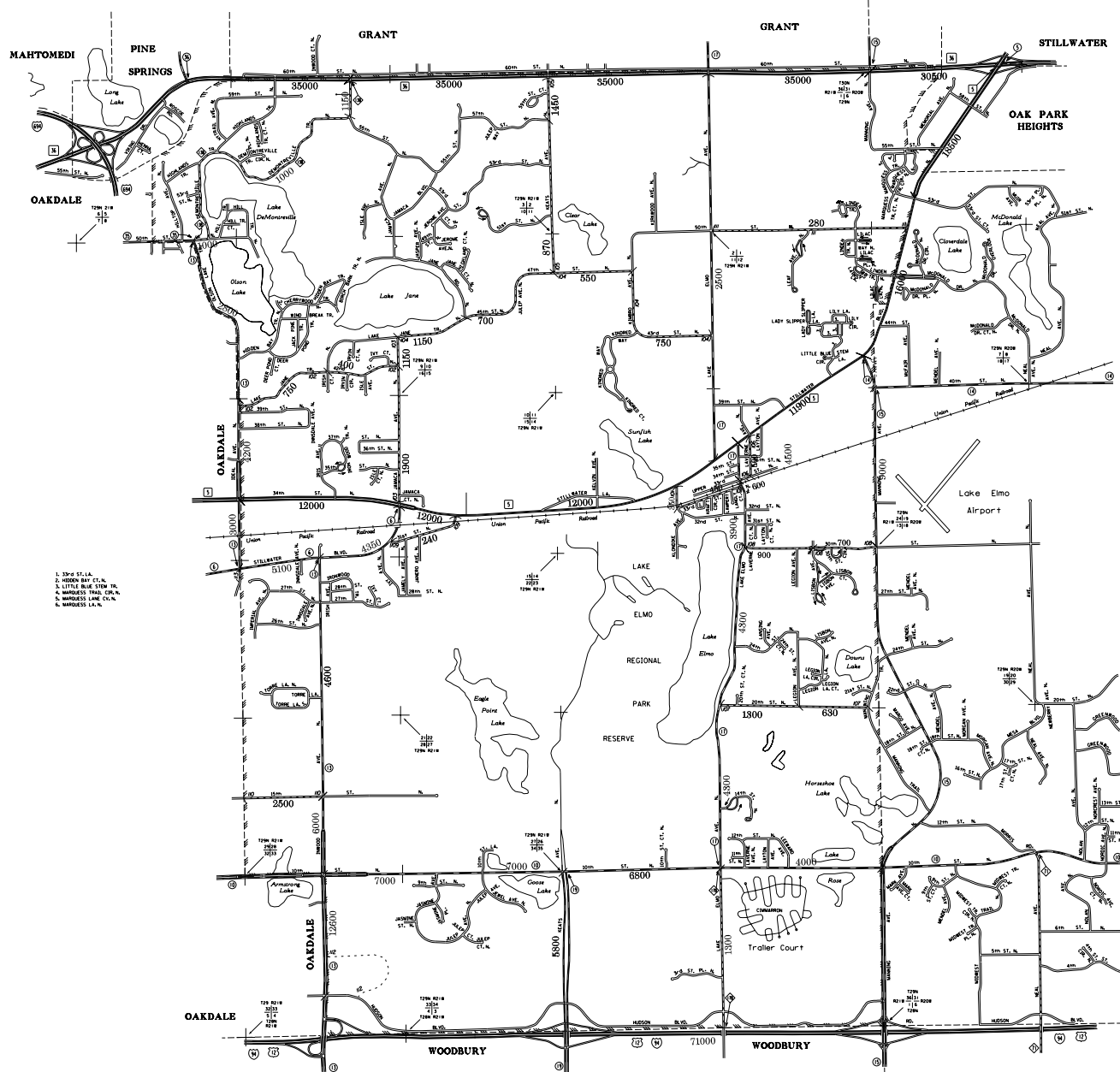

- 1. 13th St. S.E.
- 2. Hudson Bay Ct. S.E.
- 3. Little Blue St. S.W.
- 4. Harborside Trail Ct. S.W.
- 5. Harborside Lane Ct. S.W.
- 6. Harborside Ln. S.W.