

**FINAL**  
NOVEMBER 2000

1999 TRAFFIC VOLUMES  
MUNICIPALITIES OF  
**STEELE CO.**

PREPARED BY THE  
MINNESOTA DEPARTMENT OF TRANSPORTATION  
TECHNICAL SERVICES DIVISION  
IN COOPERATION WITH THE  
U.S. DEPARTMENT OF TRANSPORTATION  
FEDERAL HIGHWAY ADMINISTRATION

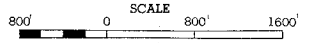

1999  
BASIC DATA 1977

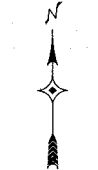

**LEGEND**

- INTERSTATE TRUNK HIGHWAY..... (35)
- U.S. NUMBERED TRUNK HIGHWAY..... (10)
- STATE NUMBERED TRUNK HIGHWAY..... (5)
- COUNTY STATE AID HIGHWAY..... (3)
- COUNTY ROAD..... (7)
- COUNTY STATE AID HIGHWAY IN ADJOINING COUNTY..... (2)
- COUNTY ROAD IN ADJOINING COUNTY..... (1)
- CORPORATE LIMITS.....
- CENTRAL BUSINESS DISTRICT BOUNDARY.....

A.A.D.T. .... 2500  
(ANNUAL AVERAGE DAILY TRAFFIC)  
NUMERALS INDICATE ANNUAL AVERAGE TRAFFIC VOLUMES ON DESIGNATED ROADWAYS

VOLUMES PREPARED BY  
TRANSPORTATION RESEARCH AND INVESTMENT MANAGEMENT DIVISION

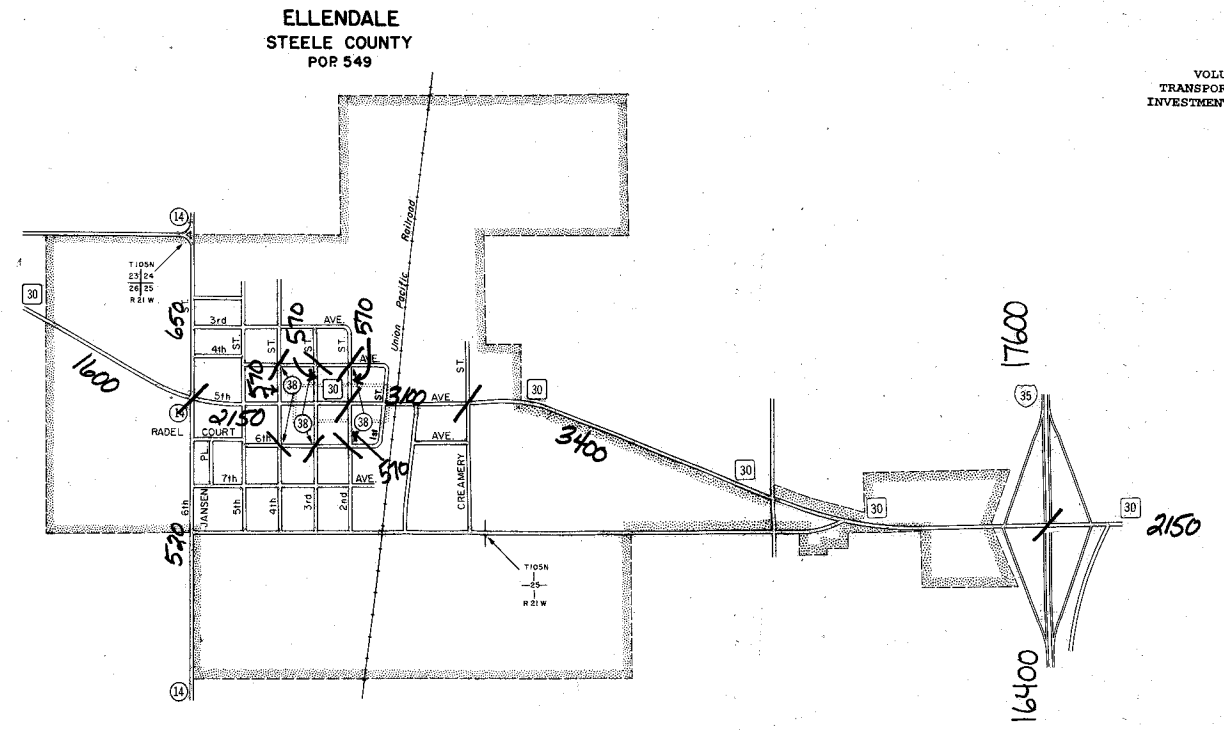
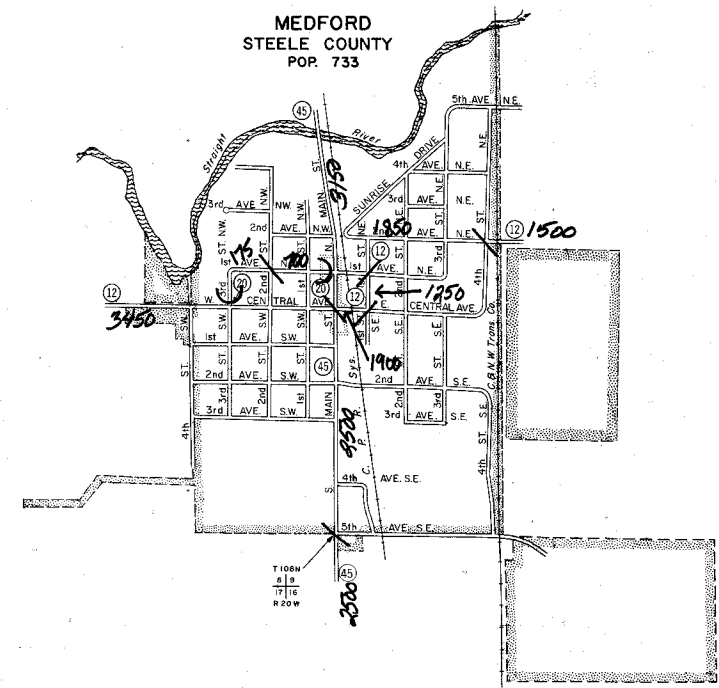
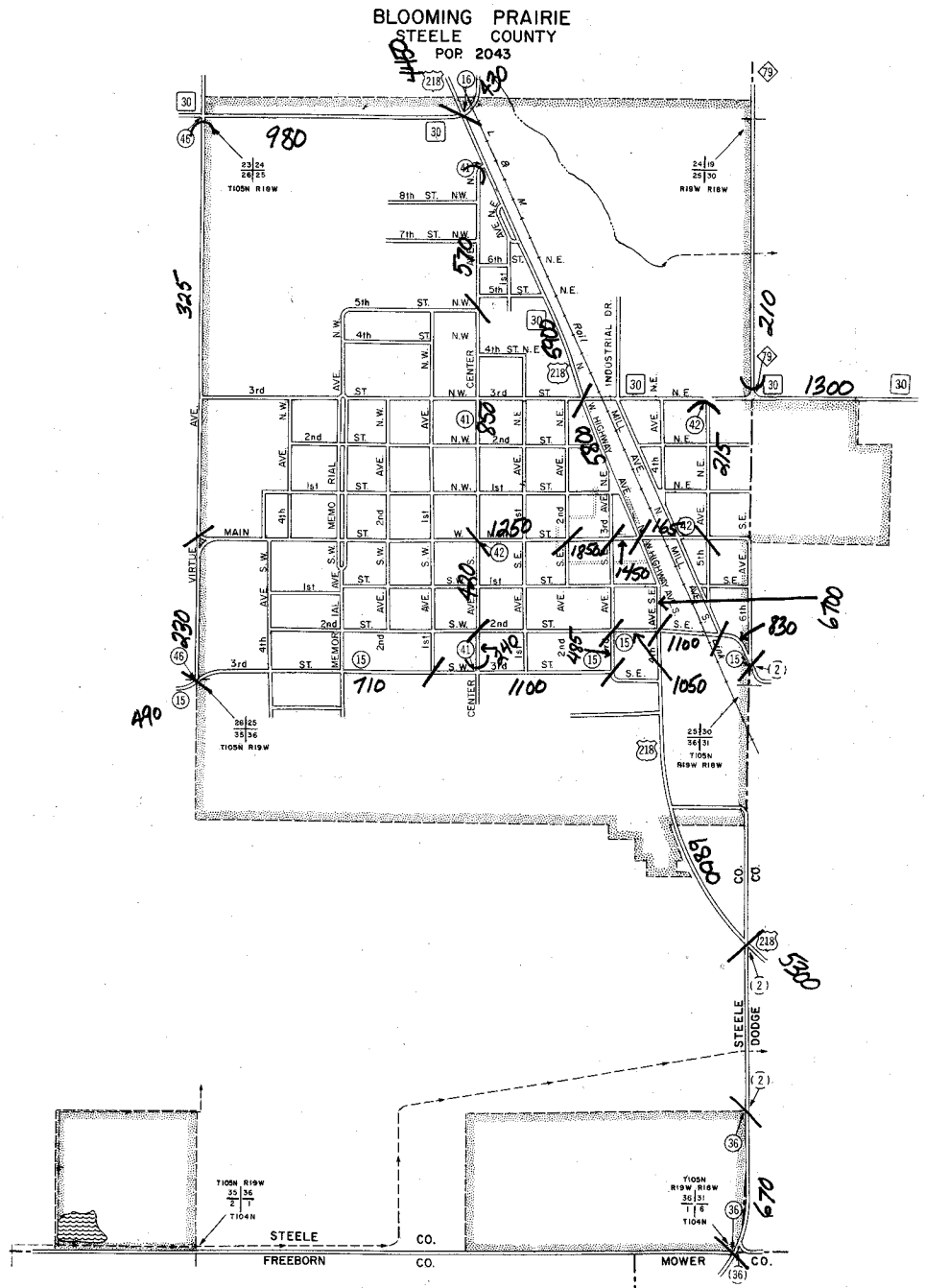

MUNICIPALITIES SHOWN ON THIS SHEET  
BLOOMING PRAIRIE  
ELLEENDALE  
MEDFORD

U.S. CENSUS FIGURES SHOWN FOR ALL MUNICIPALITIES UNLESS OTHERWISE STATED.