

**FINAL**  
NOVEMBER 2000

1999 TRAFFIC VOLUMES

MUNICIPALITIES OF  
**SIBLEY**

PREPARED BY THE  
MINNESOTA DEPARTMENT OF TRANSPORTATION  
TECHNICAL SERVICES DIVISION  
IN COOPERATION WITH  
U.S. DEPARTMENT OF TRANSPORTATION  
FEDERAL HIGHWAY ADMINISTRATION

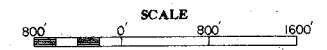

1999  
BASIC DATA - 1977

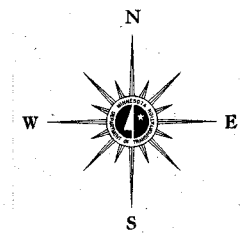

**LEGEND**

- INTERSTATE TRUNK HIGHWAY..... (55)
- U.S. TRUNK HIGHWAY..... (10)
- STATE TRUNK HIGHWAY..... (55)
- COUNTY STATE AID HIGHWAY..... (23)
- COUNTY ROAD..... (1)
- COUNTY STATE AID HIGHWAY IN ADJOINING COUNTY..... (51)
- COUNTY ROAD IN ADJOINING COUNTY..... (55)
- CORPORATE LIMITS.....
- CENTRAL BUSINESS DISTRICT BOUNDARY.....
- PUBLIC ROAD.....
- PRIVATE ROAD.....

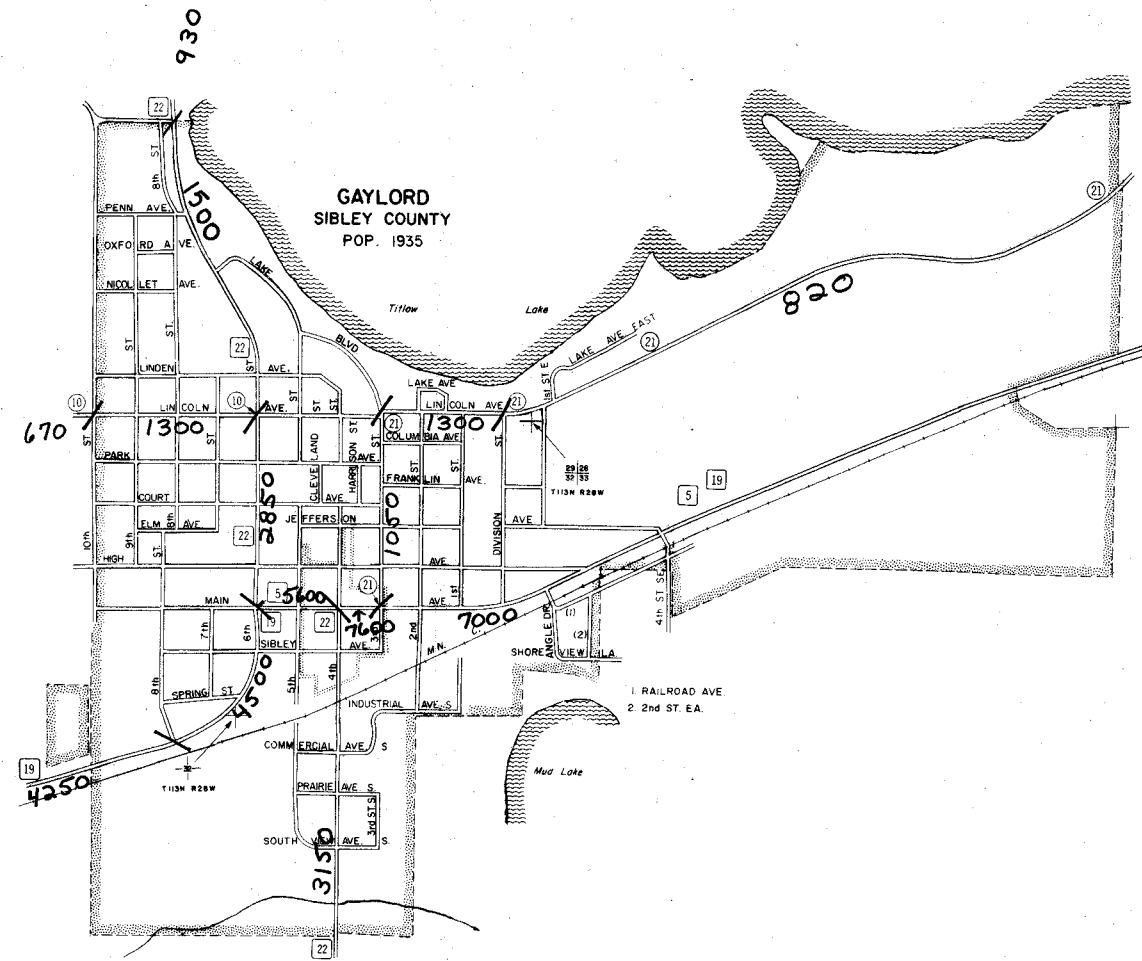

**GIBBON**  
SIBLEY COUNTY  
POP. 712

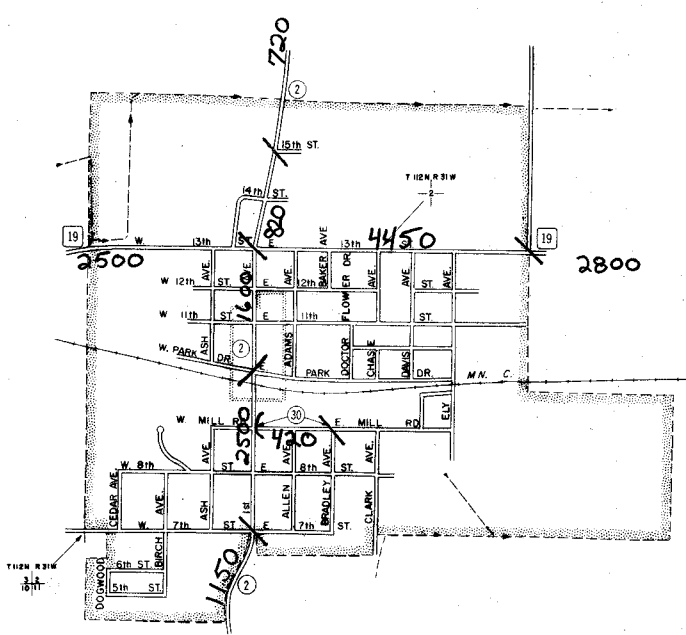

**HENDERSON**  
SIBLEY COUNTY  
POP. 746

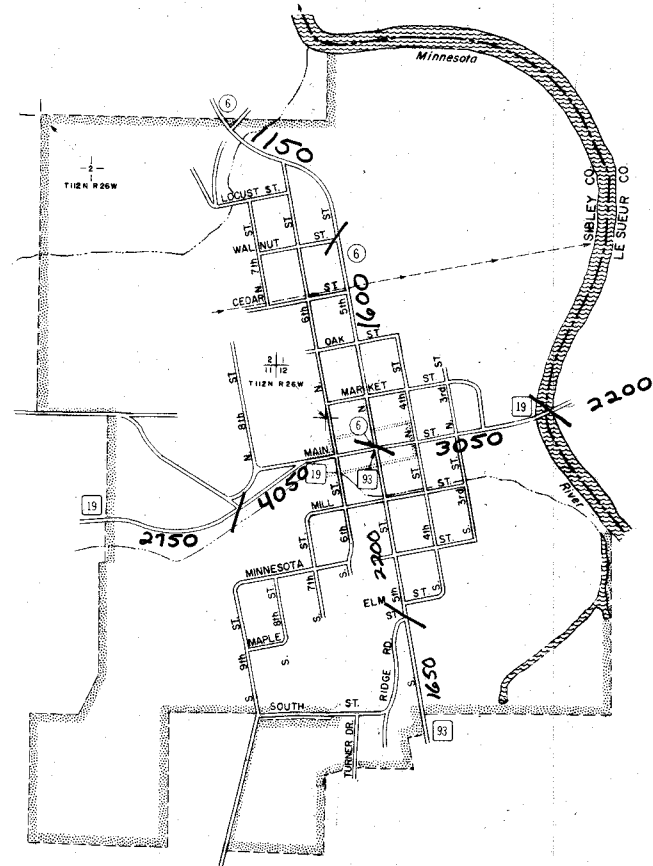

A.A.D.T. .... 2500  
(ANNUAL AVERAGE DAILY TRAFFIC)  
NUMERALS INDICATE ANNUAL AVERAGE TRAFFIC VOLUMES ON DESIGNATED ROADWAYS

VOLUMES PREPARED BY  
TRANSPORTATION RESEARCH AND  
INVESTMENT MANAGEMENT DIVISION

- MUNICIPALITIES SHOWN  
ON THIS SHEET
- GAYLORD
  - GIBBON
  - HENDERSON

NOTE: 1990 U.S. CENSUS FIGURES SHOWN FOR ALL MUNICIPALITIES UNLESS OTHERWISE STATED.