

FINAL
NOVEMBER 2000

1999 TRAFFIC VOLUMES

MUNICIPALITIES OF
RENVILLE CO.

PREPARED BY THE
MINNESOTA DEPARTMENT OF TRANSPORTATION
ENGINEERING SERVICES DIVISION
IN COOPERATION WITH
U.S. DEPARTMENT OF TRANSPORTATION
FEDERAL HIGHWAY ADMINISTRATION

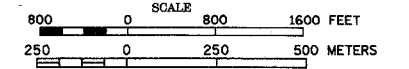

1999
BASIC DATA - 1977

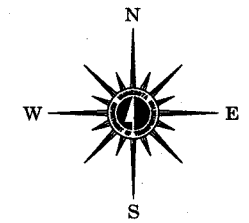

LEGEND

- INTERSTATE TRUNK HIGHWAY..... (I-5)
- U.S. TRUNK HIGHWAY..... (US-15)
- STATE TRUNK HIGHWAY..... (ST-15)
- COUNTY STATE AID HIGHWAY..... (CSA-15)
- COUNTY ROAD..... (C-15)
- PUBLIC ROAD..... (P-15)
- PRIVATE ROAD..... (PR-15)
- CORPORATE LIMITS..... (---)
- CENTRAL BUSINESS DISTRICT BOUNDARY.. (---)

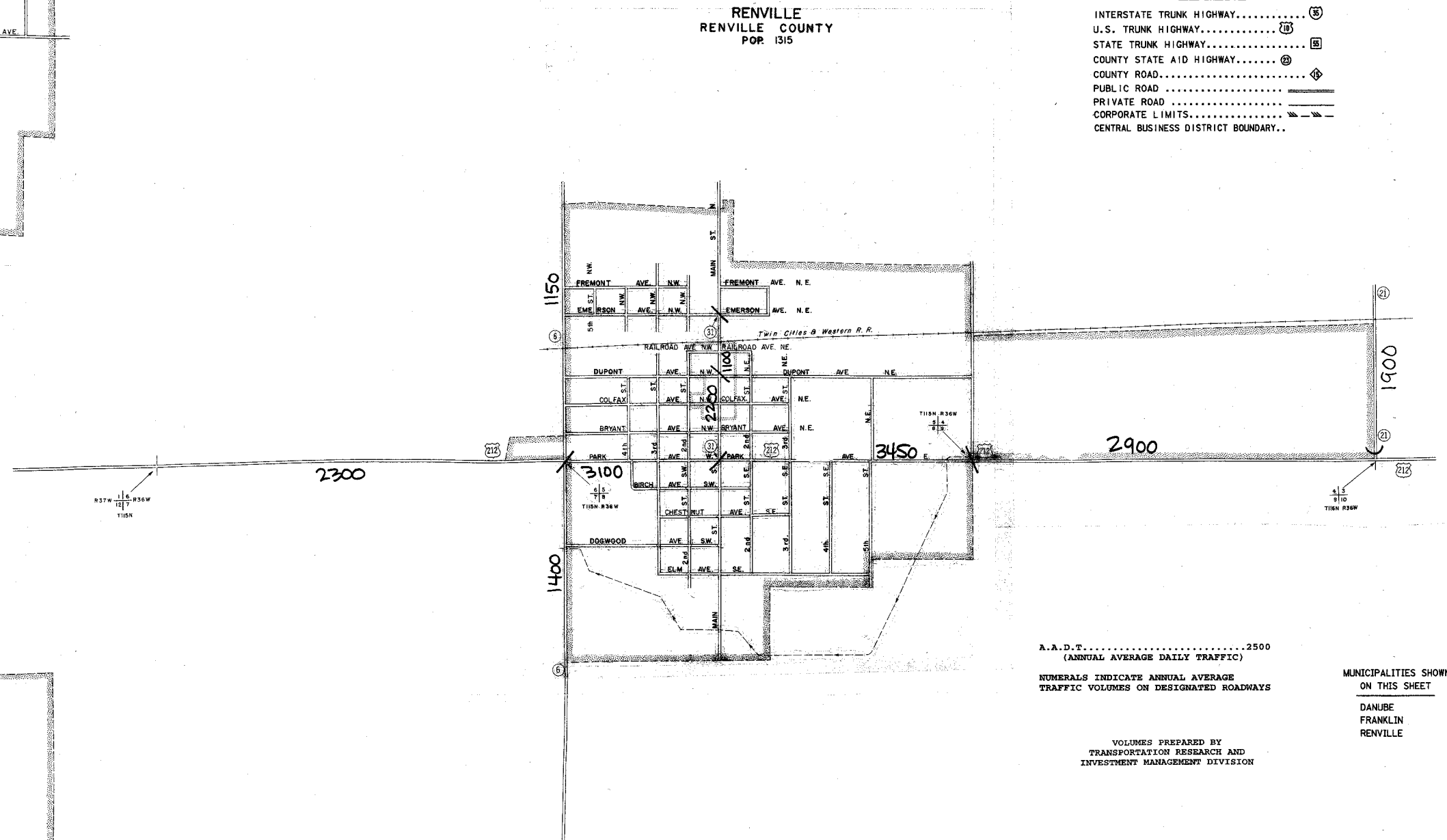
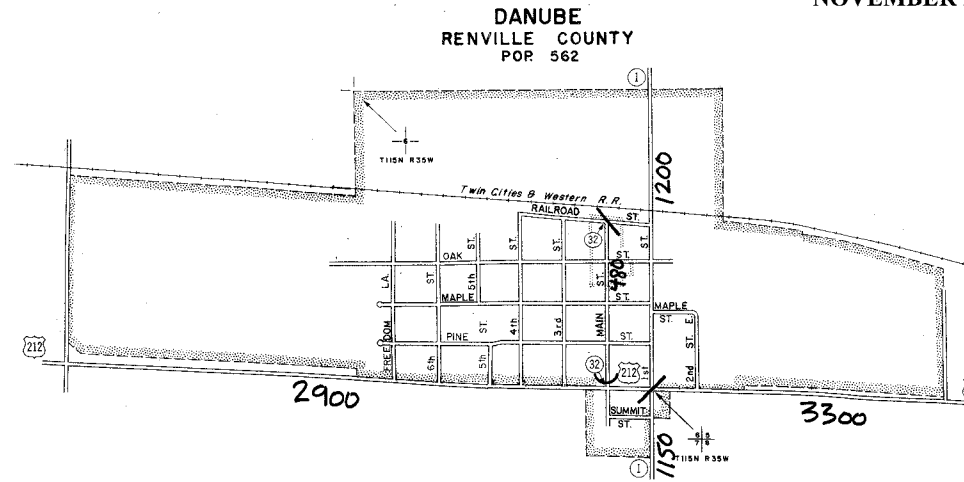
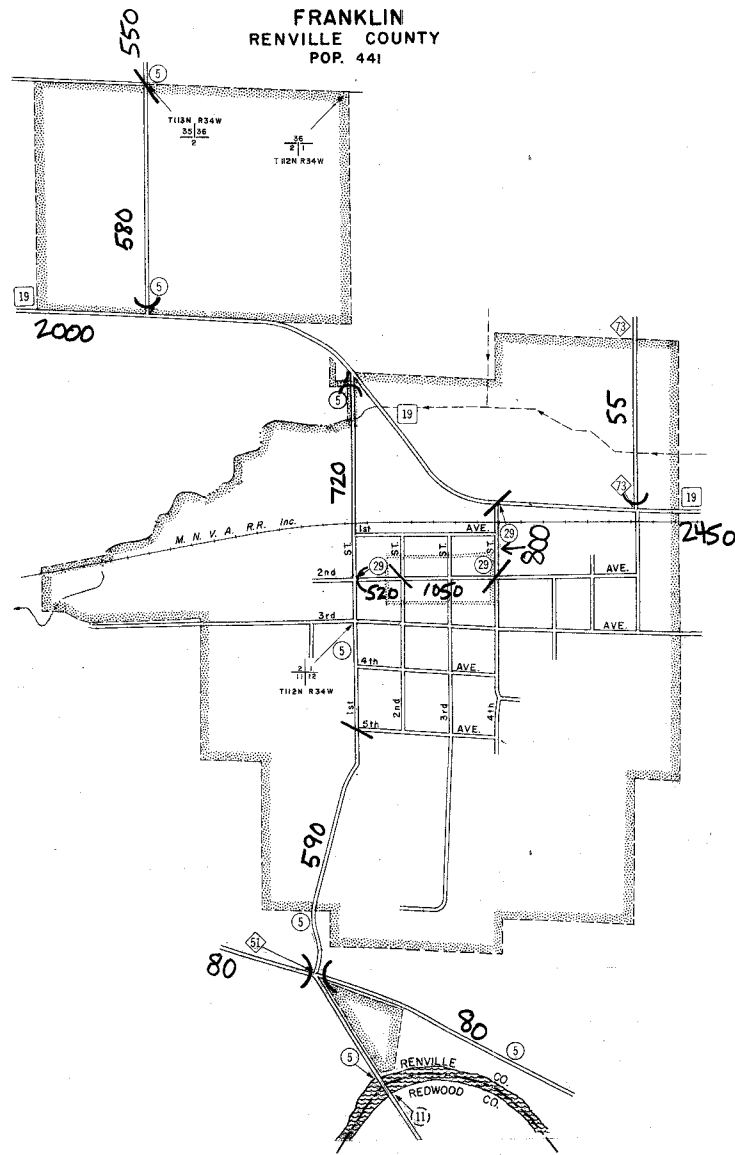

Part of RENVILLE

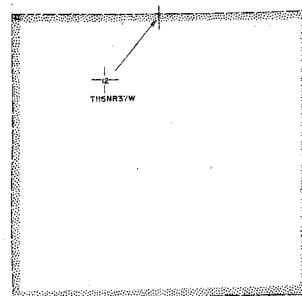

A.A.D.T.....2500
(ANNUAL AVERAGE DAILY TRAFFIC)

NUMERALS INDICATE ANNUAL AVERAGE TRAFFIC VOLUMES ON DESIGNATED ROADWAYS

MUNICIPALITIES SHOWN ON THIS SHEET

DANUBE
FRANKLIN
RENVILLE

VOLUMES PREPARED BY
TRANSPORTATION RESEARCH AND
INVESTMENT MANAGEMENT DIVISION

NOTE: 1990 U.S. CENSUS FIGURES SHOWN FOR ALL MUNICIPALITIES UNLESS OTHERWISE STATED.