

FINAL
NOVEMBER 2000

1999 TRAFFIC VOLUMES
MUNICIPALITIES OF
BENTON CO.

PREPARED BY THE
MINNESOTA DEPARTMENT OF TRANSPORTATION
TECHNICAL SERVICES DIVISION
IN COOPERATION WITH THE
U.S. DEPARTMENT OF TRANSPORTATION
FEDERAL HIGHWAY ADMINISTRATION

SCALE 1" = 800'

1999
BASIC DATA-1977



LEGEND

- INTERSTATE TRUNK HIGHWAY.....(35)
- U.S. NUMBERED TRUNK HIGHWAY.....(10)
- STATE NUMBERED TRUNK HIGHWAY.....(6)
- COUNTY STATE AID HIGHWAY.....(3)
- COUNTY ROAD.....(7)
- COUNTY STATE AID HIGHWAY IN ADJOINING COUNTY.....(2)
- COUNTY ROAD IN ADJOINING COUNTY.....(1)
- CORPORATE LIMITS.....
- CENTRAL BUSINESS DISTRICT BOUNDARY.....

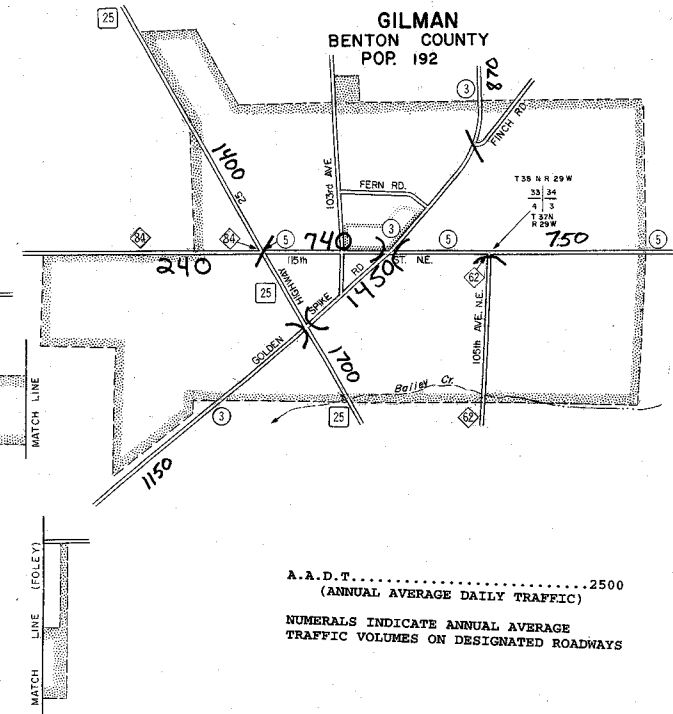
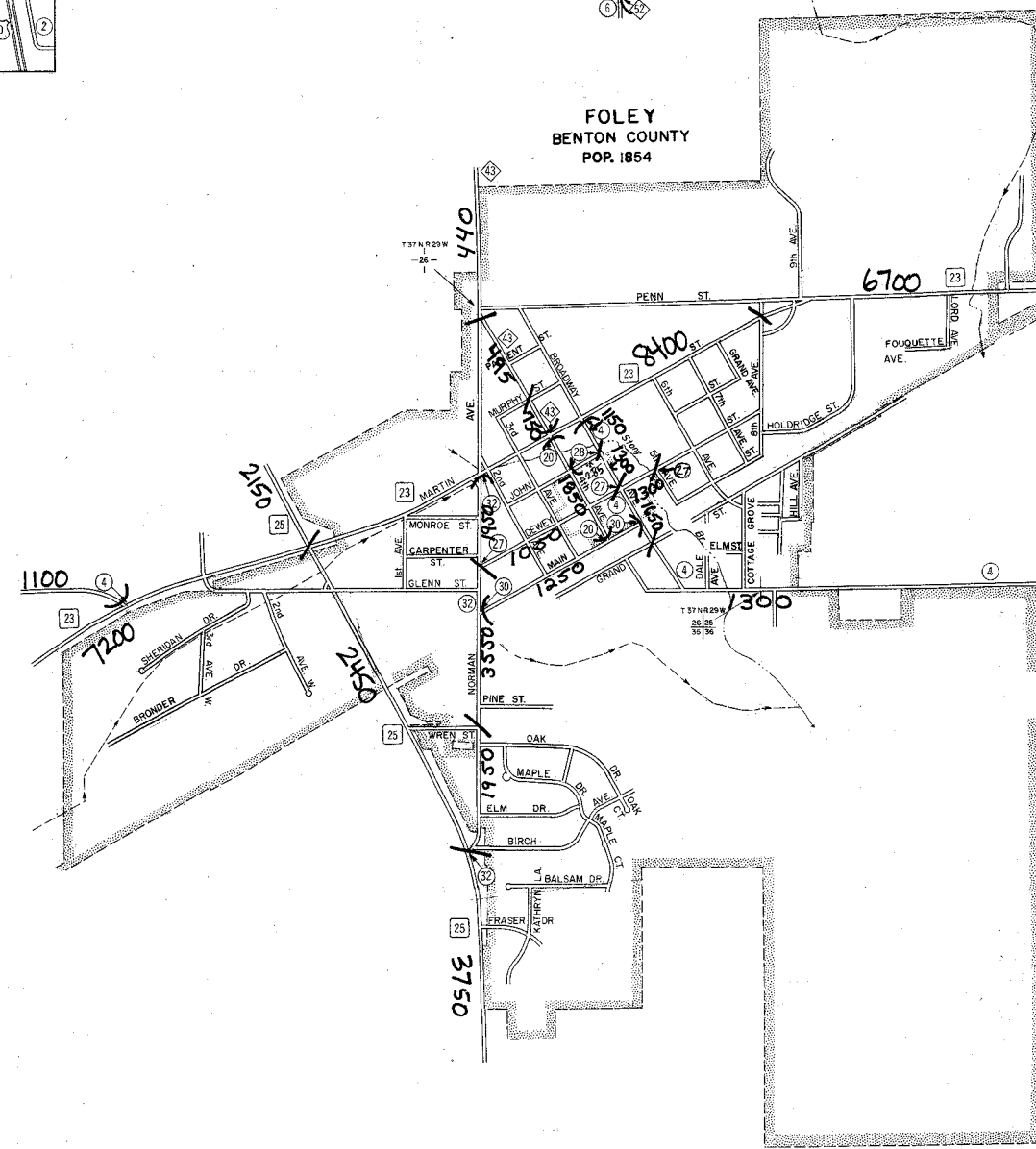
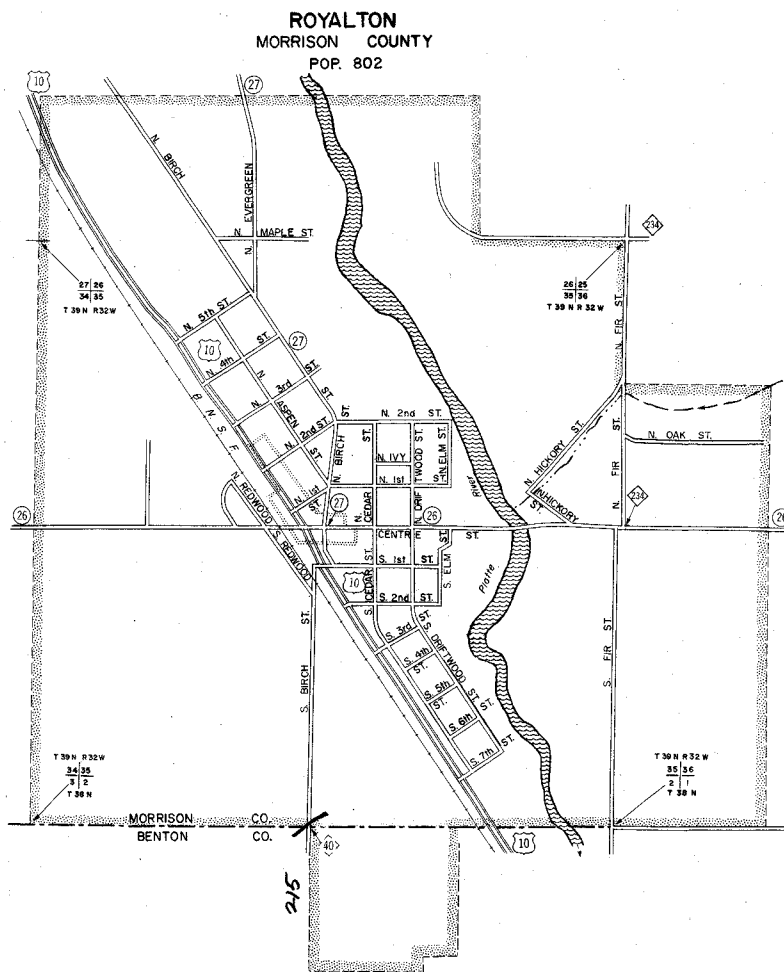
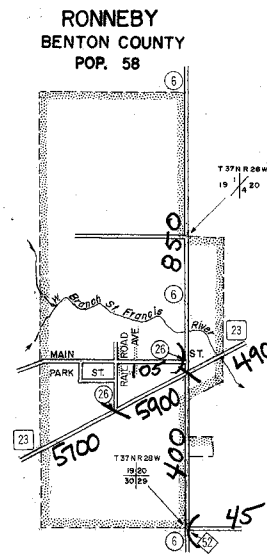
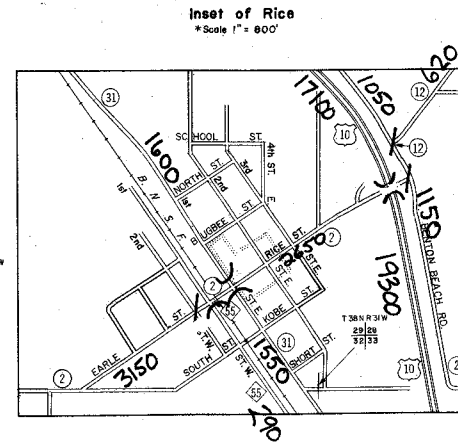
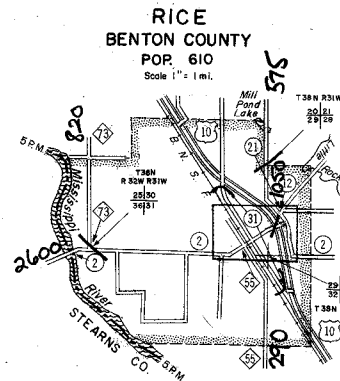

A.A.D.T.2500
(ANNUAL AVERAGE DAILY TRAFFIC)
NUMERALS INDICATE ANNUAL AVERAGE
TRAFFIC VOLUMES ON DESIGNATED ROADWAYS

VOLUMES PREPARED BY
TRANSPORTATION RESEARCH AND
INVESTMENT MANAGEMENT DIVISION

MUNICIPALITIES SHOWN
ON THIS SHEET

- FOLEY
- GILMAN
- RICE
- RONNEBY
- ROYALTON

NOTE: U.S. CENSUS FIGURES SHOWN FOR ALL MUNICIPALITIES UNLESS OTHERWISE STATED.

* Note: RICE shown at 1" = 1 mi.