

1999 TRAFFIC VOLUMES
MUNICIPALITY OF
REDWOOD FALLS

PREPARED BY THE
MINNESOTA DEPARTMENT OF TRANSPORTATION
PROGRAM SUPPORT GROUP
IN COOPERATION WITH
U.S. DEPARTMENT OF TRANSPORTATION
FEDERAL HIGHWAY ADMINISTRATION

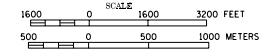

1999
BASIC DATA - 1982

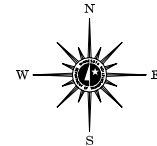

LEGEND

- INTERSTATE TRUNK HIGHWAY..... (I)
- U.S. TRUNK HIGHWAY..... (U.S.)
- STATE TRUNK HIGHWAY..... (S)
- COUNTY STATE AID HIGHWAY..... (CS)
- COUNTY ROAD..... (C)
- CORPORATE LIMITS..... (---)
- PUBLIC ROAD..... (—)
- PRIVATE ROAD..... (---)

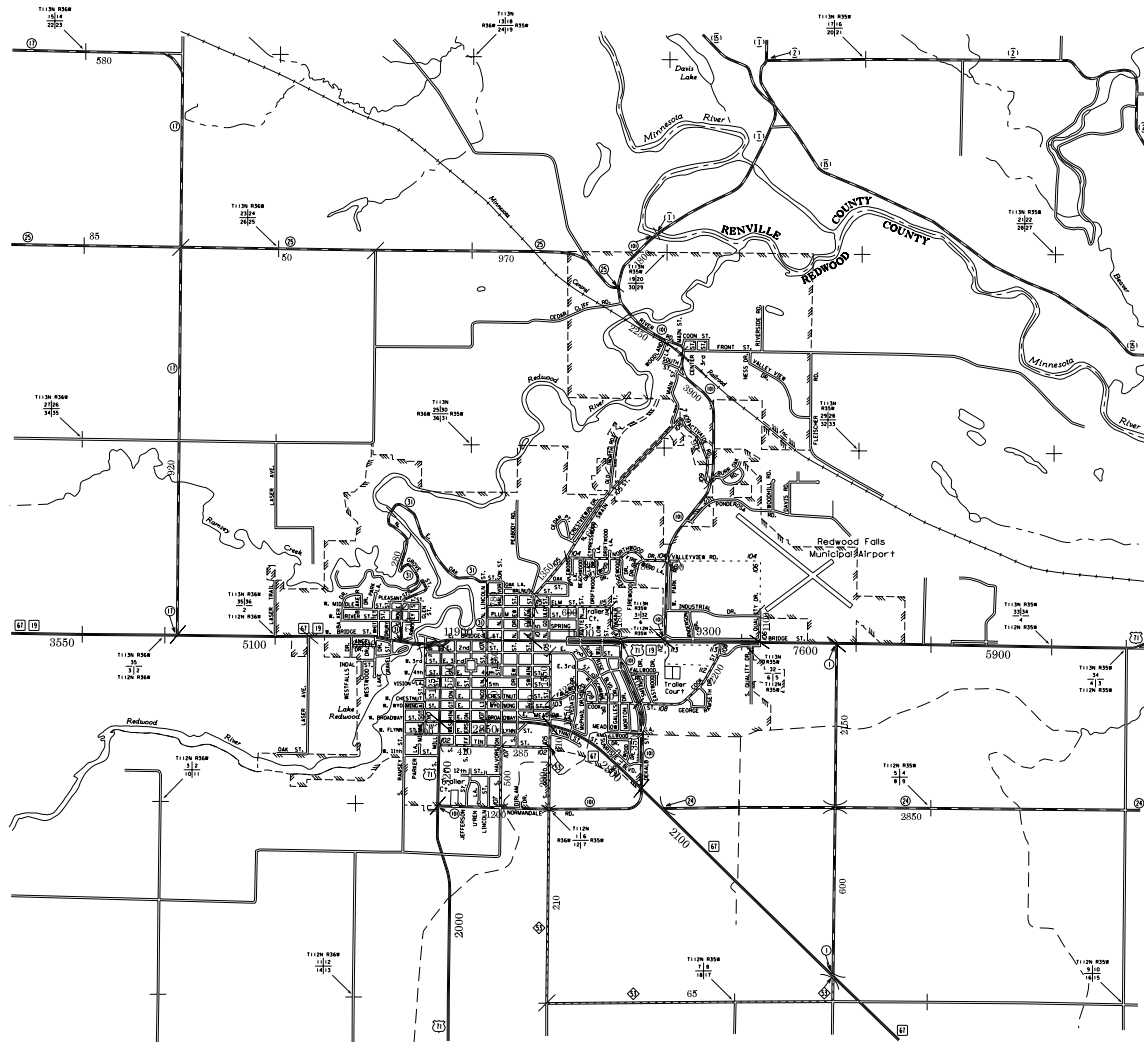

**MUNICIPAL STATE AID
STREET SYSTEM**

LEGEND

- MUNICIPAL COUNTY STATE AID STREET..... (—)
- MUNICIPAL STATE AID STREET..... (—)
- COUNTY STATE AID HIGHWAY..... (—)
- COUNTY ROAD..... (—)
- TRUNK HIGHWAY..... (—)

VOLUMES PREPARED BY
TRANSPORTATION RESEARCH AND
INVESTMENT MANAGEMENT DIVISION

NUMERALS INDICATE AVERAGE DAILY
TRAFFIC VOLUMES ON DESIGNATED ROADS
NOTE: T.H. ROUTES ARE 1998 A.A.D.T. VOLUMES

FOR DESIGNATED ROADS :
/ = SEGMENT ENDPOINT FOR ALL
ROADS INTERSECTED BY HATCH
(= SEGMENT ENDPOINT ONLY FOR
ROAD SEPARATED FROM INTERSECTING
ROAD BY ARC