

PREPARED BY  
HIGHWAY PLANNING SURVEY  
IN COOPERATION WITH  
U.S. PUBLIC ROADS ADMINISTRATION

STATE OF MINNESOTA  
DEPARTMENT OF HIGHWAYS  
ROAD LIFE STUDIES  
CONSTRUCTION PROJECT LOG RECORD

CONTROL SECTION 8509  
TRUNK HIGHWAY 76  
COUNTY Winona  
DISTRICT 6A

LIMITS: S. Co. Line - Jct. T.H. 43

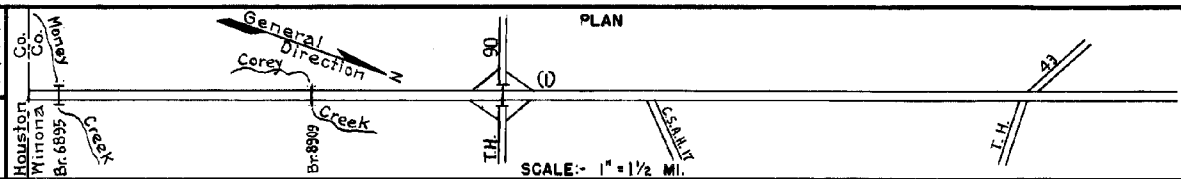

YEAR BUILT	PROJECT N <sup>o</sup>	DESCRIPTION				CODE N <sup>o</sup>
		TYPE	WIDTH	THICKNESS	REMARKS	
		Gravel	20'	1"	No Record of Constr. Added in 1934	
		Br. X-840, 6258, 8404	16'20"		50' B.T., 32' B.S. & 4' B.S.	
		(1) Brick	8'	3 1/2"	No Record of Constr. Added in 1934	
		(2) Concrete	8'	7"	No Record of Constr. Added in 1934	
1915		Br. 1654	18'		23' B.S. Added in 1934	
1934		Br. 3547	19'		70' L.T.	
C		Grading	28'			
1940	A.F.E. 42 & 43	Crushed Rock	28'	1"	Maint. Dept.	
C		Reshaping & Culverts	28'		Maint. Dept.	
1941	A.F.E. 34	Crushed Rock	28'		989 C.Y./Mi. Maint. Dept.	
C&M		Br. 6364	24'		40' B.S. Replaces Br. 6258.	
1942	Gang 2	Br. 1654	28'		23' B.S. Widening.	
M		Crushed Rock Resurfacing			15262 Tons	
1948	A.F.E. 6	Bit. Surfacing			MC 3, 11828 Gal.	
C		Mixed Bit.	24'	1"		
1948	A.F.E. 34	Spot Treat.			MC 3 563, 2030 Gal.	
M		Bit. Surf. Repair	24'		Agg. 350 C.Y.	
1949	A.F.E. 4	Spot Fog Seal	24'			
M		Spot Treat.			MC 2 63, 4323 Gal.	
1950	A.F.E. 4	Bit. Surf. Repair	24'		Agg. 240 C.Y.	
M		Spot Fog Seal				
1950	A.F.E. 6	Crushed Rock Resurfacing			661 C.Y. (Spots, Net 300 Mi)	

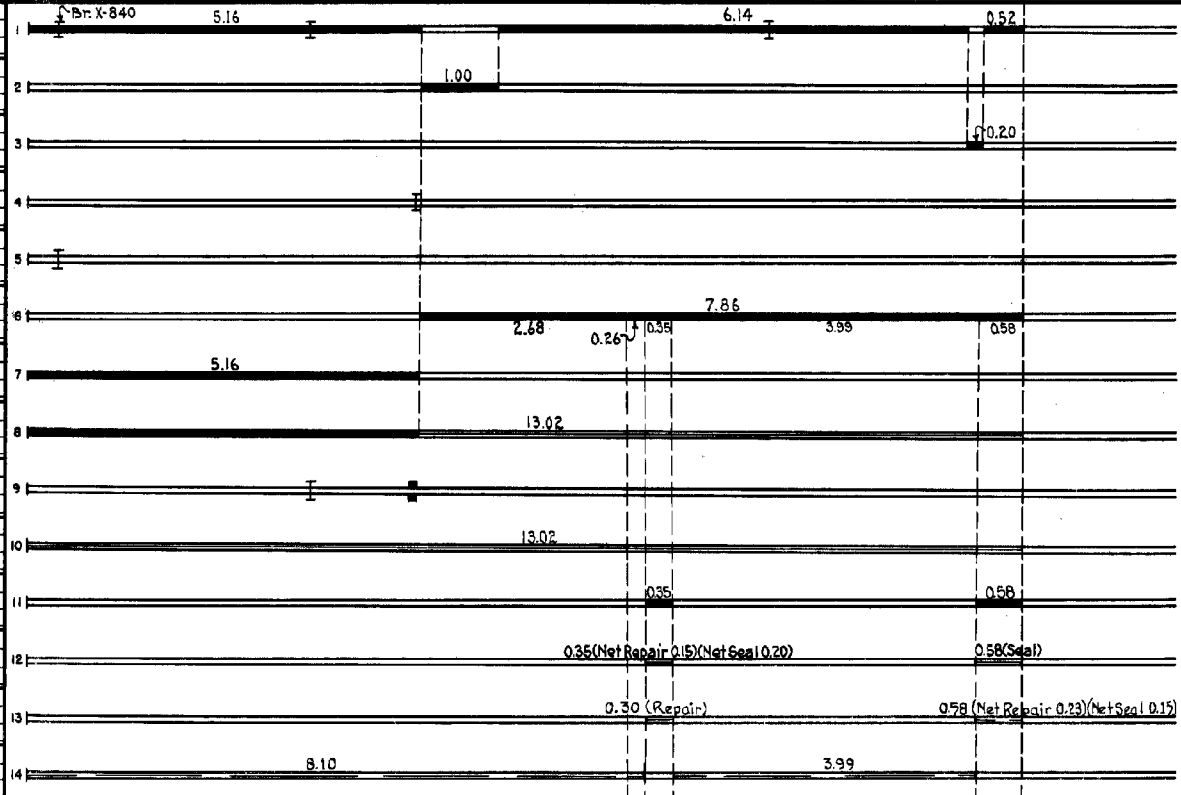

YEARS FROM	TOTAL MILES TO	UNINCORPORATED		INCORPORATED		RURAL		URBAN	
		RDWY. MI.	BR. MI.	RDWY. MI.	BR. MI.	RDWY. MI.	BR. MI.	RDWY. MI.	BR. MI.
1934	1955	3.02	13.00	0.02	0.00	13.00	0.02	0.00	0.00
1956		12.74	12.71	0.03	0.00	12.71	0.03	0.00	0.00

REMARKS: Layout to scale as of 1934

(1) 24' top with B of Brick & 16 of Gravel. (2) 20' top with 8' Concrete & 12 of Gravel.

4-75

PREPARED BY  
HIGHWAY PLANNING SURVEY  
IN COOPERATION WITH  
U. S. PUBLIC ROADS ADMINISTRATION

STATE OF MINNESOTA  
DEPARTMENT OF HIGHWAYS  
ROAD LIFE STUDIES  
CONSTRUCTION PROJECT LOG RECORD

CONTROL SECTION 8509  
TRUNK HIGHWAY 76  
COUNTY Winona  
DISTRICT 6A

LIMITS: S. Co. Line - Jct. T.H. 43

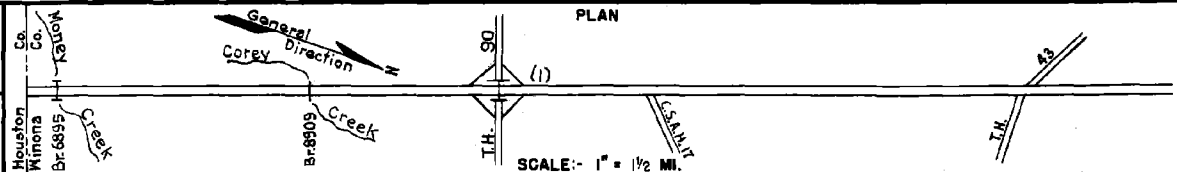

YEAR BUILT	PROJECT NO.	DESCRIPTION		REMARKS	CODE NO.	PLAN	
		TYPE	WIDTH THICK- NESS			8.10	3.99
M 1951	A.F.E. 6	Grav. Resurfacing	25'	5699 Tons			
M 1951	A.F.E. 4	Spot Treat Bit. Surf. Repair	24'	MC-2, 5596 Gal. Agg. 362 C.Y. (Net 0.70 Mi.)		0.35	0.58
M 1952	A.F.E. 6	Cr. Rock Resurf.	24'	9697 Tons		8.10	3.99
M 1952	A.F.E. 4	Bit. Surf. Repair & Light Bit. Seal	24'	MC-2, 2156 Gal. Agg. 65 C.Y.		0.35	0.58
C 1953	A.F.E. 819 A.F.E. 820	Bit. Resurfacing Mixed Bit.	24'	SC-3, 8681 Gal. Agg. 520 C.Y.		0.35	0.58
M 1954	A.F.E. 604	Spot Treat Bit. Surf. Repair Spot Light Bit. Seal	24'	MC-3, 2486 Gal. Agg. 103 Tons		0.35 (Net Repair 0.20) (Net Seal 0.19)	0.58 (Net Repair 0.08) (Net Seal 0.39)
M 1955	A.F.E. 606	Cr. Rock Resurfacing (Spot)	24'	3245 Tons		8.10 (Net 3.50)	3.99
M 1955	A.F.E. 604	Spot Treat Bit. Surf. Repair (Net 0.72 Mi.)	24'	SC-3, 5489 Gal. Agg. 363 Tons		0.35	0.58
M 1956	A.F.E. 604	Spot Treat Bit. Surf. Repair	24'			0.35	0.58
M 1956	A.F.E. 606	Cr. Rock Resurfacing (Spot)	24'	4818 Tons			3.99 (Net 1.00)
C 1956	A.F.E. 822* 8509-03 8509-04	Grading Crushed Rock Br. 6895	42" 34" 2" 30"	*Covers Guard Rail C1210(Dr. 8509) & C1212H 135 B.E.		7.56	
M 1958	A.F.E. 606	Cr. Rock Resurfacing		2076 Tons			3.99
C 1958	8509-05	Cr. Rock Base Plant Mix Bit.	24" 12" 24" 2"			7.97	
M 1959	A.F.E. 604	Bit. Surf. Repair	24'	SC-3 & MC-2, 2127 Gal. Agg. 167 Tons		12.74 (Net 0.32)	

YEARS FROM TO		TOTAL MILES	UNINCORPORATED		INCORPORATED		RURAL		URBAN	
FROM	TO		ROWY. MI.	BR. MI.	ROWY. MI.	BR. MI.	ROWY. MI.	BR. MI.	ROWY. MI.	BR. MI.

REMARKS: See Sheet No. 1

4-75

PREPARED BY  
TRAFFIC AND PLANNING DIVISION  
IN COOPERATION WITH  
U.S. DEPARTMENT OF COMMERCE  
BUREAU OF PUBLIC ROADS

STATE OF MINNESOTA  
DEPARTMENT OF HIGHWAYS  
ROAD LIFE STUDIES  
CONSTRUCTION PROJECT LOG RECORD

CONTROL SECTION 8509  
TRUNK HIGHWAY 76  
COUNTY Winona  
DISTRICT 6A

LIMITS: S. Co. Line - Jct. T.H. 43

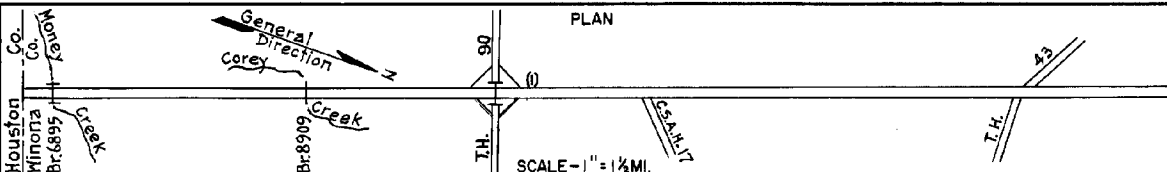

YEAR BUILT	PROJECT NO.	DESCRIPTION				REMARKS
		TYPE	WIDTH	THICKNESS		
M 1960		Cr. Rock Resurfacing	24'		1003 Tons	
C&M 1961	8509-06	Grading Crushed Rock Random Rip Rap	36' 26'			By Maint. Div.
C&M 1962		Crushed Rock Base Road Mix Bit. Bit Surf. Repair	30' 24'	5"		Bit Mix 41 Tons
C&M 1963	c-sf	Light Bit. Seal	2.5'		RS-2K, 20525 Gal. Agg. 710 C.Y.	
M 1964	c	Light Bit. Seal	2.5'		RS-2K, 8366 Gal. Agg. 304 C.Y.	
M 1966	SF	Bit. Surf. Repair	24'	3/4"	Bit Mat'l 3458 Gal. Agg. 184 C.Y.	12.74 (Net 0.53)
M 1967	C	Light Bit. Seal	2.5'		CRS-1, 21497 Gal. Agg. 719 C.Y.	12.74 (Net 12.69)
M 1969	SF	Spot Bit. Repair	24'	3/4"	MC250 Tack 600 Gal. Agg. 662 Tons	12.74 (Net 100)
C 1972	8580-25	Grade, Gravel Base Plant Mix Bit. Surf. Gravel & Bit. Should.	24'	6" 2"		Relocation Lengthens 0.06 Mi.
C 1972	8580-58	Grade, Gravel Base Plant Mix Bit. Surf. Gravel Shoulders	24'	13" 1 1/2"		Relocation Shortens 0.32 Mi.
C 1972	8580-76	Grade, Gravel Base Plant Mix Bit. Surf. Gravel Shoulders	24'	16" 2"		Relocation Shortens 0.22 mi.
M 1972	SF	Spot Surf. Repair	24'	1/2"	RC-800 1792 Gal. Agg. 182 Tons	12.26 (Net Repair 0.80)
M 1972	SF	Seal Coat with Agg			Bit Mat'l 23045 Agg. 905 Cu. Yd.	5.00
M 1972	SF	Bit. Surf. Repair	24"	1/2"	RC-800 6830 Gal. Agg. 1187 Tons	5.00 (Net Repair 390)

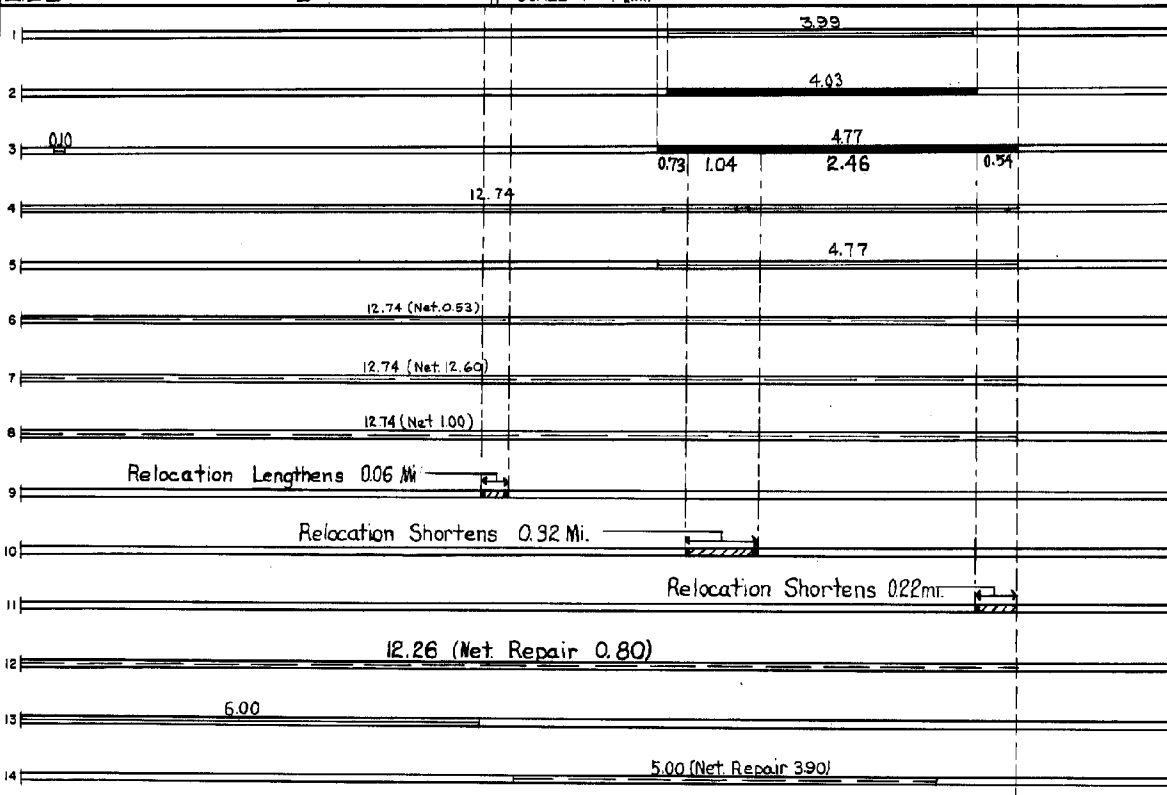

YEARS		TOTAL MILES	UNINCORPORATED		INCORPORATED		RURAL		URBAN	
FROM	TO		RDWY. MI.	BR. MI.	RDWY. MI.	BR. MI.	RDWY. MI.	BR. MI.	RDWY. MI.	BR. MI.

REMARKS: See Sheet No. 1 See C.S. 8580 for information on Bridge

4-75

PREPARED BY  
 TRANSPORTATION PLANNING AND PROGRAMMING DIVISION  
 IN COOPERATION WITH  
 U.S. DEPARTMENT OF TRANSPORTATION - FEDERAL HIGHWAY ADMINISTRATION

STATE OF MINNESOTA  
 DEPARTMENT OF HIGHWAYS  
 ROAD LIFE STUDIES  
 CONSTRUCTION PROJECT LOG RECORD

CONTROL SECTION 8509  
 TRUNK HIGHWAY 76  
 COUNTY Winona  
 DISTRICT 6A

LIMITS: S. Co. Line - C.S.A.H. 12  
 Ref. Pt. 030+00.591 - 036+00.909

YEAR BUILT	PROJECT NO	DESCRIPTION	WIDTH		REMARKS
			TYPE	THICKNESS	
C 1974	-10	P. Mix Bit Surf. Gravel Shoulders	24'	2-3'	Exception 0.13 Mi.
C 1976	8509-12	Bit. Resurfacing	24'	2 1/2"	
C 1989	8509-13	Bit. Overlay	24'	1 1/2"	Spec. 2331
2011	8509-14	Milling Bit. Overlay	var.	var. 3"	Spec. 2360

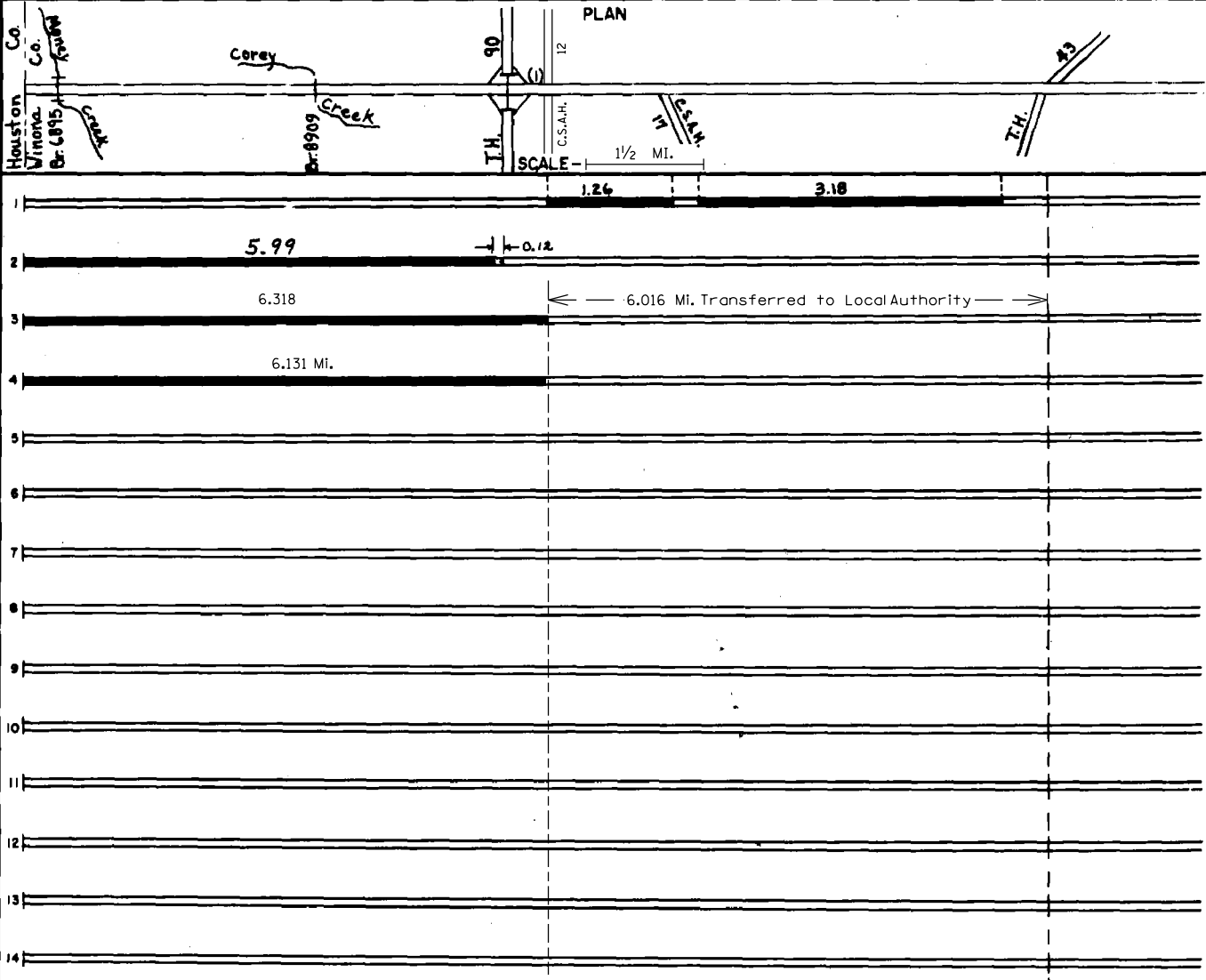

YEARS		TOTAL MILES	UNINCORPORATED		INCORPORATED		RURAL		URBAN	
FROM	TO		RDWY. MI.	BR. MI.	RDWY. MI.	BR. MI.	RDWY. MI.	BR. MI.	RDWY. MI.	BR. MI.

REMARKS: See Sheet No. 1 (1) See C.S. 8580 for Information on Bridge