

PREPARED BY
HIGHWAY PLANNING SURVEY
IN COOPERATION WITH
U.S. PUBLIC ROADS ADMINISTRATION

STATE OF MINNESOTA
DEPARTMENT OF HIGHWAYS
ROAD LIFE STUDIES
CONSTRUCTION PROJECT LOG RECORD

CONTROL SECTION 8204
TRUNK HIGHWAY 36
COUNTY Washington
DISTRICT 9A

LIMITS: Jct. T.H. 120 - Jct. T.H. 212.

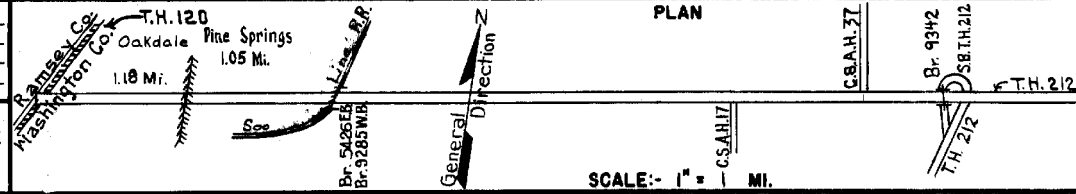

| YEAR BUILT | PROJECT N° | DESCRIPTION | | | CODE N° |
|------------|---------------------|-----------------------------------|-------|-----------|---|
| | | TYPE | WIDTH | THICKNESS | |
| | | Asph. Tr. Gravel | 20' | 1" | No Record of Constr. |
| | | | | | Added in 1934. |
| 1929 | | Grading Gravel | 26' | 2 3/4" | Co. Job 2904. 1374 C.Y./Mile. Added in 1934. |
| 1934 | 36-118-22 | Grading Br. 5426 | 32' | 30" | Added in 1934. 162 C.D.G.-O.H. |
| | (1) | | | | |
| 1935 | 36-118-22 | C.C. Stab. Gravel | 36' | 3" | Maint. Dept. |
| 1937 | A.F.E. 24 | Mixed Bit. | 28' | 1" | Maint. Dept. |
| 1937 | A.F.E. 24 | Mixed Bit. | 24' | 1" | Maint. Dept. |
| C | | Grading | 32' | | |
| 1940 | 8204-01 | Stab. Grav. Base Mixed Bit. | 32' | 3" | 26' 1/2" |
| C | | Seeding | | | |
| 1940 | 8204-02 A.F.E. 8 | | | | Maint. Dept. |
| M | | Bit. Retreat. | 22' | | RT-6, 5106 Gal./Mi. Grav. 271 C.Y./Mi. Maint. Dept. |
| 1940 | A.F.E. 45 | | | | |
| M | | Bit. Retreat. | 22' | | SC-4, 3753 Gal./Mi. Grav. 272 C.Y./Mi. Maint. Dept. |
| 1941 | A.F.E. 25 | | | | |
| M | | Bit. Seal Coat | | | RT-10, 2210 Gal./Mi. Agg. 64 C.Y./Mi. Maint. Div. |
| 1944 | A.F.E. 5 | | | | |
| M | | Bit. Surface Repair & Fog Seal | 22' | | RT-6, 70104 Gal. Agg. 3555 C.Y. |
| 1947 | A.F.E. 4 | | | | |
| M | | Light Bit. Seal | 24' | | RT-8, 9318 Gal. Agg. 333 C.Y. |
| 1950 | A.F.E. 4 | | | | |
| M | | Spot Treat. Bit. Surf. Repair | | | MC38 RT-6, 32482 Gal. Agg. 2027 C.Y. |
| 1952 | A.F.E. 4 | | | | |

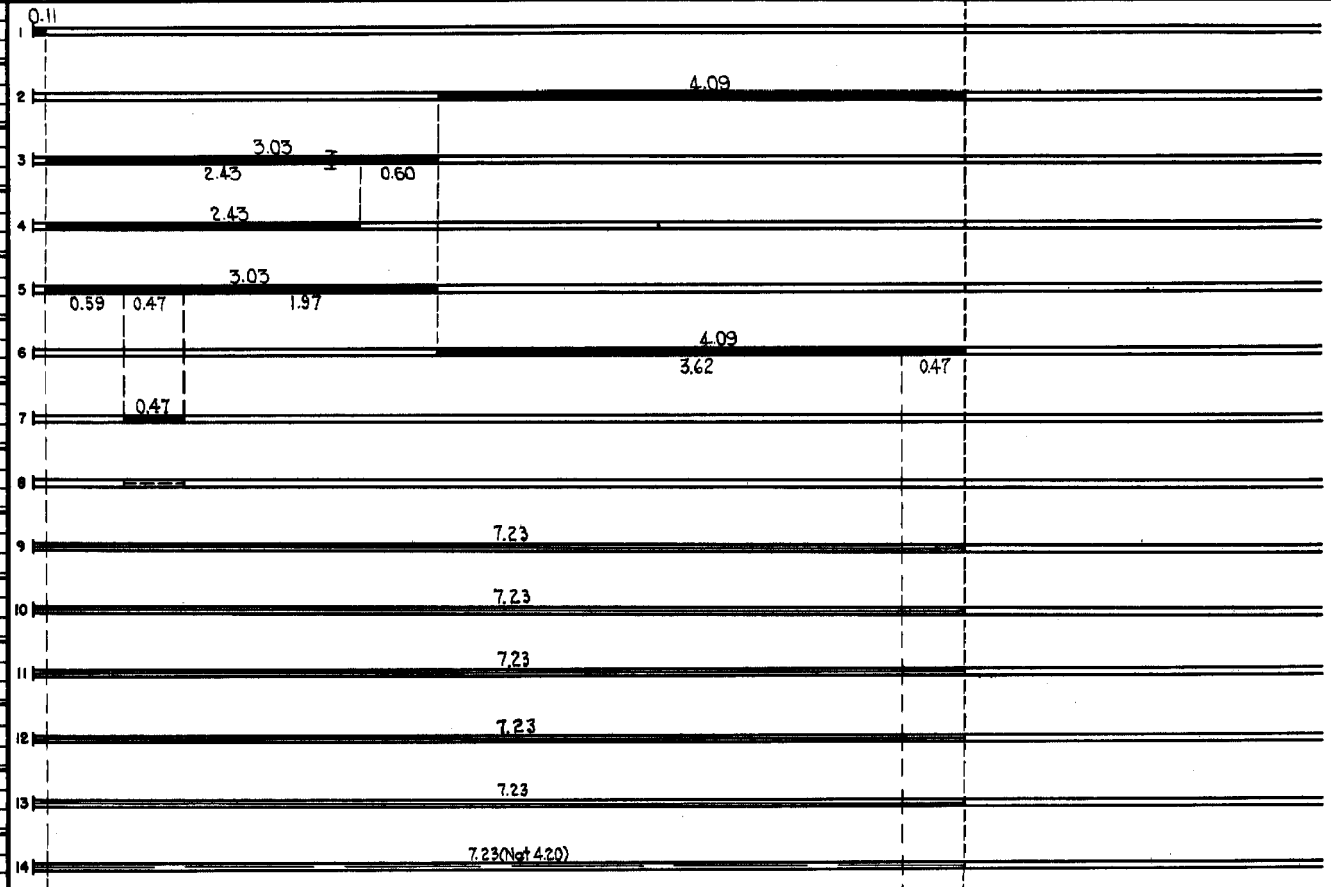

| YEARS | | TOTAL MILES | UNINCORPORATED | | INCORPORATED | | RURAL | | URBAN | |
|-------|------|-------------|----------------|---------|--------------|---------|-----------|---------|-----------|---------|
| FROM | TO | | ROWY. MI. | BR. MI. | ROWY. MI. | BR. MI. | ROWY. MI. | BR. MI. | ROWY. MI. | BR. MI. |
| 1954 | 1954 | 7.23 | 7.20 | 0.03 | 0.00 | 0.00 | 7.20 | 0.03 | 0.00 | 0.00 |
| 1955 | 1958 | 7.26 | 7.23 | 0.03 | 0.00 | 0.00 | 7.23 | 0.03 | 0.00 | 0.00 |
| 1959 | 1959 | 7.26 | 6.00 | 0.00 | 1.23 | 0.03 | 7.23 | 0.03 | 0.00 | 0.00 |
| 1960 | 1967 | 7.33 | 6.25 | 0.03 | 1.05 | 0.00 | 7.30 | 0.03 | 0.00 | 0.00 |
| 1968 | | 7.33 | 5.07 | 0.03 | 2.23 | 0.00 | 6.12 | 0.03 | 1.18 | 0.00 |

REMARKS: Layout is to scale as of 1934.
(1) This work not done under this project number but lies within the limits of this project.

PREPARED BY
HIGHWAY PLANNING SURVEY
IN COOPERATION WITH
U.S. PUBLIC ROADS ADMINISTRATION

STATE OF MINNESOTA
DEPARTMENT OF HIGHWAYS
ROAD LIFE STUDIES
CONSTRUCTION PROJECT LOG RECORD

CONTROL SECTION 8204
TRUNK HIGHWAY 36
COUNTY Washington
DISTRICT 9A

LIMITS: Jct. T.H. 120 - Jct. T.H. 212

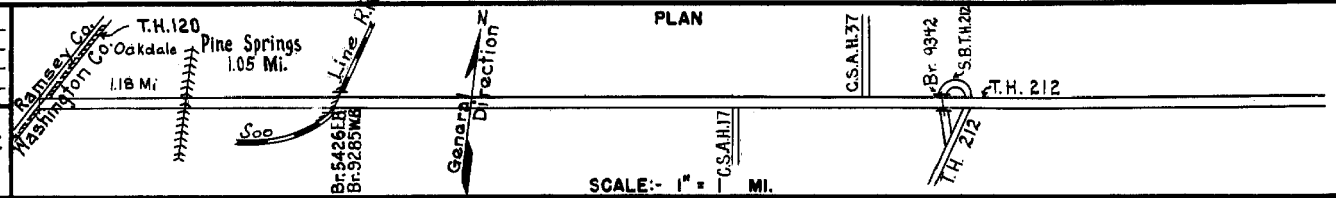

| YEAR BUILT | PROJECT N ^o | DESCRIPTION | | | CODE N ^o |
|------------|------------------------|--|-----------------|-----------|---------------------|
| | | TYPE | WIDTH | THICKNESS | |
| M | 1953 A.F.E. 604 | Spot Treat Bit. Surf. Repair | | | |
| M | 1954 A.F.E. 604 | Spot Treat Bit. Surf. Repair | 24' | | |
| M | 1955 A.F.E. 605 | Light Bit. Seal | 22' | | |
| C | 1955 8204-06 | Grading | 38' | | |
| C | 1955 8204-09 | Bit. Stab. Base Plant Mix Bit. | 38' 6" / 24' 3" | | |
| M | 1956 A.F.E. 604 | Bit. Surf. Repair | | | |
| M | 1957 A.F.E. 604 | Spot Treat Bit. Surf. Repair | 24' | | |
| C | 1959 8204-12 | Br. 9285 | 30' | | |
| C | 1960 8204-11 | Grading Gravel & Bit. Base Road Mix bit. Surf. | 22' 6" 1 1/2" | | |
| C | 1960 8214-28 / 8214-25 | Grading & Base Road Mix bit. Surf. Br. 9342 | 22' 1 1/2" | | |
| C | 1961 B204-14(1) | Asphaltic Conc. Bit. Shoulders | 22' 4" | | |
| M | 1965 SF | Buld Turn Lane At C.S.A.H. 37 | 15' 3" | | |
| C | 1967 B204-16 | Slope Paving Repair on Br. 9342 | | | |
| C | 1970 B204-18 | Turn Lanes at DeMontreville Rd. Frontage Rd. C.S.A.H. 37 | | | |

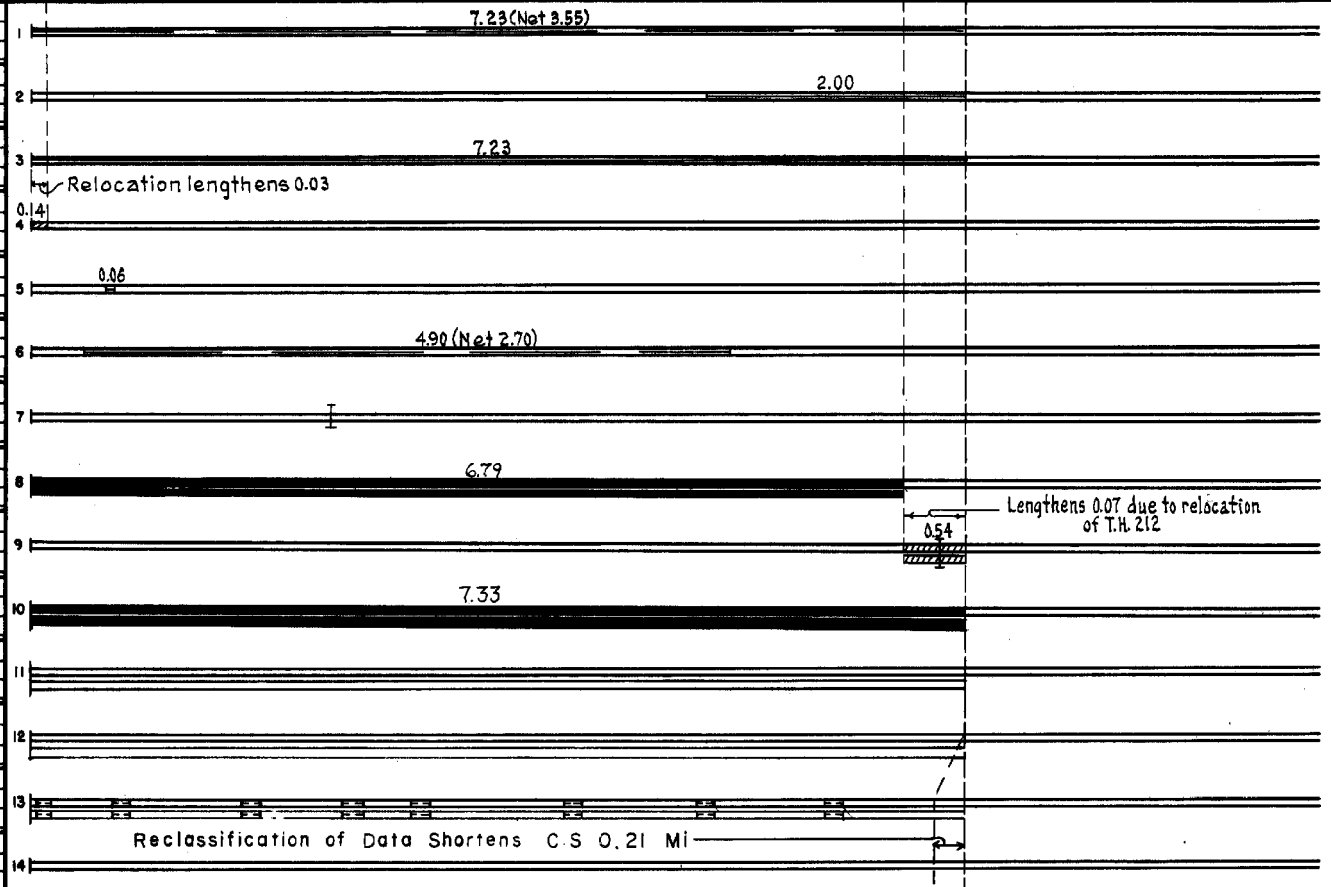

| YEARS | | TOTAL MILES | UNINCORPORATED | | INCORPORATED | | RURAL | | URBAN | |
|-------|----|-------------|----------------|---------|--------------|---------|-----------|---------|-----------|---------|
| FROM | TO | | RDWY. MI. | BR. MI. | RDWY. MI. | BR. MI. | RDWY. MI. | BR. MI. | RDWY. MI. | BR. MI. |
| | | | | | | | | | | |

REMARKS: See Sheet No. 1
(1) From Mi. Pt. 7.12 at Br. 9342 to Jct. T.H. 212 done under S.P. 8214-33.

