

PREPARED BY
HIGHWAY PLANNING SURVEY
IN COOPERATION WITH
U.S. PUBLIC ROADS ADMINISTRATION

STATE OF MINNESOTA
DEPARTMENT OF HIGHWAYS
ROAD LIFE STUDIES
CONSTRUCTION PROJECT LOG RECORD

CONTROL SECTION 8105
TRUNK HIGHWAY 30
COUNTY Waseca
DISTRICT 7A

LIMITS: W. Co. Line - N. Jct. T.H. 13 E. of New Richland.

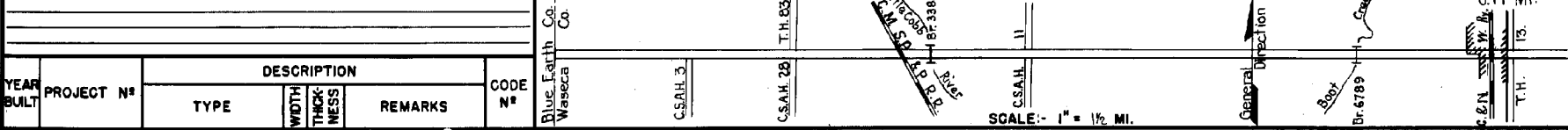

YEAR BUILT	PROJECT N°	DESCRIPTION		REMARKS	CODE N°	MILEPOST
		TYPE	WIDTH THICKNESS			
		Gravel	18' 3"	No Record of Constr. Added in 1934.		9.99
		Br. 5368 & 2359	17-19	75 C.D.G. & 30 B.S.		9.64
		Gravel	22' 2"	No Record of Constr. Added in 1934.		0.65
1927		Gravel	16' 2 1/2"	Co. Job 2707. 1200 C.Y./Mile. Added in 1934.		3.51
1935		Oil Tr. Gravel	22' 1 1/2"	Maint. Dept.		0.85
M&C 1940	A.F.E. 10	Regraveling		417 C.Y./Mile. Maint. Dept.		14.15
C 1941	A.F.E. 12	Bit Surf Treat.	26' 3/4"	SC-4 7616 Gal./Mi. Grav. 502 C.Y./Mi. Maint. Dept.		1.00
M 1943	A.F.E. 17	Grade Lifts & Grav. Resurface (Spots)		175 C.Y./Mi. Maint. Dept.		13.15
M 1944	A.F.E. 6	Grav. Resurfacing (Spots)		90 C.Y./Mi. Maint. Div.		13.15
M 1946	A.F.E. 6	Grav. Resurfacing (Spots)		2053 C.Y.		13.15 (Net 8.70)
C 1947	8105-01	Grading	32'			0.08
		Stab. Gravel	32' 2"	1200 C.Y./Mi.		
M 1948	A.F.E. 6	Grav. Resurfacing (Spots)		352 C.Y.		13.15 (Net 11.00)
C 1948	8105-02	Bit Surf. Treated	26' 3/4"			0.37
M 1949	A.F.E. 6	Grav. Resurfacing (Spots)		376 C.Y.		13.15
CPM 1950	A.F.E. 6	Grav. Resurfacing (Spots)	24'	992 C.Y.		13.50 (Net 4.60)

FROM	TO	TOTAL MILES	UNINCORPORATED		INCORPORATED		RURAL		URBAN	
			RDWY. MI.	BR. MI.	RDWY. MI.	BR. MI.	RDWY. MI.	BR. MI.	RDWY. MI.	BR. MI.
1934	1947	14.15	3.49	0.01	0.65	0.00	14.14	0.01	0.00	0.00
1948	1951	14.16	3.50	0.01	0.65	0.00	14.15	0.01	0.00	0.00
1952	1959	14.05	3.52	0.01	0.65	0.00	14.04	0.01	0.00	0.00
1960	1961	14.05	3.39	0.01	0.65	0.00	3.39	0.01	0.65	0.00
1962	1964	14.05	3.30	0.01	0.74	0.00	3.30	0.01	0.74	0.00
1965		14.05	3.35	0.01	0.71	0.00	3.35	0.01	0.71	0.00

REMARKS: Layout is to scale as of 1934.

7-7A

PREPARED BY
HIGHWAY PLANNING SURVEY
IN COOPERATION WITH
U.S. PUBLIC ROADS ADMINISTRATION

STATE OF MINNESOTA
DEPARTMENT OF HIGHWAYS
ROAD LIFE STUDIES
CONSTRUCTION PROJECT LOG RECORD

CONTROL SECTION 8105
TRUNK HIGHWAY 30
COUNTY Waseca
DISTRICT 7A

LIMITS: W. Co. Line - N. Jct. T.H. 13 E. of New Richland

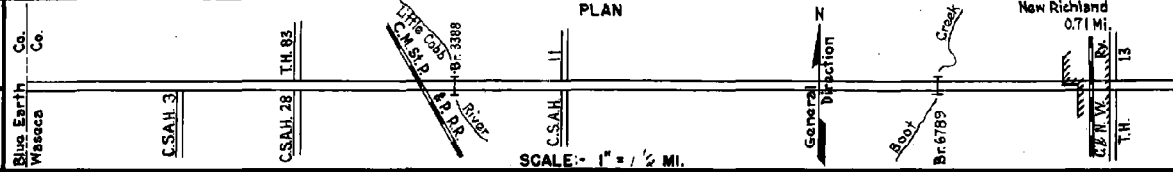

YEAR BUILT	PROJECT N ^o	DESCRIPTION				CODE N ^o
		TYPE	WIDTH	THICK-NESS	REMARKS	
C	A. F. E. 24	Reshaping	37'		SC3, 2902 Gal.	
		Bit. Surfacing			Agg. 190 CY.	
		Bit. Surf. Treat.	28'	1/2"		
C	8105-05	Gravel Base	40'	10"		
(D)		Plant Mix Bit.	40'	2"		
C	8105-04	Grading	34'		Ext. W86D (Br. 8131)	
1952	8105-07	Gravel	30'	1"	600 CY/Mi.	
(2)	8105-06	Widen Br. 3388 - Br. 6789	30'		23 #40 C.D.G.	
M	1953 A. F. E. 606	Grav. Resurfacing			1506 Tons	
M	1954 A. F. E. 606	Grav. Resurfacing			4515 Tons	
C	8105-08	Soil-Cement Base	24'	6"	(30' Top)	
1955		Plant Mix Bit.	24'	2"		
M	1956 A. F. E. 605	Bit. Seal Coat	24'		RS-2, 41117 Gal. Agg. 1810 C.Y.	
M	1961	Spot Treat Bit. Surf. Repair	24'		Bit. Mix 118 Tons Tack 225 Gal. MC-3	
M	1962 SF	Spot Treat Bit. Surf. Repair	24'		Pl. Mix. 161 Tons MC-3, Tack 400 Gal. Pl. Mix 42 Tons (1963)	
M	1964 SF	Spot Treat Bit. Surf. Repair	24'		Plant Mix 82 Tons MC-3, Tack 300 Gal.	
M	1965 C	Light Bit. Seal	24'		RS-1c, 23879 Gal. Agg. 895 C.Y.	
M	1967 SF	Bit. Surf. Repair	24'	3/4"	MC-250 Tack 425 Gal. Pl. Mix Bit Surf 444 Ton	
M	1968 SF	Bit. Surf. Repair	24'	3/4"	MC-250, 2950 Gal. Agg. 1192 Tons	
M	1971 SF	Spot Bit. Repair	24'	3/4"	MC-250, 1,950 Gal. Agg. 666 Ton	

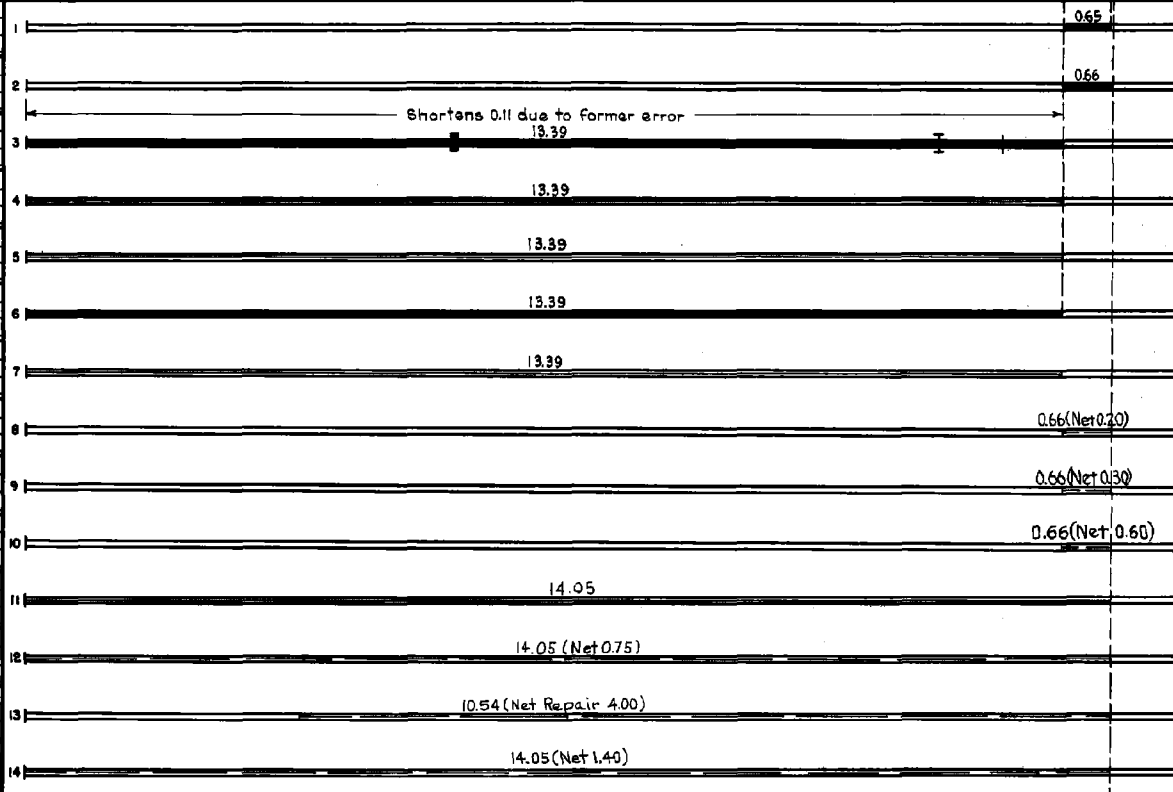

YEARS FROM	TOTAL MILES TO	UNINCORPORATED		INCORPORATED		RURAL		URBAN	
		RDWY. MI.	BR. MI.	RDWY. MI.	BR. MI.	RDWY. MI.	BR. MI.	RDWY. MI.	BR. MI.

REMARKS: See Sheet No. 1
(1) Contract not final but work substantially complete in 1951. (2) Contract on S.P. 8105-04 not final but work substantially complete in 1952.

PREPARED BY
TRANSPORTATION & TRAVEL PLANNING & PROGRAMMING DIVISION
IN COOPERATION WITH
U.S. DEPARTMENT OF TRANSPORTATION-BUREAU OF PUBLIC ROADS

STATE OF MINNESOTA
DEPARTMENT OF HIGHWAYS
ROAD LIFE STUDIES
CONSTRUCTION PROJECT LOG RECORD

CONTROL SECTION 8105
TRUNK HIGHWAY 30
COUNTY WASECA
DISTRICT 2A

LIMITS: W.Co. Line - N. Jct. T.H. 13 E. of New Richland

Ref. Pt. 154+00.427 - 168+00.464

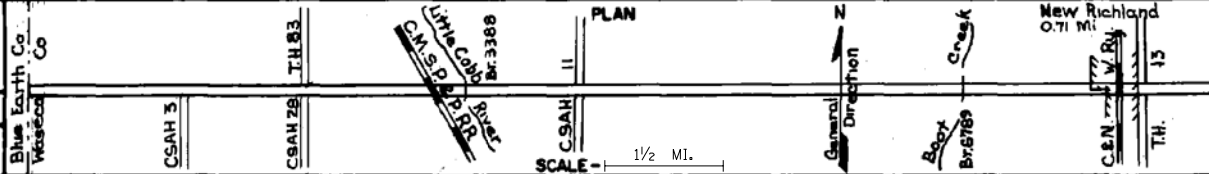

YEAR BUILT	PROJECT NO.	DESCRIPTION			
		TYPE	WIDTH	THICKNESS	REMARKS
C 1973	8105-12	Plant Mix Bit Overlay Right Turn Lanes Gravel Shoulders	24'	2 1/2"	Bit Mix 2255 Tons
M 1982	SF	Bit. Surfacing	24'	1 1/8"	2281 Ton Pl Mix 0.0838 Sp. Yd. Tech
M 1983	SF	Bit. Surfacing	24'	2"	2177 Ton Pl. Mix
M 1984	SF	Shoulder Gravel	3'	4"	1938 Tons for CS 8105B 0707
M 1984	SF	Bit. Spot Overlay	24'	1 1/2"	Sp. 2331 1848 Tons for CS 8105B 0707
C 1985	8105-15	Bit Surfacing Asp. Shoulders	24' 4'	2 1/2" Var.	Sp. 2331
M 1991	SF	Bit. Overlay	24'	2"	Spec. 2331
C 1999	8105-16	Bit. Overlay	28'	2-3"	Spec. 2350
M 2001	8827-16	Major Crack Repair			
U 2003	U10079 8105-18	GRADING & BIT. EDGE DRAINS, SAN. & STORM SEWERS	24'	8"	Spec. 2360

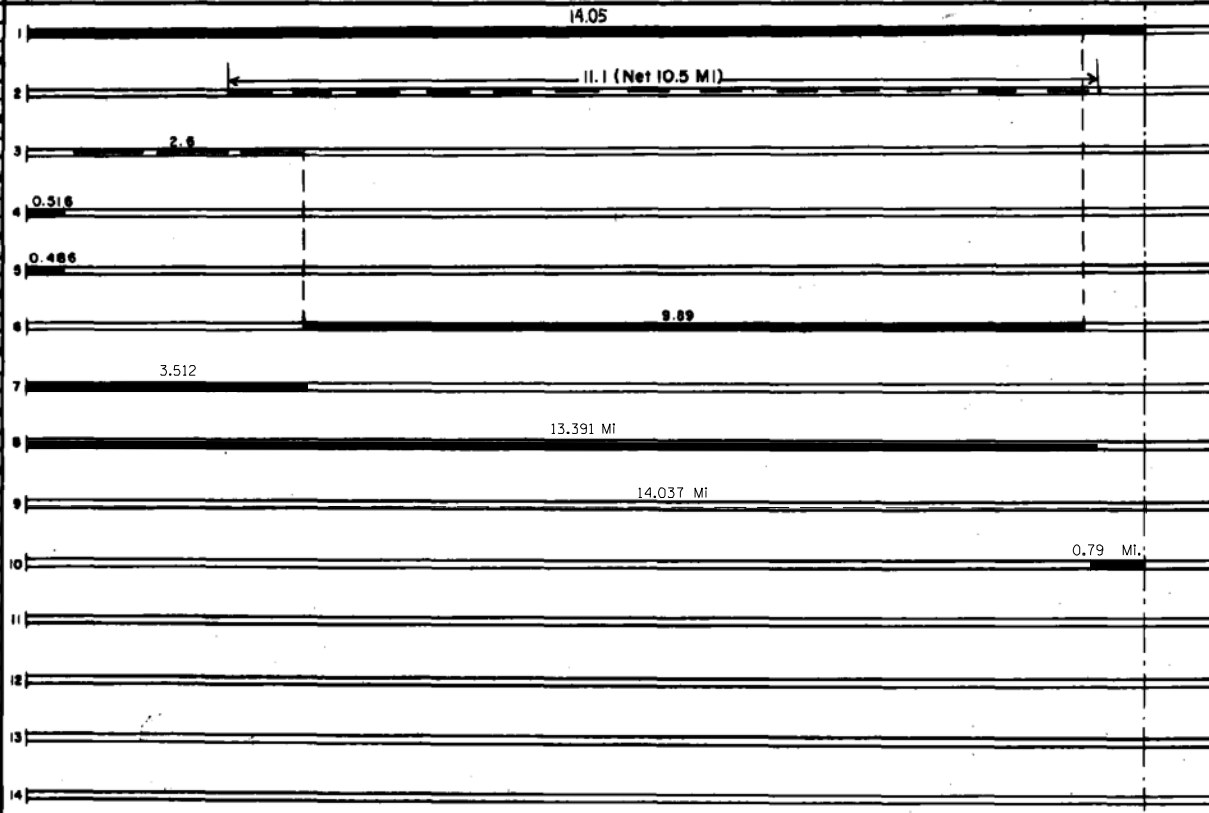

YEARS FROM	TO	TOTAL MILES	UNINCORPORATED		INCORPORATED		RURAL		URBAN	
			ROWY. MI.	BR. MI.	ROWY. MI.	BR. MI.	ROWY. MI.	BR. MI.	ROWY. MI.	BR. MI.

REMARKS: See Sheet No. 1