

PREPARED BY
HIGHWAY PLANNING SURVEY
IN COOPERATION WITH
U.S. PUBLIC ROADS ADMINISTRATION

STATE OF MINNESOTA
DEPARTMENT OF HIGHWAYS
ROAD LIFE STUDIES
CONSTRUCTION PROJECT LOG RECORD

CONTROL SECTION 7903
TRUNK HIGHWAY 60
COUNTY Wabasha
DISTRICT 6A

LIMITS: Jct. T.H. 63 in Zumbro Falls - Jct. T.H. 61 in Wabasha

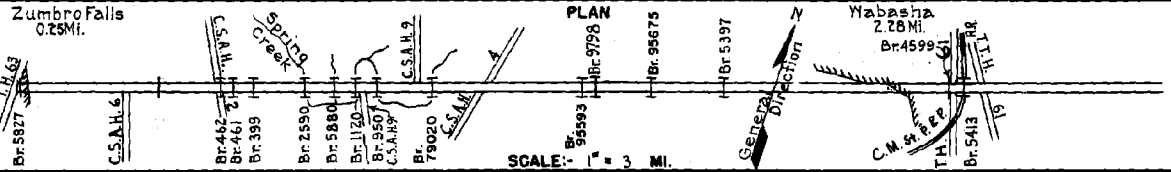

YEAR BUILT	PROJECT N°	DESCRIPTION			CODE N°
		TYPE	WIDTH	THICKNESS	
		Oil Tr. Gravel	24'		No Record of Constr.
		Earth	16'8"		Added in 1934.
		Br. 3861, 8253 & 702	32'		No Record of Constr. Added in 1934.
		Earth	18'20"		35 B.S. 4 C.A. & 16' B.S.
		9 Bridges	4'20"		No Record of Constr. Added in 1934. (1)
		Gravel	16'20"		No Record of Constr. Added in 1934.
		Br. 8251, 6187, X676, X677	16'8"		16 B.S. 24 B.S. 40' L.T. & 70' L.T.
		Br. 462	24'		12 B.S. Replace Br. X688
1934		Br. 461	24'		14 B.S. Replace Br. X687
		Br. 399	20'		10' B.S. Replace Br. X475
1935	60-73-21-1	Grading	32'		
		Grading, Br. 399	32'		W12B
1935	60-73-21-1A to G	Br. 5397	28'		65' D.P.G.
		4599 & 5413			24' M.P. Arch & 0.P.G. U.P.
1935		Crushed Rock & Reshaping	20'	2"	Maint. Dept.
1935	60-73-21-1A to G	Stab. Gravel	24'	3"	
1936	60-73-21-1B-6	Check Dams			
	1937 A.F.E. 26	Grading	30'		
1938	1938 A.F.E. 4	Crushed Rock	24'	2 1/2"	Maint. Dept.
		Grading	32'		
1938	A.F.E. 22	Gravel	24'	2 1/4"	Maint. Dept.
		Br. 462, 461, 399	24'7"		10 B.S. 40' B.S. 16 B.S.
1938		950, 6323 & 380 (2)	24'		60 B.S. 46 B.S. & 35' B.S.
		Wider Br. 8251	24'		16 B.S. Maint. Dept.
1938	A.F.E. 26	Channel Change			Maint. Dept.

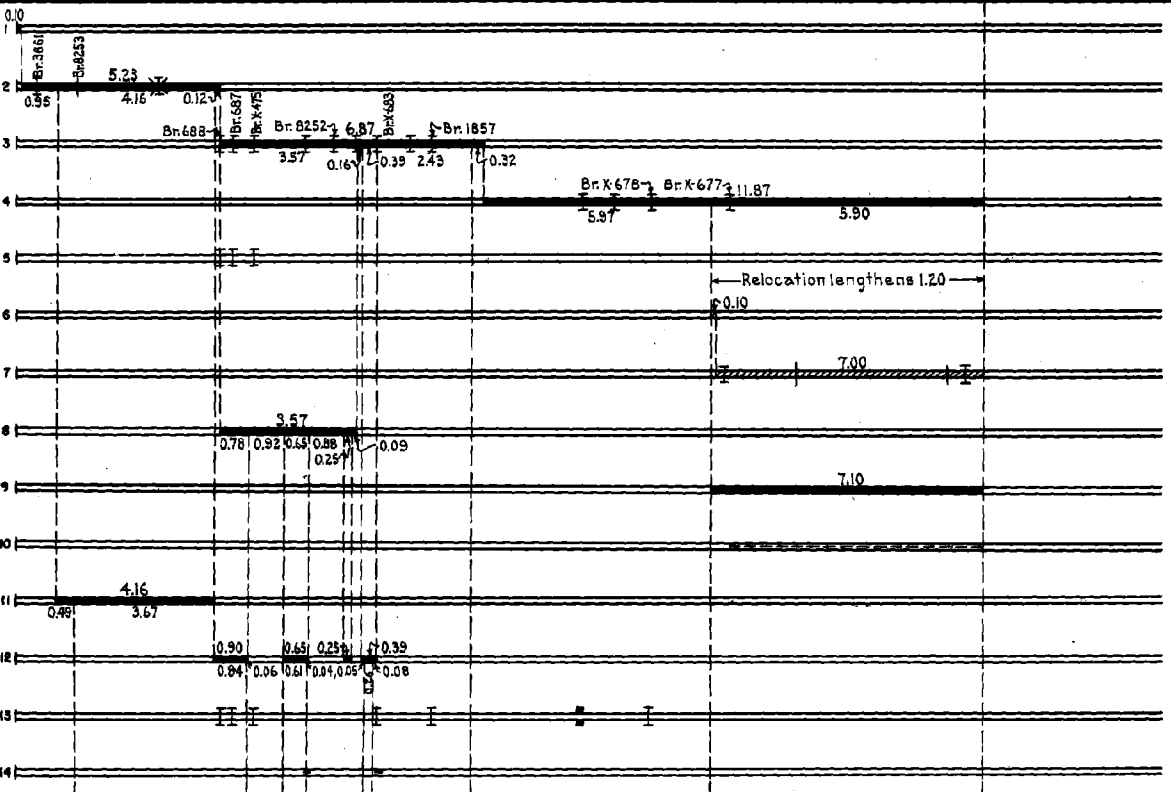

YEARS FROM	TO	TOTAL MILES	UNINCORPORATED		INCORPORATED		RURAL		URBAN	
			RDWY. MI.	BR. MI.	RDWY. MI.	BR. MI.	RDWY. MI.	BR. MI.	RDWY. MI.	BR. MI.
1934	1934	24.07	21.53	0.11	2.43	0.00	21.86	0.11	2.10	0.00
1935	1938	25.27	22.31	0.11	2.85	0.00	22.24	0.11	2.52	0.00
1935	1941	25.00	22.07	0.10	2.83	0.00	22.38	0.10	2.52	0.00
1942	1960	24.81	22.18	0.10	2.53	0.00	22.43	0.10	2.28	0.00
1961		24.71	22.07	0.11	2.53	0.00	22.32	0.11	2.28	0.00

REMARKS: Layout is to scale as of 1935

(1) Br. 688, 10' B.S., Br. 687, 14' B.S., Br. 475, 10' W.S., Br. 2590, 50' L.T., Br. 8252, 14' B.S., Br. 1120, 167' H.T. & B.S., Br. 683, 30' B.S., Br. 1790, 16' B.S., & Br. 1857, 30' B.S.

(2) Br. 462, 461, & 399 reconstructed. Br. 950 replaced Br. X683, Br. 6323 replaces Br. 1857, & Br. 380 replaces Br. 678.

PREPARED BY
HIGHWAY PLANNING SURVEY
IN COOPERATION WITH
U.S. PUBLIC ROADS ADMINISTRATION

STATE OF MINNESOTA
DEPARTMENT OF HIGHWAYS
ROAD LIFE STUDIES
CONSTRUCTION PROJECT LOG RECORD

CONTROL SECTION 7903
TRUNK HIGHWAY 60
COUNTY Wabasha
DISTRICT 6A

LIMITS: Jct. T.H. 63 in Zumbro Falls - Jct. T.H. 61 in Wabasha

Zumbro Falls
0.25 MI.

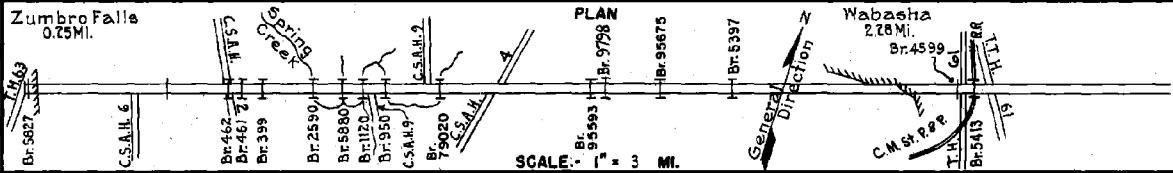

YEAR BUILT	PROJECT N ^o	DESCRIPTION			CODE N ^o
		TYPE	WIDTH	THICK-NESS	
1939	1938 A.F.E. 8 7903-01 & 02 A.F.E. 6-14	Grading Crushed Rock Br. 5827 (M.P. Arch)	33' 30'	1 1/2"	
1940	7903-04	Br. 5880	30'		30' B.S. Replaces Br. 8252
1940	7903-05 & 8 & 9 A.F.E. 7 & 8 & 9	Seeding			Maint. Dept.
1941	A.F.E. 53	Reshaping Cr. Rock Surf.	30'		1050 C.Y./Mi. Maint. Dept.
1942	7903-07	Grading Cr. Rock Surf. Br. 5879 & Mono. Cul.	32'		W.P.A. 3550 C.Y./Mi. C108 & W46
1942	7903-08	Grading Cr. Rock Surf. Br. 8590	32' 32' 4"		W.P.A. W108 (Rep. Br. 1798)
		Bit Surf. Treat.		3/4"	No record of Const. See letter from Bratton (5-12-44)
1945	A.F.E. 6	CaCl ₂ Treated Crushed Rock Resurfacing			999 C.Y./Mi. Maint. Div.
1947	A.F.E. 17 & 27	Spot Grav. Lfite Bit Surfacing Mixed Bit.	24' 24'	1/2" 1"	MC1 & 3, 109144 Gal. Agg. 5021 Tons
1947	A.F.E. 50	Erosion Control			
1948	A.F.E. 4	Spot Treat. Bit Surf. Repair Spot Fog Seal	24' 24'		MG283 & 563, 11931 Gal. Agg. 396 CY
1948	A.F.E. 6	Cr. Rock Resurfacing			7244 Tons
1948	7903-03 A.F.E. 50 (1)	Grading Cr. Rock Base Mixed Bit.	30' 26'	3'-6" 1 1/2"	6"-18" Shale Sub- base in spots
1949	A.F.E. 20	Bit Surfacing Mixed Bit.	24'	1"	MC-02 & 5C-4, 88640 Gal. Agg. 6117 Tons

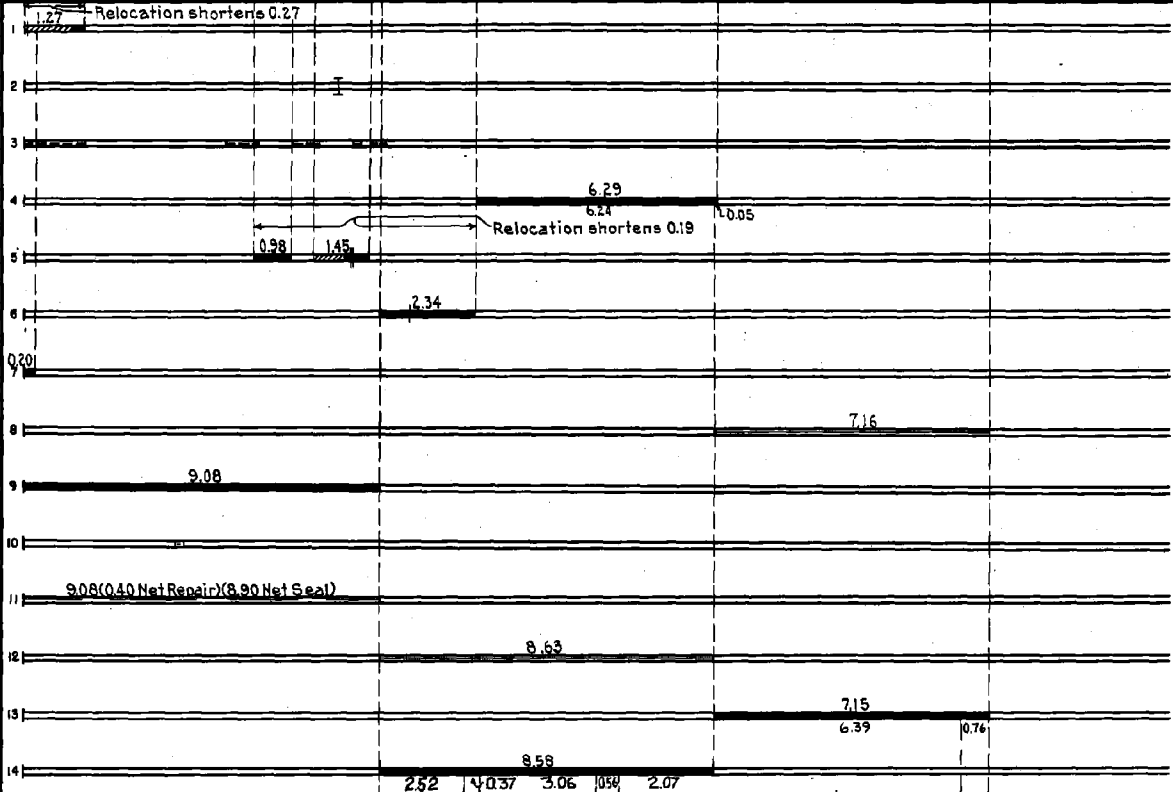

YEARS FROM	TOTAL MILES TO	UNINCORPORATED		INCORPORATED		RURAL		URBAN	
		ROWY MI.	BR. MI.	ROWY MI.	BR. MI.	ROWY MI.	BR. MI.	ROWY MI.	BR. MI.

REMARKS: See Sheet No. 1
(1) A.F.E. 50 covers shouldering at Mi. Pt. 21.50.

PREPARED BY
HIGHWAY PLANNING SURVEY
IN COOPERATION WITH
U.S. PUBLIC ROADS ADMINISTRATION

STATE OF MINNESOTA
DEPARTMENT OF HIGHWAYS
ROAD LIFE STUDIES
CONSTRUCTION PROJECT LOG RECORD

CONTROL SECTION 7903
TRUNK HIGHWAY 60
COUNTY Wabasha
DISTRICT 6A

LIMITS: Jct. T.H. 63 in Zumbro Falls - Jct. T.H. 61 in Wabasha

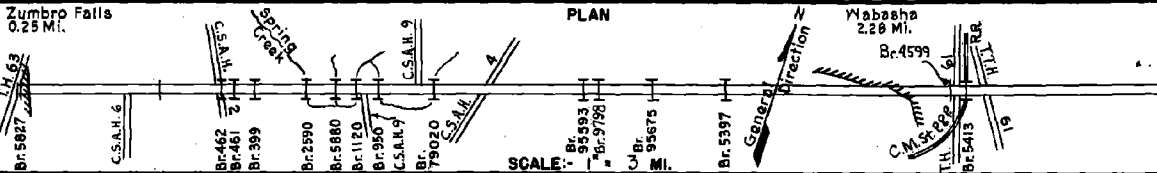

YEAR BUILT	PROJECT N°	DESCRIPTION			CODE N°
		TYPE	WIDTH	THICKNESS	
M		Spot Treat			
1956	A.F.E. 604	Bit. Surf. Repair	24'		
	A.F.E. 605	Spot Light Bit. Seal	24'		
M		Spot Treat			
1957	A.F.E. 604	Bit. Surf. Repair	24'		
M		Spot Treat			
1958	A.F.E. 604	Bit. Surf. Repair	24'		
M		Spot Treat			
1959	A.F.E. 604	Bit. Surf. Repair	24'		
	A.F.E. 605	Light Bit. Seal	27"		
M		Spot Treat			
1960		Bit. Surf. Repair	24'		
M	7903-12	Grading On Rock	32'		
1961		Br. 9798	30'		
		Spot Bit. Surf. Repair	24'		
M		Bit. Surfacing (0.83)			
1962		Bit. Surface Treat	24'		
		Spot Bit. Repair	24'		
M		Light Bit. Seal (Spot)	24'		
1963	SF	Spot Treat			
		Bit. Surf. Repair	24'		
M		Light Bit. Seal	27"		
1964		Spot Treat			
	SF	Bit. Surf. Repair	24'		
M		Spot Treat			
1965	SF	Bit. Surf. Repair	24'	3/4"	
		Light Bit. Seal	24'		
M		Bit. Surf. Repair	24'	3/4"	
1966	SF	Light Bit. Seal	24'		
M		Spot Bit. Surf. Repair	24'	3/4"	
1967	SF	Light Bit. Seal	24'		
M		Spot Bit. Surf. Repair	24'	3/4"	
1968	SF	Light Bit. Seal	24'		
C	7903-21	Remove Br. 702			
1969		Install 2 Culverts			

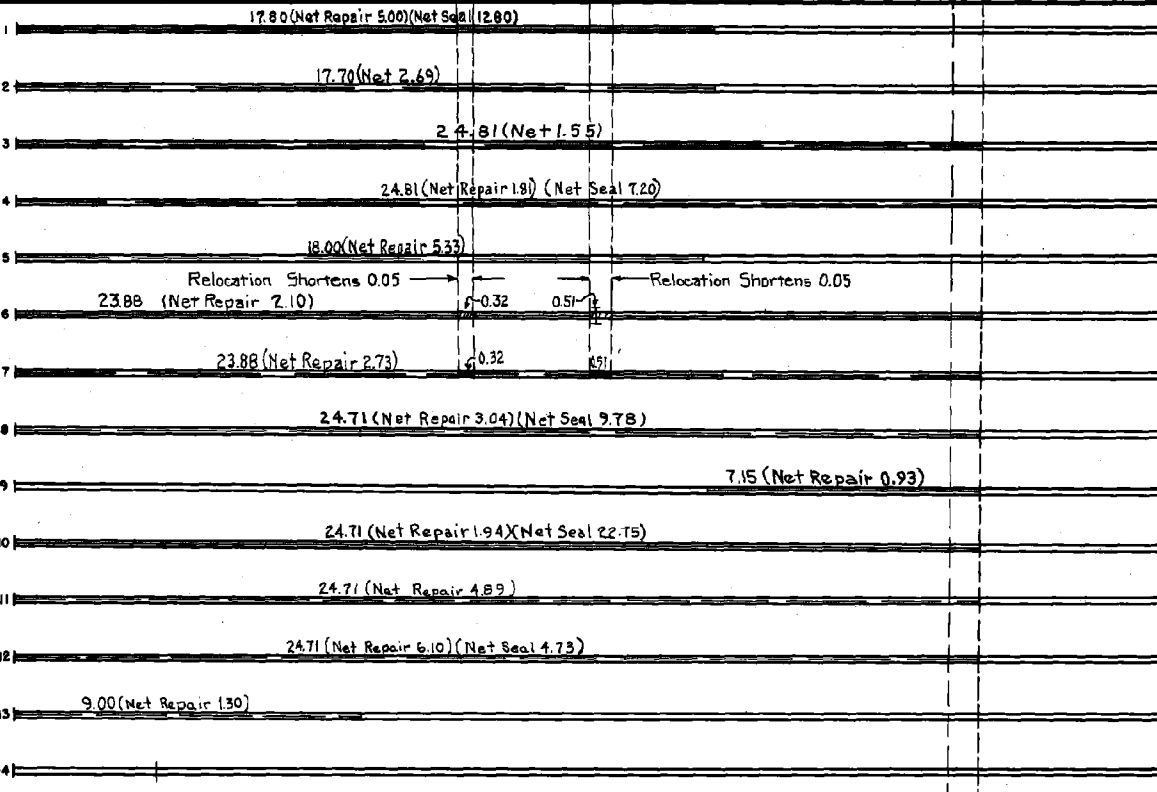

YEARS FROM	TOTAL MILES TO	UNINCORPORATED		INCORPORATED		RURAL		URBAN	
		RDWY. MI.	BR. MI.	RDWY. MI.	BR. MI.	RDWY. MI.	BR. MI.	RDWY. MI.	BR. MI.

REMARKS: See Sheet No. 1

PREPARED BY
TRAFFIC AND PLANNING DIVISION
IN COOPERATION WITH
U.S. DEPARTMENT OF COMMERCE
BUREAU OF PUBLIC ROADS

STATE OF MINNESOTA
DEPARTMENT OF HIGHWAYS
ROAD LIFE STUDIES
CONSTRUCTION PROJECT LOG RECORD

CONTROL SECTION 7903
TRUNK HIGHWAY 60
COUNTY Wabasha
DISTRICT 6A

LIMITS: Jct. T.H. 63 in Zumbro Falls - Jct. T.H. 61 in Wabasha

Zumbro Falls
0.25 Mi.

PLAN

Wabasha
2.28 Mi.
Br. 4599

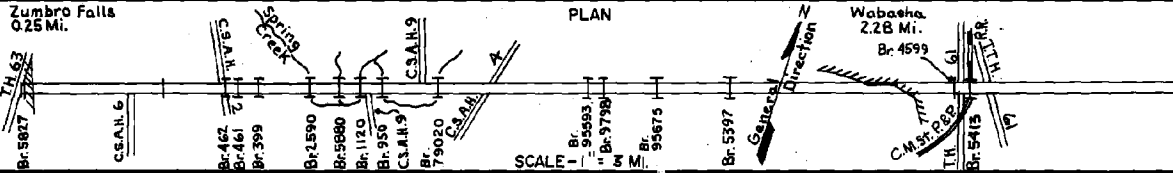

YEAR BUILT	PROJECT NO	TYPE	DESCRIPTION		REMARKS
			WIDTH	THICKNESS	
1967	Maint.	Br. 79015 (1)	30'		Steel Beam Span 114' REPL # 1120
1970	7903-18	Grade Base P.L. Mix Bit. Surf. Gravel Shldr.	24' 40'	6 1/2" 1 1/2"	
1970	SF	Spot Bit. Repair	24'	1/2"	RC-250 60,678 Gal. Agg. 2,670 C.Y.
1972	SF	Spot Bit. Repair	24'	1/2"	
1972	SF	Seal Coat	24'		RC-800 49,000 Gal. Agg. 1,330 C.Y.
1972	SF	Spot Bit. Repair			RC-800 14,800 Gal. Agg. 297 Ton
1975	SF	Bit. Overlay	24'	1"	AC 2341 1355 Ton
1976	SF	Random Bit. Overlay	22'	1"	AC 2331 2845.1 Ton
1976	SF	Seal Coat	24'		CRS-1 3362 Gal. Sand 80 Cu Yd.
1978	SF	Bit. Spot Overlay	20'		P.L. Mix AC 2341 1500 Ton
1978	SF	Bit. Overlay	24'	1 3/4"	P.L. Mix AC 2341 2263 Ton
1979	SF	Bit. Overlay	24'	1 1/2"	P.L. Mix 4782 Ton
1979	SF	Random Bit. Overlay	24'	1 1/2"	
1980	7903-20	Bituminous Resurfacing	22'	1 1/2"	

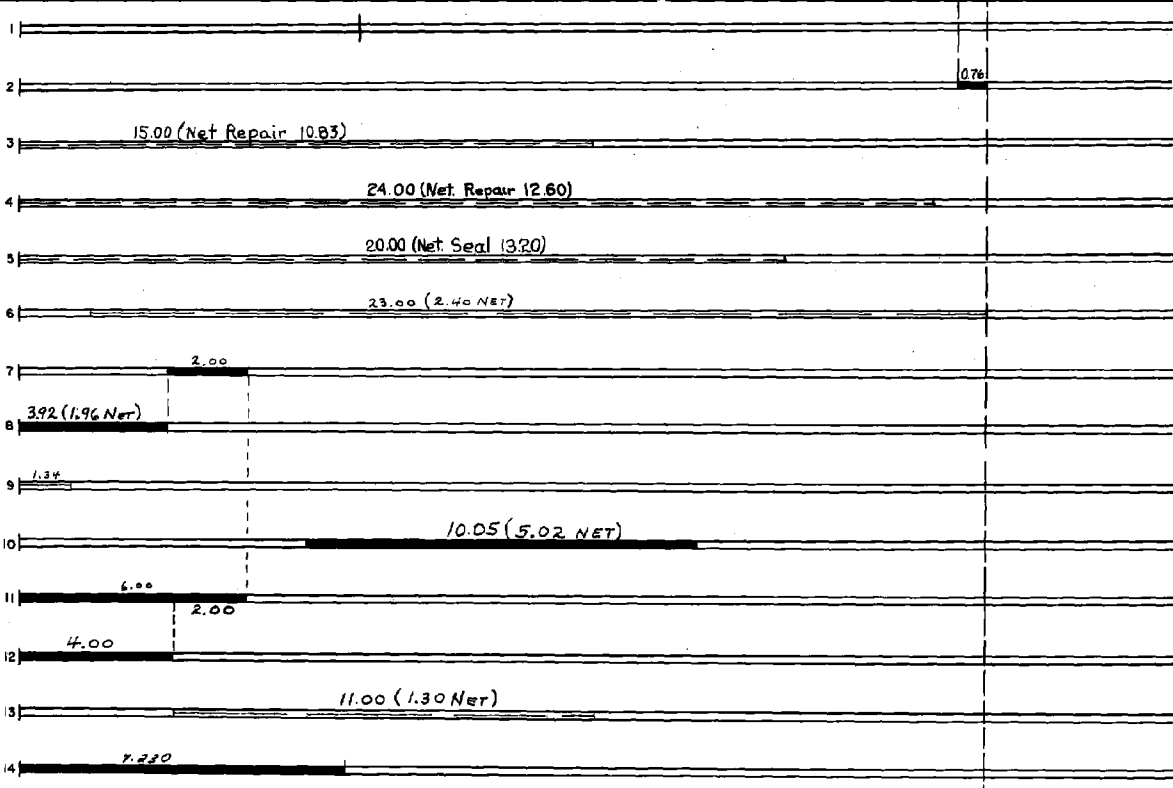

YEARS FROM	TOTAL TO	UNINCORPORATED		INCORPORATED		RURAL		URBAN	
		RDWY. MI.	BR. MI.	RDWY. MI.	BR. MI.	RDWY. MI.	BR. MI.	RDWY. MI.	BR. MI.

REMARKS: See Sheet No. 1
(1) Replace Br. 1120

673

