

PREPARED BY  
HIGHWAY PLANNING SURVEY  
IN COOPERATION WITH  
U. S. PUBLIC ROADS ADMINISTRATION

STATE OF MINNESOTA  
DEPARTMENT OF HIGHWAYS  
ROAD LIFE STUDIES  
CONSTRUCTION PROJECT LOG RECORD

CONTROL SECTION 7807  
TRUNK HIGHWAY 117  
COUNTY Traverse  
DISTRICT 4B

LIMITS: E. End of Bridge (Lake Traverse) - Jct T.H. 27

Ref. Pt. 000+00.011 - 001+00.797

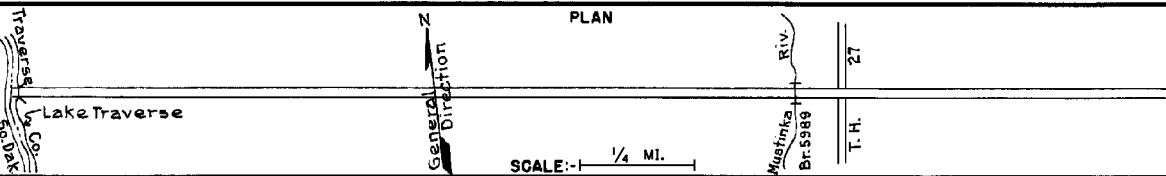

YEAR BUILT	PROJECT N <sup>o</sup>	DESCRIPTION				CODE N <sup>o</sup>
		TYPE	WIDTH	THICKNESS	REMARKS	
		Gravel	22'	4"	No Record of Const. Added in 1934	
		Br. 8428, 8428 & 859	24'	6"	215 Y.S. & 210 B.S.	
1941	War Dept.	Grading	26'		Removed Br. 8428	
		Soil Cement Base	26'	6"		
		Mixed Bit	26'	1 1/4"		
1941	7807-02	Grading	26'			
1942	7807-03	Br. 5989	23'		130' B.S. & L.T.	
1942	A.F.E. 7	Seeding			Seed supplied by R.S.D. (S.R. 7807-04) Maint. Dept.	
1943	A.F.E. 6	Grav. Resurface			430 C.Y. / Mi. Maint. Dept.	
1947	A.F.E. 22 & 23	Mixed Bit.	24' & 23'	1"-5"	Bit 9244 Gal. Agg. 877 Tons	
1948	A.F.E. 4	Bit Surf. Repair	24'		SC-483, 10364 Gal. Agg. 672 Tons	
1952	A.F.E. 4	Spot Treat			SC-3 & MC-2, 5560 Gal. Agg. 259 C.Y.	
	A.F.E. 5	Bit Surf. Repair	24'			
		Light Bit Seal (Spots)	24'			
1953	A.F.E. 604	Spot Treat			SC-3 & MC-2, 12103 Gal. Agg. 547 C.Y.	
		Bit Surf. Repair	24'		(0.78 Mi. repair on appx)	
		Spot Fog Seal				
1954	A.F.E. 604	Spot Treat			SC-3 & MC-2, 7610 Gal. Agg. 353 Tons	
		Bit Surf. Repair	24'			
		Fog Seal (1.60 Mi.)	24'			
1979	7807-07	Traffic Barrier Inst.			Rt. Br. No. 5989	
		601 posts (C)				
1979	7807-07	Traffic Barrier Inst.			Rt. Br. No. 6271	
		60 posts (C)				

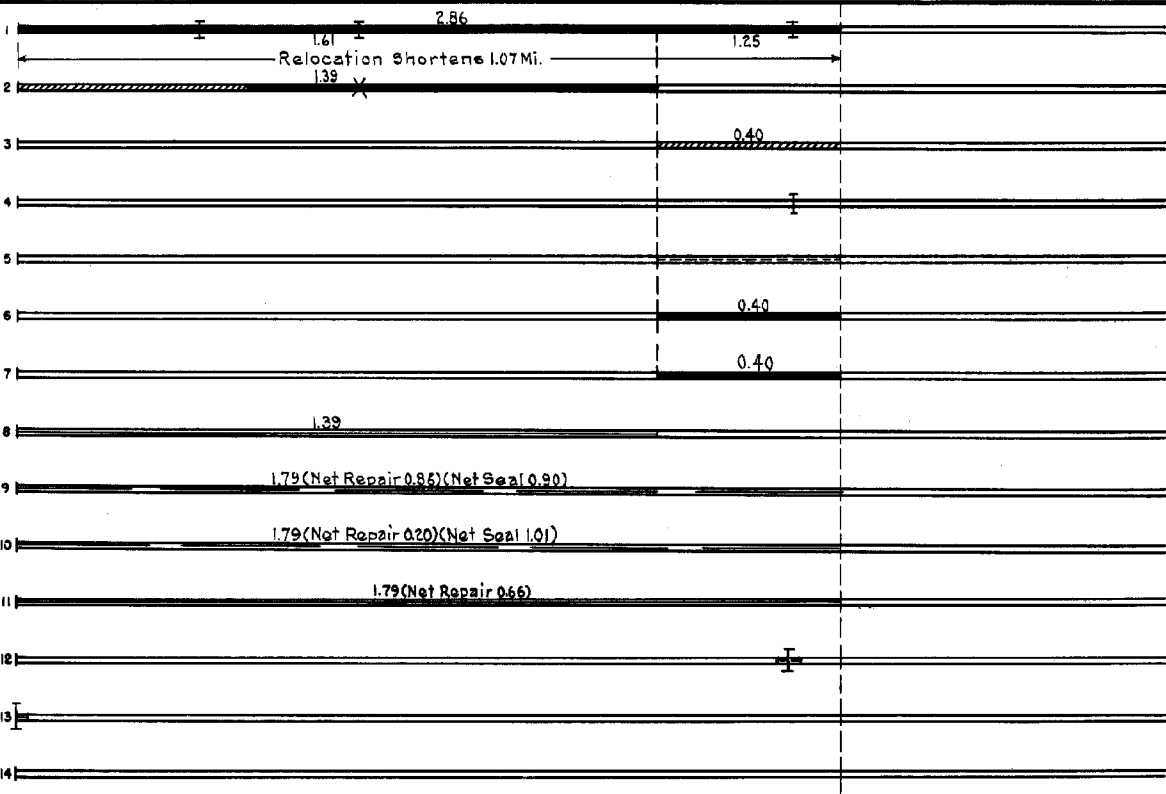

FROM	TO	TOTAL MILES	UNINCORPORATED		INCORPORATED		RURAL		URBAN	
			ROWY. MI.	BR. MI.	ROWY. MI.	BR. MI.	ROWY. MI.	BR. MI.	ROWY. MI.	BR. MI.
1934	1940	2.86	2.81	0.05	0.00	0.00	2.81	0.05	0.00	0.00
1941		1.79	1.76	0.03	0.00	0.00	1.76	0.03	0.00	0.00

REMARKS: Layout is to scale as of 1941

