

PREPARED BY
HIGHWAY PLANNING SURVEY
IN COOPERATION WITH
U. S. PUBLIC ROADS ADMINISTRATION

STATE OF MINNESOTA
DEPARTMENT OF HIGHWAYS
ROAD LIFE STUDIES
CONSTRUCTION PROJECT LOG RECORD

CONTROL SECTION 7805
TRUNK HIGHWAY 75
COUNTY Traverse
DISTRICT 4B

LIMITS: S. Co. Line - N. Jct. T.H. 27 in Wheaton.

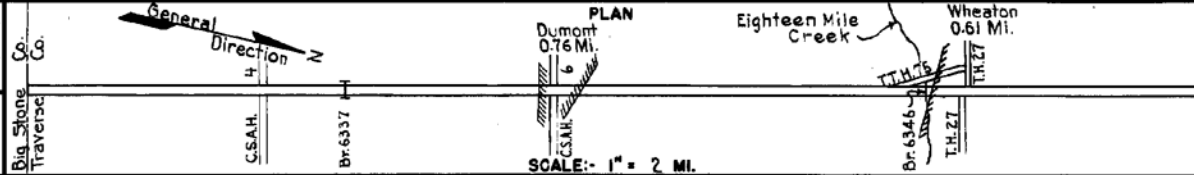

YEAR BUILT	PROJECT N#	DESCRIPTION			CODE N#
		TYPE	WIDTH	THICKNESS	
		Gravel			No Record of Constr.
		Gravel			No Record of Constr.
1920	75-6-14	Grading Br. 2250, 2248, 3340, 3339 & 3338	24' 20'		14 B.S., 17 B.S., 16 C.S. 30 C.D.G. & 14 C.S.
1921	75-6-14	Gravel	18'	2'	
		Gravel			No Record of Constr. City St. taken over in 1925.
1925	75-6-20N	Asphalt	NW		City Construction. Taken over in 1925. Concrete Base.
	(1)				Maint. Dept.
1932	75-6-14	Oil Tr. Gravel Widen Br. 2250, 2248, 3340	22' 24'	1"	10,300 Gal./Mile. Widened to 24'
1932		Oil Tr. Gravel	22'		10,300 Gal./Mile. Maint. Dept.
1939	7805-04	Br. 6337 Mono. Culv. Br. 8505			WI28D-W186-W105 on New Line.
C	1940	Grading (2) Gravel	36' 36'	1 1/4"	800 C.Y./Mile.
C	1940	7805-07 A.F.E. 8			Seeding Maint. Dept.
C	1941	7805-15	46' 46'	8"	Grading Stab. Gravel Base
C	1941	7805-01	36'		Grading Stab. Gravel Bridge Removal
C	1941	7805-03			Br. 6346 WI08TX50.

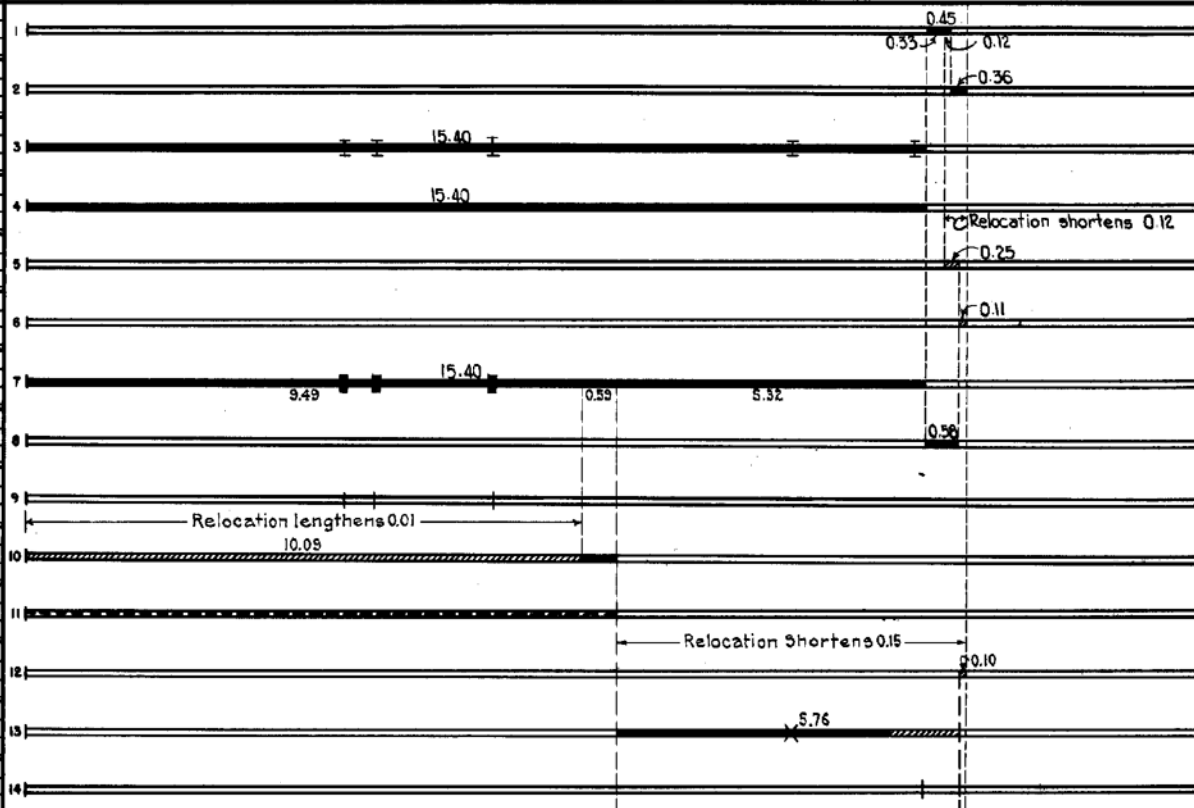

YEARS		TOTAL MILES	UNINCORPORATED		INCORPORATED		RURAL		URBAN	
FROM	TO		RDWY. MI.	BR. MI.	RDWY. MI.	BR. MI.	RDWY. MI.	BR. MI.	RDWY. MI.	BR. MI.
1921	1924	16.21	4.63	0.02	1.56	0.00	15.36	0.02	0.61	0.00
1925	1935	16.09	4.63	0.07	1.44	0.00	15.36	0.02	0.69	0.00
1940	1940	16.10	4.64	0.01	1.45	0.00	15.20	0.01	0.69	0.00
1941		15.95	4.58	0.00	1.37	0.00	15.34	0.00	0.61	0.00

REMARKS: Layout is to scale as of 1925. Plan revised for 1941 relocation.

(1) This work not done under this project number but lies within the limits of this project. (2) 60' wide sta. 449+11 to sta. 463+00 (in Dumont) and sta. 711+87 to sta. 719+60 (in Collis)

PREPARED BY
HIGHWAY PLANNING SURVEY
IN COOPERATION WITH
U.S. PUBLIC ROADS ADMINISTRATION

STATE OF MINNESOTA
DEPARTMENT OF HIGHWAYS
ROAD LIFE STUDIES
CONSTRUCTION PROJECT LOG RECORD

CONTROL SECTION 7805
TRUNK HIGHWAY 75
COUNTY Traverse
DISTRICT 48

LIMITS: S. Co. Line - N. Jct. T.H. 27 in Wheaton

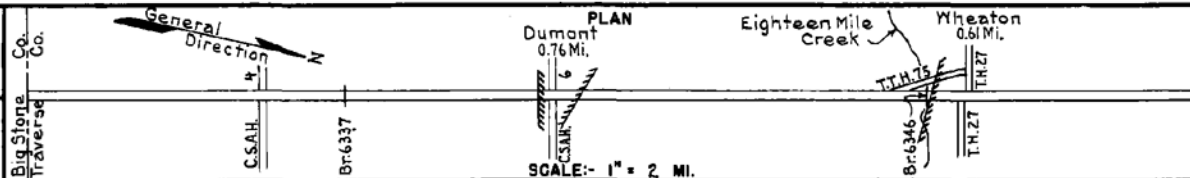

YEAR BUILT	PROJECT N ^o	DESCRIPTION			CODE N ^o	Miles
		TYPE	WIDTH	THICKNESS		
C	7805-08	Stab. Grav. Base Bit. Surf. Treat.	36'0"	8 1/2"		10.09
C	7805-10	Stab. Grav. Base	32'	6" Added		5.76
C	7805-14	Mixed Bit.	26'	1"		5.76
C	7805-16	Mixed Bit.	46'	1"		0.10
C	1941 A.F.E. 6 1942 A.F.E. 7	Seeding			Seeds supplied by R.S.D.(S.P. 7805-13) Maint. Dept.	
M	7805-17	Base Repair	29'	6"		0.23
M	A.F.E. 4	Bit. Surf. Repair			RC2&MC2, 12776 IM. Maint. Dept.	10.09
C	A.F.E. 34	3 S.C. Culverts			36'X20', 36'X30' & 36'X32'. Maint. Div.	
C	7805-18	Offtake Ditch				
M	A.F.E. 5	Bit. Seal Coat (Spots)	2646		Bit. 3263 Gal./Mi. Grav. 93 C.Y./Mi. Maint. Div.	5.86
M	1945 A.F.E. 23 A.F.E. 4	Spot Grav. Lifts & Restore Bit. Mat Bit. Fog Seal	30' 26'	6"	Bit. 4097 Gal./Mi. Maint. Div.	10.30
M	1945 A.F.E. 4	Spot Treat. Bit. Surf. Repair	24'		SC-3, 11839 Gal. Agg. 1025 C.Y.	13.10 (Net 3.40)
C	1947 A.F.E. 31	Bit. Resurfacing Mixed Bit.	24'	1" Added	MC3, 183166 Gal. Agg. 11345 Tons	15.95
M	1948 A.F.E. 4	Gravel Base (Spots) Spot Treat. Bit. Surf. Repair	28' 24'	6"	Bit. 36282 Gal. Agg. 3027 Tons	8.23 (Net 4.63)

YEARS FROM TO		TOTAL MILES	UNINCORPORATED		INCORPORATED		RURAL		URBAN	
			RDWY. MI.	BR. MI.	RDWY. MI.	BR. MI.	RDWY. MI.	BR. MI.	RDWY. MI.	BR. MI.

REMARKS: See Sheet No. 1

PREPARED BY
HIGHWAY PLANNING SURVEY
IN COOPERATION WITH
U.S. PUBLIC ROADS ADMINISTRATION

STATE OF MINNESOTA
DEPARTMENT OF HIGHWAYS
ROAD LIFE STUDIES
CONSTRUCTION PROJECT LOG RECORD

CONTROL SECTION 7805
TRUNK HIGHWAY 75
COUNTY Traverse
DISTRICT 4B

LIMITS: S. Co. Line - N. Jct. T.H. 27 in Wheaton

Ref. Pt. 155+00.811 - 171+00.759

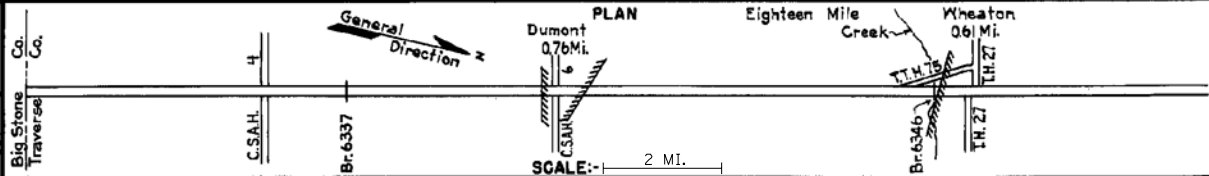

YEAR BUILT	PROJECT N°	DESCRIPTION			CODE N°
		TYPE	WIDTH	THICKNESS	
M	1949 A.F.E. 4	Spot Treat Bit. Surf. Repair	24'		
C	1950 7805-21	P.C. Concrete	24'	9-7-9	
M	1952 A.F.E. 29	Install Culverts			
M	1973 SF	Joint Seal			
C	1975 7805-22	GRAY SHOULDERS	5'		
C	1978 7805-25	PAVEMENT WIDENING BIT REPAIRING AGG. SHOULDERS	24' 5" 10'		
C	1990 7805-29	Crack Concrete Widen Road Edge Drains, Bit Overlay	26'	4 1/2"	
M	1991 4460	Crack Repair			
C	1995 7805-30	Remove Bit. Bit. Overlay	24'		
M	1997 8824-02	Agg. Seal			
M	1999 8824-12	Bit. Crack Sealing			
M	2000 8824-20	Bit. Crack Sealing			
M	2002 7805-31	Bituminous Overlay Gravel Surface	24' 8'	1.5" 1.5"	

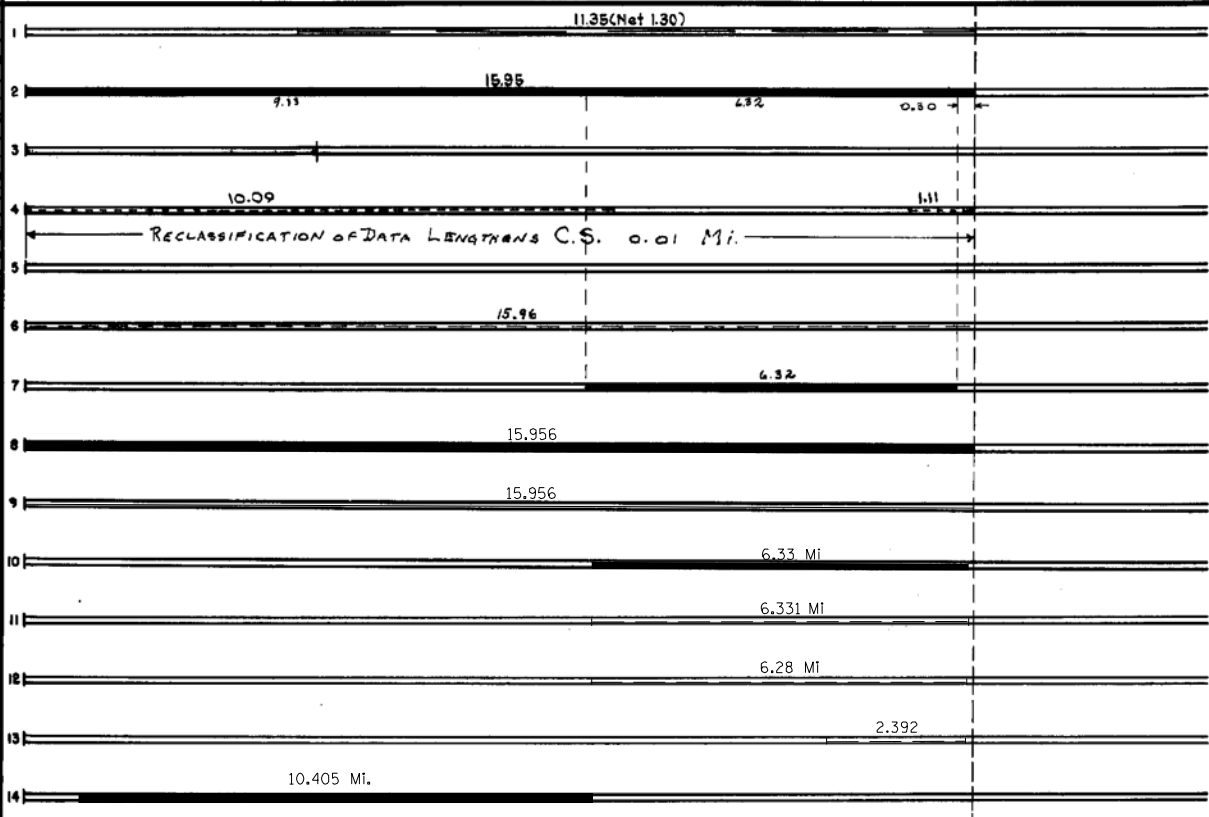

YEARS FROM	TO	TOTAL MILES	UNINCORPORATED		INCORPORATED		RURAL		URBAN	
			RDWY. MI.	BR. MI.	RDWY. MI.	BR. MI.	RDWY. MI.	BR. MI.	RDWY. MI.	BR. MI.

REMARKS: See Sheet No. 1
(1) 60' combination type for 0.27 Mi. in Dumont and 0.14 Mi. at Collis.

