

PREPARED BY
HIGHWAY PLANNING SURVEY
IN COOPERATION WITH
U.S. PUBLIC ROADS ADMINISTRATION

STATE OF MINNESOTA
DEPARTMENT OF HIGHWAYS
ROAD LIFE STUDIES
CONSTRUCTION PROJECT LOG RECORD

CONTROL SECTION T106
TRUNK HIGHWAY 52
COUNTY Todd
DISTRICT 5B

LIMITS: W. Co. Line in Oakis- S. Co. Line

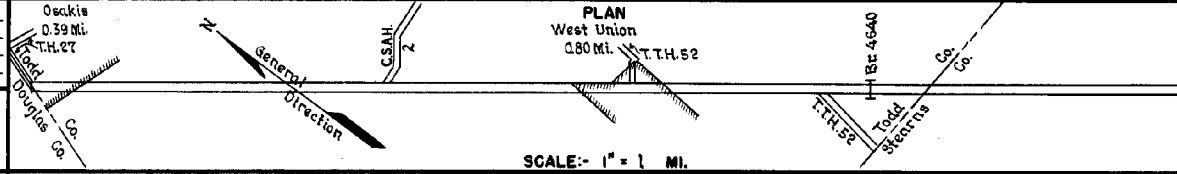

YEAR BUILT	PROJECT N ^o	DESCRIPTION				CODE N ^o
		TYPE	WIDTH	THICK-NESS	REMARKS	
		Gravel	24	2"	No Record of Const.	
1922	52-3-28A	Grading	30'			
1923	52-3-28A	Gravel	24	4 1/2"	2000 C.Y./Mile.	
1927	52-3-29-2B	Grading	32			
		Gravel	24	1 1/2"	750-800 C.Y./Mile.	
1927	52-3-52A	Grading	32			
		Gravel	24	2"	900 C.Y./Mile.	
		Br. 4640	27		26" C.D.G.	
1928	52-3-52A	Grading	32			
1928	52-3-29-2B	Concrete	20	9-79		
1928	52-3-28A	Concrete	20	9-79		
1928	52-3-52A	Concrete	20	9-79		
C		Raise Sag				
1940	A.F.E. 60	Mixed Bit.	22'	1 1/2"		
C		Bit. Stab. Lift	30'	3"	RT-4, 2890 Gal.	
1946	A.F.E. 19	Bit. Surfacing			Agg. 54 C.Y.	
		Bit. Surf. Treated	30'	3/4"		
C		Bit. Resurfacing			RT-4, 2223 Gal.	
1948	A.F.E. 26	Mixed Bit.	24'	1" added	Agg. 105 C.Y.	
M					RT-4, 300 Gal.	
1952	A.F.E. 5	Light Bit. Seal (Spots)	24'		Agg. 26 C.Y.	
M					SC-4, 4734 Gal.	
1953	A.F.E. 624	Spot Bit. Surf. Repair	20'		Agg. 453 Tons	

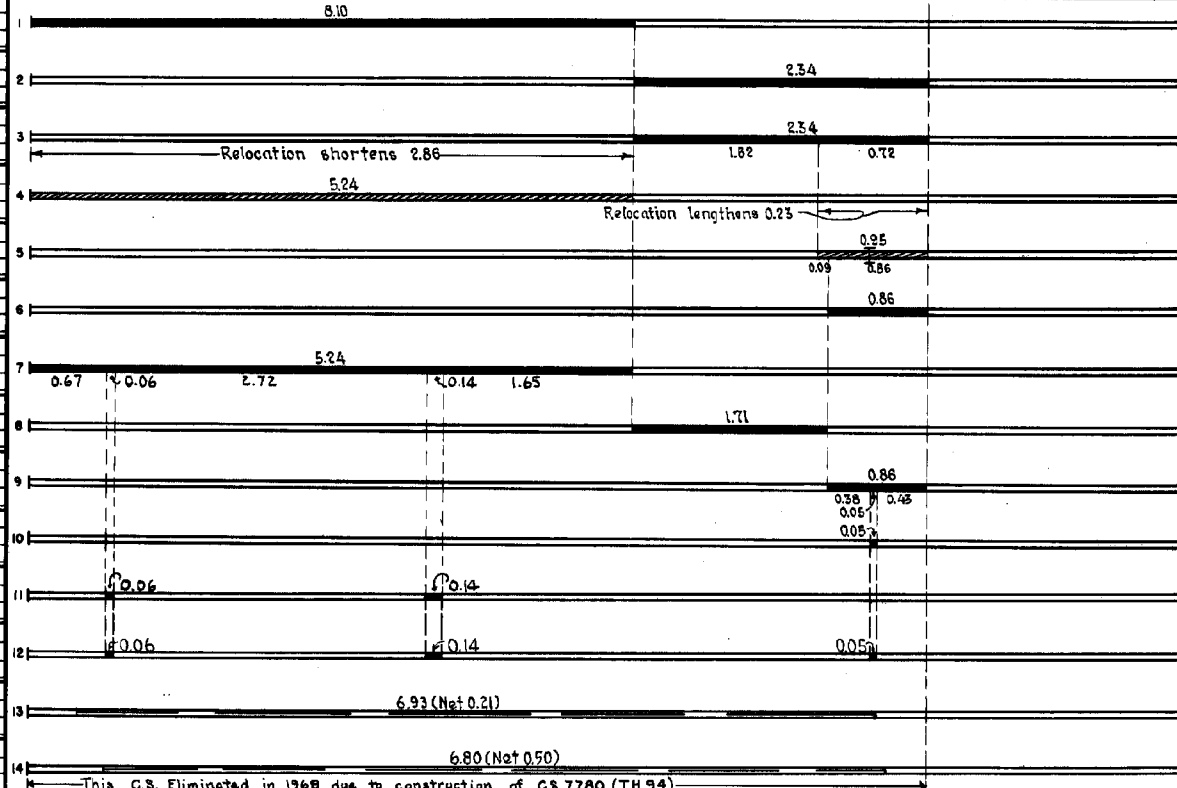

This C.S. Eliminated in 1968 due to construction of C.S. 7780 (T.H. 94)

YEARS FROM	TO	TOTAL MILES	UNINCORPORATED		INCORPORATED		RURAL		URBAN	
			RDWY. MI.	BR. MI.	RDWY. MI.	BR. MI.	RDWY. MI.	BR. MI.	RDWY. MI.	BR. MI.
1922	1926	0.44	0.76	0.00	1.68	0.00	9.34	0.00	1.10	0.00
1927	1927	7.81	6.61	0.01	1.19	0.00	7.41	0.01	0.39	0.00
1928		0.00	0.00	0.00	0.00	0.00	0.00	0.00	0.00	0.00

REMARKS: Layout is to scale as of 1927.