

PREPARED BY
TRAFFIC AND PLANNING DIVISION
IN COOPERATION WITH
U.S. DEPARTMENT OF COMMERCE
BUREAU OF PUBLIC ROADS

STATE OF MINNESOTA
DEPARTMENT OF HIGHWAYS
ROAD LIFE STUDIES
CONSTRUCTION PROJECT LOG RECORD

Interstate

CONTROL SECTION 7480
TRUNK HIGHWAY 35
COUNTY Steele
DISTRICT 6B

LIMITS: S. Co. Line - N. Co. Line

YEAR BUILT	PROJECT NO	DESCRIPTION			
		TYPE	WIDTH	THICKNESS	REMARKS
C	1958 7407-15	Grading Base & Sub-base Br 8911 & Culvert	80'	12"	Divided Highway (Grav & Sand-Grav) C(11-14-11)14T & C88
C	1958 7407-15	Built as Temp Conn. under S.P. 7407-15	80'	5"	Added thickness Plant Mix Bit.
C	1958 7407-27	Concrete Br. 7162 (on C.S.A.H. 12)	48'	9"	2-24' Roadways 195' B.S.
C	1958 7407-16	Br. 9051 & 9052	2@30'		123' B.S.O.H. (each rdwy)
C	1958 7407-18	Br. 9054 & 9055	2@30'		129' B.S.O.H. (each rdwy)
C	1958 7407-22	Br. 9056			B.S.-U.P.
C	1958 7480-03	Interstate fencing			
C	1966 7480-10	Grading Sub-base & Base P.C. Concrete	2@49'	5 1/4"	Divided Highway Sand-Grav. & Grav.
C	1966 7480-20	Br. 74805	57-37'		209' P.P.G.-U.P. Both 130' B.S.-O.H.
C	1966 7480-23 & 24	Br's 74823 & 74824	78-38'		Both 190' P.P.G.-O.H.
C	1966 7480-28	Br. 74821	39-38'		209' P.P.G.-U.P. Both 159' P.P.G.-O.H.
C	1966 7480-19	Br's 74809 & 74810	39-38'		Both 159' P.P.G.-O.H.
C	1966 7480-13	Br's 74819 & 74820	39-38'		Both 202' B.S.-U.P.
C	1966 7480-08	Br. 74806	39-39'		224' P.P.G.-U.P.
C	1966 7480-18	Br. 74813	39-39'		227' P.P.G.-U.P.
C	1966 7480-17 & 18	Br's 74815 & 74816	39-38'		Both 130' B.S.-O.H.
C	1966 7480-17 & 18	Br's 74817 & 74818	39-38'		Both 179' B.S.-O.H.
C	1967 7480-11	Br. 74801			212 P.P.G.-U.P.
C	1967 7480-08	Grading Gravel Sub-base & Base P.C. Concrete	2@24'	5 1/4"	Divided Highway
C	1967 7480-13	Grading Gravel Sub-base & Base P.C. Concrete	2@24'	5 1/4"	Divided Highway
C	1967 7480-19	Grading Gravel Sub-base & Base P.C. Concrete	2@24'	5 1/4"	Divided Highway
C	1967 7480-91086	Br. 91086			C106T
C	1967 7480-74802	Br. 74802			232' P.P.G.-U.P.
C	1967 7480-74803 & 74804	Br's 74803 & 74804	2@38'		Both 128' B.S.-O.H.
M	1966 SF	Bit Shoulder Repair	10'	3"	MC-250, 117 Gal.
C	1967	Light Bit. Seal	32'		AC-178 Tons

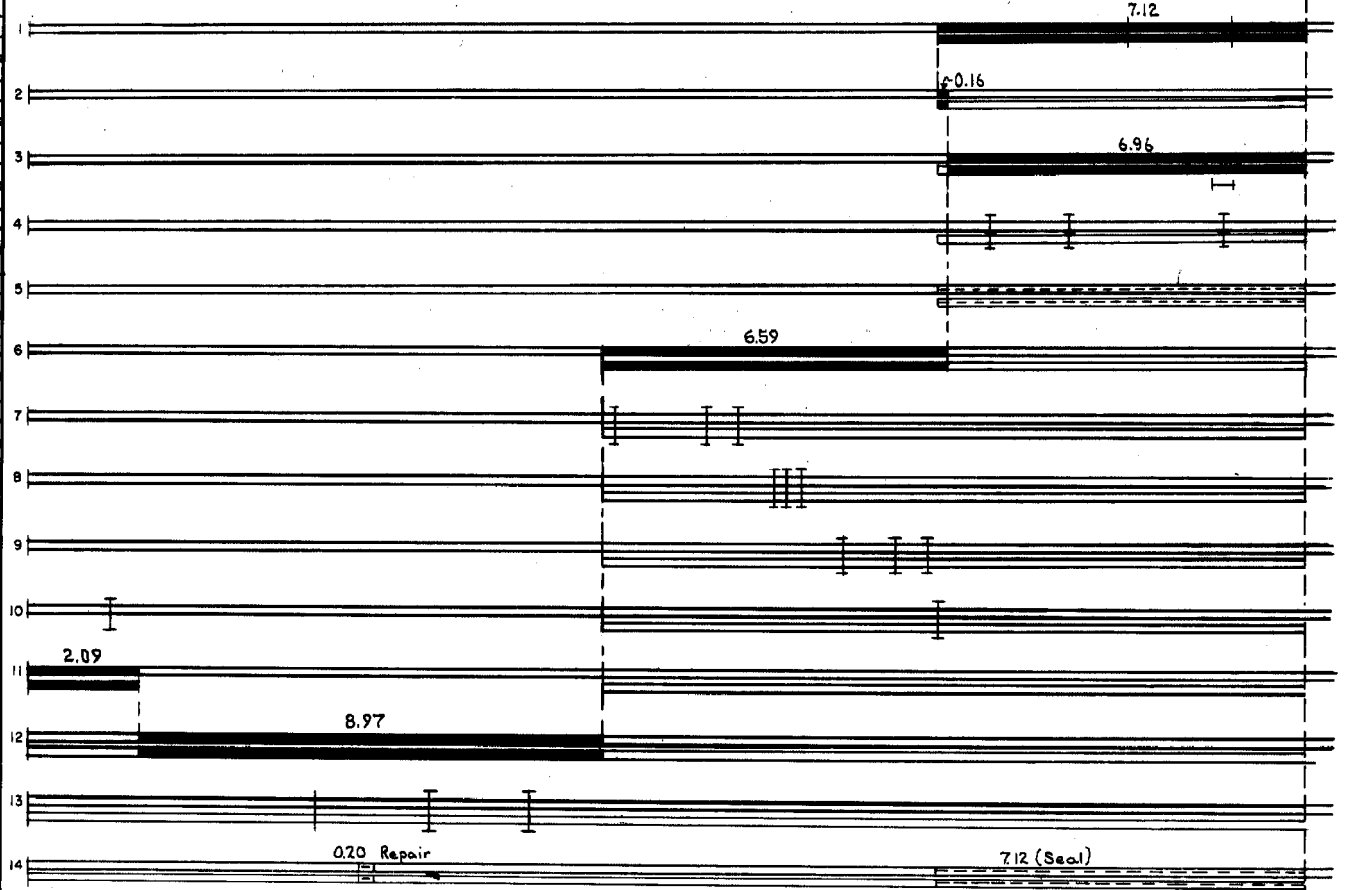
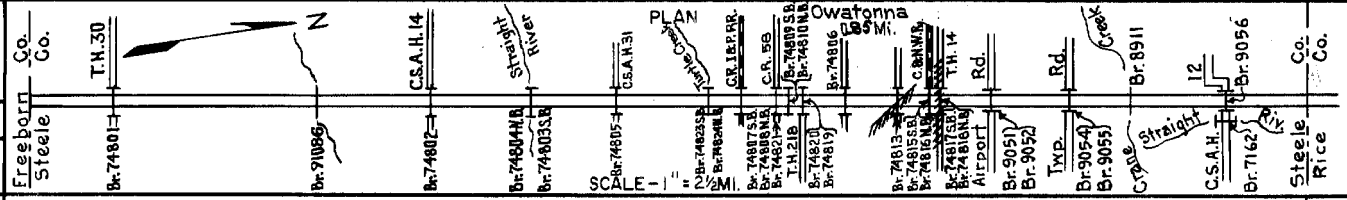

YEARS		TOTAL MILES	UNINCORPORATED		INCORPORATED		RURAL		URBAN	
FROM	TO		RDWY. MI.	BR. MI.	RDWY. MI.	BR. MI.	RDWY. MI.	BR. MI.	RDWY. MI.	BR. MI.
1958	1965	7.72	7.07	0.05	0.00	0.00	7.07	0.05	0.00	0.00
1966	1966	9.67	8.87	0.05	0.69	0.06	8.87	0.05	0.69	0.06
1967	1970	24.61	23.68	0.16	0.71	0.06	23.68	0.16	0.71	0.06
1971		24.61	23.60	0.16	0.79	0.06	23.60	0.16	0.79	0.06

REMARKS: Layout is to scale as of 1958

PREPARED BY
TRAFFIC AND PLANNING DIVISION
IN COOPERATION WITH
U.S. DEPARTMENT OF COMMERCE
BUREAU OF PUBLIC ROADS

STATE OF MINNESOTA
DEPARTMENT OF HIGHWAYS
ROAD LIFE STUDIES
CONSTRUCTION PROJECT LOG RECORD

Interstate CONTROL SECTION 7480
TRUNK HIGHWAY 35
COUNTY Steele
DISTRICT 686

LIMITS: S. Co. Line - N. Co. Line

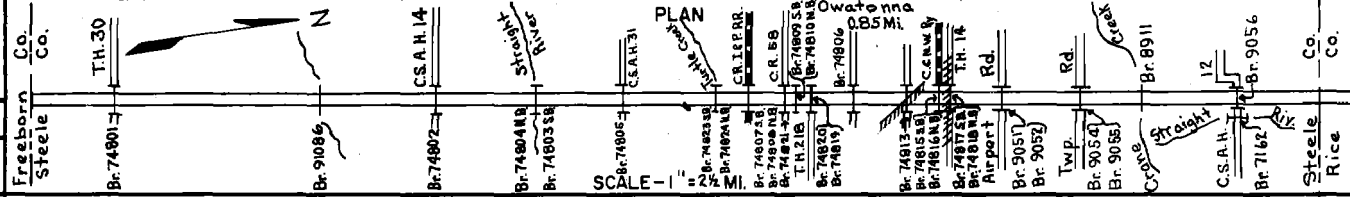

YEAR BUILT	PROJECT NO.	DESCRIPTION				REMARKS
		TYPE	WIDTH	THICKNESS		
M 1968	SF	Fine Mix on Bit Shoulders	2'	Var.	RC-800 Tack & AC Fine Mix 800 Gal. Agg. 80 Tons	
M 1973	SF	BIT SHOULDER REPAIR	24'	1 1/2"	AC 2331 1966 Ton R2800 TACK 14000 GAL.	
M 1976	SF	BIT OVERLAY ON WEST FRONTAGE Rd.	24'	1 1/2"	AC 2331 1318 Ton CR5-2 TACK 200 GAL.	
C 1977	7490-51	RAMP & INTERCHANGE	8' COM.		AT BR. # 74813	
M 1978	SF	BIT SURF. REPAIR BIT SHOULDERS	10'	3"	AC-1 2331 P.Mix 4029 Ton	
M 1980	7480-74809	Br. Deck Repairs & Overlay			Br. 74809	
M 1978	SF	Bit. Surface Repairs	2'	0" 3"	252 Ton 800 Gal. CSS1H Pl. Mix. Fine Mix AC-1	
M 1979	SF	Bit. Shoulder Repairs	2'	0" 2"	420 Ton 1,000 Gal. CSS1H Pl. Mix. 2331 Fine Mix AC-1	
C 1980	7480-74823	Br. Repair				
M 1980	SF	Concrete Joint Repair	22x24"	1/4"	Remove, Cut & Pour P.V.C. Joint Material on Transverse Joints NB & SB Lanes	
M 1979	SF	Concrete Joint Repair	22x24"	1/4"	Remove, Cut & Pour P.V.C. Material on Transverse Joints NB & SB Lanes	
M 1980	SF	Concrete Joint Repair	22x24"	1/4"	Remove, Cut & Pour P.V.C. Material on Transverse Joints NB & SB Lanes	
M 1981	SF	Spot Bit Shoulder Repair	10'	2"	192 Ton AC-1 2331 Wear	
M 1981	SF	Reg. Seal Shoulders	3'		5400 Gal. CSS1H	

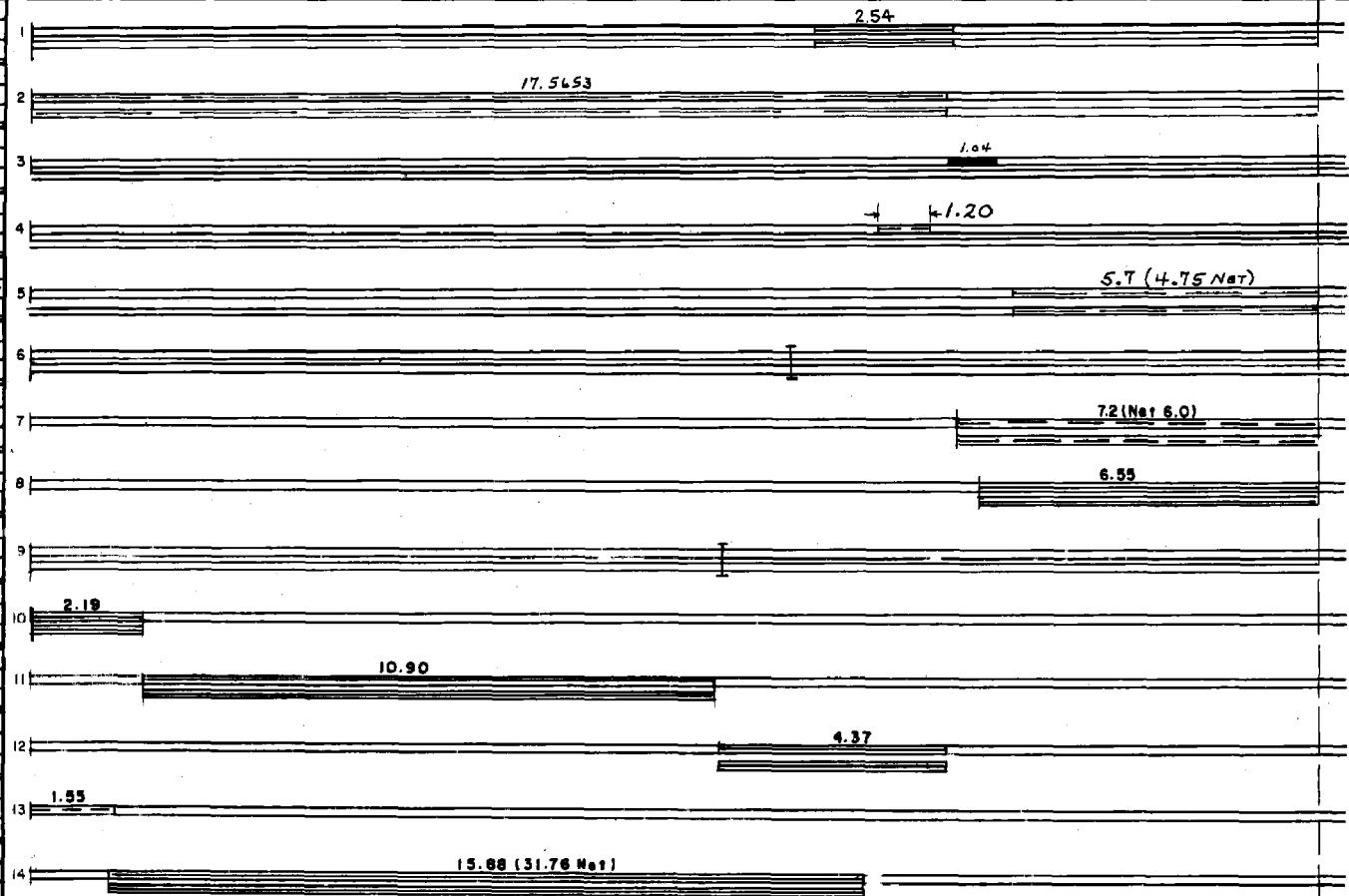

YEARS FROM	TO	TOTAL MILES	UNINCORPORATED		INCORPORATED		RURAL		URBAN	
			RDWY. MI.	BR. MI.	RDWY. MI.	BR. MI.	RDWY. MI.	BR. MI.	RDWY. MI.	BR. MI.

REMARKS: See Sheet No. 1

STATE OF MINNESOTA
DEPARTMENT OF TRANSPORTATION
CONSTRUCTION PROJECT LOG RECORD

CONTROL SECTION 7480
TRUNK HIGHWAY 35
COUNTY Steele
DISTRICT 6B

PREPARED BY
BUREAU OF POLICY & PLANNING
IN COOPERATION WITH
U. S. DEPARTMENT OF TRANSPORTATION - FEDERAL HIGHWAY ADMINISTRATION

LIMITS: Freeborn/Steele Co. Line - Steele/Rice Co. Line

Ref. Pt. 025+00.050 - 049+00.659

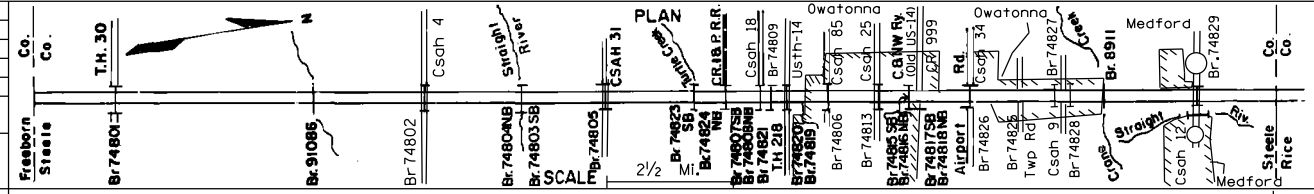

YEAR BUILT	PROJECT No	DESCRIPTION			
		TYPE	WIDTH	THICKNESS	REMARKS
S	2010 7480-114	Bit. Overlay	24'	3"	Spec. 2360 SB NB
S	2011 7480-117 (7401-34)	Grading, Gran Embmt Conc Paving Agg Base Class 5	27'	3" 1 1/2" 8"	10' comb. shldrs-8' Bit non reinforced Spec 2360 SB NB
S	2013 7480-122	Milling & Bituminous Overlay Comb shldr		2" 3,5"	Spec 2360 Agg Class 2
S	2013 7480-120	Roundabouts, Grading Conc Paving Bit Mill & Ovly	On	Csah	12 At I-35 Ramps
S	2013 7480-113	Grading/Agg. Base Concrete Surfacing Bit. Shldrs, widening	var.	6" 11" 4"	Class 6 Mainline NRCD Bridges
	2016 7480-128	Hi Tens. Cable barrier			

1	9.450 Mi.	
2	1.386 Mi	
3	10.085 Mi. (net)	
4		
5	2.39 Mi.	
6	5.92 Mi.	
7		
8		
9		
10		
11		
12		
13		
14		

YEARS FROM TO		TOTAL MILES	UNINCORPORATED RDWY. MI. BR. MI.		INCORPORATED RDWY. MI. BR. MI.		RURAL RDWY. MI. BR. MI.		URBAN RDWY. MI. BR. MI.	

REMARKS: