

PREPARED BY  
TRAFFIC AND PLANNING DIVISION  
IN COOPERATION WITH  
U.S. DEPARTMENT OF COMMERCE  
BUREAU OF PUBLIC ROADS

STATE OF MINNESOTA  
DEPARTMENT OF HIGHWAYS  
ROAD LIFE STUDIES  
CONSTRUCTION PROJECT LOG RECORD

CONTROL SECTION **6946**  
TRUNK HIGHWAY **23**  
COUNTY **St. Louis**  
DISTRICT **1A**

LIMITS: (In Duluth) N. Jct. TH 194 (6th Ave. E.) -  
N. Jct. TH 61 (London Road)

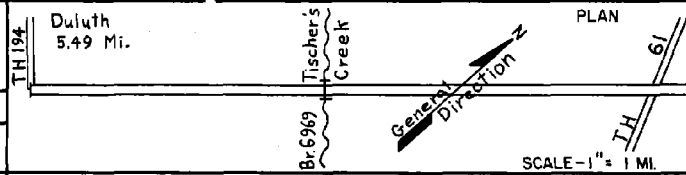

YEAR BUILT	PROJECT NO.	DESCRIPTION			
		TYPE	WIDTH	THICKNESS	REMARKS
					No record of constr. No record of Surf. Type Entered in 1950
1950		Asphaltic Concrete over PCC in place	47'	3"	
					0.53 mi. on 2nd St. 0.14 mi. on 12th Ave. 1.62 mi. on Superior St.
1956	6946-07	Grading, Base Asphaltic Conc. on New One Way St.			0.53 mi. on 3rd St. 0.07 mi. on 12th Ave.
1956	6946-08	Grading, Base Asphaltic Concrete	44'	3"	
1960	6946-14	Grading, Base Asphaltic Conc.		3"	3rd St. Built 2nd St. Trans. in
					No record of constr. Entered in 1960
1963		Pl. Mix. Bit. Surf.	24'	5"	
1963		Asphaltic Concrete on 2nd St.			
1964		Concrete Base Repair Asphaltic Concrete	44'	4"	
1968	6946-25	Pl. Mix. Bit. Surface	38'	2"	
1969	6946-24	Traffic Signal System			At Int. of TH 23 & Superior St.
1973	6946-28 M 3051 (1)	Grading, Base Bit. Surfacing	44'	3"	At 21st Av E.
1974	6946-29	Traffic Signal System			
1974	6946-32	Asph. Conc. Surface	40'	5/8"	21st Av E - 47th Av E.

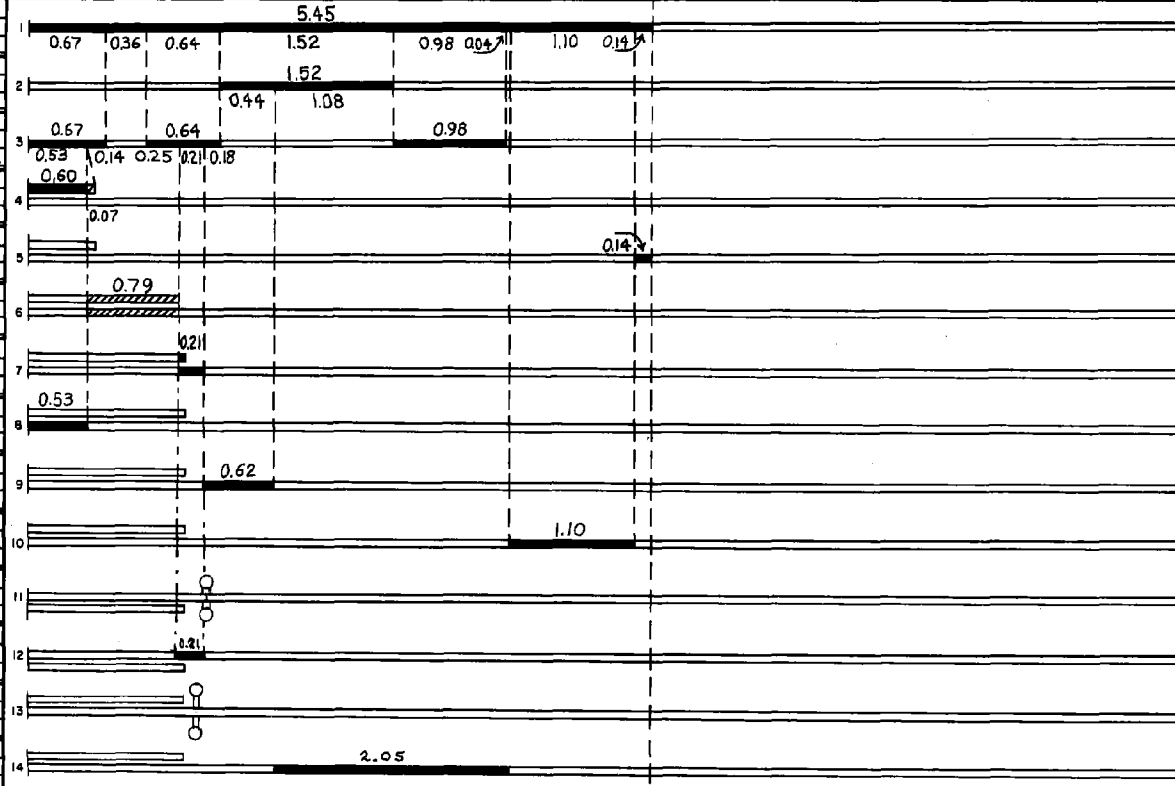

YEARS		TOTAL MILES	UNINCORPORATED		INCORPORATED		RURAL		URBAN	
FROM	TO		RDWY. MI.	BR. MI.	RDWY. MI.	BR. MI.	RDWY. MI.	BR. MI.	RDWY. MI.	BR. MI.
1950	1956	5.45	0.00	0.00	5.45	0.03	0.00	0.00	5.45	0.03
1956	1960	5.22	0.00	0.00	5.52	0.03	0.00	0.00	5.52	0.03
1960		5.49	0.00	0.00	5.49	0.03	0.00	0.00	5.49	0.03

REMARKS: Layout is to scale as of 1950  
Br. 6949 - 155' CS no record of construction

7-74

