

LIMITS: (In Duluth) E. Jct. T.H. 53 (Trinity Road) - Jct. T.H. 23
(6th Ave. E. & 2nd St.)
Ref. Pt. 013+00.569 - 016+00.875

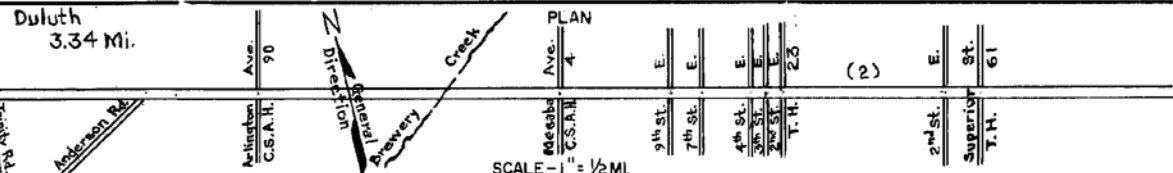

| YEAR BUILT | PROJECT NO. | DESCRIPTION | | | | REMARKS |
|------------|-------------------------|---|----------------------------|-----------------------|--|---------|
| | | TYPE | WIDTH | THICKNESS | | |
| | (1) | Oiled Earth Sandstone Block Concrete | | | Entered System in 1934 | |
| | | Inplace Culv. | | | W 55' 6" Span | |
| C 1938 | 6933-01 | Grading Widening (New Lane) | Var. | | | |
| C 1939 | 6930-02 | Agg. Base Mixed Bit Surf | 28' | 1'-9" | | |
| C 1940 | 6933-07 | Agg. Base P.C. Concrete | 28' | 1'-11/2" | Grading on 6933-03 | |
| C 1942 | 6933-11 | Grading, Gravel Base P.C. Conc. Gravel Shoulders | 28' | 6" | N.B. Rdwy only 5' Rt. & 10' Lt. | |
| M 1943 | AFE 9 | Shoulders | | | 23 Tons of CaCl ₂ applied | |
| M 1944 | AFE 30 | Bit Surf Repair | 21'-42" | 1/2" | | |
| C 1946 | 6933-18 | Conc. Base Asphaltic Conc. | 2@22' | 6" 2 1/2" | Divided Highway | |
| M 1949 | AFE-31 | Base Gravel Asphaltic Conc. | 6'-30 1/2" | 6" 2" | 6' Rt. & Lt of Conc. inplace | |
| C 1952 | 6933-27 | Conc. Rdwy. Inplace Plant Mix Bit. Gravel Shoulders | 2@22' | 9'-6-9" 3' | 5' inside 10' outside | |
| C 1954 | 6933-24-28 | Conc. Base Widening Asphaltic Conc. Asphaltic Conc. | 44-48' 44-48' 42-44' | 7" 3" 1'-1 1/4" | Old Conc. Inplace 9th St. to 2nd St. E. | |
| C 1961 | 6933- | Old P.C. Conc. inplace Asphaltic Conc. | 28'-37' | 6" 1 1/4" | 0.09 on N.B. T.H. 194 | |
| M 1964 | Maint. Proj. 6933-41 | Base Repair Asphaltic Conc. Traffic Signals | 42' | 1 1/2" | | |

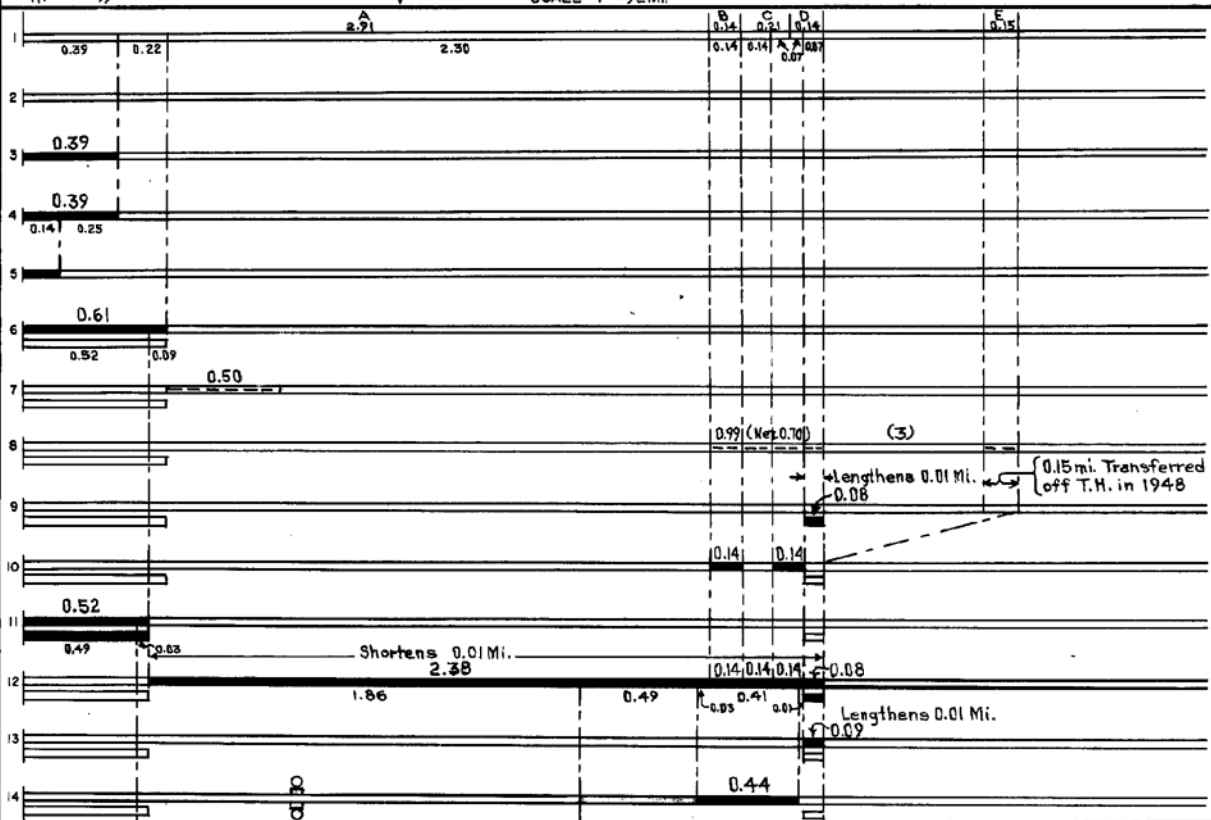

| YEARS | | TOTAL MILES | UNINCORPORATED | | INCORPORATED | | RURAL | | URBAN | |
|-------|------|-------------|----------------|---------|--------------|---------|-----------|---------|-----------|---------|
| FROM | TO | | RDWY. MI. | BR. MI. | RDWY. MI. | BR. MI. | RDWY. MI. | BR. MI. | RDWY. MI. | BR. MI. |
| 1934 | 1948 | 3.55 | 0.00 | 0.00 | 3.55 | 0.00 | 0.00 | 0.00 | 3.55 | 0.00 |
| 1948 | 1954 | 3.41 | 0.00 | 0.00 | 3.41 | 0.00 | 0.00 | 0.00 | 3.41 | 0.00 |
| 1954 | 1961 | 3.40 | 0.00 | 0.00 | 3.40 | 0.00 | 0.00 | 0.00 | 3.40 | 0.00 |
| 1961 | 1968 | 3.41 | 0.00 | 0.00 | 3.41 | 0.00 | 0.00 | 0.00 | 3.41 | 0.00 |
| 1968 | | 3.34 | 0.00 | 0.00 | 3.34 | 0.00 | 0.00 | 0.00 | 3.34 | 0.00 |

REMARKS: Layout to scale as of 1969.
 (1) Surface entered in 1934; A - conc. built 1929 (2.91 mi.); B - Sandstone block, built 1929 (0.14 mi.);
 C - conc. built 1917 (0.21 mi.); D - Oiled earth, year unknown (0.14 mi.); E - Sandstone block, built 1927 (0.15 mi.)
 (2) 0.35 mi. from 6th Ave. E. to 2nd Ave. E. on C.S. 6945; 0.09 mi. from Mesaba Ave & 1st St. on 2nd St. to 2nd Ave. E.
 on C.S. 6945.
 (3) Includes that portion of T. 25 from 6th Ave. E. to 2nd Ave. E. C.S. 6945.

PREPARED BY
TRAFFIC AND PLANNING DIVISION
IN COOPERATION WITH
U.S. DEPARTMENT OF COMMERCE
BUREAU OF PUBLIC ROADS

STATE OF MINNESOTA
DEPARTMENT OF HIGHWAYS
ROAD LIFE STUDIES
CONSTRUCTION PROJECT LOG RECORD

CONTROL SECTION 6933
TRUNK HIGHWAY 194
COUNTY St. Louis
DISTRICT 1A1

LIMITS: (In Duluth) E. Jct. T.H. 53 (Trinity Road) - Jct. T.H. 23
(6th Ave E. & 2nd St.)

Ref. Pt. 013+00.569 - 016+00.875

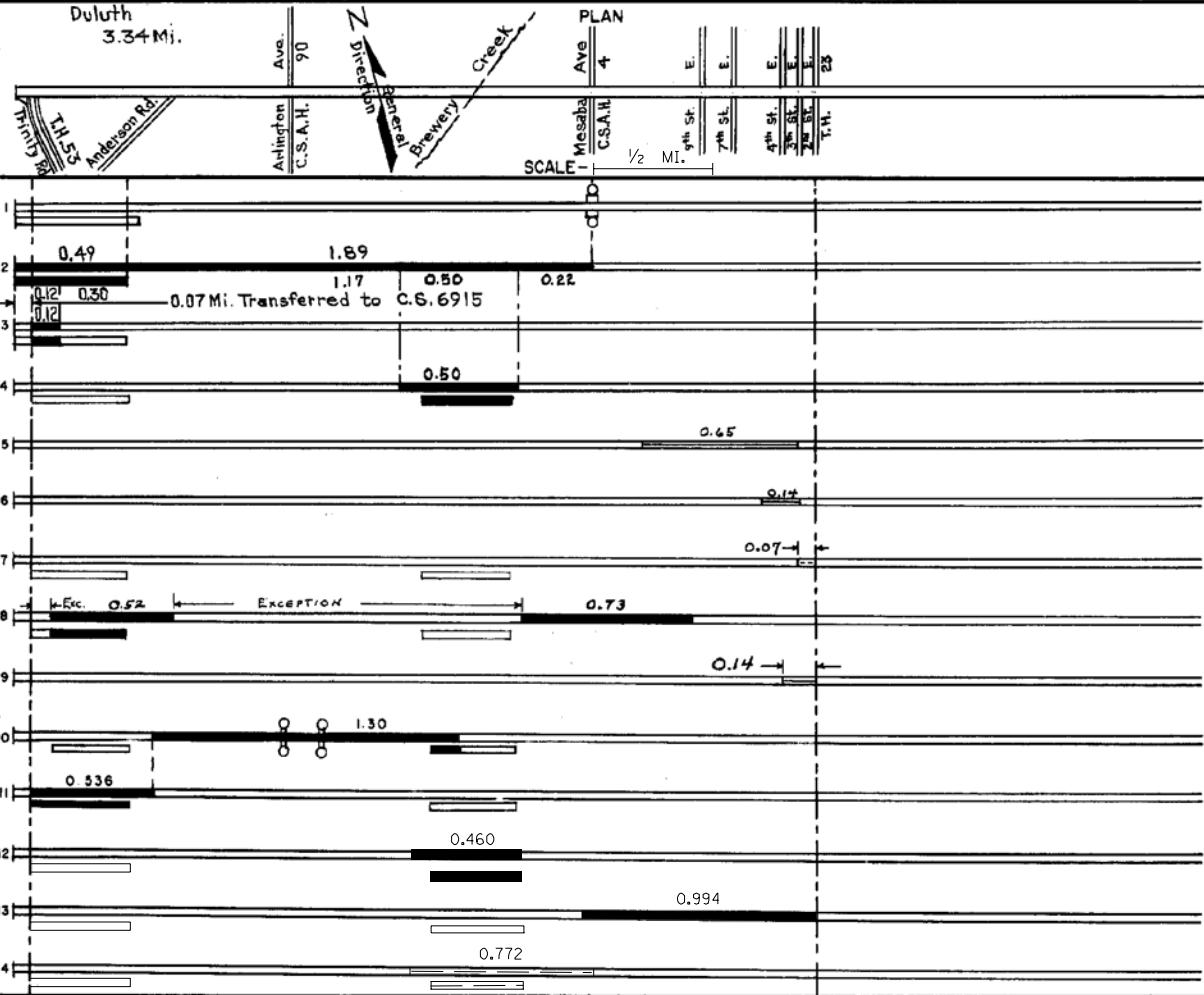

| YEAR BUILT | PROJECT NO | DESCRIPTION | | | | REMARKS |
|------------|--------------|--|--------------------|------------------|----|---|
| | | TYPE | WIDTH | THICKNESS | | |
| C | 6933-40 | Turn Lanes, Lighting Channelization Traffic Signals | | | | Jct. of Central Ent and Mesaba Ave. |
| 1966 | Maint. Proj. | Plant. Mix Bit. Shape Shoulders | 44-48 | 1 1/2" | | 0.49 Divided |
| C | 6915-60 | Asphaltic Conc. | 20'22" | 1 1/2" | | 0.07 Mi. Transferred to C.S. 6915 |
| C | 6933-50 | | | | | |
| 1971 | T 5101 (002) | ASPHALTIC CONC. WIDENING | 20'28" | 2 3/4" | | 0.34 MI. DIVIDED |
| M | 6933-57 | CURB & GUTTER CONC. SIDEWALK & STORM DRAINAGE REPAIR | | | 4" | |
| M | 6933-58 | ASPH. CONC. REPAIR | 41' | 3/8" | | CURB TO CURB |
| C | 6933-51 | TRAFFIC CHANNELIZATION | | | | |
| C | 6933-53 | BIT. OVERLAY, TURN LANE EXTENSIONS, CONST. TURN LANES & SHOULDER | 44 1/2' | 1 1/2" | | FROM CSAN 13 TO 97th St. E. IN DULUTH |
| C | 6933-58 | ASPH. CONC. REPAIR | 41' | 3/8" | | ASPH. CONC. #1861 165 TEN SF |
| C | 6933-64 | Grading, Surfacing, C&G, Signals & Bike Path | Var. | 1" | | Signals at Arlington & Rosewood Bit. Spec. 2361 Shldr. Spec. 2361 |
| C | 6933-67 | App. & Bit. Base Bit. Surface Bit. Shoulders | 2-30' 2-24' 10' 3' | 1 3/4" 2 1/4" 2" | | |
| C | 6933-69 | Grading Bit. Surfacing | Var. | 1" | | Spec. 2331 Spec. 2361 |
| C | 6933-73 | Grading Conc. Surfacing | Var. | 8" | | |
| M | M4534 | Crack Repair | | | | |

| YEARS | | TOTAL MILES | UNINCORPORATED | | INCORPORATED | | RURAL | | URBAN | |
|-------|----|-------------|----------------|---------|--------------|---------|-----------|---------|-----------|---------|
| FROM | TO | | RDWY. MI. | BR. MI. | RDWY. MI. | BR. MI. | RDWY. MI. | BR. MI. | RDWY. MI. | BR. MI. |
| | | | | | | | | | | |

REMARKS: See sheet No. 1.

