

PREPARED BY
HIGHWAY PLANNING SURVEY
IN COOPERATION WITH
U.S. PUBLIC ROADS ADMINISTRATION

STATE OF MINNESOTA
DEPARTMENT OF HIGHWAYS
ROAD LIFE STUDIES
CONSTRUCTION PROJECT LOG RECORD

CONTROL SECTION 6908
TRUNK HIGHWAY 7
COUNTY St. Louis
DISTRICT 1A

LIMITS: Jct. TH 33 - W. Corp. Limits of Duluth.

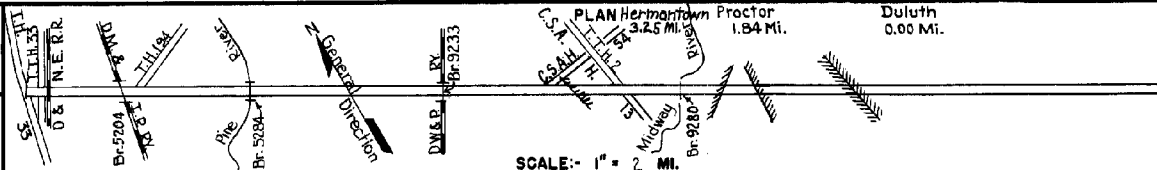

YEAR BUILT	PROJECT NO.	DESCRIPTION			CODE NO.
		TYPE	WIDTH	THICKNESS	
1932	2=8-48-1 2=11-44-1	Grading Gravel Br. 5204	40 30 26	1 1/2"	800 C.Y./Mile B. S. Underpass
1934	2=8-48-1 2=11-44-1	Gravel	30	5 1/2"	2600 C.Y./Mile Accumulated Thickness
1934	(1) 2=8-48-1 2=11-44-1	Tar Tr. Gravel	26	2"	18200 Gal./Mile. Maint. Dept.
		Concrete	34'		No Record of Constr. Added in 1934.
		Gravel	24'		No Record of Constr. Added in 1934.
1925		Tar Tr. Gravel	30	1 1/2"	Co. Job 2502 Added in 1934.
1926		Tar Tr. Gravel	30	1 1/2"	Co. Job 2605 Added in 1934.
1929		Gravel Br. 6015	24'	3 1/2"	Co. Job 29-5-12-1 Added in 1934. W 86 D
1931		Gravel Br. 3946	30 25'	2 3/4"	Co. Job 31-5-12-2 Added in 1934. 30' B.S.
1934		Tar Tr. Gravel	24'	1 1/2"	19500 Gal./Mile Maint. Dept.
1910		Br. 6336	24'		D.P.G. Underpass. Taken over in 1936.
1932		Br. 5284	27'		30' B.S. Taken over in 1936.
1932		Grading Gravel Br. 8017	30 20'	2 3/4"	Co. Job 31-5-12-1 added in 1935 1600 C.Y./Mile. W 106 x 40
		Gravel	20'	2"	No Record of Constr. Taken over in 1936.

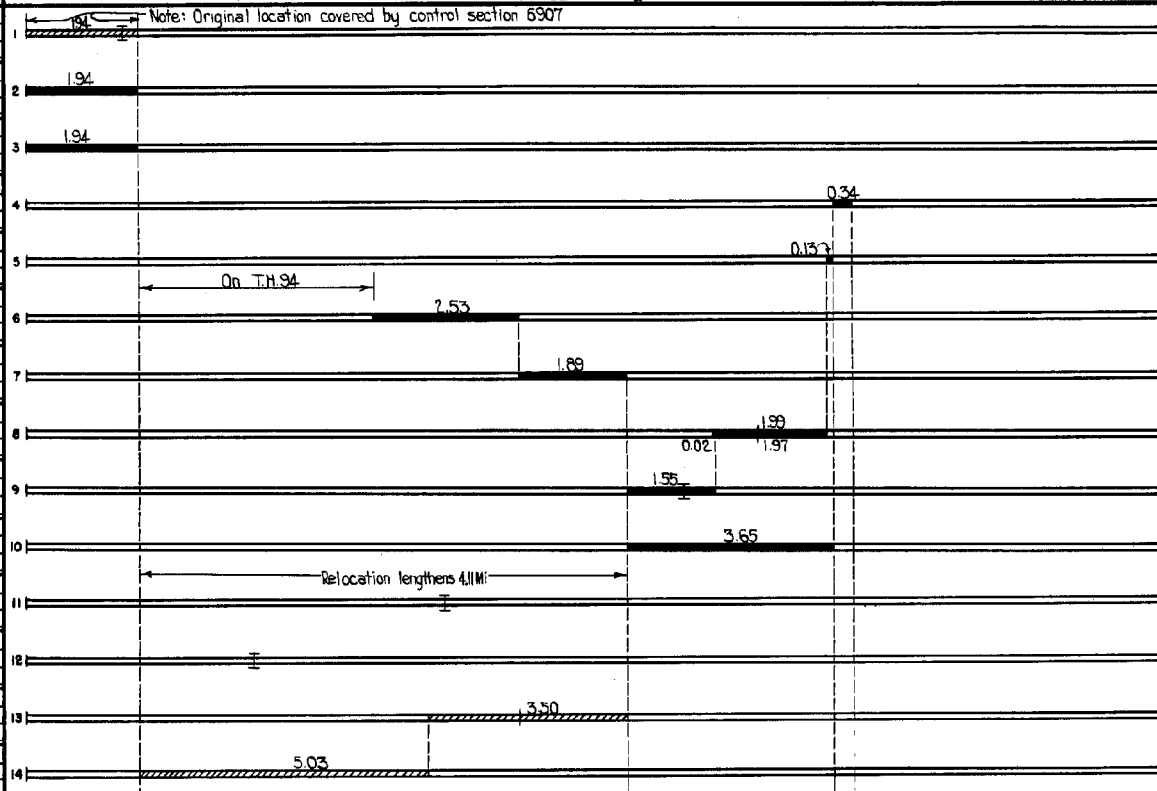

YEARS FROM	TO	TOTAL MILES	UNINCORPORATED		INCORPORATED		RURAL		URBAN		REMARKS: Layout is to scale as of 1936.
			ROWY. MI.	BR. MI.	ROWY. MI.	BR. MI.	ROWY. MI.	BR. MI.	ROWY. MI.	BR. MI.	
1937	1933	3.4	1.94	0.00	0.00	0.00	1.94	0.00	0.00	0.00	(1) This work not done under these project numbers but lies within the limits of these projects.
1934	1933	0.55	0.55	0.01	1.49	0.00	0.55	0.01	1.49	0.00	
1936	1935	4.26	1.92	0.01	1.49	0.00	1.92	0.01	1.49	0.00	
1936	1937	4.80	12.95	0.01	1.84	0.00	12.95	0.01	1.84	0.00	
1958	1975	4.65	12.80	0.01	1.84	0.00	12.80	0.01	1.84	0.00	
1976		14.65	23.5	0.01	5.09	0.00	23.5	0.01	5.09	0.00	

PREPARED BY
HIGHWAY PLANNING SURVEY
IN COOPERATION WITH
U. S. PUBLIC ROADS ADMINISTRATION

STATE OF MINNESOTA
DEPARTMENT OF HIGHWAYS
ROAD LIFE STUDIES
CONSTRUCTION PROJECT LOG RECORD

CONTROL SECTION 6908
TRUNK HIGHWAY 7
COUNTY St. Louis
DISTRICT 1A

LIMITS: Jct. T.H. 33 - W. Corp. Limits of Duluth.

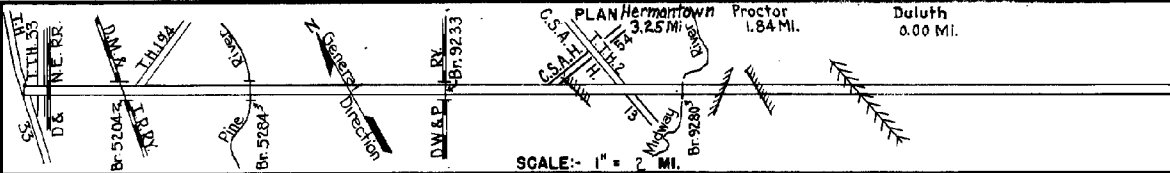

YEAR BUILT	PROJECT N°	DESCRIPTION			CODE N°
		TYPE	WIDTH	THICKNESS	
1938	A.F.E. 12	Gravel Lifts	26'	4'-9"	
					Maint. Dept.
1939	A.F.E. 20	Bit. Surf. Treat.	24'	3"	
					Maint. Dept.
1940	A.F.E. 53	Mixed Bit.	34'	1"	
					Old Conc. Base
M	A.F.E. 34	Spot Treat.			MC-3 RT-9,5919 Gal./Mi.
1940	A.F.E. 17	Bit. Seal Coat			Agg. 261 C.Y./Mi.
					Maint. Dept.
M	A.F.E. 4	Bit. Retreat.	24'		MC-3 3357 Gal./Mi.
1942	A.F.E. 4	Bit. Retreat.	24'		Agg. 81 C.Y./Mi.
					Maint. Dept.
M	A.F.E. 5	Bit. Seal Coat	24'		AE-1 3953 Gal./Mi.
1942	A.F.E. 5	Bit. Seal Coat	24'		Agg. 275 C.Y./Mi.
					Maint. Dept.
M	A.F.E. 4	Spot Treat.			MC-2 1628 Gal./Mi.
1943	A.F.E. 4	Bit. Surf. Repair			Agg. 140 C.Y./Mi.
					Maint. Dept.
M	A.F.E. 4	Spot Treat.			MC-2 RT-4,4647 Gal./Mi.
1944	A.F.E. 4	Bit. Surf. Repair			Agg. 285 C.Y./Mi.
					Maint. Div.
M	A.F.E. 4	Spot Treat.			MC-2 RT-4,4005 Gal./Mi.
1945	A.F.E. 4	Bit. Surf. Repair			Agg. 212 C.Y./Mi.
					Maint. Div.
M	A.F.E. 4	Spot Treat.			MC-1 3835 Gal.
1946	A.F.E. 4	Bit. Surf. Repair	24'		Agg. 1074 C.Y.
C	1946 6908-04	Concrete	20'	9-6-7	
M	A.F.E. 4	Spot Treat.			MC-2 47735 Gal.
1947	A.F.E. 4	Bit. Surf. Repair	24'		Agg. 2389 C.Y.
M	A.F.E. 4	Spot Treat.			MC-2 35982 Gal.
1948	A.F.E. 4	Bit. Surf. Repair	24'		Agg. 2143 C.Y.
M	A.F.E. 4	Spot Treat.			MC-2 1456 Gal.
1950	A.F.E. 4	Bit. Surface Repair For Seal	24'		Agg. 2028 C.Y.

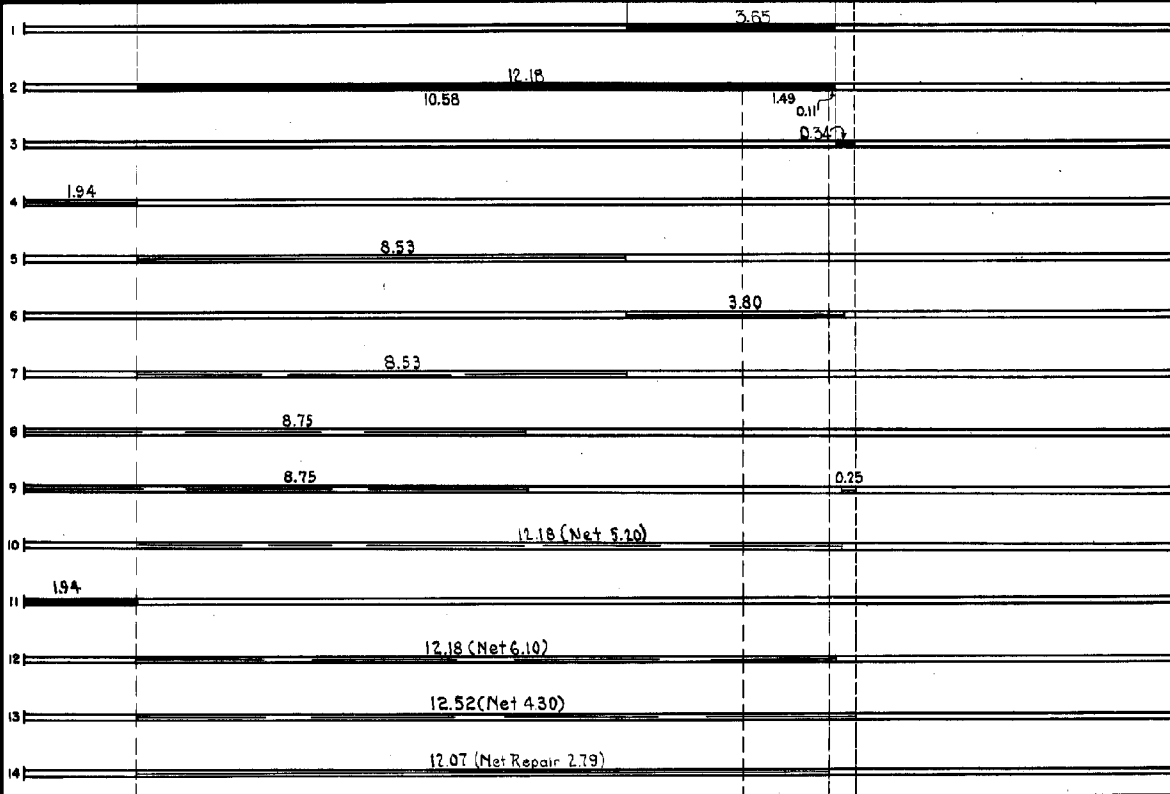

YEARS FROM TO		TOTAL MILES	UNINCORPORATED		INCORPORATED		RURAL		URBAN	
FROM	TO		RDWY. MI.	BR. MI.	RDWY. MI.	BR. MI.	RDWY. MI.	BR. MI.	RDWY. MI.	BR. MI.

REMARKS: See Sheet No 1

PREPARED BY
HIGHWAY PLANNING SURVEY
IN COOPERATION WITH
U.S. PUBLIC ROADS ADMINISTRATION

STATE OF MINNESOTA
DEPARTMENT OF HIGHWAYS
ROAD LIFE STUDIES
CONSTRUCTION PROJECT LOG RECORD

CONTROL SECTION 6908
TRUNK HIGHWAY 7
COUNTY St. Louis
DISTRICT 1A

LIMITS: Jct. T.H. 33 to West Corp. Limits of Duluth

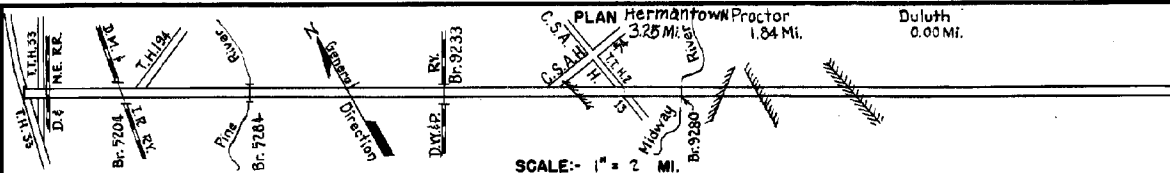

YEAR BUILT	PROJECT N°	DESCRIPTION			CODE N°
		TYPE	WIDTH	THICKNESS	
C	6908-07	Plant Mix Bit	24'	1 1/2" added	
1950	A.F.E. 37	Imp. Shoulders			Reshape & Gravel
M		Spot Treat.			MC-2, 28854 Gal.
1952	A.F.E. 4	Bit. Surf. Repair	24'		Agg. 1656 C.Y.
M		Spot Treat.			MC-2, RC-3, 129099 Gal.
1953	A.F.E. 604	Bit. Surf. Repair	24'		Agg. 1714 C.Y.
	A.F.E. 605	Bit. Seal (0.45 MI)	32'		
M		Spot Treat.			MC-2, 28853 Gal.
1954	A.F.E. 604	Bit. Surf. Repair	24'		Agg. 1868 Tons
M		Spot Treat.			MC-2, 17118 Gal.
1955	A.F.E. 604	Bit. Surf. Repair	24'		Agg. 1422 Tons
M		Spot Treat.			MC-2, 9624 Gal.
1956	A.F.E. 604	Bit. Surf. Repair	24'		Agg. 974 Tons
C		Grading	254'		Ext. W86D (Br. 8016)
1956	6908-06	Grav. Base & Sub-base	254'	17"	
		Mixed Bit. (base)	250'	1 1/2"	
		Mixed Bit. (0.08 MI)	50'		Transferred in from village in 1956
		Concrete (0.17 MI)	46'	7"	
C		Bit. Stab. Base (0.08 MI)	49'	18"	
1957	6908-10	Conc. Base (Widen 0.17)	3'	7"	
	6908-13 *	Hot Asphaltic Conc.	24'	3"	* Traffic Signals
M		Bit. Seal Coat	249'		RC-5, 9388 Gal.
1958	A.F.E. 605	Bit. Seal Coat	249'		Agg. 360 C.Y.
C		Grading			Ext. M106 & Const. Br. 9280 (C128D)
1958	6908-09	Gravel Base *	42'		
		Mixed Bit. Base	26'		* on 12" Sand-Gr. Subbase
C		Br. 9233			120' B.S. UP.
1959	6908-11	Br. 9233			
C		Plant Mix Bit. Surf.	24'	3"	
1960	6908-16	Plant Mix Bit. Surf.	24'	3"	
M		Truck Break Check			
1964	A.F.	Turnout Area	0-12'	13 1/4"	Pl. Mix. 70 Tons
1966	6908-17	Flasher Signal			

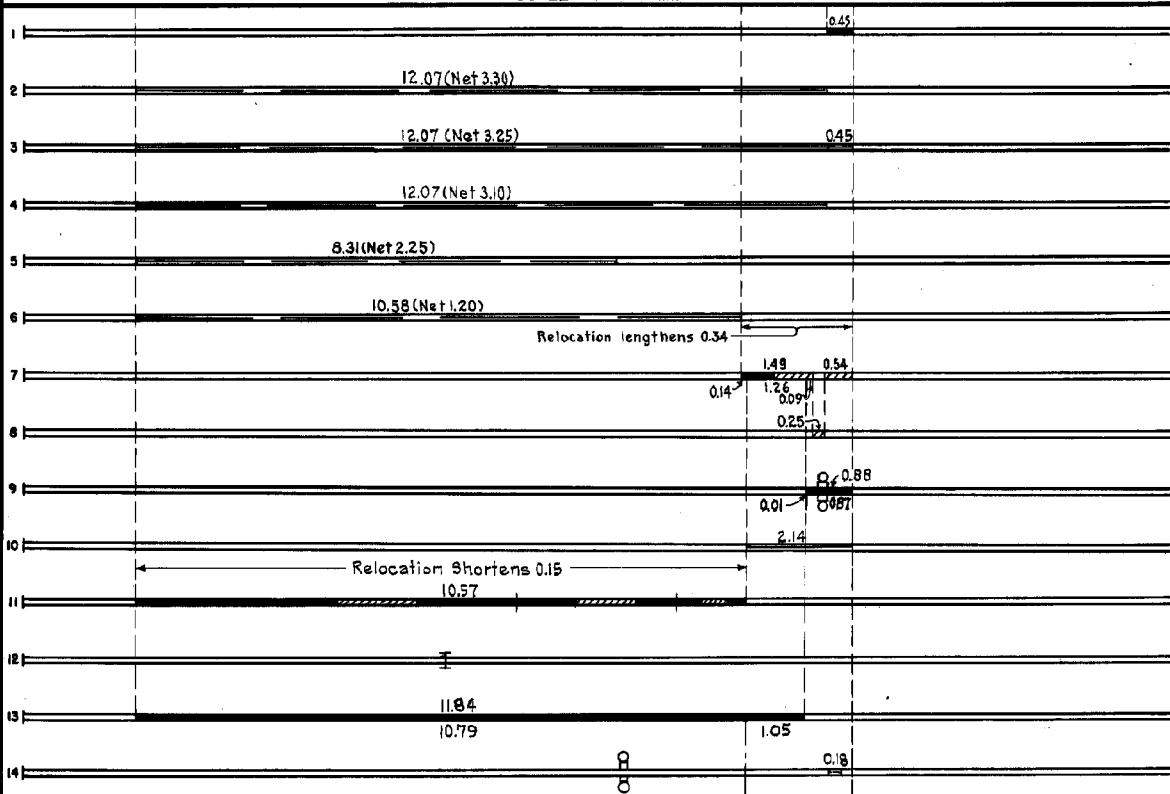

YEARS FROM	TOTAL TO	UNINCORPORATED		INCORPORATED		RURAL		URBAN	
		ROWY. MI.	BR. MI.	ROWY. MI.	BR. MI.	ROWY. MI.	BR. MI.	ROWY. MI.	BR. MI.

REMARKS: See Sheet No. 1.

PREPARED BY
TRAFFIC AND PLANNING DIVISION
IN COOPERATION WITH
U.S. DEPARTMENT OF COMMERCE
BUREAU OF PUBLIC ROADS

STATE OF MINNESOTA
DEPARTMENT OF HIGHWAYS
ROAD LIFE STUDIES
CONSTRUCTION PROJECT LOG RECORD

CONTROL SECTION 6908
TRUNK HIGHWAY 2
COUNTY St. Louis
DISTRICT 1A

LIMITS: Jct. T.H. 33 to West Corp. Limits of Duluth

Ref. Pt. 244+00.837 - 259+00.504

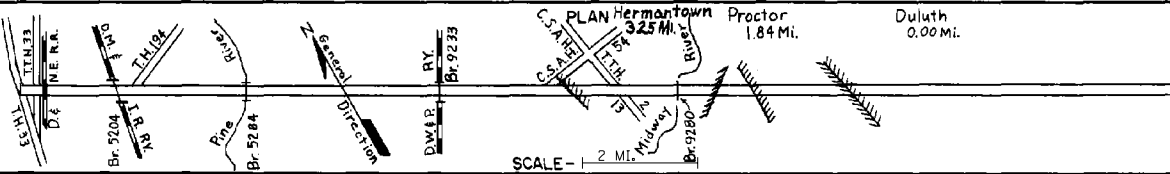

YEAR BUILT	PROJECT NO	DESCRIPTION			
		TYPE	WIDTH	THICKNESS	REMARKS
M 1967	C	Bit. Seal Coat	24'		CRS-1 Bit. 19,757 Gal. FA-1 Agg. 737.3 C.Y.
C 1969	6908-19	Traffic Signals			
	6908-25	Railroad Crossing Signal			
	6908-23	Truck Stopping Lanes			At Railroad Crossing
C 1973	6908-28 FOOB-4(34)	Bit. Overlay & Should.	24'±	1 1/2"	
C 1976	6907-20 RFOOB-4(42)	RT. TURN LANE	13'	1 1/8"	
C 1975	6999-13 4058-1(32)	Bit. Shoulder Const. Grading Bit. Surf. of Downhill Truck Lane	3'	1 1/2"	
C 1970	6908-00 SF	Bit. Resurfacing	45'	5/8"	Bit. Spec. 2361 787 Ton Asph. Cement 78 Ton
C 1981	6900-12 HES0008(47)	Traffic Barrier Construction			
C 1980	6908-34	Drainage Repair Bit. Surf. & Shldr. Turn Lanes	24'	2 1/2"	8' Shld. 1.1 & Rt.
C 1980	6908-35	Drainage Repair Bit. Surf. & Shldr. Turn Lanes	24-48'	1 1/2-2 1/2"	8' Shld. 1.1 & Rt.
M 1984	SF	Spot Bit. Overlays	40'	1-3"	Sp. 2341 - 574.3 Tons Sp. 2361 - 34 Tons
M 1986	SF	Bit. Overlay		1 1/2"	Spec. 2361
C 1988	6908-40	Grading Bit. Surfacing	Var.	1 1/2"	Spec. 2331 Spec. 2341
M 1990	M4372	Crack Repair			
C 1997	6908-49	Milling Bit. Overlay	24'	Var. 3 1/2"	Spec. 2350

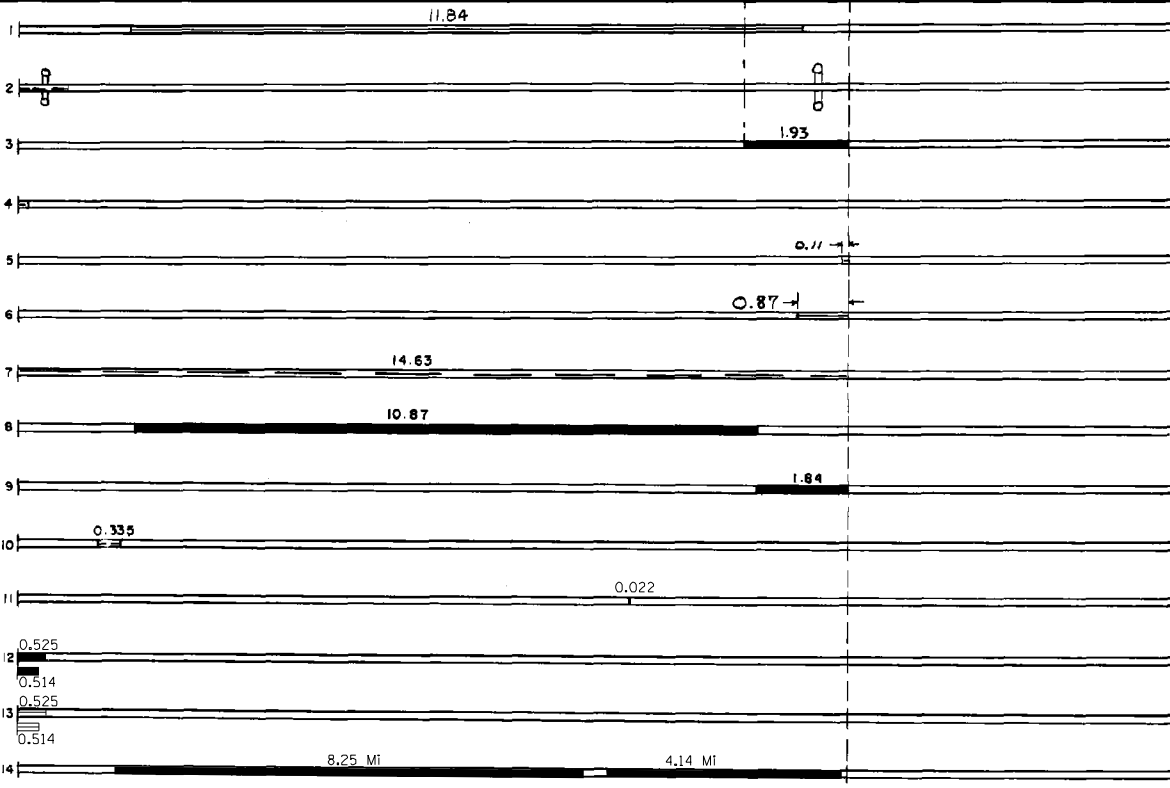

YEARS		TOTAL MILES	UNINCORPORATED		INCORPORATED		RURAL		URBAN	
FROM	TO		RDWY. MI.	BR. MI.	RDWY. MI.	BR. MI.	RDWY. MI.	BR. MI.	RDWY. MI.	BR. MI.

REMARKS: See Sheet No. 1

