

PREPARED BY
TRAFFIC AND PLANNING DIVISION
IN COOPERATION WITH
U.S. DEPARTMENT OF COMMERCE
BUREAU OF PUBLIC ROADS

STATE OF MINNESOTA
DEPARTMENT OF HIGHWAYS
ROAD LIFE STUDIES
CONSTRUCTION PROJECT LOG RECORD

INTERSTATE

CONTROL SECTION 6780
TRUNK HIGHWAY 90
COUNTY Rock
DISTRICT 7B

LIMITS: W. State line (W. Co. line) - E. Co. line

YEAR BUILT	PROJECT NO	DESCRIPTION			
		TYPE	WIDTH	THICKNESS	REMARKS
C	6780-02	Grading, Base P.C. Concrete (358 MI) Br's. 91002 & 91003	20'24"	9"	358 MI, Divided Highway P.L. Mix Temp Conn (0.29) C108 D & C(11-14-10) 10T
C	6780-06	Br's. 9685 & 9686	30'36"		Both are 119' P.P.G. - O.H.
C	6780-04	Br. 9687			201' B.S. - U.P.
C	6780-11	Grading	20'49"		Divided Highway
C	6780-19	Sub-base & Gr. Base P.C. Concrete	20'24"	9"	
C	6780-15	Grading	20'49"		Divided Highway
C	6780-9689	Br. 9689	30'		387' P.P.G. - O.H.
C	6780-9690	Br. 9690	30'		387' P.P.G. - O.H.
C	6780-9774	Br. 9774			215' P.P.G. - U.P.
C	6780-678001	Br's. 67801 & 67802	37'03"		Both are 119' B.S. - O.H.
C	6780-67802	Br. 67802			212' P.P.G. - U.P.
C	6780-67805	Br's. 67805 & 67806	38'28"		Both are 194' B.S. - O.H.
C	6780-67807	Br's. 67807 & 67808	38'28"		Both are 111' P.P.G. - O.H.
C	6780-67809	Br. 67809			212' P.P.G. - U.P.
C	6780-91077	Br. 91077			C(11-14-11) 10T
C	6780-67810-11	Br's. 67810 & 67811			Both are 212' P.P.G. - U.P.
C	6780-91073	Br. 91073			C 106 D
C	6780-20 (1)	Sand-gravel Sub-base Gravel Base P.C. Concrete	20'28"	2 1/4"	
M	1971	SF			Joint Seal
M	1972	SF			Joint Seal
M	1973	SF			Joint Seal
M	1974	SF			Joint Seal
M	1978	SF			Bit Seal Coat
M	1978	SF			Bit Seal Coat
M	1978	SF			Bit Seal Coat

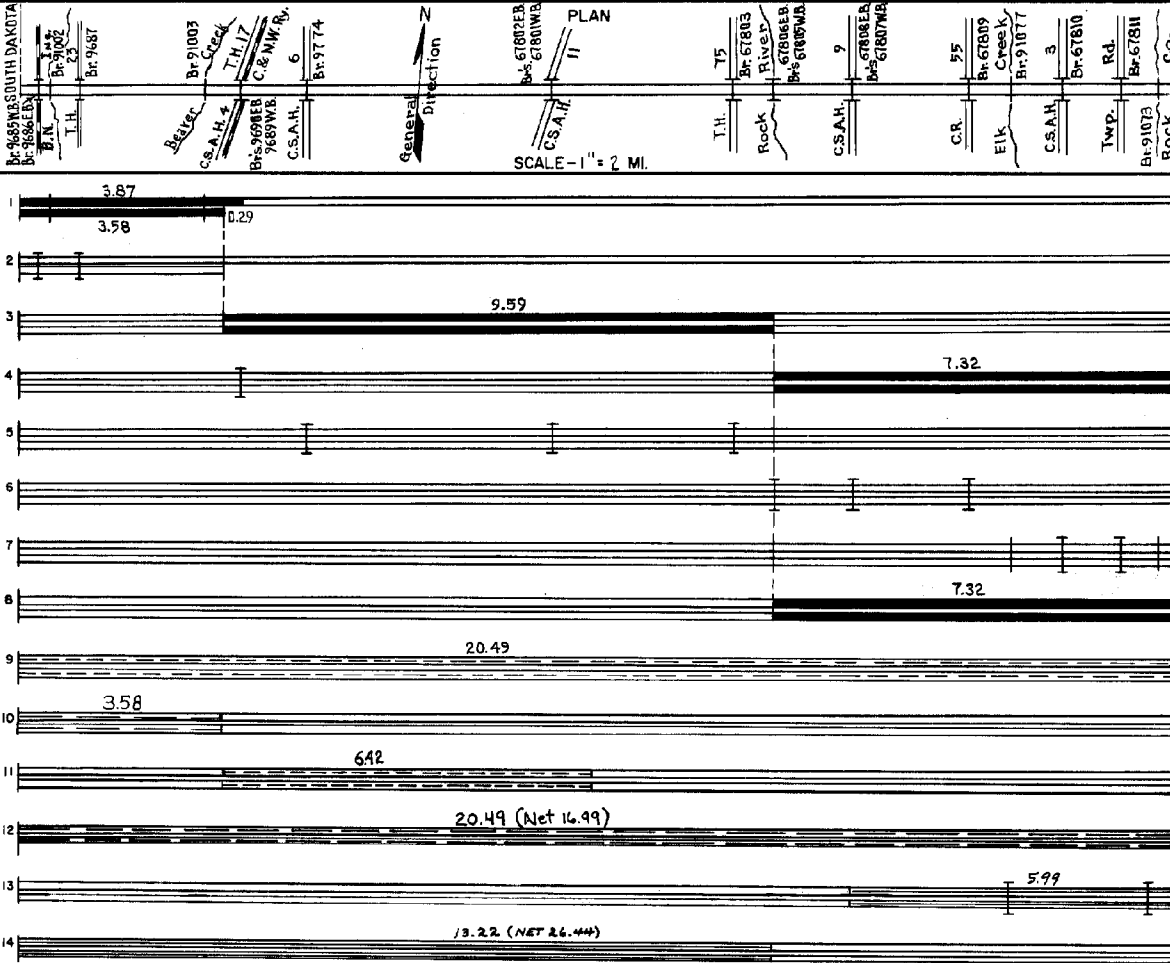

YEARS FROM	TOTAL MILES TO	UNINCORPORATED		INCORPORATED		RURAL		URBAN	
		RDWY. MI.	BR. MI.	RDWY. MI.	BR. MI.	RDWY. MI.	BR. MI.	RDWY. MI.	BR. MI.
1960	1964	3.87	3.85	0.00	0.00	3.85	0.02	0.00	0.00
1965	1965	12.47	12.35	0.12	0.00	12.35	0.12	0.00	0.00
1966	1966	18.48	18.30	0.18	0.00	18.30	0.18	0.00	0.00
1967	1967	20.49	20.31	0.18	0.00	20.31	0.18	0.00	0.00

REMARKS: Layout is to scale as of 1960.
(1) The easterly 2.01 mi. not in use until 1967.

4-75

PREPARED BY
BUREAU OF POLICY & PLANNING
IN COOPERATION WITH
U. S. DEPARTMENT OF TRANSPORTATION - FEDERAL HIGHWAY ADMINISTRATION

STATE OF MINNESOTA
DEPARTMENT OF TRANSPORTATION
CONSTRUCTION PROJECT LOG RECORD

CONTROL SECTION 6780
TRUNK HIGHWAY 90
COUNTY Rock
DISTRICT 7B

LIMITS: W. State Line (W. Co. Line) - E. Co. Line
000+00.000 - 020+00.493

YEAR BUILT	PROJECT No	DESCRIPTION				
		TYPE	WIDTH	THICKNESS	REMARKS	
S	2001	6780-95	Bit. Overlay	28'	3"	Spec. 2350
			Gravel Surfacing	6'	3"	Class 1
S	2002	6780-97	Mill & Bit. Overlay	24'	4"	Spec. 2360
M	2004	6780-99	Bit Joint Repair			EB
S	2005	6780-98	Milling & Bituminous Overlay	24'	6"	for 800'
			Conc joint repair	24'	3"	Spec 2360 in spots
M	2007	8827-85	Crack Seal			Spec. 3725 E.B. only
M	2008	8827-102	Crack Seal			Type 3725
S	2013	6780-101	Bit Overlay			Spec. 2360
S	2017	6780-105	Grading prep & compact	agg	base	
			Concrete Surf.	10' RT, 4' LT	9'	9'
			conc. shldr			1 1/2' Agg shldr

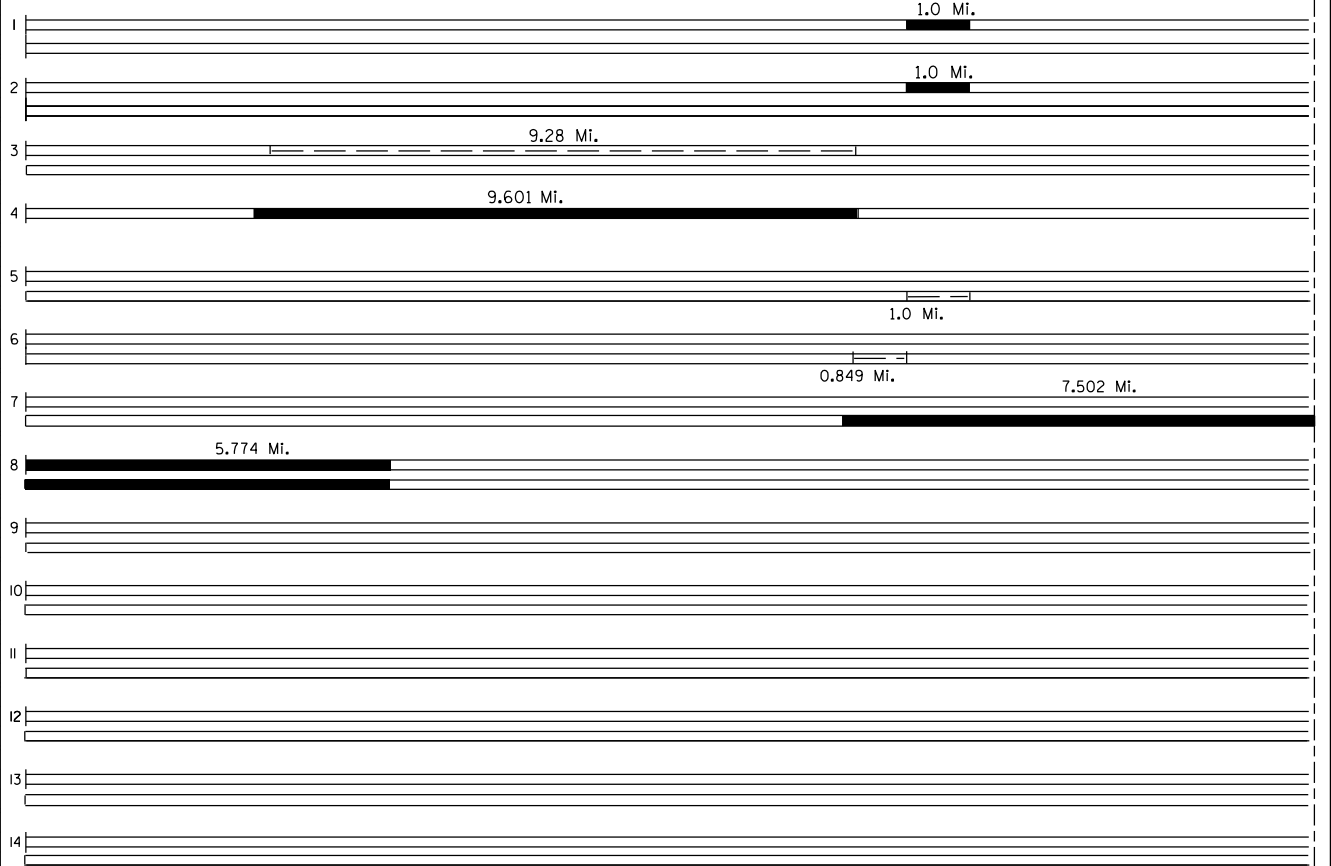
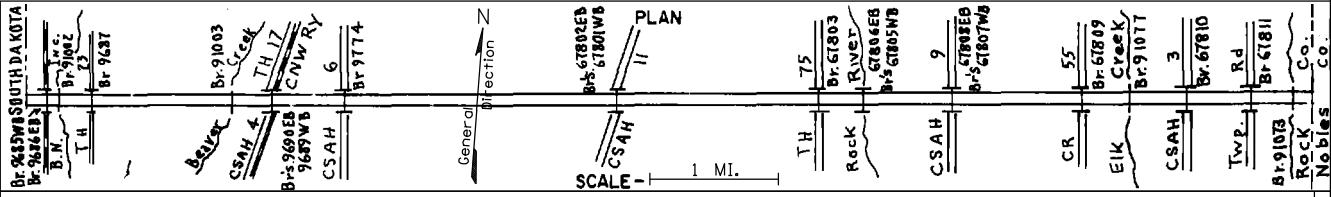

YEARS FROM TO		TOTAL MILES	UNINCORPORATED RDWY. MI. BR. MI.		INCORPORATED RDWY. MI. BR. MI.		RURAL RDWY. MI. BR. MI.		URBAN RDWY. MI. BR. MI.	

REMARKS: