

PREPARED BY
HIGHWAY PLANNING SURVEY
IN COOPERATION WITH
U.S. PUBLIC ROADS ADMINISTRATION

STATE OF MINNESOTA
DEPARTMENT OF HIGHWAYS
ROAD LIFE STUDIES
CONSTRUCTION PROJECT LOG RECORD

CONTROL SECTION 6614
TRUNK HIGHWAY 246
COUNTY Rice
DISTRICT 68

LIMITS: Jct. T.H. 13 in Northfield - 270 E. of Cherry St. in Nerstrand

Northfield 0.49 Mi. Nerstrand 0.47 Mi.
See Sheet 2 for Plan Subsequent to 1958
PLAN
General Direction

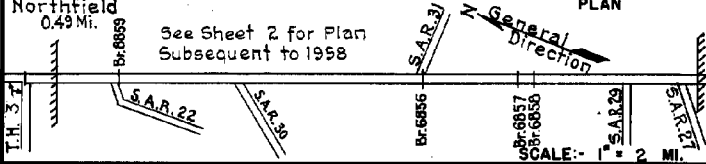

YEAR BUILT	PROJECT N ^o	DESCRIPTION			CODE N ^o
		TYPE	WIDTH	THICKNESS	
		Mixed Bit.	40"		No Record of Const. Added in 1949
		Gravel	26"		No Record of Const. Added in 1949
1936	66-01	Grading	24"		Co. Job 3601 Added in 1949
		Gravel	26"		No Record of Const. Added in 1949
M	1950 A.F.E. 6	Gravel Resurfacing	20"		3001 Tons
C	1970 A.F.E. 18	Spot Sand-Gravel Base Bit. Surfacing	30"	6"	MC 0 1 Sc 9, 22095 Gal. Agg. 1421 Tons
M	1951 A.F.E. 4	Light Bit. Seal	22"		RS-1, 3128 Gal. Agg. 60 C.Y.
M	1952 A.F.E. 6	Grav. Resurfacing			4908 Tons
M	1952 A.F.E. 4	Spot Treat. Bit Surf. Repair			5626 MC2, 9122 Gal. Agg. 502 C.Y.
M	1953 A.F.E. 604	Light Bit. Seal	22"		(Net Repair 100 Mi. for patching) MC2 & SC2, 11840 Gal. Agg. 684 C.Y.
C	6614-02	Grading	42"		C106T (Br. 8859) C12AD
C	6614-06	Gravel (1200 C.Y./Mi)	30"	2"	(Br. 6856) C101A-11) C1T (Br. 6857 & C12AD) (Br. 8858)
C	6614-07	Gravel Base Mixed Bit.	34" 3'-16" 24" 1 1/2"		Grading (Mi. Pt. 0.01-0.20)
M	1958 A.F.E. 605	Light Bit. Seal	25"		RS-2, 23034 Gal. Agg. 688 C.Y.
C	1959 6614-11	Grading Gravel Base Mixed Bit. Base	44" 44" 16" 44" 1 1/2"		

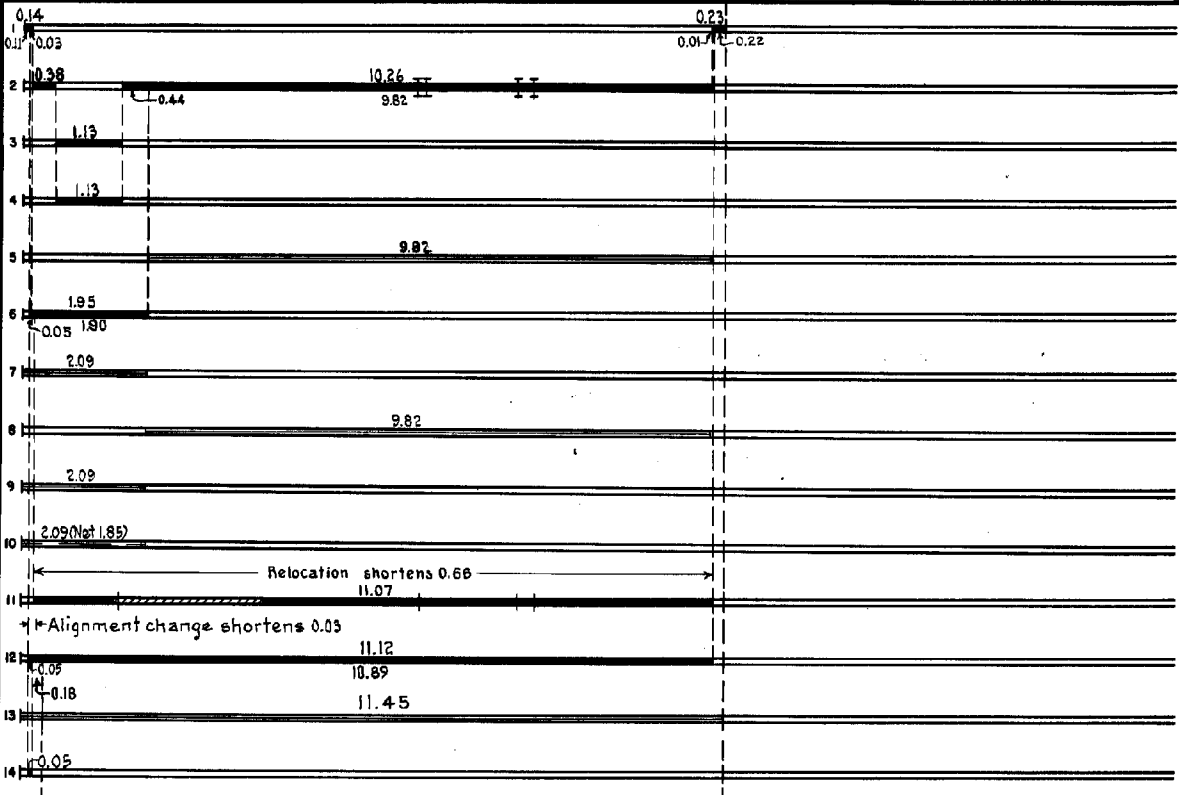

FROM YEARS	TO YEARS	TOTAL MILES	UNINCORPORATED		INCORPORATED		RURAL		URBAN	
			RDWY. MI.	BR. MI.	RDWY. MI.	BR. MI.	RDWY. MI.	BR. MI.	RDWY. MI.	BR. MI.
1949	1954	12.14	11.13	0.02	0.98	0.00	11.60	0.02	0.52	0.00
1955	1955	11.48	10.49	0.00	0.99	0.00	10.96	0.00	0.52	0.00
1956	1956	11.45	10.49	0.00	0.96	0.00	10.96	0.00	0.49	0.00
1959	1964	13.34	10.99	0.00	2.32	0.03	12.24	0.00	1.07	0.03
1965	1971	13.30	10.99	0.00	2.28	0.03	12.24	0.00	1.03	0.03
1972	1974	13.37	10.99	0.00	2.35	0.03	12.24	0.00	1.10	0.03
1975	1975	13.37	10.89		2.45	0.03	12.14		1.20	0.03

REMARKS: Layout is to scale as of 1949

6-76

PREPARED BY
TRAFFIC AND PLANNING DIVISION
IN COOPERATION WITH
U.S. DEPARTMENT OF COMMERCE
BUREAU OF PUBLIC ROADS

STATE OF MINNESOTA
DEPARTMENT OF HIGHWAYS
ROAD LIFE STUDIES
CONSTRUCTION PROJECT LOG RECORD

CONTROL SECTION 6614
TRUNK HIGHWAY 246
COUNTY Rice
DISTRICT 68

LIMITS: Jct. T.H. 3 in Northfield - E. Co. Line

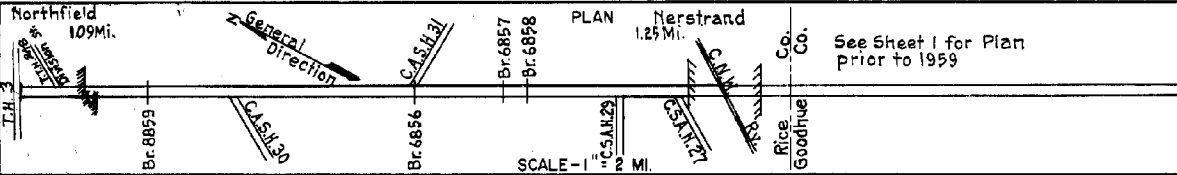

YEAR BUILT	PROJECT NO	DESCRIPTION			
		TYPE	WIDTH	THICKNESS	REMARKS
1946	6603-12	P.C. Concrete On old P.C. Conc. Base	32'		
1932	218-1-26-1	P.C. Concrete On old P.C. Conc. Base Br. 1232	56' 24'	4 1/2" 5"	152' C.S.
1946	A.F.E. 22 A.F.E. 26	Plant Mix Bit. On old Concrete Base	40-44'	1 1/2" 6"	
		Mixed Bit.	24'		No Record of Const.
		Gravel	28'		Added in 1959 No Record of Const. Added in 1959
M	1959 A.F.E. 604	Bit Surface Repair	Vari.	2"	Plant Mix 296 Tons
M	1960	Agg. Resurfacing	24'		Gravel 672 Tons
C	1966 Maint. Proj.	Plant Mix Bit. Gravel Shoulders	24-32'	1 1/2"	
C	1965 6612-50	Grading, Base Asphaltic Conc. Surf.	52'	3"	
C	1977 SF	Agg. Resurf.	28'	6 1/2"	3055 Cu. Yd.
M	1976 SF	Bit. Spot Overlay	24'	1"	AC-1 2331 309 Ton CRS-2 Tack 170 Gal.
C	1978 SF	Pl. Mix Bit. Overlay	24'	3"	

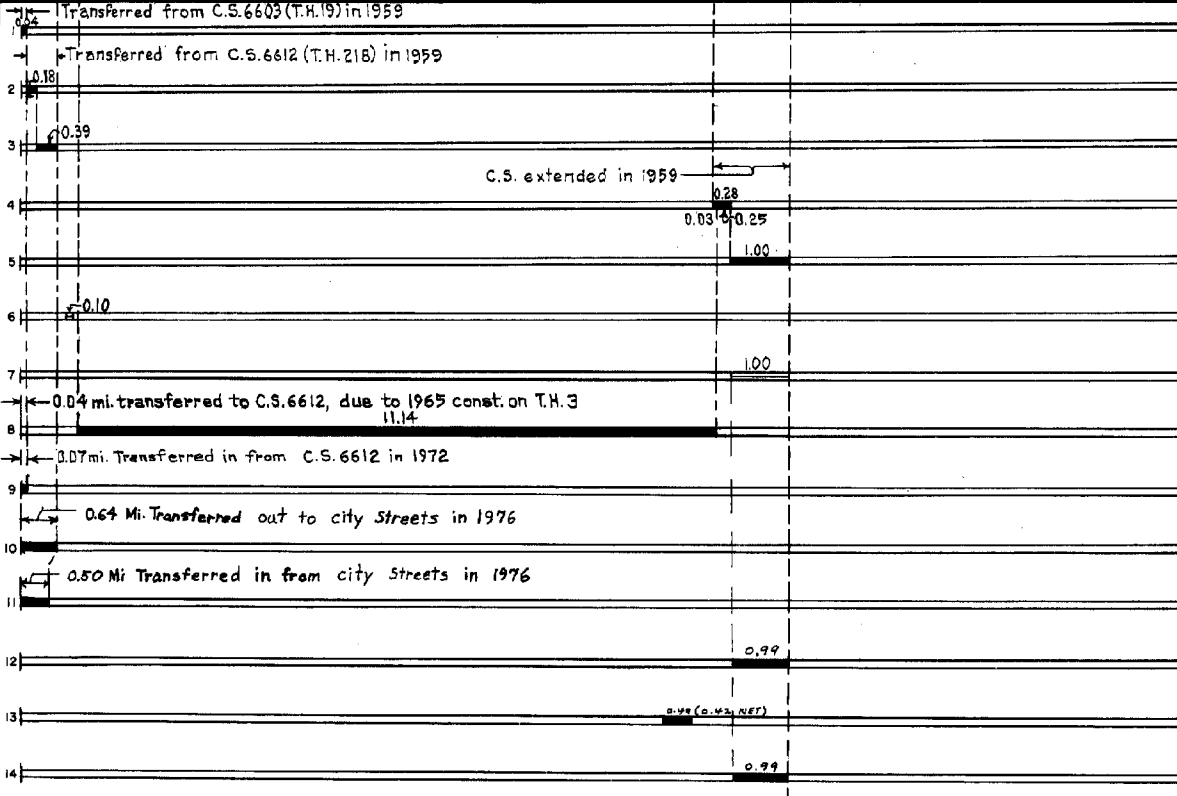

0.04 mi. transferred to C.S. 6612, due to 1965 const. on T.H. 3
11.14
0.07 mi. Transferred in from C.S. 6612 in 1972
0.64 Mi. Transferred out to city Streets in 1976
0.50 Mi Transferred in from city Streets in 1976

YEARS		TOTAL MILES	UNINCORPORATED		INCORPORATED		RURAL		URBAN	
FROM	TO		RDWY. MI.	BR. MI.	RDWY. MI.	BR. MI.	RDWY. MI.	BR. MI.	RDWY. MI.	BR. MI.
1976		13.23	10.89		2.34	12.14		1.09		

REMARKS: Layout is to scale as of 1959

6-76

