

PREPARED BY
HIGHWAY PLANNING SURVEY
IN COOPERATION WITH
U.S. PUBLIC ROADS ADMINISTRATION

STATE OF MINNESOTA
DEPARTMENT OF HIGHWAYS
ROAD LIFE STUDIES
CONSTRUCTION PROJECT LOG RECORD

CONTROL SECTION 6611
TRUNK HIGHWAY 65
COUNTY Rice
DISTRICT 6B

LIMITS: 2.32 mi. S. - N. Co. Line

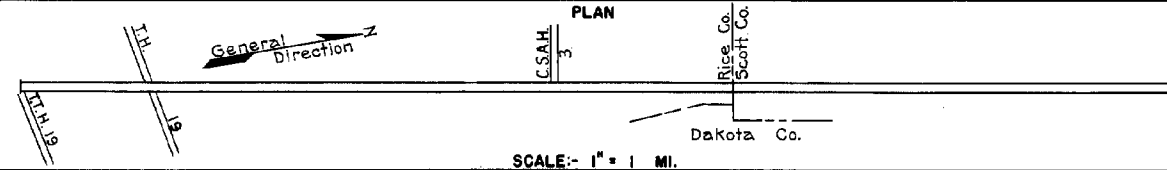

YEAR BUILT	PROJECT N ^o	DESCRIPTION			CODE N ^o
		TYPE	WIDTH	THICK-NESS	
1924		Gravel Br. 3978	24' 21"	3 1/2"	
M	1940 A.F.E. 38	Spot Graveling			
M	1942 A.F.E. 6	Spot Graveling			
M	1943 A.F.E. 6	Grav. Resurface (9 spots)			
M	1944 A.F.E. 6	Grav. Resurfacing (Spots)			
C	1947 6611-04	Grading & Slab Gravel Culverts (1)	32'	2"	
C	1949 6611-06	Gravel Base Plant Mix Bit. (2)	32'	10" 15"	
M	1951 A.F.E. 4	Light Bit. Seal	24'		
C	1952 6611-07	Plant Mix Bit.	24'	3" added	
M	1963	Light Bit. Seal (Spots)	25'		

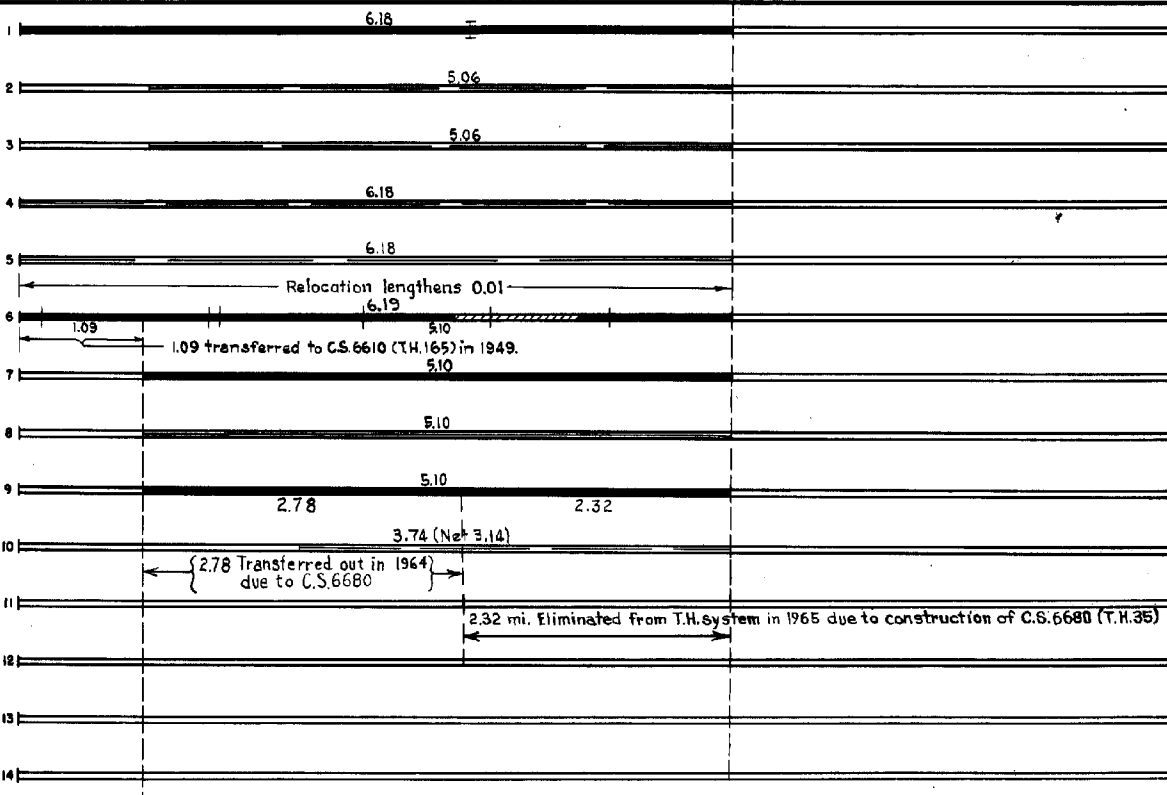

YEARS		TOTAL MILES	UNINCORPORATED		INCORPORATED		RURAL		URBAN	
FROM	TO		RDWY. MI.	BR. MI.	RDWY. MI.	BR. MI.	RDWY. MI.	BR. MI.	RDWY. MI.	BR. MI.
1934	1946	6.18	5.17	0.01	0.00	0.00	6.17	0.01	0.00	0.00
1947	1948	6.19	6.19	0.00	0.00	0.00	6.19	0.00	0.00	0.00
1949	1963	5.10	5.10	0.00	0.00	0.00	5.10	0.00	0.00	0.00
1964	1964	2.32	2.32	0.00	0.00	0.00	2.32	0.00	0.00	0.00
1965		0.00	0.00	0.00	0.00	0.00	0.00	0.00	0.00	0.00

REMARKS: Layout is to scale as of 1934 (1) Place 10 S.C. cattle passes; extend W46, W44 & 2-VY66; const. C88 & VY88 (2) Contract not final but work substantially complete in 1949.