

PREPARED BY  
HIGHWAY PLANNING SURVEY  
IN COOPERATION WITH  
U.S. PUBLIC ROADS ADMINISTRATION

STATE OF MINNESOTA  
DEPARTMENT OF HIGHWAYS  
ROAD LIFE STUDIES  
CONSTRUCTION PROJECT LOG RECORD

CONTROL SECTION 6607  
TRUNK HIGHWAY 60  
COUNTY Rice  
DISTRICT 6B

LIMITS: Jct. T.H. 65 in Faribault - E. Co. Line

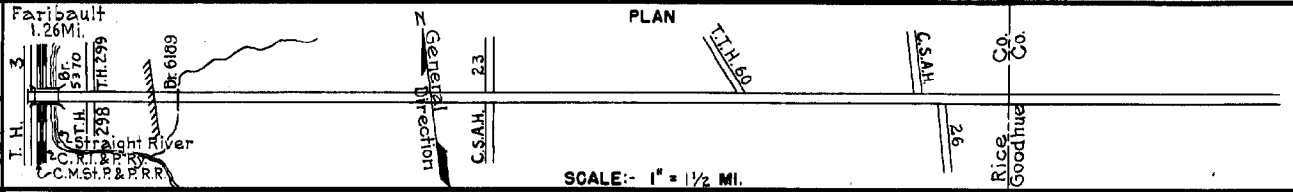

YEAR BUILT	PROJECT N <sup>o</sup>	DESCRIPTION			CODE N <sup>o</sup>
		TYPE	WIDTH	THICKNESS	
		Wood & Brick Pave.	11'		No Record of Constr.
		Gravel	20'	2"	No Record of Constr.
		Br. M. 230	18'		140 H.T.
		Br. M. 233			U.P. Street
1921	60-21-3	Grading			
		Gravel	24'	3"	1422 C.Y./Mile.
1930		Tar Tr. Gravel	20'		No Record of Constr. Status map shows oil in 1930.
		Oil Tr. Gravel	20'		No Record of Constr. City St. taken over in 1932.
		Br. 6189			W108 T.H.
1932	60-21-26-1A&B	Grading	32'		
		Gravel	28'	1 3/4"	900 C.Y./Mile.
				(1)	
1934	60-21-26-1A&B	Gravel	28'	4"	1300 C.Y./Mile.
				(2)	
1934	60-21-26-1A&B	Stab. Gravel	30'	2 1/2"	
				(2)	Maint. Dept.
1935	60-21-26-1A	Tar Tr. Gravel	20'		680 Gal./Mile. Maint. Dept.
				(2)	
1936	60-21-26-1A	Tar Tr. Gravel	20'	1"	9977 Gal./Mile. Maint. Dept.
				(2)	
1936	60-21-26-1B	Oil Tr. Gravel	20'	1"	9977 Gal./Mile. Maint. Dept.
1937	60-21-26-4B	Grading	40'		
1938	6607-01	Br. 5370	30'		933 C.D.G.C.A. & C.S. O.H.
1939	A.F.E. 35	Gravel	36'	1"	Maint. Dept.

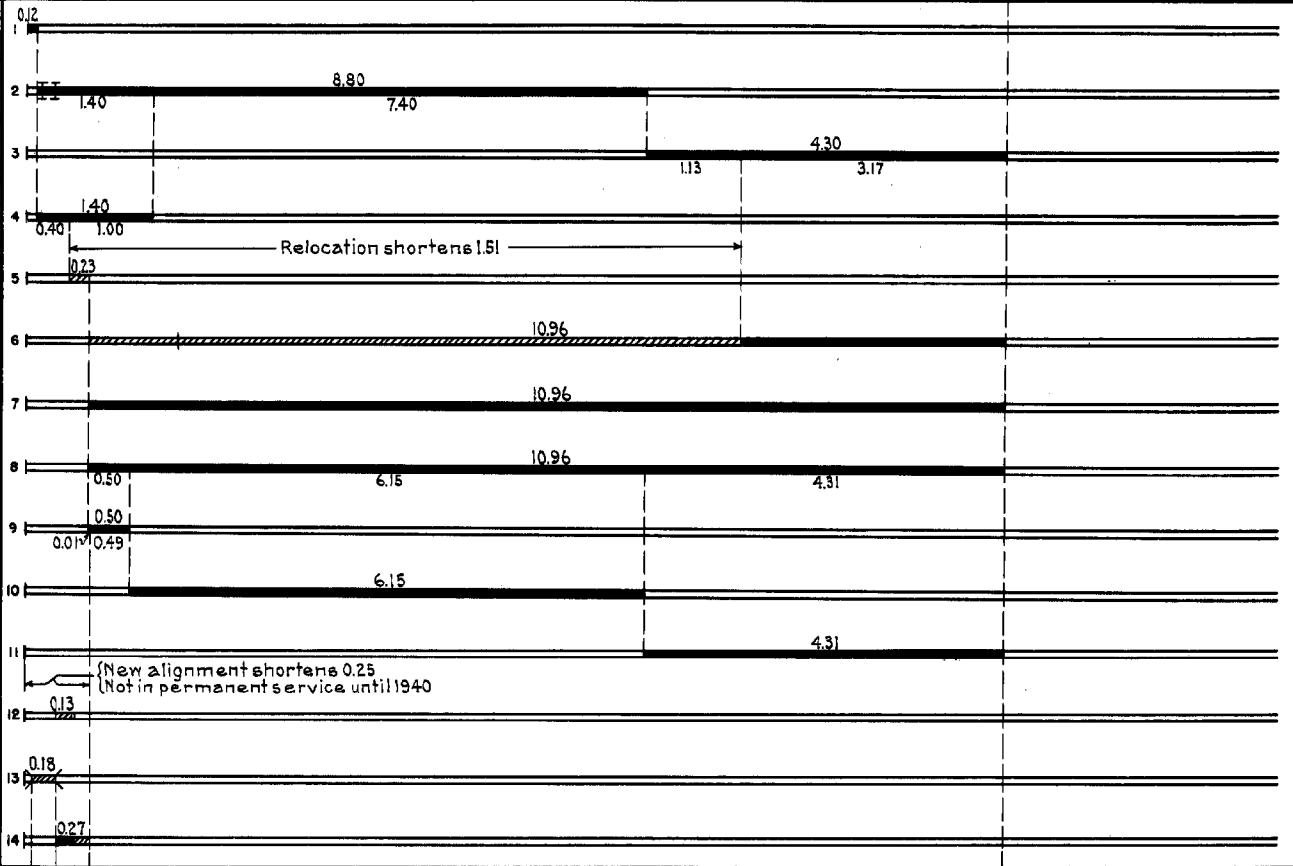

YEARS		TOTAL MILES	UNINCORPORATED		INCORPORATED		RURAL		URBAN	
FROM	TO		ROWY. MI.	BR. MI.	ROWY. MI.	BR. MI.	ROWY. MI.	BR. MI.	ROWY. MI.	BR. MI.
1921	1931	13.22	11.70	0.00	1.45	0.03	11.70	0.00	1.45	0.03
1932	1935	11.71	10.21	0.00	1.47	0.03	10.21	0.00	1.47	0.03
1940	1941	11.46	10.21	0.00	1.07	0.18	10.21	0.00	1.07	0.18
1942	1966	11.47	10.21	0.00	1.08	0.18	10.21	0.00	1.08	0.18
1967		12.68	10.21	0.00	2.49	0.18	10.21	0.00	2.49	0.18

REMARKS: Layout is to scale as of 1932.

(1) Accumulated thickness. (2) This work not done under these project numbers but lies within the limits of these projects.

PREPARED BY  
HIGHWAY PLANNING SURVEY  
IN COOPERATION WITH  
U. S. PUBLIC ROADS ADMINISTRATION

STATE OF MINNESOTA  
DEPARTMENT OF HIGHWAYS  
ROAD LIFE STUDIES  
CONSTRUCTION PROJECT LOG RECORD

CONTROL SECTION 6607  
TRUNK HIGHWAY 50  
COUNTY Rice  
DISTRICT 2B

LIMITS Jct. T.H. 65 in Fairbault - E. Co. Line

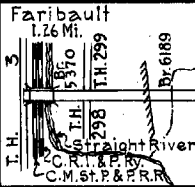

YEAR BUILT	PROJECT N <sup>o</sup>	DESCRIPTION			CODE N <sup>o</sup>
		TYPE	WIDTH	THICKNESS	
1939	6607-05	Misc. Structures			
C					Work done by W.P.A.
1940	6607-07	Concrete	54'	9-7-9	
	6607-04	Concrete	40'	9-7-9	
M					SC-2, 2780 Gal./Mi.
1940	A.F.E. 26	Bit. Retreat			Grav. 51 C.Y./Mi. Maint. Dept.
M					Bit. 492 Gal./Mi.
1941	A.F.E. 19	Spot Treat. Bit. Surf. Repair			Maint. Dept.
C					0.31 Mi. in Fairbault
1942	6607-12	Stab. Grav. Base	30'	6-9"	37' Wide.
	6607-13				
C					
1943	6607-14	Mixed Bit.	26'	1"	
	6607-15				
C					
1944	6607-19	Mixed Bit.	26'	1 1/2" Added	
M					A.E-1, 31533 Gal. Agg. 845 C.Y.
1946	A.F.E. 5	Bit. Seal Coat	16'		
C					MC3 & SC3, 44463 Gal. Agg. 3315 Tons
1947	A.F.E. 16	Bit. Resurfacing Mixed Bit.	26'	1" Added	
M					RS-2, 10578 Gal. Agg. 306 C.Y.
1949	A.F.E. 5	Bit. Seal Coat	26'		
C					
1952	6607-22	Plant Mix Bit.	24'	2-4" added	
C					
1953	6607-23	Precast Concrete Cattle Pass			
M					RS-2, 41864 Gal. Agg. 1328 C.Y.
1957	A.F.E. 605	Bit. Seal Coat	25'		
C					
1961	6607-20	Grading, Base & Bit. Surface on Frontage Road			

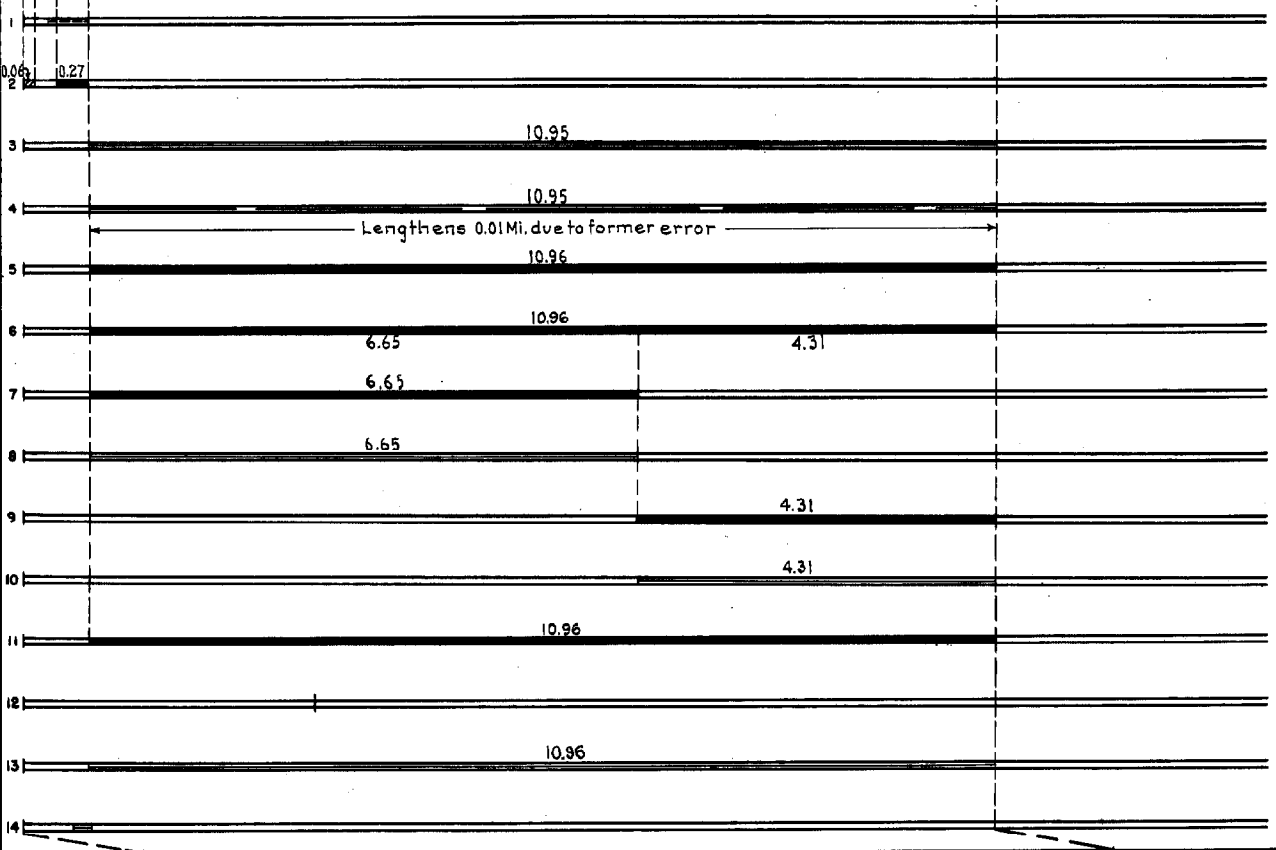

YEARS FROM	TOTAL TO	UNINCORPORATED		INCORPORATED		RURAL		URBAN	
		RDWY. MI.	BR. MI.	RDWY. MI.	BR. MI.	RDWY. MI.	BR. MI.	RDWY. MI.	BR. MI.

REMARKS: See Sheet No 1

PREPARED BY  
TRAFFIC AND PLANNING DIVISION  
IN COOPERATION WITH  
U.S. DEPARTMENT OF COMMERCE  
BUREAU OF PUBLIC ROADS

STATE OF MINNESOTA  
DEPARTMENT OF HIGHWAYS  
ROAD LIFE STUDIES  
CONSTRUCTION PROJECT LOG RECORD

CONTROL SECTION **6607**  
TRUNK HIGHWAY **50**  
COUNTY **Rice**  
DISTRICT **6B**

LIMITS: Jct. T.H. 65 in Faribault - E. Co. Line

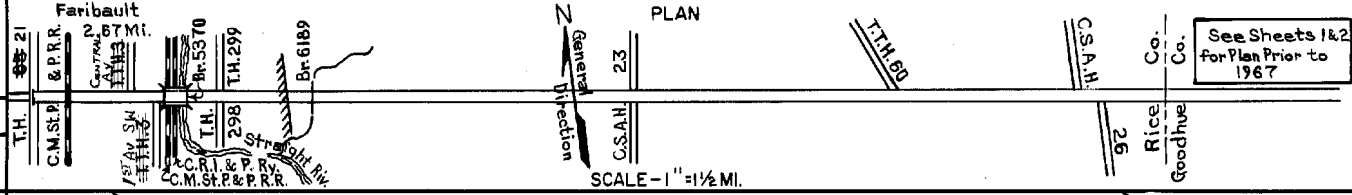

YEAR BUILT	PROJECT NO	DESCRIPTION				REMARKS
		TYPE	WIDTH	THICKNESS		
1955	6606-17	Plant Mix Bit.	0.40mi	24'-6"	3"	Transferred from
1947	6606-DE	Concrete	0.69mi	56'		C.S. 6606 (60-60) in 1967
1925	218-1-46	Concrete	0.02mi	18'	7 1/2"	Transferred from
		Brick	0.02mi	20'		C.S. 6612 (3=1) in 1967
1947	6612-24	Concrete	0.28mi	56'		1967
C+M		Bit Surf. Repair and		24'	1"	MC 250 Tack 250 Gal.
1967	SF	Right Turn Lane				Bit. Mixture 711 Ton
M						MC-250 Tack 336 Gal.
1968	SF	Spot Patch		24'	1"	Agg. 597 Tons
M						MC-250 Tack 350 Gal.
1969	SF	Bit. Overlay		24'	1"	Agg. 750 Tons
M						MC 250. 518 Gal.
1970	SF	Spot Repair		24'	1"	Agg. 552 Tons
C						
1972	-25	Asph. Conc. Resurf.		56'	1 3/4"	
M						
1973	SF	Bit. SURF. REPAIR		24'	1"	AC-1 2331 1103.6 Ton RC 200 Tack 440 GAL
M						
1977	SF	Bit. SURF. REPAIR		24'	1"	AC-1 2331 2044 Ton CRS-2 Tack 1095 GAL
M						
1977	SF	RESTORE AGG. SHLDRS.	VAR.	VAR.	VAR.	AGGREGATE 377 Cu. Yd.
C						
1978	6607-27	TRAFFIC CONTROL SIGNAL SYSTEM				FULL TRAF. ACTUATED AT DIVISION ST 14th Av NE
M						
1978	6607-SF	Bit. SURF. REPAIR		24'	1 1/2"	AC-1 2331 2606 Ton CRS-1 Tack 835 GAL
M						
1978	SF	RESTORE AGG. SHLDRS.	VAR.	VAR.	VAR.	AGG 1190 Ton
M						
1979	SF	Bit. Surface Repair		24'	1"	1697 Ton 172 Gal. CRSH CRS-1 2331 Tack RE-1

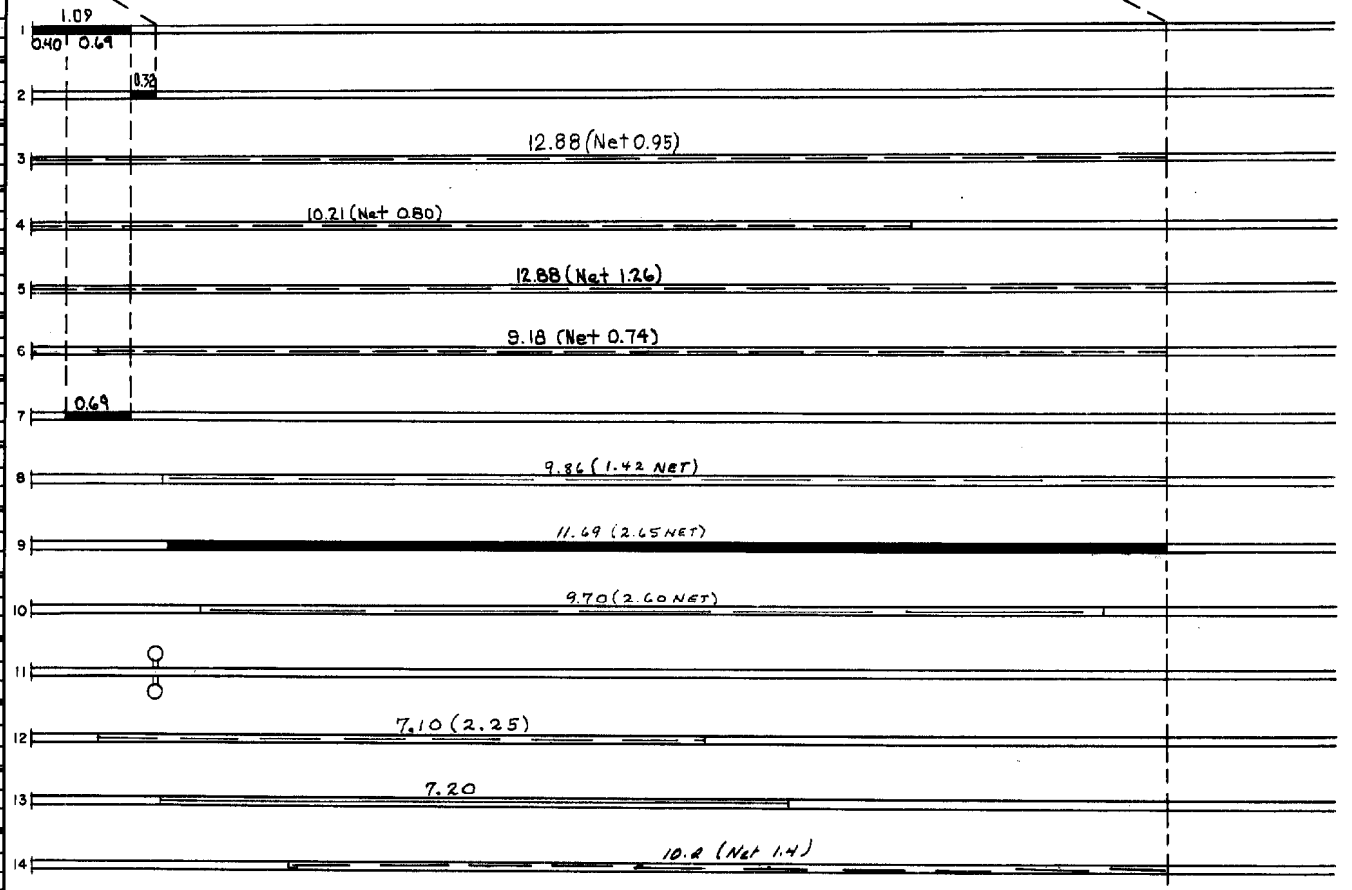

YEARS FROM	YEARS TO	TOTAL MILES	UNINCORPORATED		INCORPORATED		RURAL		URBAN		REMARKS
			RDWY. MI.	BR. MI.	RDWY. MI.	BR. MI.	RDWY. MI.	BR. MI.	RDWY. MI.	BR. MI.	
											See Sheet No. 1



STATE OF MINNESOTA  
DEPARTMENT OF TRANSPORTATION  
CONSTRUCTION PROJECT LOG RECORD

CONTROL SECTION 6607  
TRUNK HIGHWAY 60  
COUNTY Rice  
DISTRICT 6B

U.S. DEPARTMENT OF TRANSPORTATION - FEDERAL HIGHWAY ADMINISTRATION

LIMITS: Jct. TH-65 in Faribault - E. Co. Line

Ref. Pt. 147+00.888 - 160+00.417

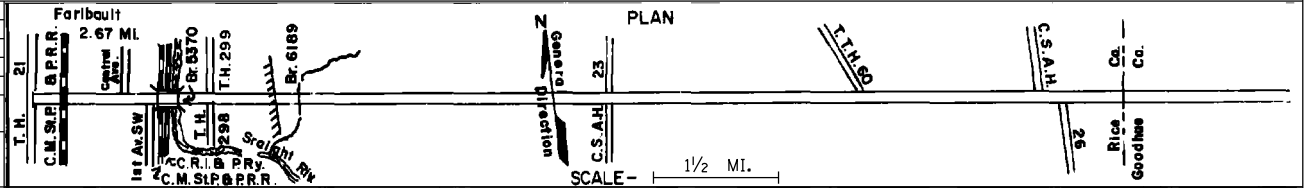

YEAR BUILT	PROJECT No	DESCRIPTION			
		TYPE	WIDTH	THICKNESS	REMARKS
S	2006 6607-45	Milling Bit. Overlay	Var.	Var.	Spec. 2360
S	2008 6607-46	Crack Seal			Type 3723
S	2009 6607-42	Grading Bit. Surfacing	var.	6"	Spec. 2360
S	2013 6607-48	Grading Agg. Base Bit. Surfacing	30' 30' 26'	6" 6" 6"	Spec. 2360



YEARS		TOTAL MILES	UNINCORPORATED		INCORPORATED		RURAL		URBAN		REMARKS:
FROM	TO		RDWY. MI.	BR. MI.	RDWY. MI.	BR. MI.	RDWY. MI.	BR. MI.	RDWY. MI.	BR. MI.	

REMARKS: