

PREPARED BY
HIGHWAY PLANNING SURVEY
IN COOPERATION WITH
U. S. PUBLIC ROADS ADMINISTRATION

STATE OF MINNESOTA
DEPARTMENT OF HIGHWAYS
ROAD LIFE STUDIES
CONSTRUCTION PROJECT LOG RECORD

CONTROL SECTION 6403
TRUNK HIGHWAY 19
COUNTY Redwood
DISTRICT 8B

LIMITS: N. Co. Line (Jct. T.H. 67) - Jct. T.H. 71 in Redwood Falls

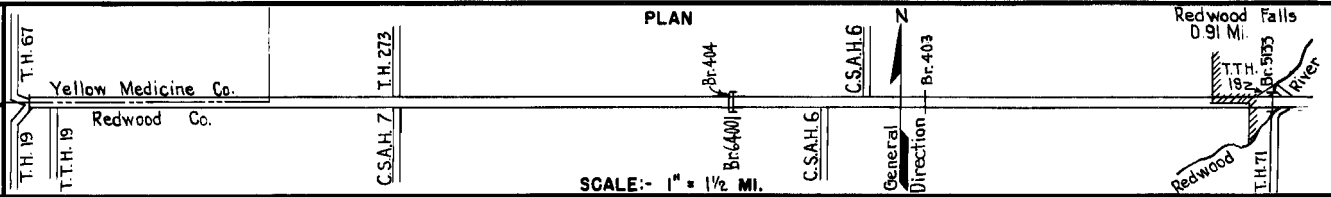

YEAR BUILT	PROJECT N ^o	DESCRIPTION			CODE N ^o
		TYPE	WIDTH	THICKNESS	
		Gravel	20'	2"	No Record of Constr.
1921	19-14-9	Concrete Br. 805	36'	20"	No Record of Constr. (1) Concrete Arch.
1921	19-14-10	Grading (1) Gravel	20'	2 1/2"	Co. Job 2012 1000 C.Y./Mile.
1930	19-14-25-1	Br. 404 & 403 Grading Gravel	40'	1 1/8"	W106DX48, W106DX52. 800 C.Y./Mile.
1931	19-14-25-2B	Grading Gravel	40'	3/4"	800 C.Y./Mile.
1932	19-14-25-1A&B 19-14-25-2B	Concrete	20'	9-7-9	
1934	19-14-25-1C	Grading Br. 5133	V.W. 40'		226 C.D.G. & C.A.
1935	19-14-25-1C	Concrete	V.W.		
C	1953 6403-06 6403-09	Plant Mix Bit. Street Lighting	40'	3"	
C	1955 A.F.E. 820	Const. Sidewalk and Guard Rail			
C	1956 6403-10	Rdwy. Drainage			Install C.M. Culvs.
C	1960 6403-12	Br. 64-001	32'		69' P.C.S.
C	1970 6403-14	Pl. Mix Bit.	39'	1 1/2"	
C	1974 6403-18	Grading Pl. Mix Bit. Surf.	24'	3"	

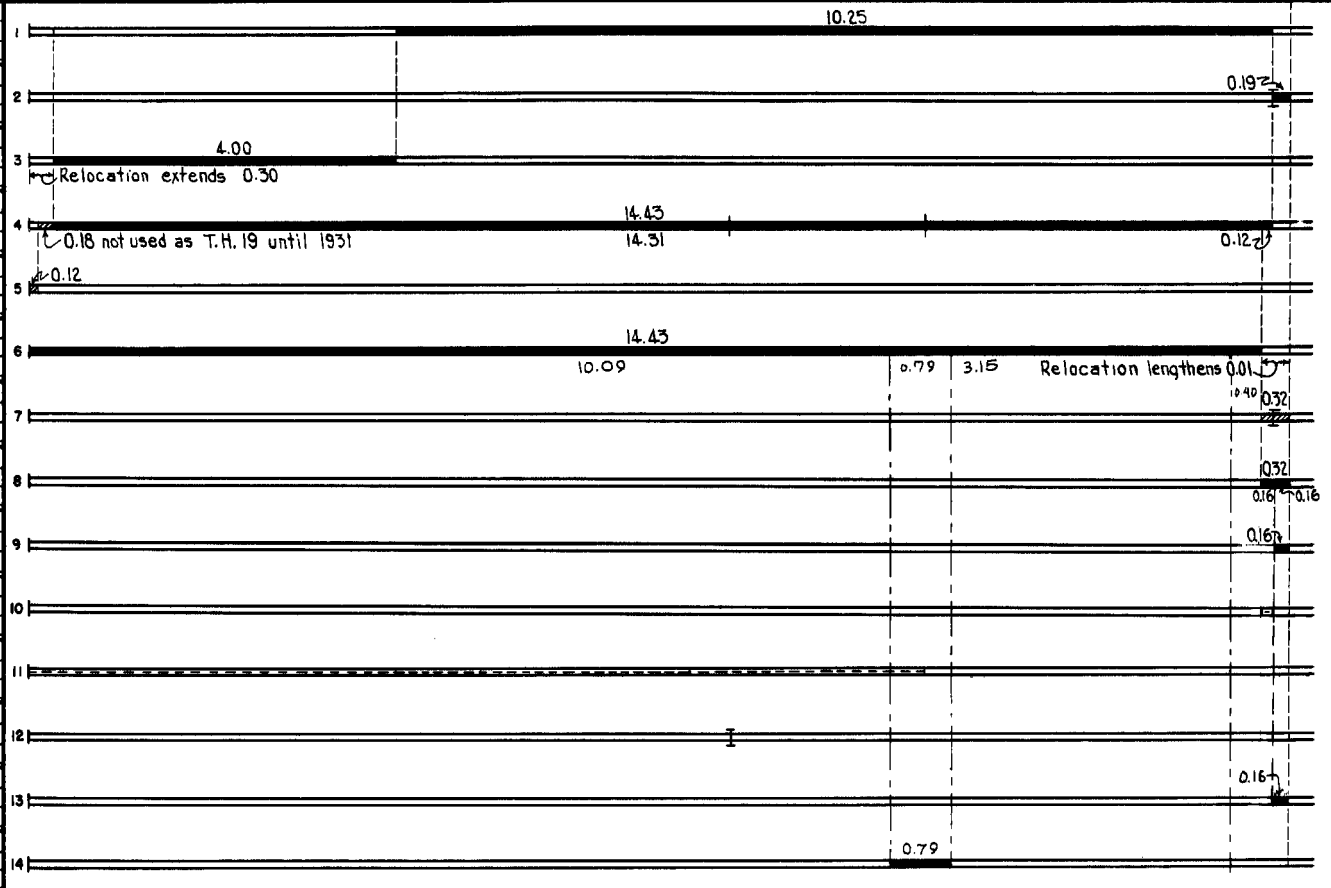

YEARS		TOTAL MILES	UNINCORPORATED		INCORPORATED		RURAL		URBAN	
FROM	TO		RDWY. MI.	BR. MI.	RDWY. MI.	BR. MI.	RDWY. MI.	BR. MI.	RDWY. MI.	BR. MI.
1921	1930	4.44	3.54	0.00	0.87	0.03	3.54	0.00	0.87	0.03
1931	1933	4.74	3.84	0.00	0.87	0.03	3.84	0.00	0.87	0.03
1934	1952	4.75	3.84	0.00	0.87	0.04	3.84	0.00	0.87	0.04
1960		4.75	3.83	0.01	0.87	0.04	3.83	0.01	0.87	0.04

REMARKS: Layout is to scale as of 1934.

(1) No Record of construction of grading.

PREPARED BY
TRANSPORTATION & TRANSIT PLANNING & PROGRAMMING DIVISION
IN COOPERATION WITH
U.S. DEPARTMENT OF TRANSPORTATION - FEDERAL HIGHWAY ADMINISTRATION

STATE OF MINNESOTA
DEPARTMENT OF HIGHWAYS
ROAD LIFE STUDIES
CONSTRUCTION PROJECT LOG RECORD

CONTROL SECTION 6403
TRUNK HIGHWAY 19
COUNTY Redwood
DISTRICT 8B

LIMITS: N. Co. Line (Jct. T.H. 67) - Jct. T.H. 71 in Redwood Falls

Ref. Pt. 057+00.360 - 072+00.087

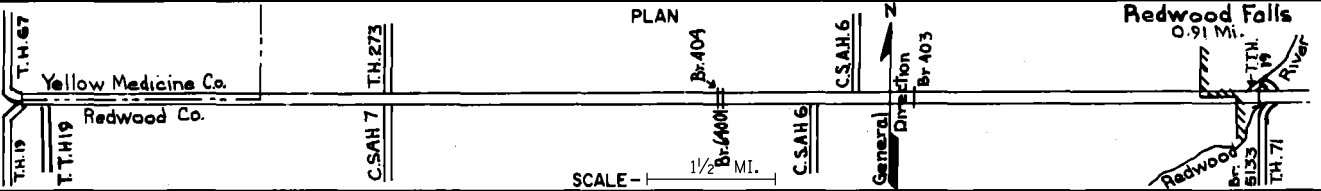

YEAR BUILT	PROJECT NO	DESCRIPTION			REMARKS
		TYPE	WIDTH	THICKNESS	
C	1973 6403-17	Lip Curb Removal Agg. Shoulders	8'		
C	1973 6403-16	Widening Asphaltic Conc. Surf. Pl. Mix Bit. Shldrs	24'	2 1/2"	
M	1973 BF	Crack & Joint Seal			44,412 Lin. Ft.
M	1973 SF	Crack & Joint Seal			16,119 Lin. Ft.
M	1974 SF	Joint & Crack Seal			97,760 Lin. Ft.
C	1980 6403- BHE014-(97)	Temp. Br. 99025			
C	1980 6403-64002 SF	Br. No. 64002			Br. Overlay
C	1981 6403-22	Reconstruct Super- structure & Appr. Br. 5133	48'	1 1/2"	
C	1983 6403-24 F.PMS 014-143	Bit. Widening Bit. Surfacing Agg. Shoulders	25' 28' 5'	2 1/2" 4" Var.	L. & Rt.
C	1986 6403-26	Grading Conc. Surfacing Bit. Overlay	44' 24'	8 1/2" 3" 1"	Spec. 2331 Spec. 2341
M	1988 4316	Bit. Sealing			
M	2000 6404-36	Concrete Joint Repair			
S	2001 6403-29	Bit. Overlay	24'	4 1/2"	Spec. 2350
S	2009 8828-110	Seal Coat Fog Seal			Spec. 2356 FA-2 Spec. 2355

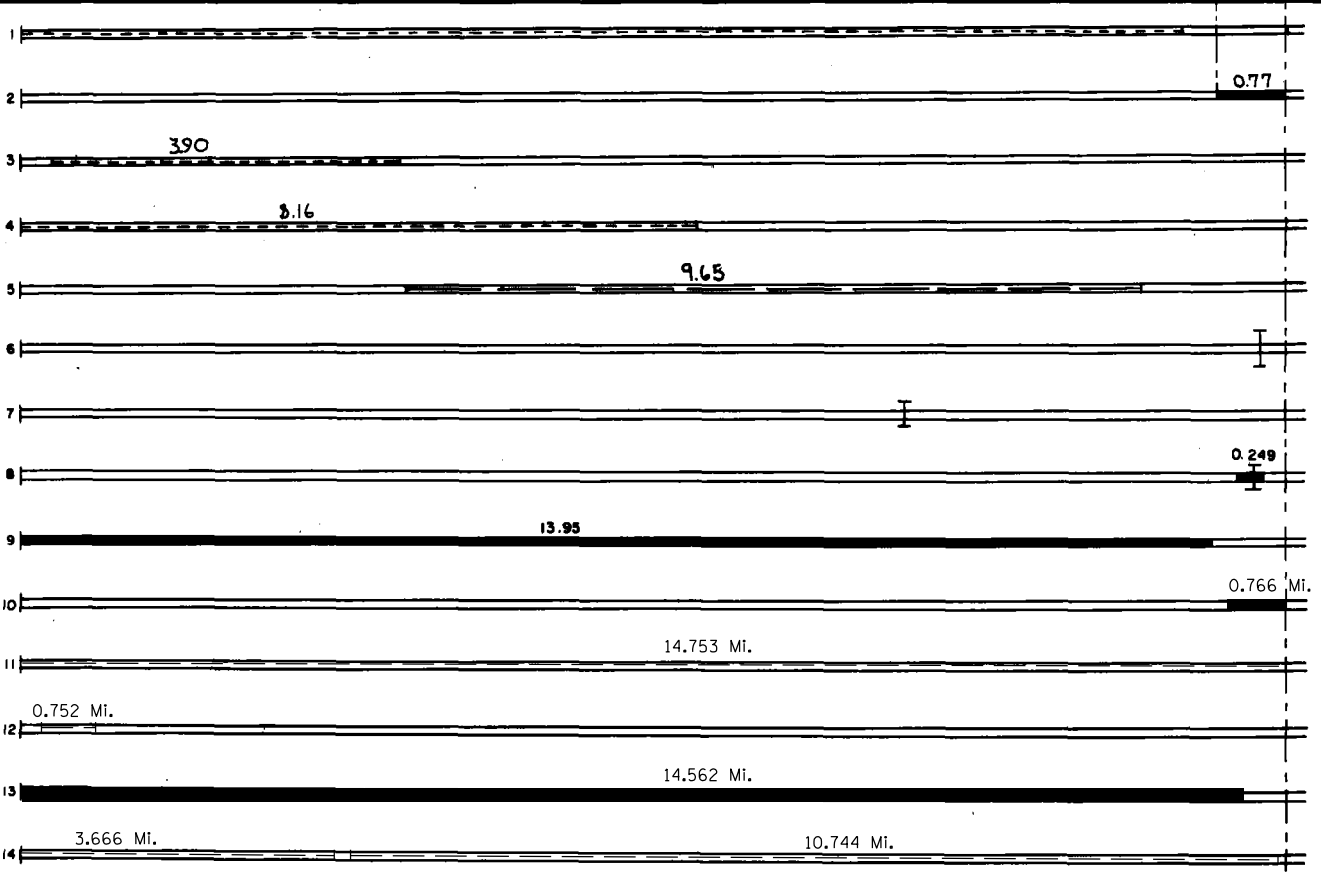

YEARS		TOTAL MILES	UNINCORPORATED		INCORPORATED		RURAL		URBAN	
FROM	TO		ROWY. MI.	BR. MI.	ROWY. MI.	BR. MI.	ROWY. MI.	BR. MI.	ROWY. MI.	BR. MI.

REMARKS: See Sheet No 1

PREPARED BY
BUREAU OF POLICY & PLANNING
IN COOPERATION WITH
U. S. DEPARTMENT OF TRANSPORTATION - FEDERAL HIGHWAY ADMINISTRATION

STATE OF MINNESOTA
DEPARTMENT OF TRANSPORTATION
CONSTRUCTION PROJECT LOG RECORD

CONTROL SECTION 6403
TRUNK HIGHWAY 19
COUNTY Redwood
DISTRICT 8B

LIMITS: Yellow Medicine/Redwood Co. Line - Jct. USTH 71

Ref. Pt. 57+00.360 - 72+00.087

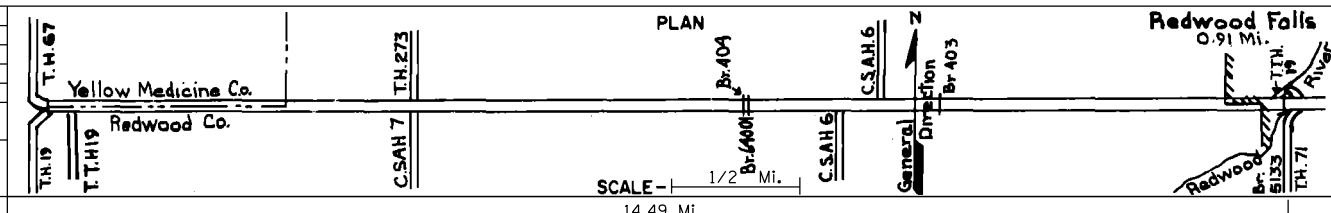

YEAR BUILT	PROJECT No	DESCRIPTION			
		TYPE	WIDTH	THICKNESS	REMARKS
S		Grading			
2016	6403-34	Bit. Mill & Overlay	28'	2.5"	Spec. 2360

1	
2	
3	
4	
5	
6	
7	
8	
9	
10	
11	
12	
13	
14	

YEARS		TOTAL MILES	UNINCORPORATED		INCORPORATED		RURAL		URBAN	
FROM	TO		RDWY. MI.	BR. MI.	RDWY. MI.	BR. MI.	RDWY. MI.	BR. MI.	RDWY. MI.	BR. MI.

REMARKS: _____

