

PREPARED BY
HIGHWAY PLANNING SURVEY
IN COOPERATION WITH
U.S. PUBLIC ROADS ADMINISTRATION

STATE OF MINNESOTA
DEPARTMENT OF HIGHWAYS
ROAD LIFE STUDIES
CONSTRUCTION PROJECT LOG RECORD

CONTROL SECTION 6106
TRUNK HIGHWAY 29
COUNTY Pope
DISTRICT 48

LIMITS: Jct. T.H. 28 in Glenwood - N. Co. Line

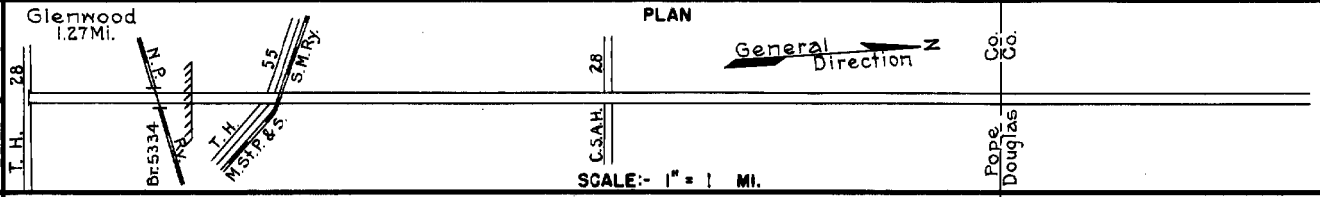

| YEAR BUILT | PROJECT N° | DESCRIPTION | | | CODE N° |
|------------|------------|-----------------------|---------|-----------|--|
| | | TYPE | WIDTH | THICKNESS | |
| | | Gravel | | | |
| | | Br. ? | 30' | | No Record of Constr. U.P. |
| 1920 | 29-29-1 | Grading | 24' | | |
| 1921 | 29-29-1 | Gravel | 20' 3" | | 1200 C.Y./Mile. |
| 1927 | | Oil Tr. Gravel | V.V. | | Maint. Dept. |
| (1) | | | | | |
| 1927 | 29-29-1 | Oil Tr. Gravel | V.V. | | Maint. Dept. |
| 1933 | 29-29-21 | Grading | 33' | | |
| | | Gravel | 26 1/2" | 12" | 5700 C.Y. Mile. |
| 1933 | 29-29-21 | Tar Tr. Gravel | 26' | 2 1/2" | |
| 1934 | 29-29-1 | Br. 5334 | 30' | | B.S.-U.P. |
| C | | | | | On old 2 1/2" mat. |
| 1942 | 6106-02 | Plant Mix Bit. | 24' | 1" | |
| | | Stab. Grav. Should. | 6 1/2' | 10" | 4' Rt. & Lt. |
| M | | | | | Asp. 5875 Gal./Mi. Grav. 251 C.Y./Mi. Maint. Dept. |
| 1942 | A.F.E. 4 | Bit. Retreat | | | |
| M | | | | | Oil, 6650 Gal./Mi. Grav. 283 C.Y./Mi. Maint. Div. |
| 1944 | A.F.E. 4 | Bit. Surf. Repair | | | |
| M | | | | | Bit. 3276 Gal./Mi. Grav. 89 C.Y./Mi. Maint. Div. |
| 1945 | A.F.E. 5 | Bit. Seal Coat | 24' | | |
| M | | | | | RC2, 8756 Gal. Agg. 408 C.Y. |
| 1951 | A.F.E. 4 | Bit. Seal (Sand Coat) | 24' | | |
| C&M | | | | | MC-12, 3700 Gal. Agg. 218 C.Y. |
| 1952 | A.F.E. 28 | Grade X-ing Signals | | | |
| | | Repair Base | | | |
| | | Restore Bit. Surf. | 24' | | |

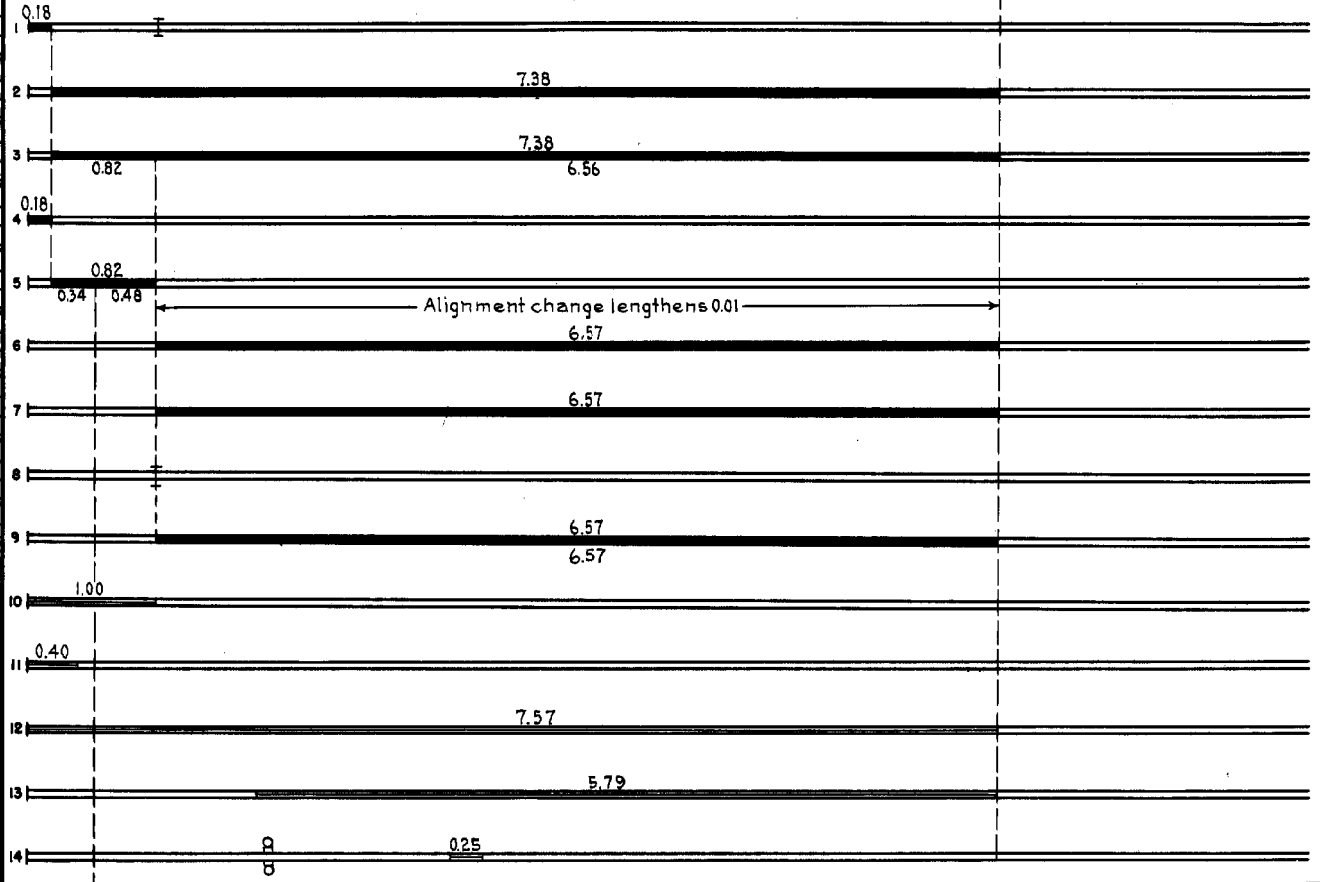

| YEARS FROM | TO | TOTAL MILES | UNINCORPORATED | | INCORPORATED | | RURAL | | URBAN | |
|------------|------|-------------|----------------|---------|--------------|---------|-----------|---------|-----------|---------|
| | | | RDWY. MI. | BR. MI. | RDWY. MI. | BR. MI. | RDWY. MI. | BR. MI. | RDWY. MI. | BR. MI. |
| 1921 | 1932 | 7.56 | 6.29 | 0.00 | 1.27 | 0.00 | 6.29 | 0.00 | 1.27 | 0.00 |
| 1933 | | 7.57 | 6.30 | 0.00 | 1.27 | 0.00 | 6.30 | 0.00 | 1.27 | 0.00 |

REMARKS: Layout to scale as of 1933

(1) This work not done under these project numbers but lies within the limits of these projects.

PREPARED BY
HIGHWAY PLANNING SURVEY
IN COOPERATION WITH
U.S. PUBLIC ROADS ADMINISTRATION

STATE OF MINNESOTA
DEPARTMENT OF HIGHWAYS
ROAD LIFE STUDIES
CONSTRUCTION PROJECT LOG RECORD

CONTROL SECTION 6106
TRUNK HIGHWAY 29
COUNTY Pope
DISTRICT 4B

LIMITS: Jct. T.H. 28 in Glenwood - N. Co. Line
Ref. Pt. 063+00.431 - 071+00.007

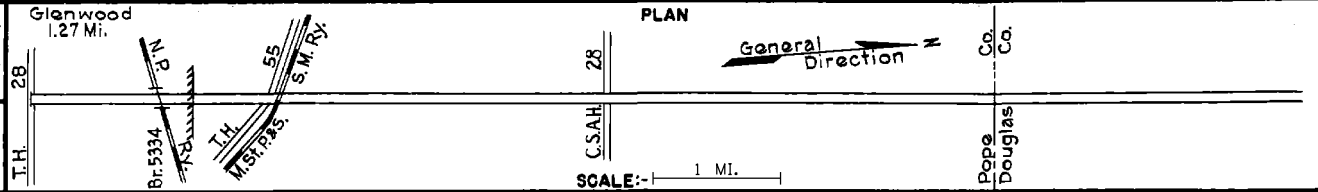

| YEAR BUILT | PROJECT N° | DESCRIPTION | | | CODE N° |
|------------|------------|---------------------------|-------|-----------|--------------------------|
| | | TYPE | WIDTH | THICKNESS | |
| M | A.F.E. 604 | Spot Treat. | | | MC2&S63, 14380 Gal. |
| 1953 | A.F.E. 818 | Bit. Surf. Repair | 24' | | Agg. 631 C.Y. |
| | | Spot Grav. Lifts | | | Spot Subgr. Corr. |
| M | A.F.E. 604 | Spot Treat. | | | MC2, 10239 Gal. |
| 1954 | A.F.E. 604 | Bit. Surf. Repair | 24' | | Agg. 701 Tons |
| C | 6106-07 | Gravel Subbase | 48' | 0'-6" | |
| 1954 | | Bit. Stab. Gravel | 48' | 6" | |
| | | Plant Mix Bit. | 48' | 2" | |
| M | A.F.E. 604 | Spot Treat. | | | MC2, 9700 Gal. |
| 1955 | A.F.E. 604 | Bit. Surf. Repair | 24' | | Agg. 654 Tons |
| M | A.F.E. 604 | Spot Treat. | | | MC2, 7120 Gal. |
| 1956 | A.F.E. 604 | Bit. Surf. Repair | 24' | | Agg. 482 Tons |
| M | A.F.E. 604 | Spot Treat. | | | MC2&RC-2, 17505 Gal. |
| 1957 | A.F.E. 604 | Bit. Surf. Repair | 24' | | Agg. 378 Tons & 416 C.Y. |
| | A.F.E. 605 | Light Bit. Seal (705 Mi.) | 24' | | |
| M | C | Light Bit. Seal | 25' | | CRS-1, 2346 Gal. |
| 1966 | | | | | Agg. 76 C.Y. |
| C | 6106-13 | Grade Base | | | |
| 1969 | | Pl. Mix. Bit. Surf. | 24' | 3/4" | |
| | | Pl. Mix. Bit. Shldrs. | 36' | | |
| C | 6106-15 | Bit. Resurfacing | 44' | 1 1/2" | |
| 1981 | | | 47' | | |
| M | 6106-16 | Restoring Br. Site | 24' | 1 1/2" | 10' Shoulder Lt. |
| 1983 | | | | | 12' Shoulder Rt. |
| C | 6106-18 | Bit. Overlay | 24' | 3" | Spec. 2331, 2341 |
| 1986 | | Bit. Shoulder Ing | | | |
| C | 6106-20 | Milling | 44' | 3" | |
| 1996 | | Bit. Overlay | Var. | 3" | Spec. 2341 |
| M | 8824-06 | Major Crack Repair | | | |
| 1998 | | | | | |
| S | 8824-25 | Bituminous Seal | | | F2 |
| 2001 | | | | | |

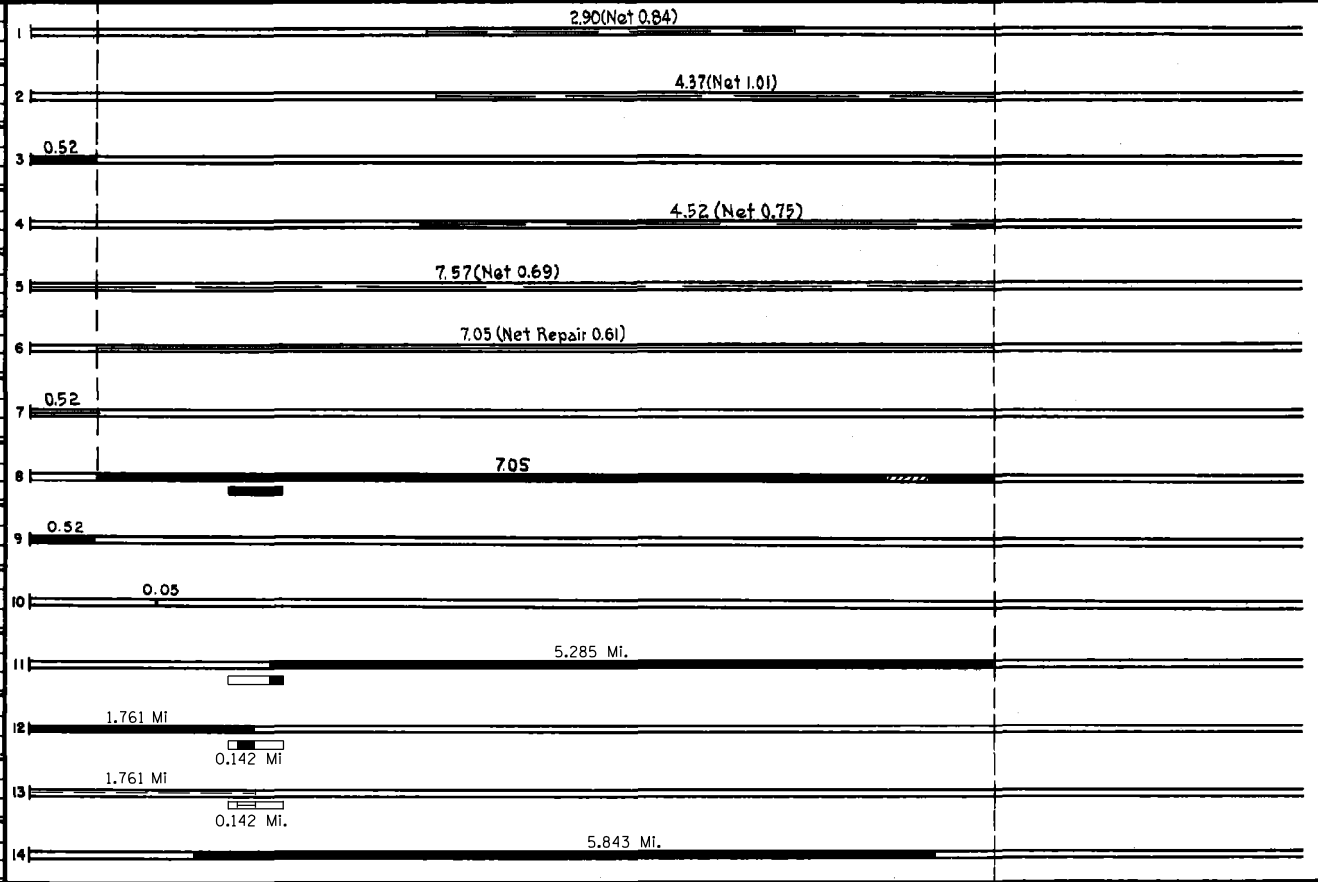

| YEARS FROM TO | | TOTAL MILES | UNINCORPORATED RDWY. MI. BR. MI. | | INCORPORATED RDWY. MI. BR. MI. | | RURAL RDWY. MI. BR. MI. | | URBAN RDWY. MI. BR. MI. | |
|---------------|--|-------------|----------------------------------|--|--------------------------------|--|-------------------------|--|-------------------------|--|
| | | | | | | | | | | |

REMARKS: See Sheet No. 1

