

PREPARED BY
HIGHWAY PLANNING SURVEY
IN COOPERATION WITH
U.S. PUBLIC ROADS ADMINISTRATION

STATE OF MINNESOTA
DEPARTMENT OF HIGHWAYS
ROAD LIFE STUDIES
CONSTRUCTION PROJECT LOG RECORD

CONTROL SECTION 6103
TRUNK HIGHWAY 28
COUNTY Pope
DISTRICT 46

LIMITS W/ct. T.H. 29 in Starbuck - Jct. T.H. 55 in Glenwood

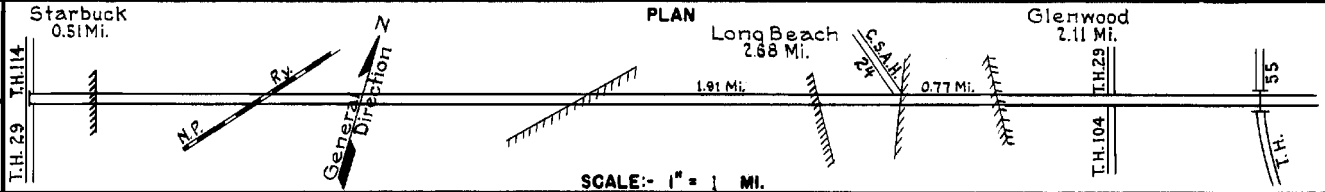

YEAR BUILT	PROJECT N ^o	DESCRIPTION			CODE N ^o
		TYPE	WIDTH	THICKNESS	
		Earth	22'		No Record of Constr.
		Gravel	22'	2"	No Record of Constr.
1924	28-28-25A&B	Grading	30'		
1925	28-28-25A	Gravel	20'	3 1/2"	1300 C.Y./Mile.
	(1)				
1925	28-28-25B	Gravel	20'	1/2"	200 C.Y./Mile. Maint. Dept.
	(1)				
1926	28-28-25A	Oil Tr. Gravel	60'	1 1/2"	17710 Gal./Mile. Maint. Dept.
	(1)				
1926	28-28-25A&B	Oil Tr. Gravel	22'	1 1/2"	17710 Gal./Mile Maint. Dept.
	(1)				
1927	28-28-25B	Oil Tr. Gravel	V.W.		Maint. Dept.
		Stab. Base		12"	
1939	A.F.E. 29 & 30	Mixed Bitum.	50'	1"	Maint. Dept.
M					MG3 Asp. 20213 Gal./Mi. Grav. 750 C.Y./Mi. Maint. Dept.
1940	A.F.E. 52	Bit. Retreat.			
M		Spot Treat.			MG4. 1614 Gal./Mi. Grav. 107 C.Y./Mi. Maint. Dept.
1941	A.F.E. 38	Bit. Surf. Repair			
M		Spot Treat.			Asp. 563b. 2691 Gal./Mi. Grav. 155 C.Y./Mi. Maint. Dept.
1942	A.F.E. 4	Bit. Surf. Repair			
M		Spot Treat.			MC2. 1901 Gal./Mi. Grav. 60 C.Y./Mi. Maint. Dept.
1943	A.F.E. 4	Bit. Surf. Repair			
M		Spot Treat.			Bit. 4236 Gal./Mi. Grav. 150 C.Y./Mi. Maint. Div.
1944	A.F.E. 4	Bit. Surf. Repair	24'		

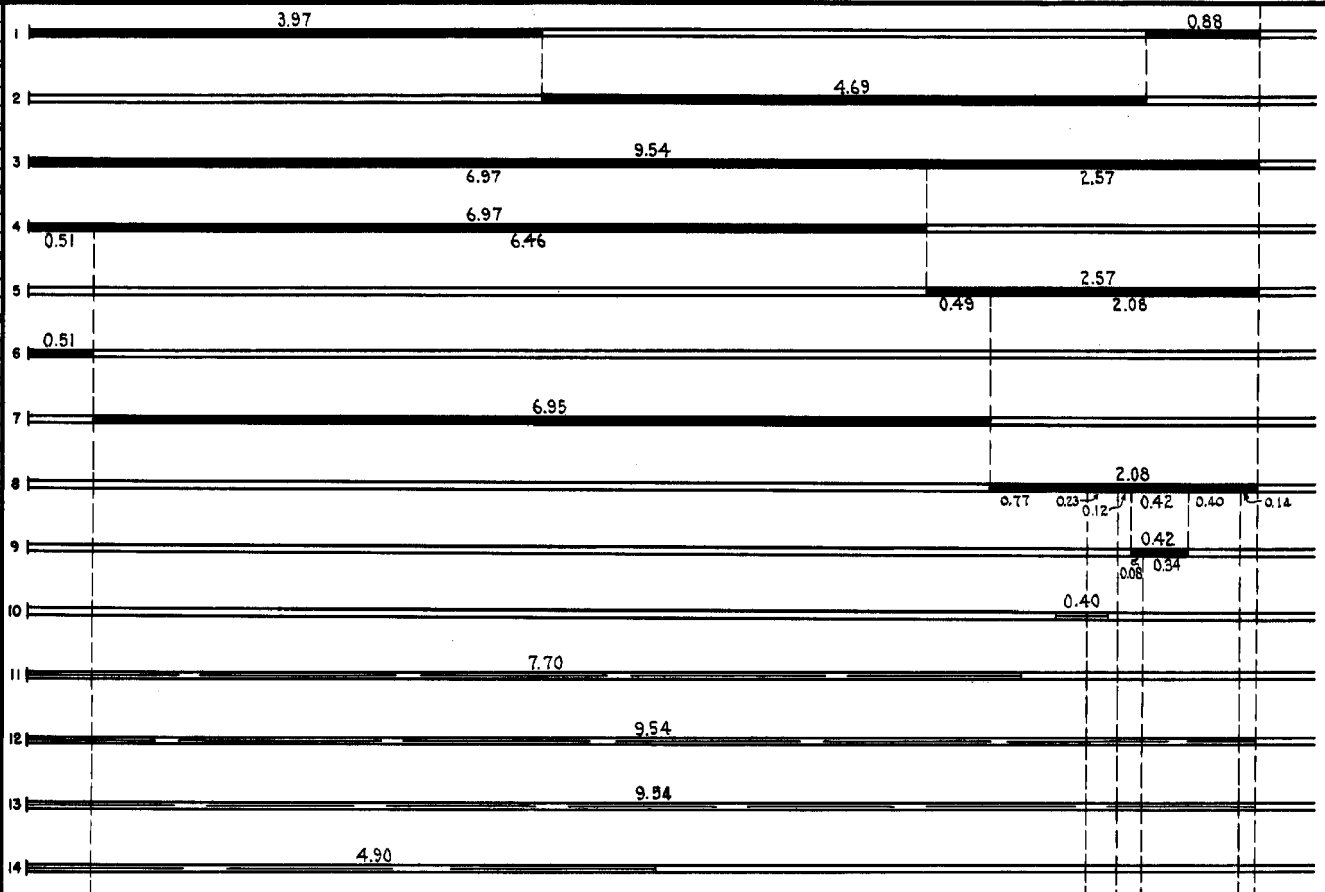

YEARS		TOTAL MILES	UNINCORPORATED		INCORPORATED		RURAL		URBAN	
FROM	TO		RDWY. MI.	BR. MI.	RDWY. MI.	BR. MI.	RDWY. MI.	BR. MI.	RDWY. MI.	BR. MI.
1921	1948	9.54	3.73	0.00	5.81	0.00	7.46	0.00	2.08	0.00
1950	1950	9.60	4.30	0.00	5.30	0.00	7.49	0.00	2.11	0.00
1951		9.60	4.30	0.00	5.30	0.00	6.98	0.00	2.62	0.00

REMARKS: Layout is to scale as of 1921
(1) This work not done under these project numbers but lies within the limits of these projects.

PREPARED BY
HIGHWAY PLANNING SURVEY
IN COOPERATION WITH
U.S. PUBLIC ROADS ADMINISTRATION

STATE OF MINNESOTA
DEPARTMENT OF HIGHWAYS
ROAD LIFE STUDIES
CONSTRUCTION PROJECT LOG RECORD

CONTROL SECTION 6103
TRUNK HIGHWAY 28
COUNTY Pope
DISTRICT 4B

LIMITS: W. Jct. T.H. 29 in Starbuck - Jct. T.H. 55 in Glenwood

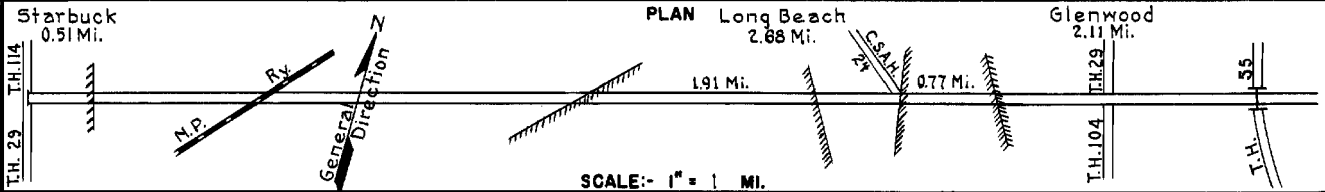

YEAR BUILT	PROJECT N°	DESCRIPTION			CODE N°
		TYPE	WIDTH	THICKNESS	
M 1945	A.F.E. 4	Spot Treat. Bit. Surf. Repair	24'		
M 1945	A.F.E. 5	Bit. Fog Seal	24'		
M 1946	A.F.E. 4	Spot Treat. Bit. Surf. Repair	24'		
M 1947	A.F.E. 4	Spot Treat. Bit. Surf. Repair	24'		
M 1948	A.F.E. 4	Spot Treat. Bit. Surf. Repair	24'		
C 1948	A.F.E. 33	Gravel Base Bit. Surfacing Mixed Bit.	65' 10" 65' 2"		
M 1949	A.F.E. 4	Spot Treat. Bit. Surf. Repair	24'		
M 1950	A.F.E. 4	Spot Treat. Bit. Surface Repair	24'		
C 1950	6103-02	Grading Stab. Gravel Ext. W46 Culvert	14'-6" 14'-6" 24'-4"		
C 1950	A.F.E. 26	Bit. Surfacing Mixed Bit.	24' 1"		
C 1950	6103-04	Plant Mixed Bit.	24' 1 1/2"		
C 1951	A.F.E. 22	Const. Off-Take Ditch			
C 1952	6103-05	Gravel Base Mixed Bit.	30'-6" 26'-6"	3'-15" 1"	
C 1954	6103-10	Grav. Sub-base Bit. Stab. Base Plant Mix. Bit.	74' 74' 74'	6'-30" 6" 2"	

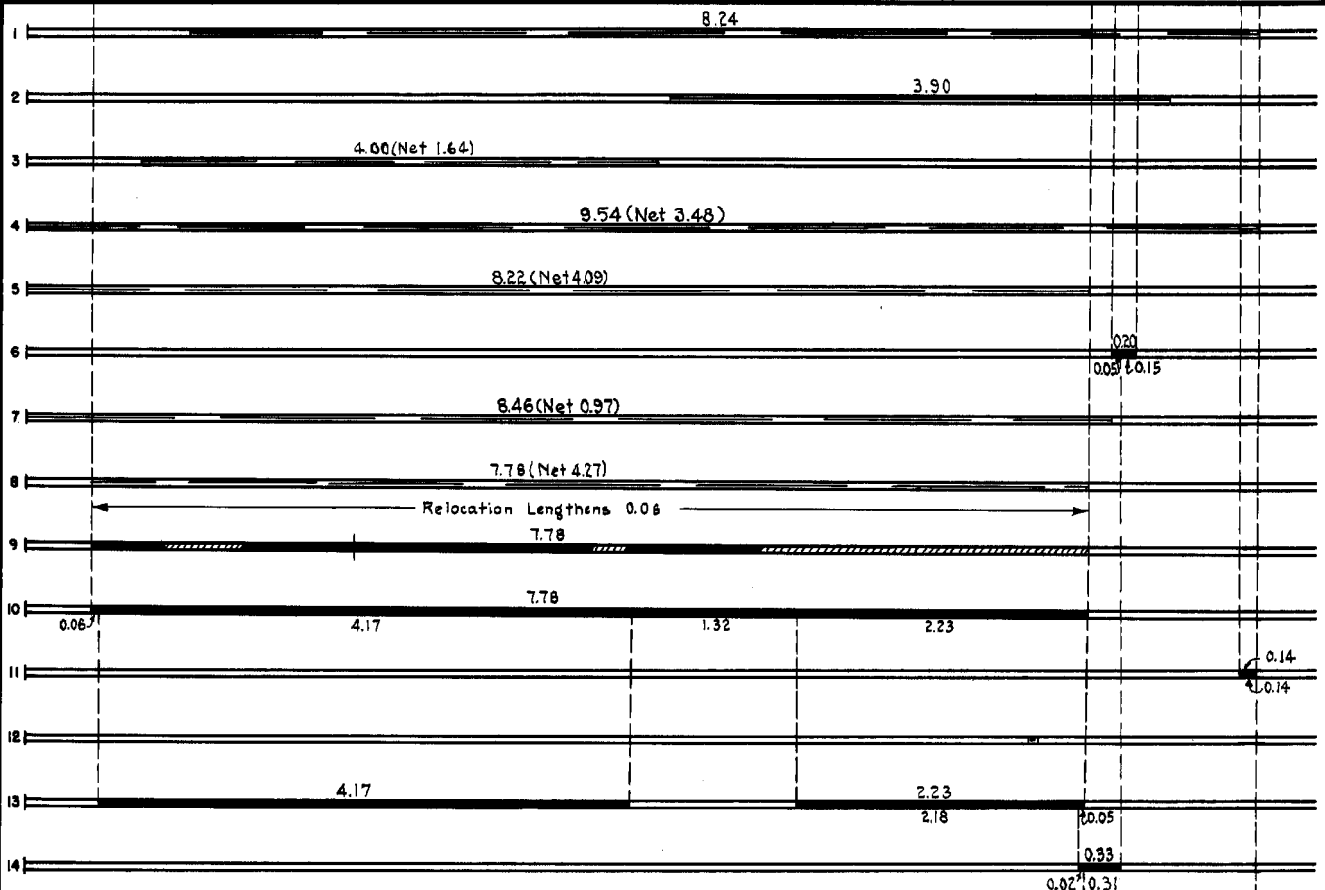

YEARS FROM	TOTAL MILES TO	UNINCORPORATED		INCORPORATED		RURAL		URBAN	
		RDWY. MI.	BR. MI.	RDWY. MI.	BR. MI.	RDWY. MI.	BR. MI.	RDWY. MI.	BR. MI.

REMARKS: See Sheet N° 1

