

PREPARED BY
HIGHWAY PLANNING SURVEY
IN COOPERATION WITH
U.S. PUBLIC ROADS ADMINISTRATION

STATE OF MINNESOTA
DEPARTMENT OF HIGHWAYS
ROAD LIFE STUDIES
CONSTRUCTION PROJECT LOG RECORD

CONTROL SECTION 5622
TRUNK HIGHWAY 106
COUNTY Otter Tail
DISTRICT 4A

LIMITS: Jct. T.H. 29 in Deer Creek - Jct. T.H. 10

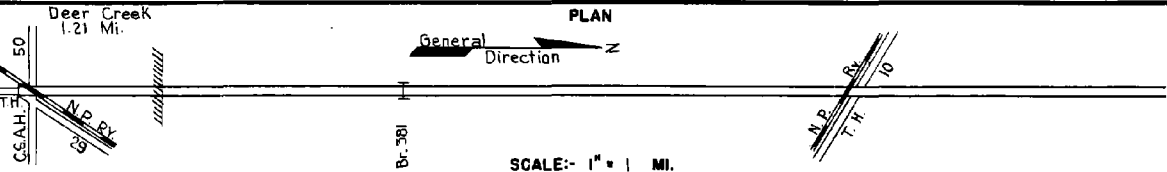

| YEAR BUILT | PROJECT N ^o | DESCRIPTION | | | CODE N ^o |
|------------|------------------------|-------------------|-------|-----------|-----------------------|
| | | TYPE | WIDTH | THICKNESS | |
| | | Oil Tr. Gravel | 22' | 1" | No Record of Constr. |
| | | | | | Added in 1934. |
| | | Gravel | 24' | 4" | No Record of Constr. |
| | | Br. 381 | 20' | | Added in 1934. |
| | | Grading | 30' | | 70' W.P.T. |
| 1938 | A.F.E. 19 | Gravel (Pit Run) | 30' | 1" | |
| | | | | | Maint. Dept. |
| 1939 | | Br. 381 | 24' | | |
| | | | | | Br. Widening. |
| | | | | | 68' W.P.T. |
| | | | | | Maint. Dept. |
| C | | Grading | 3448 | | 0.91 mi. Divided |
| 1942 | 5622-03 | Stab. Gravel | | | 1355 C.Y./Mile. |
| C | | | | | Seed supplied by |
| 1942 | A.F.E. 7 | Seeding | | | R.S.R. (S.F. 5622-04) |
| | | | | | Maint. Dept. |
| C | | Bit Surfacing | | | MC2, 111244 Gal. |
| 1948 | A.F.E. 26 | Mixed Bit. | 24' | 1 1/2" | Agg. 6412 Tons |
| M | | | | | MC2, 1578 Gal. |
| 1951 | A.F.E. 4 | Light Bit. Seal | 24' | | Agg. 56 C.Y. |
| C | | Gravel Base | 28' | 8" | SC3, 17312 Gal. |
| 1951 | A.F.E. 17 | Bit. Surfacing | | | Agg. 1470 Tons |
| | | Mixed Bit. | 24' | 1" | |
| M | | Spot Treat. | | | MC3, 18367 Gal. |
| 1952 | A.F.E. 4 | Bit. Surf. Repair | 24' | | Agg. 1378 Tons |
| M | | Spot Treat. | | | MC3, 35906 Gal. |
| 1954 | A.F.E. 604 | Bit. Surf. Repair | 24' | | Agg. 2632 Tons |
| M | | Spot Treat. | | | MC3, 8769 Gal. |
| 1957 | A.F.E. 604 | Bit. Surf. Repair | 24' | | Agg. 624 Tons |
| M | | Spot Treat. | | | MC3, 9682 Gal. |
| 1958 | A.F.E. 604 | Bit. Surf. Repair | 24' | | Agg. 692 Tons |
| M | | Light Bit. Seal | | | RS-10, 18388 Gal. |
| 1965 | C | | 25' | | Agg. 203 C.Y. |

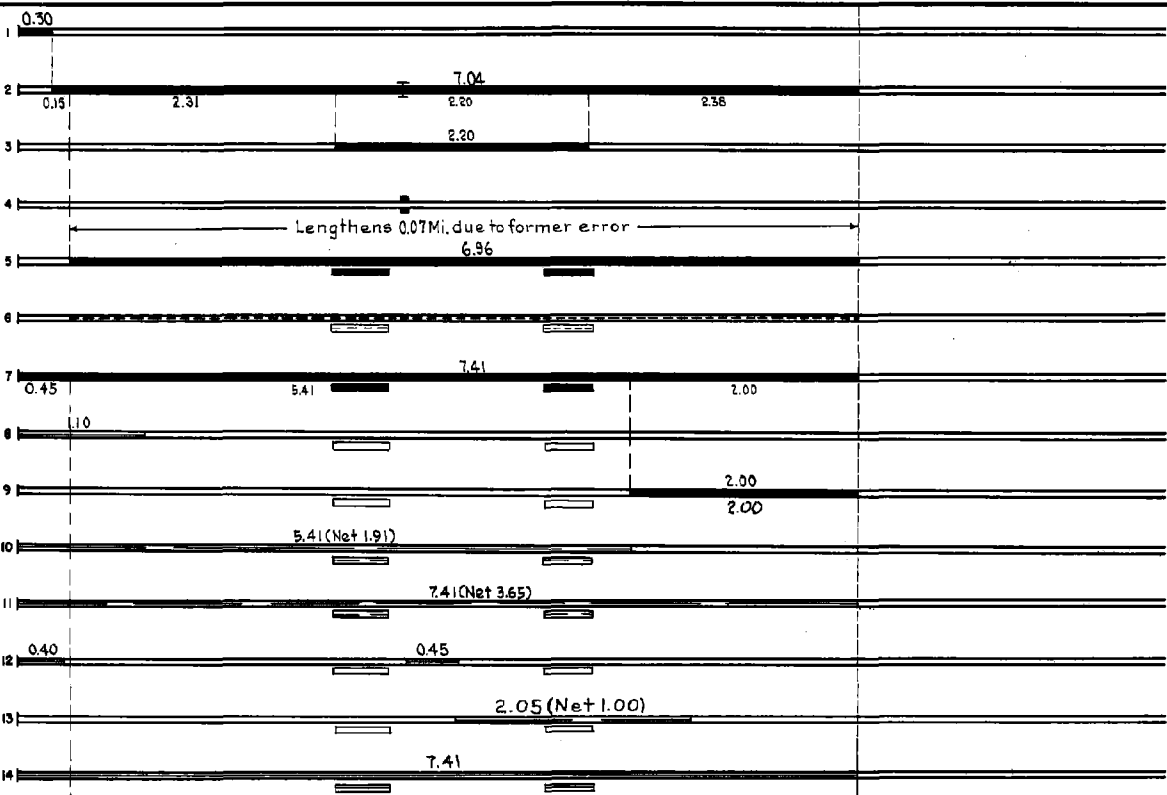

| YEARS FROM | YEARS TO | TOTAL MILES | UNINCORPORATED | | INCORPORATED | | RURAL | | URBAN | |
|------------|----------|-------------|----------------|---------|--------------|---------|-----------|---------|-----------|---------|
| | | | RDWY. MI. | BR. MI. | RDWY. MI. | BR. MI. | RDWY. MI. | BR. MI. | RDWY. MI. | BR. MI. |
| 1934 | 194 | 7.34 | 5.07 | 0.0 | 1.26 | 0.00 | 7.33 | 0.01 | 0.00 | 0.00 |
| 1942 | 1973 | 7.4 | 6.14 | 0.0 | 1.26 | 0.00 | 7.40 | 0.0 | 0.00 | 0.00 |
| 1974 | | 7.36 | 6.14 | 0.0 | 1.21 | - | 7.35 | 0.01 | - | - |

REMARKS: Layout is to scale as of 1934.

