

PREPARED BY
HIGHWAY PLANNING SURVEY
IN COOPERATION WITH
U. S. PUBLIC ROADS ADMINISTRATION

STATE OF MINNESOTA
DEPARTMENT OF HIGHWAYS
ROAD LIFE STUDIES
CONSTRUCTION PROJECT LOG RECORD

CONTROL SECTION 5621
TRUNK HIGHWAY 7B
COUNTY Otter Tail
DISTRICT 4A

LIMITS: S. Jct. T.H. 108 in Ottertail - Jct. T.H. 10

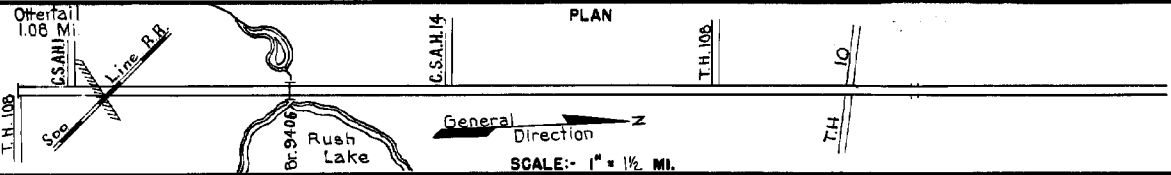

YEAR BUILT	PROJECT N ^o	DESCRIPTION			CODE N ^o
		TYPE	WIDTH	THICKNESS	
		Earth	24'		No Record of Const.
					Added in 1934.
1921		Grading Gravel Br. 3300	24'	2-3"	Co 2002. Added in 1934. 1200 C.Y./Mi. 60 L.T.
					No Record of Const.
		Tar Tr. Gravel	24'	1"	Added in 1934.
1934	78-180-21-1	Grading	30'		
1935		Oil Tr. Gravel	20'	1"	Maint. Dept.
1936	78-181-22-1	Grading	30'		
1936	(1) 78-180-21-1	Gravel	28'	1 3/4"	854 C.Y./Mile Maint. Dept.
1936	(1) 78-181-22-1	Gravel	28'	1 3/4"	854 C.Y./Mile Maint. Dept.
1937	A.F.E. 14. A.F.E. 15	Mixed Bituminous	24'	1 1/2"	Maint. Dept.
M	1940	A.F.E. 9			Bit. Seal Coat Sand 85 C.Y./Mi. Maint. Dept.
M	1941	A.F.E. 22			RG3, 3517 Gal./Mi. Agg. 119 C.Y./Mi. Maint. Dept.
C	A.F.E. 13	Spot Grav. Lifts. Bit.			SC-3b, 68145 Gal.
1946	A.F.E. 21	Resurf. & Fog Seal Mixed Bit.	21-28'	1"	Agg. 4200 C.Y.
C	1947	A.F.E. 24			Sand Lift Bit. Surfacing Bit. Surf. Treat. MC3, 4639 Gal. Agg. 200 C.Y. (Mixed Prime)
M	1949	A.F.E. 4			Spot Treat. Bit. Surf. Repair MC3, 7119 Gal. Agg. 589 Tons

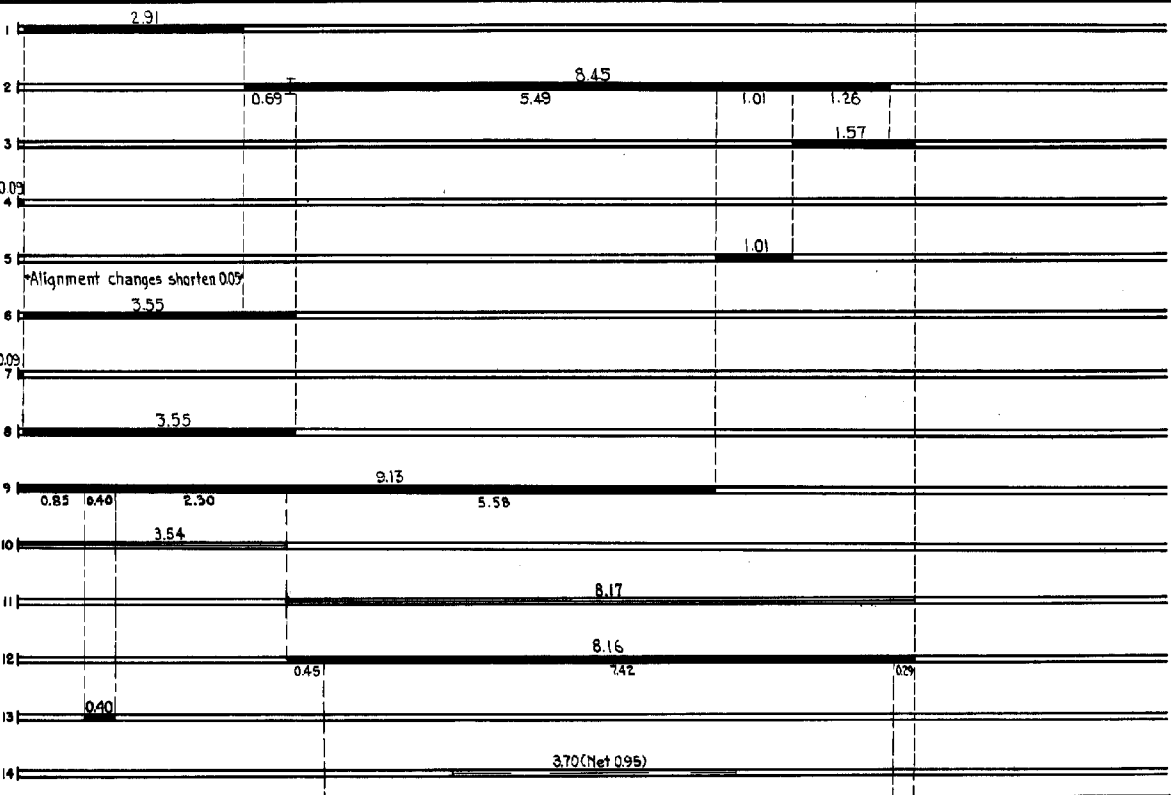

YEARS FROM	TO	TOTAL MILES	UNINCORPORATED		INCORPORATED		RURAL		URBAN	
			RDWY. MI.	BR. MI.	RDWY. MI.	BR. MI.	RDWY. MI.	BR. MI.	RDWY. MI.	BR. MI.
1934	1935	11.76	0.07	0.0	6.5	0.00	11.18	0.01	0.57	0.00
1936	1938	11.71	0.05	0.0	6.5	0.00	11.13	0.01	0.57	0.00
1939	1942	11.71	0.02	0.03	6.6	0.00	11.10	0.03	0.58	0.00
1943		11.70	0.02	0.03	6.5	0.00	11.10	0.03	0.57	0.00

REMARKS: Layout is to scale as of 1936.

(1) This work not done under these project numbers but lies within the limits of these projects.

4-75

PREPARED BY
HIGHWAY PLANNING SURVEY
IN COOPERATION WITH
U.S. PUBLIC ROADS ADMINISTRATION

STATE OF MINNESOTA
DEPARTMENT OF HIGHWAYS
ROAD LIFE STUDIES
CONSTRUCTION PROJECT LOG RECORD

CONTROL SECTION 5621
TRUNK HIGHWAY 78
COUNTY Otter Tail
DISTRICT 4A

LIMITS: S.Jct.T.H.108 in Ottertail - Jct.T.H.10

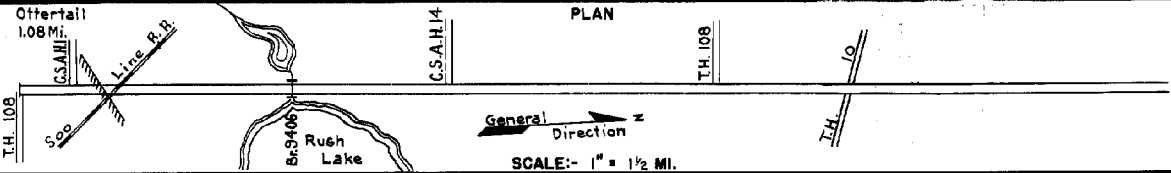

YEAR BUILT	PROJECT N ^o	DESCRIPTION			CODE N ^o
		TYPE	WIDTH	THICKNESS	
C 1949	A.F.E. 17	Bit. Resurfacing Mixed Bit.	24'	1" added	
C 1949	5621-04	Grading Plant Mix Bit.	50'	2"	
M 1951	A.F.E. 4	Light Bit. Seal	24'		RCS-1, 17068 Gal. Agg. 442 C.Y.
M 1952	A.F.E. 5	Light Bit. Seal	48'		RS-1, 977 Gal. Agg. 33 C.Y.
M 1958	A.F.E. 605	Light Bit. Seal	25'		RS-2, 4914 Gal. Agg. 198 Tons
C 1959	5621-06	Br. 9406	30'		144' C.B.S.
C 1959	5621-05	Gravel Base Road Mix Bit.	36' 2.6'	4"-8" 1 1/2"	147,800 Gal.
M 1962		Light Bit. Seal	25'		RS-2, 5220 Gal. Agg. 179 C.Y.
C 1963	5621-10	Plant Mix Bit.	24'	2"	
M 1970	SF	Seal Coat	24'-48'		RC 250 17944 Gal. Agg. 740 C.Y.
C 1970	5621-13	Plant Mix Bit. Agg. Shoulders	22'	2"-1 1/2"	3' Right & Left
M 1974	-15	Seal Coat	24' 50'		
M 1983	SF	Bit. Shoulders Bit. Overlay	6' 24'	4 1/2" 1 1/2"	388 Ton Bit. 2331 831 Ton Bit. 2331
M 1983	SF	Bit. Overlay Bit. Overlay Bit. Rt. Turn Ln.	24' 24' 12'	1" 1" 2"	Pl. Mix 2331 48 Ton Pl. Mix 2331 98 Ton Pl. Mix 2331 52 Ton
M 1984	SF	Seal Coat	24'		3200 Gal. 100 Cu Yd Sand

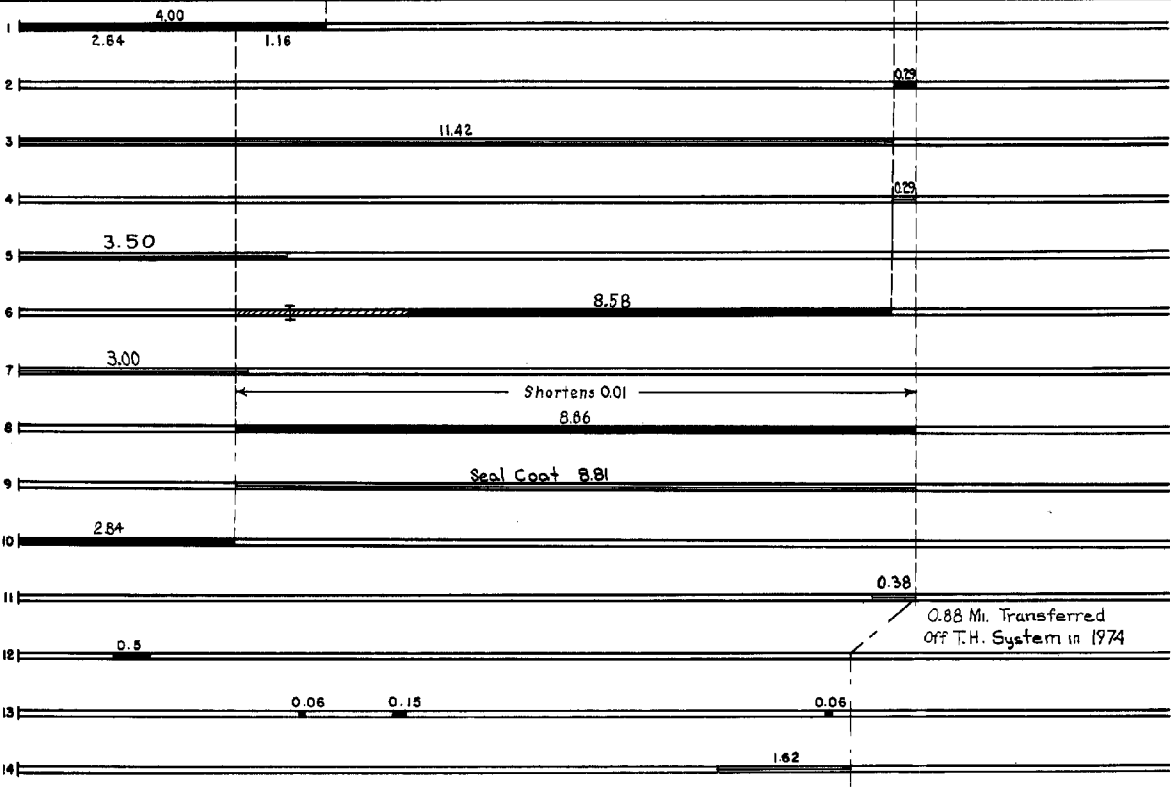

YEARS FROM	TOTAL MILES TO	UNINCORPORATED		INCORPORATED		RURAL		URBAN	
		RDWY. MI.	BR. MI.	RDWY. MI.	BR. MI.	RDWY. MI.	BR. MI.	RDWY. MI.	BR. MI.

REMARKS: See Sheet No. 1

