

PREPARED BY
HIGHWAY PLANNING SURVEY
IN COOPERATION WITH
U.S. PUBLIC ROADS ADMINISTRATION

STATE OF MINNESOTA
DEPARTMENT OF HIGHWAYS
ROAD LIFE STUDIES
CONSTRUCTION PROJECT LOG RECORD

CONTROL SECTION 5610
TRUNK HIGHWAY 29
COUNTY Otter Tail
DISTRICT 4A

LIMITS: Jct. T.H. 106 in Deer Creek - E. Co. Line.

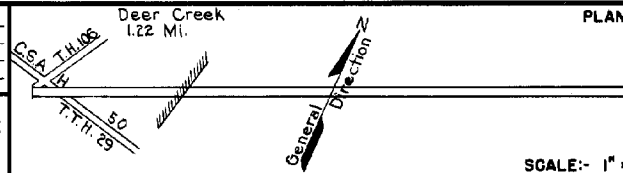

PLAN

Co. Co.

YEAR BUILT	PROJECT N ^o	DESCRIPTION			CODE N ^o
		TYPE	WIDTH	THICKNESS	
		Earth	20' 24"		
				No Record of Constr.	
1928		Gravel	20' 30"	3/4"	300 C.Y./Mile. Maint. Dept.
1933	29-29-24-2A	Grading Gravel Br. 6080	32' 30'	2"	1200 C.Y./Mile. W 106 D
	(1)				
1935	29-29-24-2A	Tar Tr. Gravel	24'	1"	21730 Gal./Mile. Maint. Dept.
M					Tar 3518 Gal./Mi. Agg. 79 C.Y./Mi. Maint. Dept.
1940	A.F.E. 16	Bit Seal Coat			
M					Subgrade Corr. & Grade Lifts in Spots
1941	A.F.E. 29				Maint. Dept.
M					RC3, 2739 Gal./Mi. Agg. 239 C.Y./Mi. Maint. Div.
1944	A.F.E. 5	Bit Seal Coat	24'		
C					(2)
1945	5610-02	Gravel Base Bit Surf. Treat. (Mixed Prime)	37' 32'	6"	MC1or2, 100 Gal./SqYd
C					MC3, 74194 Gal. Agg. 6384 Tons
1947	A.F.E. 18	Bit Surfacing Mixed Bit.	24'	1"	
M					RC3-1, 12340 Gal. Agg. 453 C.Y.
1950	A.F.E. 4	Bit. Fog Seal	24'		
M					MC3, 11516 Gal. Agg. 368 C.Y.
1953	A.F.E. 605	Bit Sand Seal (Spot)	27'		
C					Spot Base Repair
1954	5610-03	Plant Mix Bit.	24'	2" added	
C					Concrete Cattle Pass
1960					By Maint. Dist.
M					RS-2K, 15945 Gal. Agg. 558 C.Y.
1964	c	Light Bit. Seal	25'		

SCALE:- 1" = 1 MI.

Br. 6080

Otter Tail
Wadena

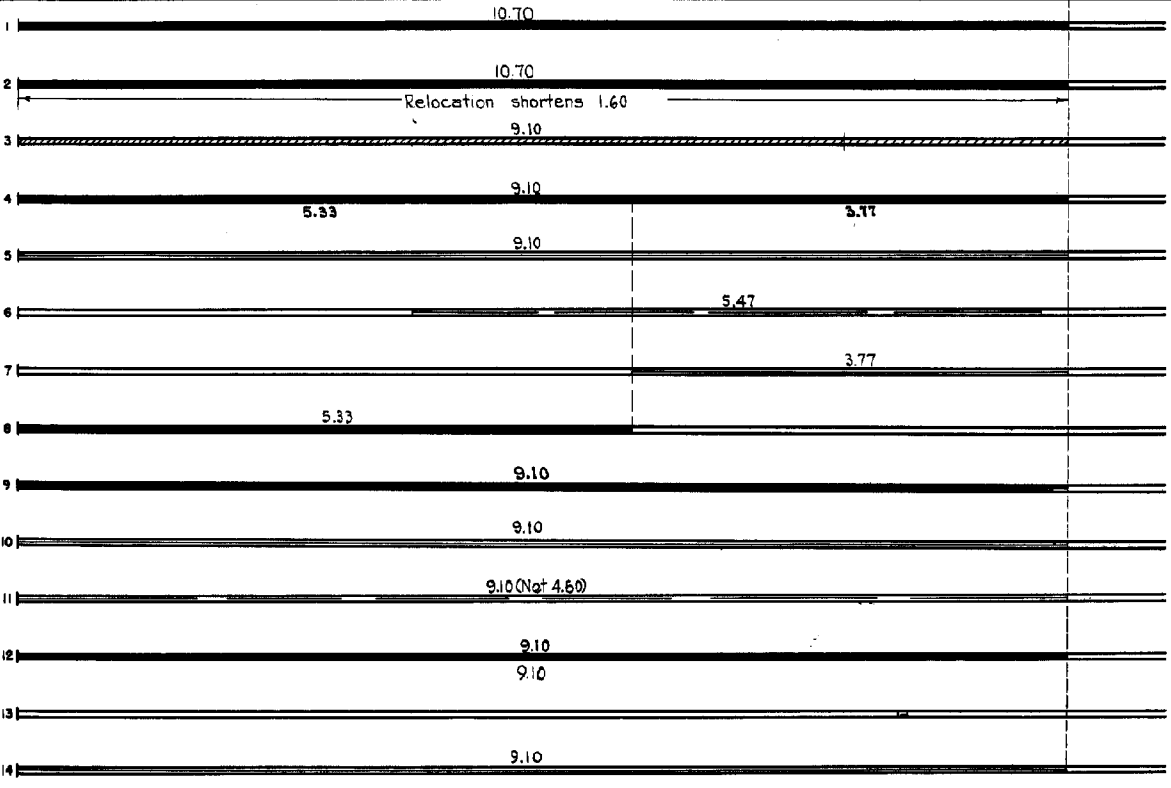

YEARS		TOTAL MILES	UNINCORPORATED		INCORPORATED		RURAL		URBAN	
FROM	TO		RDWY. MI.	BR. MI.	RDWY. MI.	BR. MI.	RDWY. MI.	BR. MI.	RDWY. MI.	BR. MI.
1921	1932	10.70	9.20	0.00	1.50	0.00	10.70	0.00	0.00	0.00
1933		9.10	7.82	0.00	1.28	0.00	9.10	0.00	0.00	0.00
1974		9.04								

REMARKS: Layout is to scale as of 1935.

(1) This work not done under this project number but lies within the limits of this project. (2) There were short exceptions on this job and the gravel base thickness varied.

PREPARED BY
 TRANSPORTATION PLANNING AND PROGRAMMING DIVISION
 IN COOPERATION WITH
 U.S. DEPARTMENT OF TRANSPORTATION - FEDERAL HIGHWAY ADMINISTRATION

STATE OF MINNESOTA
 DEPARTMENT OF HIGHWAYS
 ROAD LIFE STUDIES
 CONSTRUCTION PROJECT LOG RECORD

CONTROL SECTION 5610
 TRUNK HIGHWAY 29
 COUNTY Tail
 DISTRICT 4A

LIMITS: Jct. T.H. 106 in Deer Creek - E. Co. Line
 Ref. Pt. 116+00.654 - 125+00.681

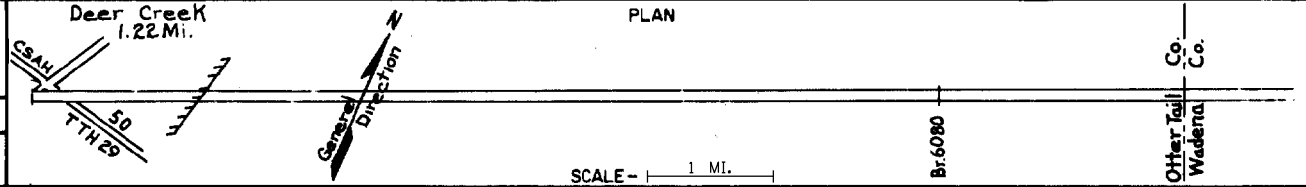

YEAR BUILT	PROJECT NO	DESCRIPTION			
		TYPE	WIDTH	THICKNESS	REMARKS
		Transferred out to C.S. 5609 in 1974			
C 1974	-07	Grading, Agg. Base Plant Mix Bit. Surf.	30' 24'	16" 3"	
M 1988	SF	Spot Overlay		1 1/2" 1 1/2"	Spec. 2331 Spec. 2341
M 1989	SF	Spot Overlay	24'	1 1/2"	Spec. 2341
C 1990	5610-10	Grading Bit. Surfacing		6 1/2" 1 1/2"	Spec. 2331 Spec. 2341
M 1991	SF	Bit. Overlay	24'	1 1/2"	Spec. 2331
C 1992	5610	Bit. Overlay	24'	2"	Spec. 2341
M 1997	5610-12	Bit. Overlay	28'	1 1/2"	Spec. 2331
S 2011	5610-13	Milling Bit. Overlay Comb. Shldr - Bit.	28' 32' 4'	3" 3" 3"	Spec 2360 Agg. C1-1, 1'-var wide
S 2017	8824-136	Rumble Strips Centerline			

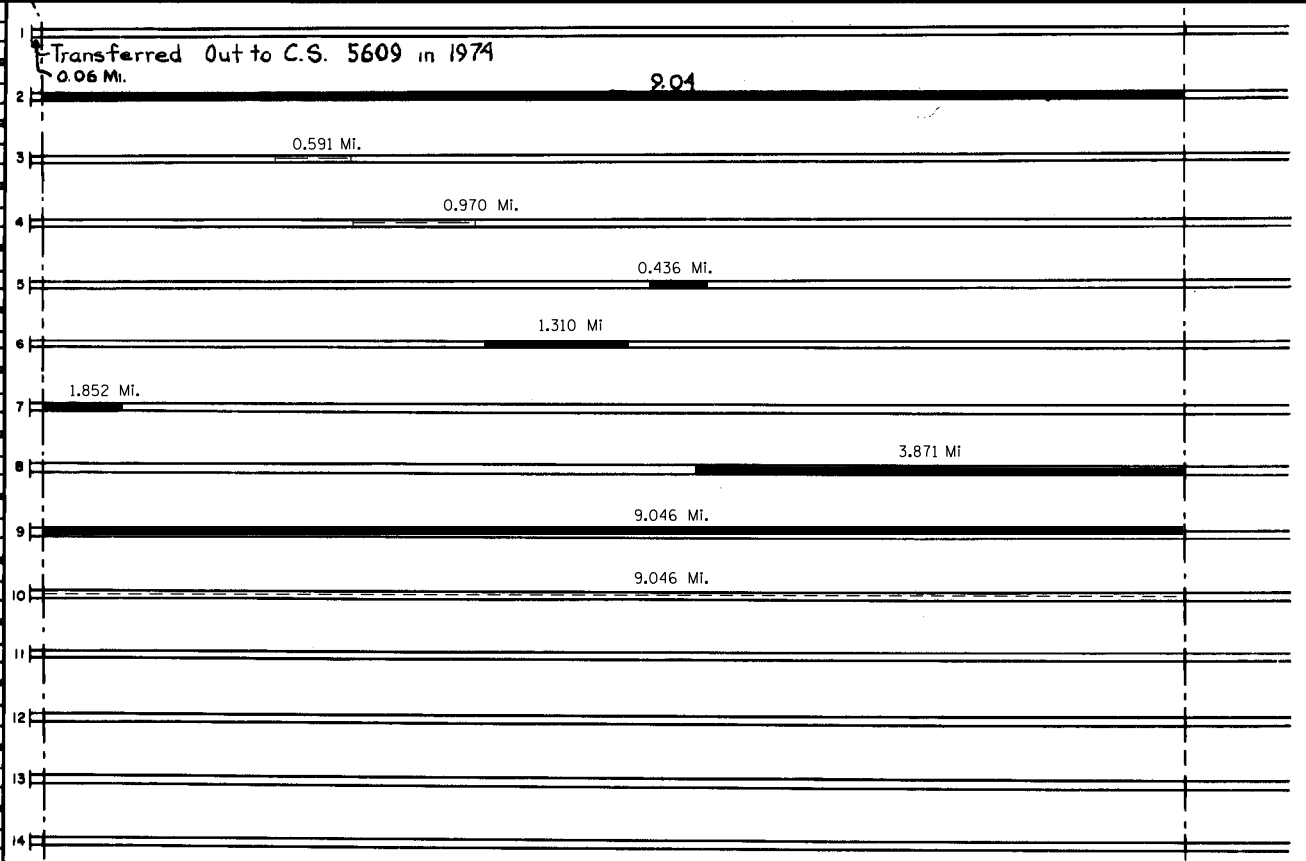

YEARS		TOTAL MILES	UNINCORPORATED		INCORPORATED		RURAL		URBAN	
FROM	TO		ROWY. MI.	BR. MI.	ROWY. MI.	BR. MI.	ROWY. MI.	BR. MI.	ROWY. MI.	BR. MI.

REMARKS: See Sheet No. 1