

PREPARED BY
HIGHWAY PLANNING SURVEY
IN COOPERATION WITH
U.S. PUBLIC ROADS ADMINISTRATION

STATE OF MINNESOTA
DEPARTMENT OF HIGHWAYS
ROAD LIFE STUDIES
CONSTRUCTION PROJECT LOG RECORD

CONTROL SECTION 5510
TRUNK HIGHWAY 63
COUNTY Olmsted
DISTRICT 6A

LIMITS: Jct. T.H. 14 at S. Corp. Limits of Rochester - N. Co. Line.

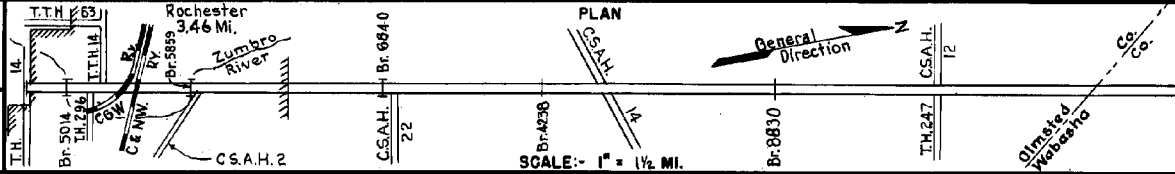

YEAR BUILT	PROJECT N°	DESCRIPTION			CODE N°
		TYPE	WIDTH	THICKNESS	
		Wood Block	70		No Record of Constr.
		Bit. Concrete Concrete Base	40		No Record of Constr.
1924	63-59-22A	Grading Br. 4238, 4238, 1511, 6205 & 6206	50 23 21		40' B.S. W108D. 12' B.S. & 2'-W105D.
1924	63-59-23	Br. 4138	20		195' L.T.
1926	63-59-22A	Gravel	24'	5 1/2"	1600 C.V./Mile.
1930	63-59-22A	Oil Tr. Gravel	22'	1 1/2"	11979 Gal./Mile. Maint. Dept.
		Block Pavement (Wood)	N/W		No Record of Constr. Transferred from T.H. 14 in 1931.(2)
1931	63-59-27-1A	Grading	40'		Not used as T.H. until 1932.
1931	63-59-27-1B	Grading Br. 5014	60' 40'		Not used as T.H. until 1932. 160' C.D.G.
1932	63-59-27-1A&B	Oil Tr. Gravel			15800 Gal./Mile. Maint. Dept.
1933	63-59-27-1A&B	Concrete	40'	9-7-9	
1935	63-59-27-1A&B	Roadside Development			
1938	63-59-28	Concrete on old Conc Base	70'	5" 6"	Spec. Agree with city for portion out side of center 20'
1938		Concrete	30'	7 1/2"	Widening by city. 15' R.L. & L.T.

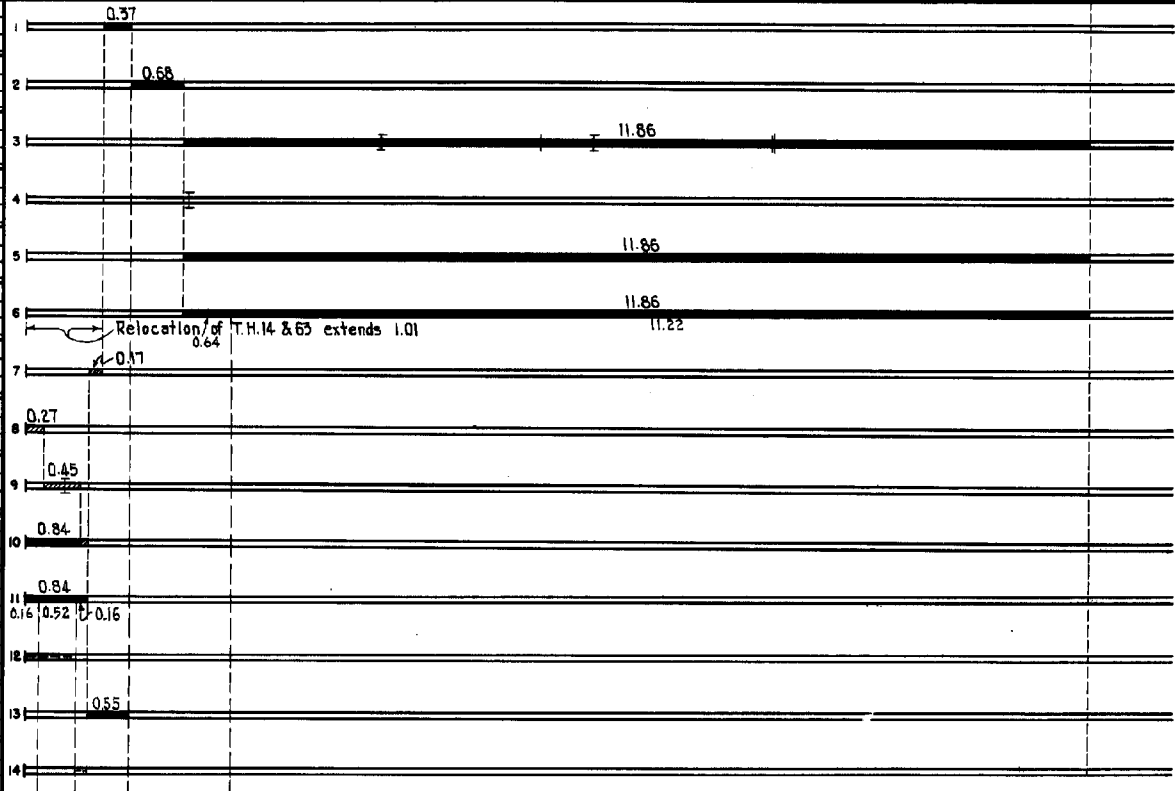

YEARS FROM	TO	TOTAL MILES	UNINCORPORATED		INCORPORATED		RURAL		URBAN	
			RDWY. MI.	BR. MI.	RDWY. MI.	BR. MI.	RDWY. MI.	BR. MI.	RDWY. MI.	BR. MI.
1924	1931	7.91	11.4	0.01	1.45	0.04	11.4	0.01	1.45	0.04
1932	1940	13.92	11.4	0.01	2.45	0.07	11.4	0.01	2.45	0.07
1941	1953	13.85	11.32	0.01	2.45	0.07	11.32	0.01	2.45	0.07
1954	1960	13.59	11.06	0.01	2.45	0.07	11.06	0.01	2.45	0.07
1961	1961	13.59	10.51	0.01	3.00	0.07	10.51	0.01	3.00	0.07
1962		13.59	10.12	0.01	3.39	0.07	10.12	0.01	3.39	0.07

REMARKS: Layout is to scale as of 1932.
 (1) This work not done under these project numbers but lies within the limits of these projects.
 (2) Not used as T.H. 63 until 1932.

PREPARED BY
HIGHWAY PLANNING SURVEY
IN COOPERATION WITH
U.S. PUBLIC ROADS ADMINISTRATION

STATE OF MINNESOTA
DEPARTMENT OF HIGHWAYS
ROAD LIFE STUDIES
CONSTRUCTION PROJECT LOG RECORD

CONTROL SECTION 5510
TRUNK HIGHWAY 63
COUNTY Olmsted
DISTRICT 6A

LIMITS: Jct. T.H. 14 at S. Corp. Limits of Rochester - N. Co. Line

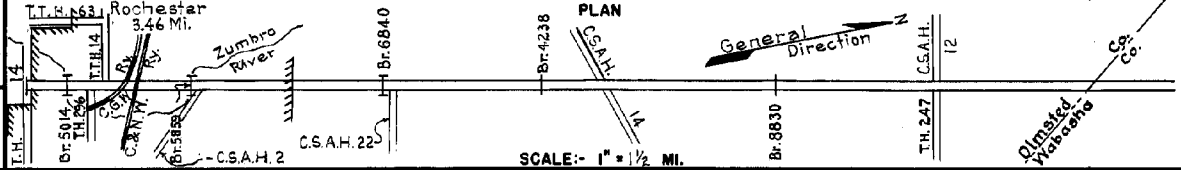

YEAR BUILT	PROJECT N ^o	DESCRIPTION			CODE N ^o	REMARKS
		TYPE	WIDTH	THICKNESS		
1939	A.F.E. 9	Shoulder Grade	8'			Widen for sidewalk.
	C					
1940	5510-06	Retaining Wall				
	M					
1940	A.F.E. 26	Bit. Retreat	24'			SG4, 6826 Gal./Mi. Grav. 338 C.Y./Mi. Maint. Dept.
	C					
1941	5510-02	Br. 5859	50'			Replaces Br. 4138 195' C.D.G.
	A.F.E. 5	Const. Br. Approach				
	M	Spot Treat.				SG4, 3520 Gal./Mi. Grav. 178 C.Y./Mi. Maint. Dept.
1941	A.F.E. 15	Bit. Surf. Repair	24'			
	C					
1941	5510-04	Concrete	60'	9.69		Relocation Shortens 0.08
	C					
1941	5510-04	Crushed Rock Base Mixed Bit.	32' 24'	3" 1"		
	C					
1941	A.F.E. 55	Seeding				Seed supplied by R.S.O.S.P. 5510-07 Maint. Dept.
	M	Spot Treat.				Oil & Tar, 216 Gal./Mi.
1942	A.F.E. 12	Bit. Surf. Repair	24'			
	C					
1942	5510-01	Roadside Develop.				W.P.A.
	C					
1942	A.F.E. 32	Roadside Develop.				Maint. Dept.
	M	Spot Treat.				MC-3 & RT-5, 2009 G./M.
1943	A.F.E. 4	Bit. Surf. Repair	24'			Grav. 247 C.Y./Mi. Maint. Dept.
	M	Spot Treat.				RT-5 & MC-3, 3599 Gal./M.
1944	A.F.E. 4	Bit. Surf. Repair	24'			Agg. 125 C.Y./Mi.
	A.F.E. 5	& Bit. Seal Coat	24'			Maint. Div.
	M	Spot Treat.				MC-3, 1910 Gal./Mi.
1945	A.F.E. 4	Bit. Surf. Repair				Grav. 106 C.Y./Mi. Maint. Div.

YEARS FROM TO		TOTAL MILES	UNINCORPORATED		INCORPORATED		RURAL		URBAN	
RDWY. MI.	BR. MI.		RDWY. MI.	BR. MI.	RDWY. MI.	BR. MI.	RDWY. MI.	BR. MI.	RDWY. MI.	BR. MI.

REMARKS: See Sheet N^o 1

