

PREPARED BY
HIGHWAY PLANNING SURVEY
IN COOPERATION WITH
U.S. PUBLIC ROADS ADMINISTRATION

STATE OF MINNESOTA
DEPARTMENT OF HIGHWAYS
ROAD LIFE STUDIES
CONSTRUCTION PROJECT LOG RECORD

CONTROL SECTION 5502
TRUNK HIGHWAY 14
COUNTY Olmsted
DISTRICT 6A

LIMITS: W. Jct. T.H. 52 W. of Rochester - E. Jct. T.H. 52 in Rochester

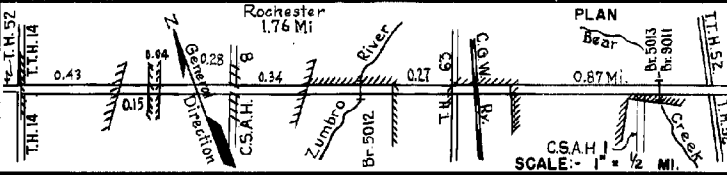

SEE SHEET 3 FOR PLAN
SUBSEQUENT TO 1957.

YEAR BUILT	PROJECT N ^o	DESCRIPTION			CODE N ^o	
		TYPE	WIDTH	THICKNESS		
		Earth	20'		No Record of Const.	1
		Black Pavement	V.W.		No Record of Const.	2
		Block Pavement	V.W.		No Record of Const. Transferred to T.H. 63 in 1931.	3
1925	14-7-33 B	Grading	30'			4
1926	14-7-33 A & B	Gravel	24'	2 1/2"	1200 C.Y./Mile.	5
1927		Concrete	20'	9-7-9	Paved by City.	6
1931	14-7-43	Grading	40'			7
	(1)					
1932	14-7-43	Gravel	50'	1 1/2"	800 C.Y./Mile. Maint. Dept.	8
	(1)					
1932	14-7-43	Bituminous	24'	1"	16017 Gal./Mile. Maint. Dept.	9
					0.24 Mi. Divided Highway	
1933	14-7-43	Concrete	20'	9-7-9		10
1935	14-7-43	Roadside Develop.				11
1936	14-7-43	Crossing Signals				12
C	1947 A.F.E. 36	Construct Service Drive				13
C	1949 5502-06	Widening Dual Type (0.55 Mi.) Concrete (0.04 Mi.)	64'	28"	9-7-9	14

YEARS		TOTAL MILES	UNINCORPORATED		INCORPORATED		RURAL		URBAN	
FROM	TO		RDWY. MI.	BR. MI.	RDWY. MI.	BR. MI.	RDWY. MI.	BR. MI.	RDWY. MI.	BR. MI.
1921	1930	2.16	0.08	0.00	2.08	0.00	0.08	0.00	2.08	0.00
1931	1946	2.99	1.81	0.04	1.12	0.02	1.81	0.04	1.12	0.02
1947	1953	3.99	1.73	0.04	1.20	0.02	1.73	0.04	1.20	0.02
1954	1958	2.99	1.42	0.04	1.45	0.02	1.42	0.04	1.45	0.02
1959	1960	2.99	1.19	0.04	1.74	0.02	1.19	0.04	1.74	0.02
1960	1961	3.62	1.65	0.04	1.91	0.02	1.65	0.04	1.91	0.02
1962	1962	3.63	1.65	0.04	1.92	0.02	1.65	0.04	1.92	0.02

REMARKS: Layout is to scale as of 1931
(1) This work not done under this project number but lies within the limits of this project

PREPARED BY
HIGHWAY PLANNING SURVEY
IN COOPERATION WITH
U.S. PUBLIC ROADS ADMINISTRATION

STATE OF MINNESOTA
DEPARTMENT OF HIGHWAYS
ROAD LIFE STUDIES
CONSTRUCTION PROJECT LOG RECORD

CONTROL SECTION 5502
TRUNK HIGHWAY 14
COUNTY Olmsted
DISTRICT 6A

LIMITS: W. Jct. T.H. 52 W. of Rochester - E. Jct. T.H. 52 in Rochester

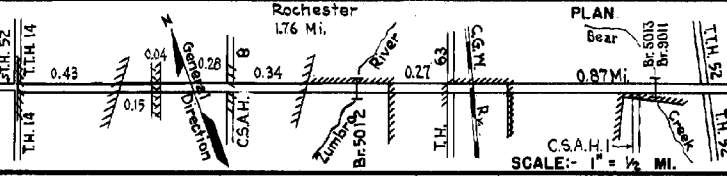

SEE SHEET 3 FOR PLAN
SUBSEQUENT TO 1957.

YEAR BUILT	PROJECT N ^o	DESCRIPTION		REMARKS	CODE N ^o
		TYPE	WIDTH THICK- NESS		
C 1949	A.F.E. 19	Bit Surfacing Service Drives			
C 1951	A.F.E. 41	Misc. Constr. of Br. 502			
C 1951	A.F.E. 51				
C 1952	A.F.E. 51	Install 9 C. Culvert			
M 1952	A.F.E. 5	Service Drive Light Bit. Seal	24'	MC-2, 1350 Gal. Agg. 33 C.Y.	
M 1953	A.F.E. 827	Service Drive Bit. Surf. Repair	24'	MC-3, 3175 Gal. Agg. 166 C.Y.	
C 1953	5502-12	Traffic Signals			
C 1953	5502-13	Traffic Signals			
M 1956	A.F.E. 604	Service Drive Spot Bit. Surf. Repair (Net 0.20 Mi.)	24'	MC-2, 965 Gal. Bit. Mix 122 Tons	
C 1956	5502-08	Grading (E.B. Rdwy) Crushed Rock Base Concrete & Bit. (2)	44'± 3'-6" 8'-9"	Br. 901 (105' x 30' S.S.) on 24' Sand Material	
M 1957	A.F.E. 605	Bit Seal Coat	32'	RS-2, 3085 Gal. Agg. 94 C.Y.	
C 1957	5502-17	Traffic Signals			

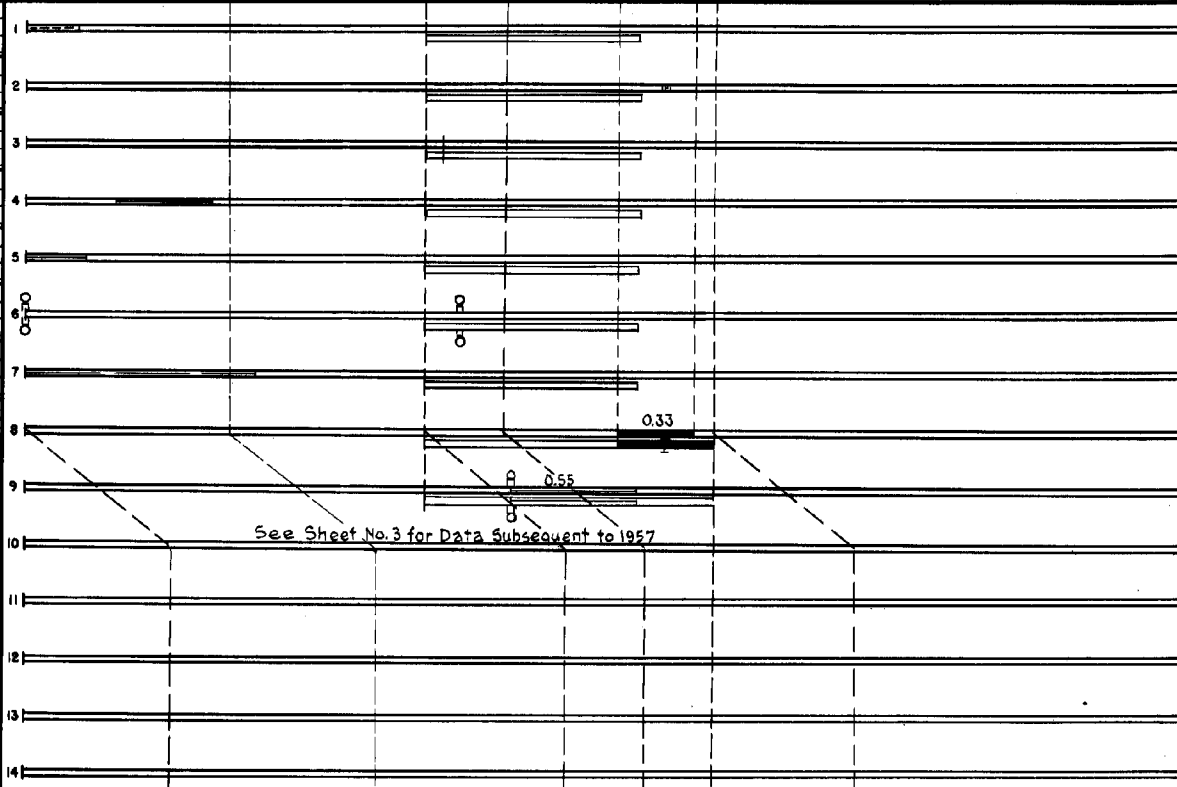

YEARS FROM TO	TOTAL MILES	UNINCORPORATED		INCORPORATED		RURAL		URBAN		
		ROWY. MI.	BR. MI.	ROWY. MI.	BR. MI.	ROWY. MI.	BR. MI.	ROWY. MI.	BR. MI.	
1963	1965	3.63	1.46	0.04	2.11	0.02	1.46	0.04	2.11	0.02
1966	1966	3.63	1.18	0.04	2.39	0.02	1.18	0.04	2.39	0.02
1967		3.74	1.47	0.07	2.18	0.02	1.47	0.07	2.18	0.02

REMARKS: See Sheet No. 1
(2) 3' x 16" Mixed Bit. on Cr. Rock placed on outsides of 2-24' conc. rdwys from Mi. Pt. 2.57-2.66.

PREPARED BY
TRAFFIC AND PLANNING DIVISION
IN COOPERATION WITH
U.S. DEPARTMENT OF COMMERCE
BUREAU OF PUBLIC ROADS

STATE OF MINNESOTA
DEPARTMENT OF HIGHWAYS
ROAD LIFE STUDIES
CONSTRUCTION PROJECT LOG RECORD

CONTROL SECTION 5502
TRUNK HIGHWAY 14
COUNTY Olmsted
DISTRICT 4A

LIMITS: W. Jct. T.H. 52 W. of Rochester - E. Jct. T.H. 52 in Rochester

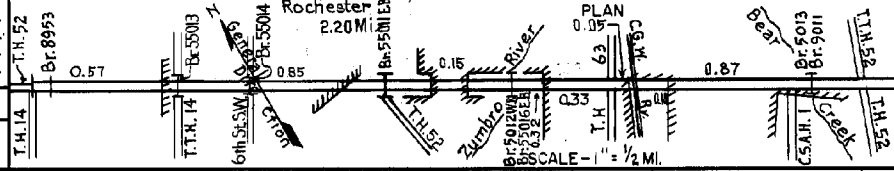

YEAR BUILT	PROJECT NO.	DESCRIPTION			REMARKS
		TYPE	WIDTH	THICKNESS	
1960		Gravel Base			0.63 Trans. from C.S. 5908 due to relocation of T.H. 14 also Br. 8953
1960		Grading, Base			Constructed in connection with T.H. 63
1961	5502-24	Traffic Signals			
1961	5502-27	Lighting System			
1962	5502-23	Grading, Cr. Rock Base*	20' 26"	8"	1.06 mi. Divided Highway Jump Conn. Mt. Pt. 144-154 Both 146' P.C.S.-U.P. Brs. 55013 & 55014
1962		Light Bit Seal	20' 16"		RC-2, 1294 Gal. Agg. 48 C.Y.
1963	5502-29	Concrete Curb			144' By Maint.
1963	5502-29	Lighting System			By Maint.
1964	5502-30	Reconst. Traffic Signal System			Spot Bit Repair On concrete surf
1966	5502-31	Lighting System			
1966	5502-33 & 34	Reconst. & Const. Traffic Signal System			
1967	5502-28	Grading			Divided Highway
1967	5502-35	Grading, Base	48' 52"	8"	
1967	5502-55011	Br. 55011	26' 20"		172' B.S. - O.H.
1967	5502-55016	Br. 55016	30'		211' B.S. - O.H.
1967	5502-55012	Br. 55012 const. of decklets	30'		211' B.S. - O.H. in place
1967	5502-36	Lighting System			
1967	5502-37	Traffic Signs			
1966	SF	Light Bit Seal Coat	25'		RC-250 Bit 2065 Gal. FA-1 Agg. 56 C.Y.
1970	5502-38	Traffic Signals System			
1970	5502-42	Traffic Signs			

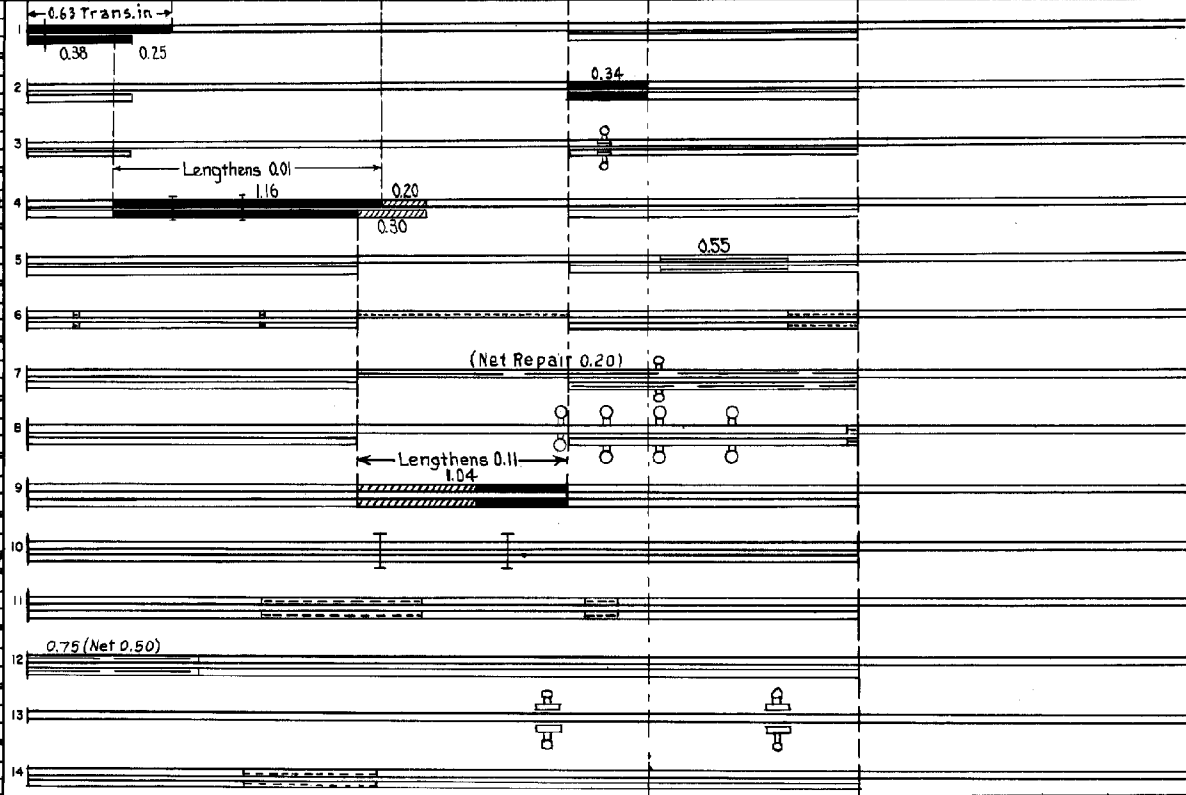

YEARS		TOTAL MILES	UNINCORPORATED		INCORPORATED		RURAL		URBAN		REMARKS: See sheet No. 1
FROM	TO		RDWY. MI.	BR. MI.	RDWY. MI.	BR. MI.	RDWY. MI.	BR. MI.	RDWY. MI.	BR. MI.	

10-74

PREPARED BY
TRANSPORTATION & TRANSIT PLANNING & PROGRAMMING DIVISION
IN COOPERATION WITH
U.S. DEPARTMENT OF TRANSPORTATION-BUREAU OF PUBLIC ROADS

STATE OF MINNESOTA
DEPARTMENT OF HIGHWAYS
ROAD LIFE STUDIES
CONSTRUCTION PROJECT LOG RECORD

CONTROL SECTION 5502
TRUNK HIGHWAY 14
COUNTY Olmsted
DISTRICT 6A

LIMITS: W. Jct. T.H. 52 W of Rochester - E. Jct. T.H. 52 in Rochester.

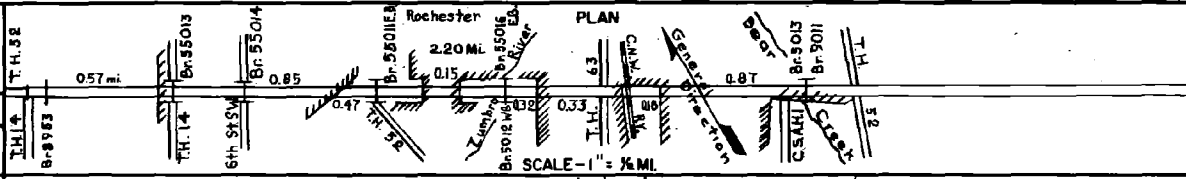

YEAR BUILT	PROJECT NO.	DESCRIPTION			REMARKS
		TYPE	WIDTH	THICKNESS	
C	5502-44	Traffic Signals			at Memorial Prky.
C	5502-46	Traffic Signals			at E. Jct. T.H. 52
C	5502-47	Traffic Signals			at Jct. T.H. 63
M	1972 SF	Shoulder Improvement	12'	5"	170 tons (Crushed Rock) 159 tons Bit Mix
M	1972 SF	Spot Bit Surface Repair	24'		Bit Mix 585 Ton
M	5502-45	Asphaltic Conc. Surf.	10'-7 1/2'	1 1/4"	
1973	T 52 01 (008) EHS 5201 (008)	Asphaltic Conc. Shldrs. At Turn Lanes	10'		Divided Highway
M	1972 SF	Bit Surface Repair			Bit 197 Tons 2 nd 26 th St. Bridge
C	1973 -48	TRAFFIC SIGNALS			@ 2ND ST. S.W.
C	1973 T 52 01 (006)	TRAFFIC SIGNALS			AT 3RD. AVE. S.E.
C	1978 5502-53	GRAZING Bit. Resurfacing	28' x 24'	9"	
C	1979 5502-54	SURFACING Mix. Grading	24'-32'		N.B. ONLY
C	1979 5502-56	CONC. SURFACING & BRIDGES 9032 & 55014	6'-10'	12"	S.B. ROADWAY
C	1980 5502-SF	Cone Joint Repair (Clear, Cut, Saw, Reseal)			8th St NW - 12th St NW
C	1983 5502-60	Grading, Paving, Lighting			18' E.B. Lane At Jct. T.H. 14 & T.H. 52
M	1984 SF	Bit. Resurfacing	24'	1"	Contract No. 4085 Sq. 2361 1265 Tons

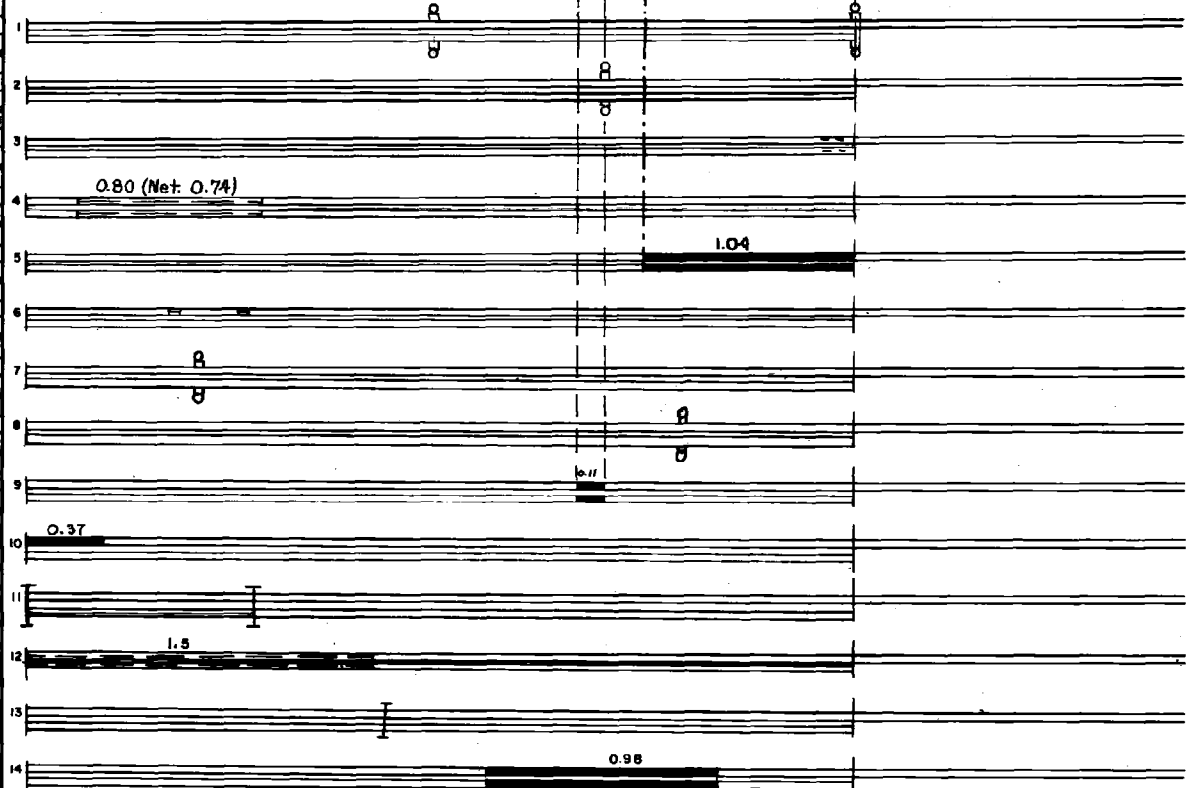

YEARS		TOTAL MILES	UNINCORPORATED		INCORPORATED		RURAL		URBAN		REMARKS
FROM	TO		RDWY. MI.	BR. MI.	RDWY. MI.	BR. MI.	RDWY. MI.	BR. MI.	RDWY. MI.	BR. MI.	
											See sheet 1

