

PREPARED BY
HIGHWAY PLANNING SURVEY
IN COOPERATION WITH
U. S. PUBLIC ROADS ADMINISTRATION

STATE OF MINNESOTA
DEPARTMENT OF HIGHWAYS
ROAD LIFE STUDIES
CONSTRUCTION PROJECT LOG RECORD

CONTROL SECTION 5403
TRUNK HIGHWAY 200
COUNTY Norman
DISTRICT 2B

LIMITS: N. Jct. T. H. 32 - E. Co. Line.

PLAN

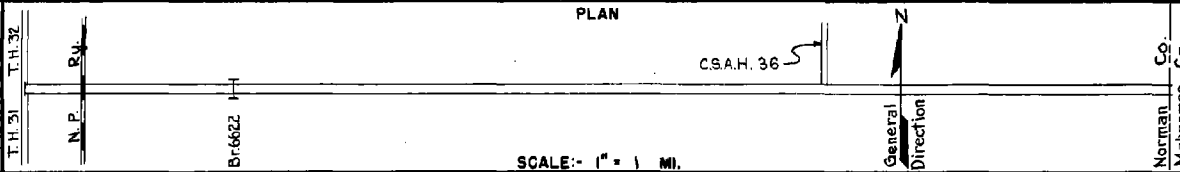

YEAR BUILT	PROJECT N ^o	DESCRIPTION			CODE N ^o Dist.
		TYPE	WIDTH THICKNESS	REMARKS	
		Earth	26	No Record of Const.	
1923	31-31-22	Grading Br. 3786	30 17	60 L.T.	
1923	31-31-23	Grading Br. 136 (1)	30 18	70' Truss	
1926	31-31-22	Gravel	26 2 1/2	1200 C.Y./Mile.	
1926	31-31-23	Gravel	26 2 1/2	1200 C.Y./Mile	
1930		Gravel	26 1 1/2	800 C.Y./Mile Maint. Dept.	
1936	31-31-23	Br. 5636		W1010	2136
M 1942	A.F.E. 6	Spot Graveling		119 C.Y./Mile. Maint. Dept.	
M 1943	A.F.E. 6	Grav. Resurface (Spots)		131 C.Y./Mi. Maint. Dept.	
M 1944	A.F.E. 6	Grav. Resurfacing (Spots)		142 C.Y./Mi. Maint. Div.	
M 1945	A.F.E. 6	Grav. Resurfacing (Spots)		157 C.Y./Mi. Maint. Div.	
C 1948	5403-02	Grading	28'		448
(2) A.F.E. 33	5403-03	Stab. Gravel Br. 6622	22' 1 1/2 27'	600 C.Y./Mi. 60 B.S.	548
C 1948	5403-02	Grading Extend #43	28'	6-12' Select Mat'l.	448
C 1949	A.F.E. 25	Bit. Surfacing Mixed Bit.	24' 1"	MGZ #5C-3, 129097 Gal. Agg. 7508 Tons	

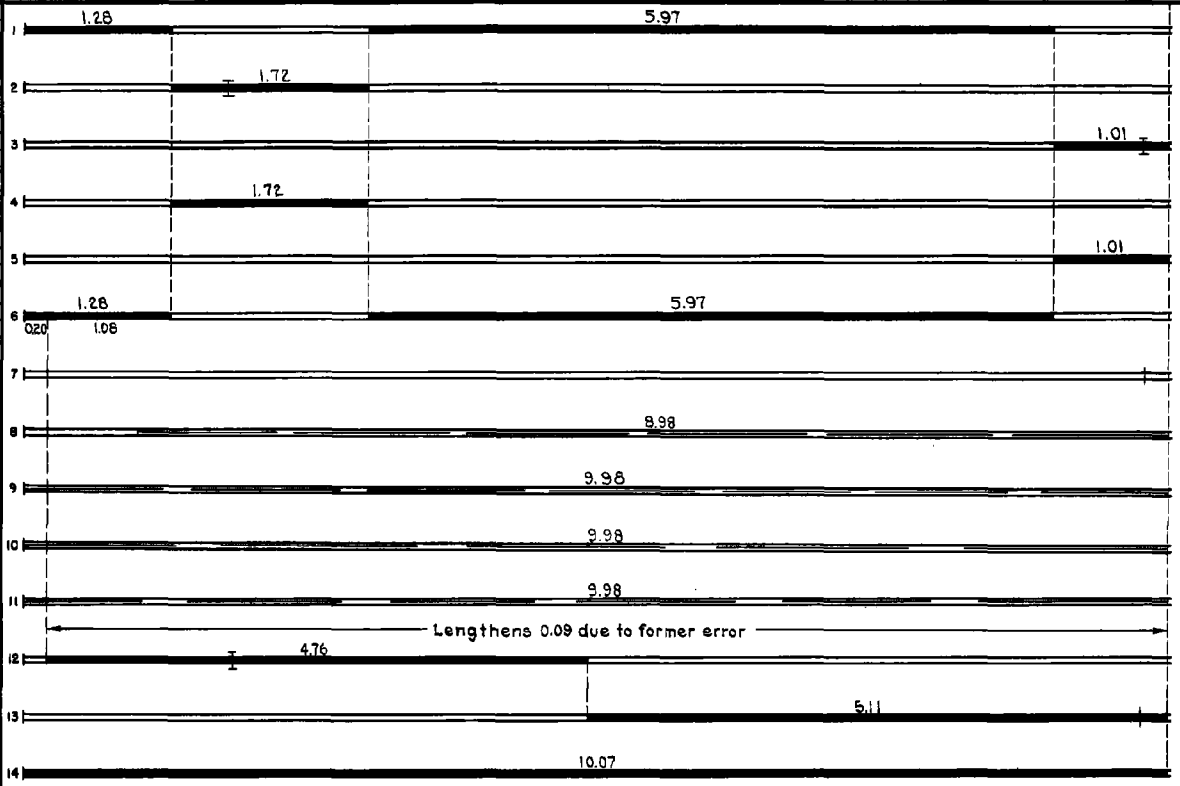

YEARS FROM TO	TOTAL MILES	UNINCORPORATED		INCORPORATED		RURAL		URBAN	
		RDWY. MI.	BR. MI.	RDWY. MI.	BR. MI.	RDWY. MI.	BR. MI.	RDWY. MI.	BR. MI.
1923	1935	9.36	0.07	0.00	0.00	9.36	0.07	0.00	0.00
1935	1947	9.36	0.01	0.00	0.00	9.37	0.01	0.00	0.00
1948	1953	10.07	0.01	0.00	0.00	10.06	0.01	0.00	0.00
1954		10.01	0.01	0.00	0.00	10.00	0.01	0.00	0.00

REMARKS: Layout is to scale as of 1923.

(1) No Record of construction of Br. 136. (2) Contract not final on S.P. 5403-03 for Br. 6622 but work substantially complete in 1948. Approach fills to Br. 6622 placed by Maint. Div. under A.F.E. 35.

PREPARED BY
HIGHWAY PLANNING SURVEY
IN COOPERATION WITH
U.S. PUBLIC ROADS ADMINISTRATION

STATE OF MINNESOTA
DEPARTMENT OF HIGHWAYS
ROAD LIFE STUDIES
CONSTRUCTION PROJECT LOG RECORD

CONTROL SECTION 5403
TRUNK HIGHWAY 200
COUNTY Norman
DISTRICT 2B

LIMITS: N. Jet T.H. 32 - E. Co. Line

Ref. Pt. 031+00.885 - 041+00.898

YEAR BUILT	PROJECT N ^o	DESCRIPTION			CODE N ^o DIST
		TYPE	WIDTH	THICKNESS	
M 1950	A.F.E. 4	Bit. Fog Seal	24'		
M 1951	A.F.E. 4	Spot Treat. Bit. Surf. Repair	24'		
C 1951	A.F.E. 22	Erosion Control			
M 1952	A.F.E. 4	Spot Treat. Bit. Surf. Repair	24'		
C 1954	5403-04 A.F.E. 821*	Sand-Grav Subbase Gravel Base Mixed Bit.	28' 28' 26'	3'-9" 3" 1"	*A.F.E. 821 Covers 3288' of Guard Rail 1554
M 1955	A.F.E. 605	Light Bit. Seal	26'		
C 1957	5403-05 5403-06	Plant Mix Bit. Grade X-ing Signals	24'	2" added	1157
M 1960		Light Bit. Seal	24'		
C 1960	-08	Plant Mix Bit. Gravel Shoulders	24' 2'	3"	
C 1976	5403-09	BIT. RESURFACING	24'	3"	1776
C 1974	5400-03	PLATE BEAM GUARD RAIL AT BR 6622			408 LIN. FT. 1774
C 1978	5400-04	GUARD RAIL FOR R.S. 436 & 3790 AT M.P. 41.7 & 33.8			1188 LIN. FT. (846 LIN. FT. SAW) 378
C 1999	5403-11	Grading Bit. Surfacing Bridges 54007	40' 28'	7"	Spec 2350

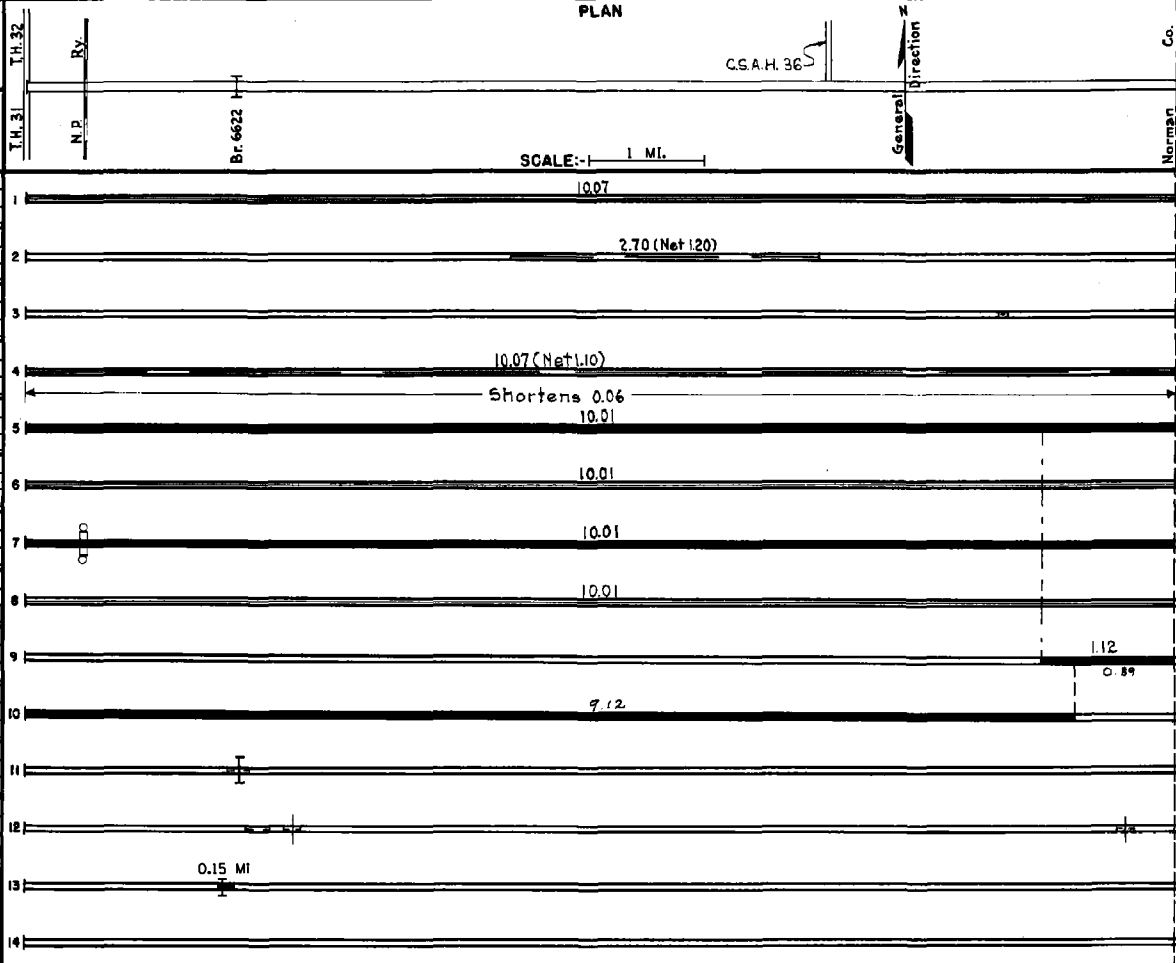

YEARS FROM	TO	TOTAL MILES	UNINCORPORATED		INCORPORATED		RURAL		URBAN	
			RDWY. MI.	BR. MI.	RDWY. MI.	BR. MI.	RDWY. MI.	BR. MI.	RDWY. MI.	BR. MI.

REMARKS: See Sheet No. 1

Co. Co.
Norman
Mahneman

