

PREPARED BY
TRAFFIC AND PLANNING DIVISION
IN COOPERATION WITH
U.S. DEPARTMENT OF COMMERCE
BUREAU OF PUBLIC ROADS

STATE OF MINNESOTA
DEPARTMENT OF HIGHWAYS
ROAD LIFE STUDIES
CONSTRUCTION PROJECT LOG RECORD

CONTROL SECTION **5380**
TRUNK HIGHWAY **90**
COUNTY **Nobles**
DISTRICT **7B**

LIMITS: Rock-Nobles Co Line to Nobles-Jackson Co. Line

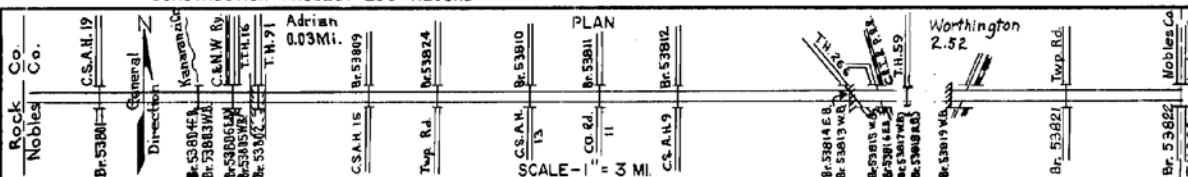

YEAR	PROJECT NO.	DESCRIPTION			
		TYPE	WIDTH	THICKNESS	REMARKS
C	5380-04	Grading			Divided Highway
1967	5380-12	Gravel Sub-base & Base P.C. Concrete	2@24'	5 1/4" 8"	
C	5380-53801	Br. 53801			209' P.P.G. - U.P.
1967	5380-53803 & 53804	Br. 53803 & 53804	2@30'		Both 128' B.S. - O.H.
	5380-53805 & 53806	Br. 53805 & 53806	2@30'		Both 265' B.S. - O.H.
C	5380-53802	Br. 53802			212' P.P.G. - U.P.
1967					
C	5380-05, 07	Grading			Divided Highway
1968	5380-13	Gravel Sub-base & Base P.C. Concrete	2@24'	5 1/4" 8"	
C	5380-53809	Br. 53809	2@24'		213' P.P.G. - U.P.
1968	5380-53824	Br. 53824	2@24'		216' P.P.G. - U.P.
	5380-53810	Br. 53810	2@24'		214' P.P.G. - U.P.
C	5380-53811	Br. 53811	2@24'		216' P.P.G. - U.P.
1968	5380-53812	Br. 53812	2@24'		216' P.P.G. - U.P.
	5380-53813 & 53814	Br. 53813 & 53814	2@30'		Both 204' P.P.G. - O.H.
C	5380-53815 & 53816	Br. 53815 & 53816	2@30'		Both 230' P.P.G. - O.H.
1968	5380-53817 & 53818	Br. 53817 & 53818	2@30'		Both 151' P.P.G. - O.H.
	5380-53819 & 53820	Br. 53819 & 53820	2@30'		Both 641' B.S. - O.H.
C	5380-07	Grading			Divided Highway
1968	5380-53821	Br. 53821			209' P.P.G. - U.P.
1971	5380-53822	Br. 53822			326' P.P.G. - U.P.
C	5380-41	Gravel Base Asphaltic Concrete P.C. Concrete	2@24'	6" 22" 3" 9"	
M	1972	SF	Joint Seal Edgeline		1650 lbs Sealant
M	1978	SF	Bit. SPOT OVERLAY	1 1/2"	P.I. Mix AC
M	1978	SF	Bit. SEAL COAT & BRIDGE DECK		RC 250 1 FA-1 WIDE SILVER
M	1976	SF	SEAL COAT		WIDE SILVER EB1WB FA-1 & RC 250
M	1977	SF	Bit. SEAL COAT		WIDE SILVER EB1WB FA-1 & RC 250

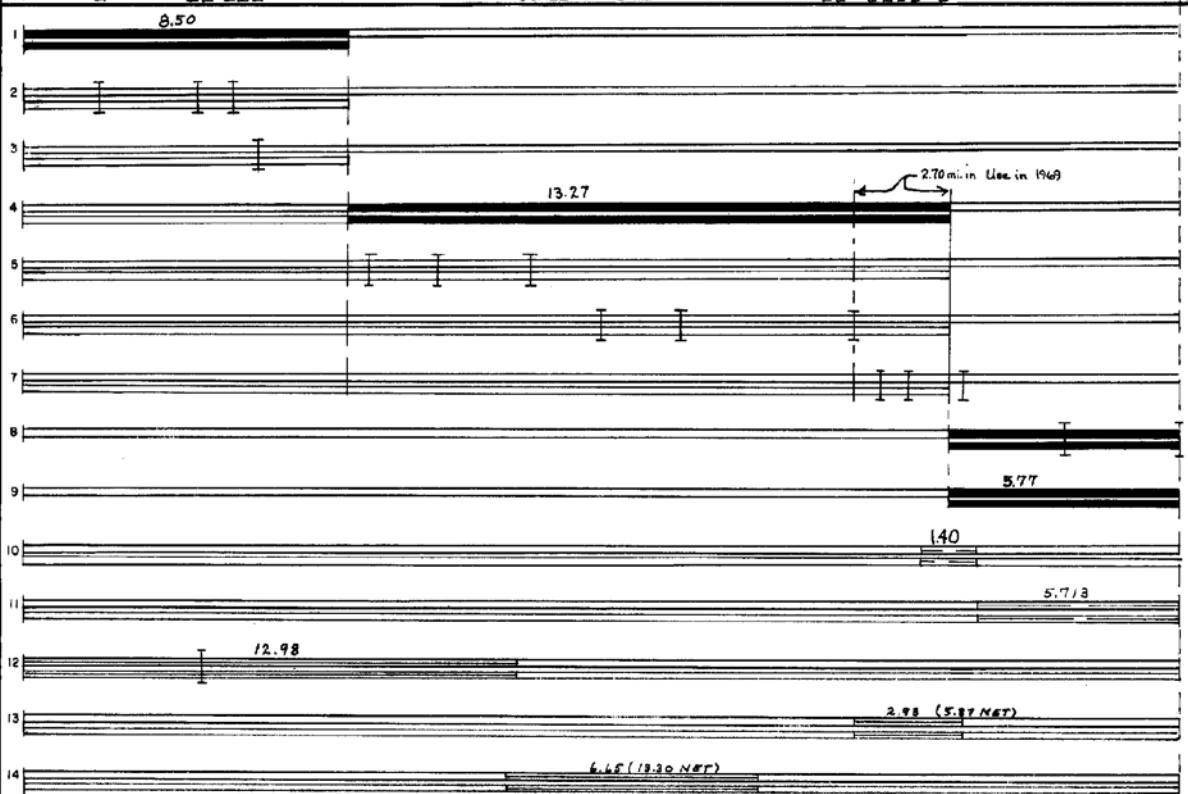

REMARKS: Layout is to scale as of 1967.

FROM	TO	TOTAL MILES	UNINCORPORATED		INCORPORATED		RURAL		URBAN	
			RDWY. MI.	BR. MI.	RDWY. MI.	BR. MI.	RDWY. MI.	BR. MI.	RDWY. MI.	BR. MI.
1967	1967	6.13	6.05	0.07	0.01	0.00	6.05	0.07	0.01	0.00
1968	1968	21.77	21.63	0.11	0.03	0.00	21.63	0.11	0.03	0.00
1969	1971	24.47	24.05	0.15	0.24	0.03	24.05	0.15	0.24	0.03
1972	1973	30.24	29.82	0.15	0.24	0.03	29.82	0.15	0.24	0.03
1974		30.24	27.54	0.15	2.52	0.03	27.54	0.15	2.52	0.03

