

PREPARED BY
HIGHWAY PLANNING SURVEY
IN COOPERATION WITH
U. S. PUBLIC ROADS ADMINISTRATION

STATE OF MINNESOTA
DEPARTMENT OF HIGHWAYS
ROAD LIFE STUDIES
CONSTRUCTION PROJECT LOG RECORD

CONTROL SECTION 5306
TRUNK HIGHWAY 60
COUNTY Nobles
DISTRICT 78

LIMITS: N. Jct. T.H. 16 in Worthington - E. Co. Line

Worthington
1.16 MI.
(See Sheet No 2)

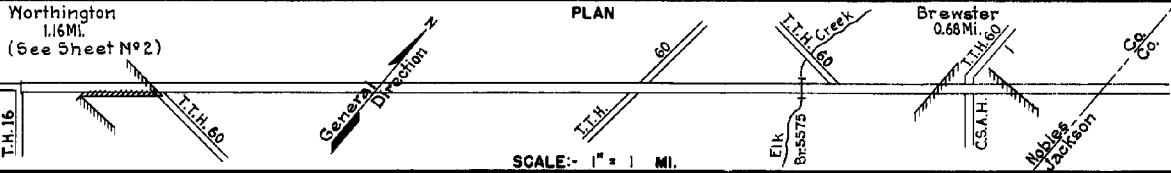

YEAR BUILT	PROJECT N ^o	DESCRIPTION			CODE N ^o
		TYPE	WIDTH	THICKNESS	
		Concrete	34'		No Record of Constr.
					Added in 1934.
		Gravel	20'	2"	No Record of Constr.
					Added in 1934.
1921		Grading	24'		F.A.P.45.
					Added in 1934.
1922		Gravel	24'	3 3/4"	F.A.P.45. 1500 C.Y./Mile. Added in 1934.
1936	60-85-22-2B	Grading	32'		
	(1)				
1936	60-85-22-2B	Gravel	24'	1 3/4"	800 C.Y./Mile. Maint. Dept.
1936	60-85-22-1	Grading Br.5575	32' 27'		50' B.S.
	(1)				
1936	60-85-22-1	Gravel	24'	1 3/4"	800 C.Y./Mile. Maint. Dept.
	(1)				
1936	60-85-22-1	Gravel	26'	1 1/2"	800 C.Y./Mile. Maint. Dept.
1937	A.F.E. 9	Seeding			Maint. Dept.
	(2)				
1938	60-85-22-2B	Gravel	32'	3 1/2"	1400 Tons/Mile.
	(2)				
1938	60-85-22-1	Gravel	32'	3 1/2"	1400 Tons/Mile.
C					
1940	5306-02&05	Concrete	22'	9-69	
C					
1941	A.F.E. 5	Seeding			Seed supplied by R.S.D. S.P. 5306 03.10 Maint. Dept.

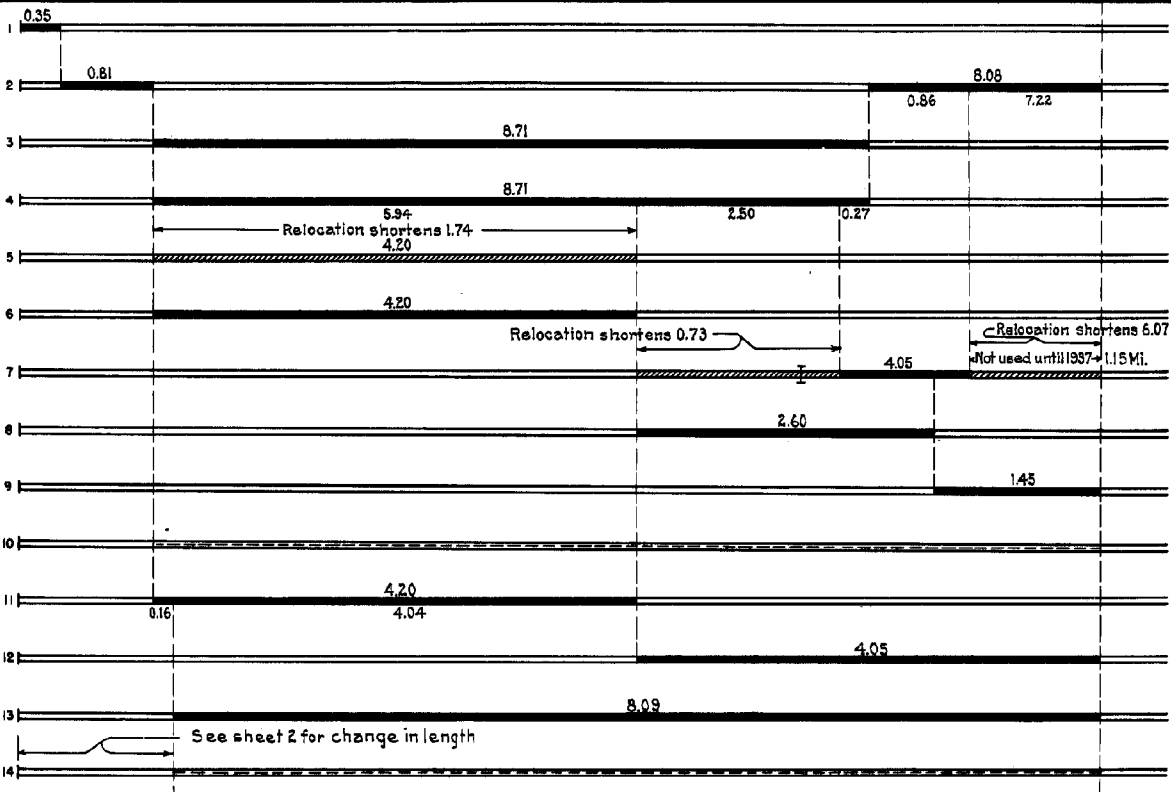

FROM	TO	TOTAL MILES	UNINCORPORATED		INCORPORATED		RURAL		URBAN	
			RDWY. MI.	BR. MI.	RDWY. MI.	BR. MI.	RDWY. MI.	BR. MI.	RDWY. MI.	BR. MI.
1934	1935	17.95	16.18	0.00	1.77	0.00	16.79	0.00	1.16	0.00
1935	1936	14.33	12.55	0.01	1.77	0.00	13.16	0.01	1.16	0.00
1937	1941	9.41	7.56	0.01	1.84	0.00	8.24	0.01	1.16	0.00
See	Sheet N ^o 2									

REMARKS: Layout is to scale as of 1937. Plan revised on sheet No 2 for 1942 relocation.

(1) This work not done under these project numbers but lies within the limits of these projects. (2) Accumulated Thickness.

PREPARED BY
HIGHWAY PLANNING SURVEY
IN COOPERATION WITH
U.S. PUBLIC ROADS ADMINISTRATION

STATE OF MINNESOTA
DEPARTMENT OF HIGHWAYS
ROAD LIFE STUDIES
CONSTRUCTION PROJECT LOG RECORD

CONTROL SECTION 5306
TRUNK HIGHWAY 69
COUNTY Nobles
DISTRICT 7B

LIMITS: N. Jct. T.H. 16 at Worthington - E. Co. Line

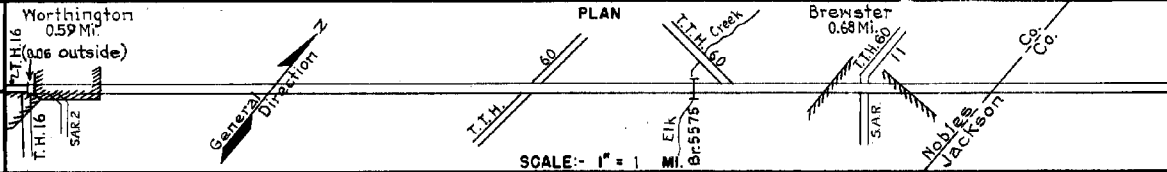

YEAR BUILT	PROJECT N°	DESCRIPTION			CODE N°
		TYPE	WIDTH	THICKNESS	
1942	5306-03	Grading	36' 7"		1
1942	5306-12	Stab. Gravel	28' 4"	4"	2
1943	5306-13	Roadside Develop.			3
1944	A.F.E. 19	Bit Surfacing Mixed Bit	24' 8"	1"	4
1945	A.F.E. 4	Bit Surf. Repair			5
1948	5306-11	Concrete	27' 4"	9' 7"	6
1961		Pavement Repair			7
1962		Install C.M. Culvert			8
1963	5306-17	Plant Mix Bit (Base) Plant Mix Bit (Surf) Gravel Shoulders	22'	4" 1 1/2"	9
1965	C	Light Bit. Seal Pav. Repair (0.36)	23'		10
1970	5380-19	Grade Gravel Base P.C. Concrete	26'	6" 8"	11
1970	5380-07	Grade, Gravel Base P.C. Concrete Pl. Mix Bit Shoulders	24'	6" 8"	12
1977	5306-25	BIT SURFACING	22'	2 1/2"	13
1982	5306-33	Emb. Const. Install Plate Beam			14

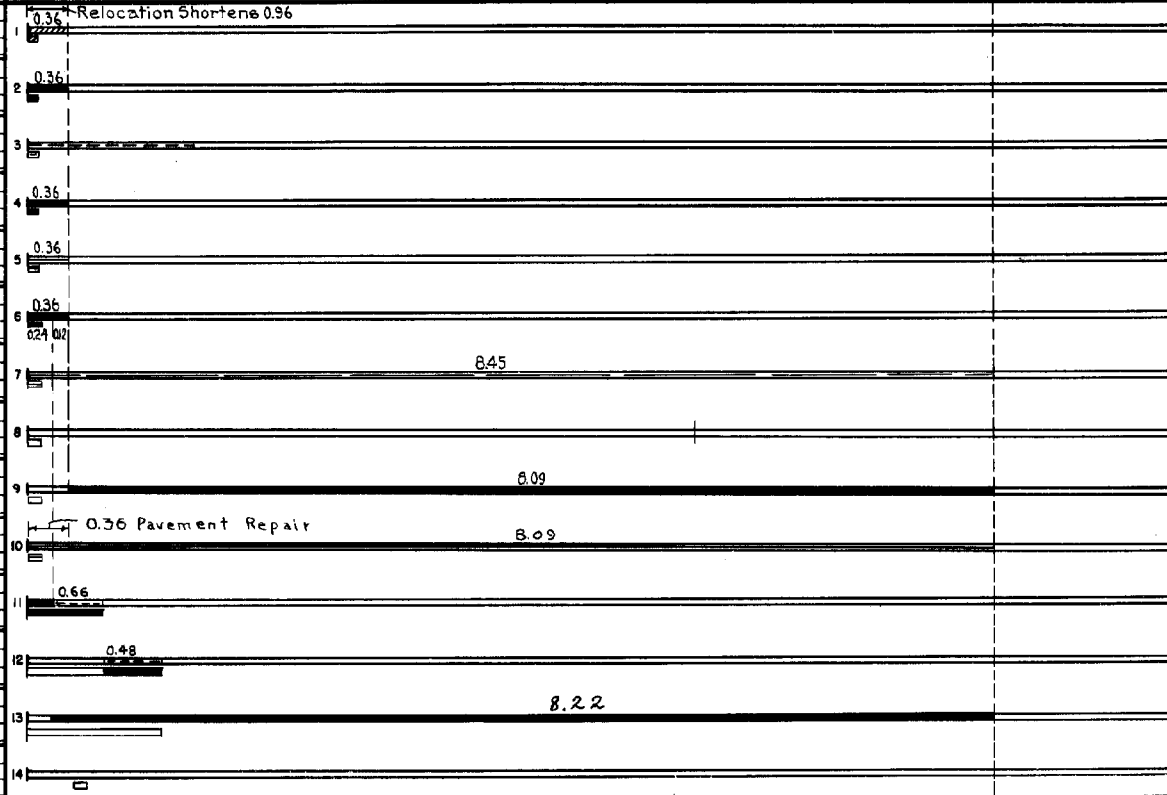

YEARS		TOTAL MILES	UNINCORPORATED		INCORPORATED		RURAL		URBAN	
FROM	TO		RDWY. MI.	BR. MI.	RDWY. MI.	BR. MI.	RDWY. MI.	BR. MI.	RDWY. MI.	BR. MI.
1942	1984	8.45	7.76	0.01	0.68	0.00	8.44	0.01	0.00	0.00
1965		8.45	7.17	0.01	1.27	0.00	7.85	0.01	0.59	0.00

REMARKS: Layout is to scale as of 1942

